



Prices effective June 2, 2025

Published September 2025

Boa Tables

Introduction	page 2
Boa Tables	3
Rectangle	5
Oval	14
Boat	23
Teardrop	26
Tapered	35
Technology/Accessories	38
Indices	43
By Name	43
By Number	45
Appendices	
20-Day or Less/Assigned Lead-Time Order Information	
Central Palette Overview	
For the latest materials information, refer to the Materials pages on HermanMiller.com .	

A Note on the Organization of This Book

There are a few signals that will help you understand the organization of this book. Once you know them, you should be able to find your way around easily.

Like a newspaper, this book is formatted with columns of text and illustrations that run vertically.

Information wraps from one column to the next and continues for as many pages as it needs to.

Black bars are clues.

A black bar at the top of a page signals the start of information about a product.

This information is divided into two sections, each signaled by a black bar. Product Information includes a description, additional notes, and dimensional drawings. Specification Information, which always begins at the top of a column, includes a series of steps. Each step represents a decision you need to make in order to complete your product number. Steps must be followed sequentially. The number of pages needed to complete information on a product varies; some will be complete in one page; others may fill three or four pages. Just continue going through the steps until you run into the next product, signaled by the black bar at the top of the page.

Black tabs running along the outside edge of the page help you locate what section you are in or what section you want to go to. You can thumb forwards or backwards to find a section; tabs and text appear on both sides of the page.

The additional pages in the back of the book include the appendices and indices. They are signaled by a long black bar running along the outside edge of the page.

The index is presented two ways.

The first index is in alphabetical order by product name. It can be helpful if you are new to the products and numbering scheme or if you are looking for a type of product, such as work chair or round table.

The second index is by product number. It lists, in alphanumeric order, the base product number, typically a five-digit number.

General Information

This book is effective June 2, 2025, subject to change without notice. Products may be purchased from authorized Herman Miller dealers who will quote prices upon request. For more information about our products and services or to see a list of dealers, visit www.HermanMiller.com.

All prices are list prices. Additional services, such as planning services, design, storage, and installation, are not included and must be added to these prices when the additional services are requested.

Illustrations, specifications, and prices are based on the latest information at the time of publication. The right is reserved to make changes at any time without notice in prices, fabrics, finishes, materials, specifications, and models, and also to discontinue models and finishes.

Dimensions shown in the drawings are engineering drawing dimensions rounded up to the nearest 1/8". Product is shipped set up or knocked down. Products that include "Shipped knocked down" in the description require some assembly. If this statement does not appear in the description, the product is shipped assembled.

Service problems are normally handled by a Herman Miller authorized dealer. Where this cannot be accomplished on a local level, service problems should be referred to the Customer Care Representative for your region, Herman Miller, Inc., Zeeland, Michigan 49464.

20-Day or Less/Assigned Lead-Time Shipments

All products and options in this price book not designated by an Assigned Program icon  will ship in **20 business days or less** after being acknowledged by Herman Miller.

Products and options designated by an  are on the assigned lead-time program and may ship in 20 days, less than 20 days, or more than 20 days from order acknowledgement.

Rectangle

Oval

Boat

Teardrop

Tapered

Technology/Accessories



Boa Table, Rectangle, Seated Height

BQ1AS BQ1AT

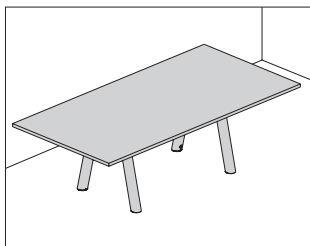

Product Information

Description

This rectangular seated-height table comes in a squared- or thin-edge style and offers a laminate top with thermoplastic edge, laminate top with universal edge, or veneer top with veneer edge. Table may be specified with cutouts to accommodate specific Herman Miller power options, ordered separately. Table comes with 1/2" leveling glides. Shipped knocked down.

Notes

Laminate tops 84" to 120" wide have 1-piece construction.

Laminate tops 132" to 168" wide have 2-piece construction.

Veneer tops 84" to 96" wide have 1-piece construction.

Veneer tops 108" to 168" wide have 2-piece construction.

All tables are supported by 4 column legs inset from the edge. See planning guide for leg placement and clearances.

Cutout will be in the center when specifying 1 cutout (A) in tables 84" to 96" wide.

When specifying cutouts (A, B) in tables 108" wide to 168" wide, cutouts can be located on the left (L), the right (R), or the left and right side(s) of the table. No center cutouts available.

Laminate and veneer tops are 1 1/4" thick.

Integrated technology cutouts are sized for Logic G1000 grommet mounted power access solutions and the Headway™ technology bucket (DP5B.). See planning guide for specific units that fit in the table.

Order the following compatible power components separately:

- Tech bucket (DP5B.)
- Logic G1000 grommet mounted electrical distributor (Y1425.)

See planning guide for additional information.

Dimensions

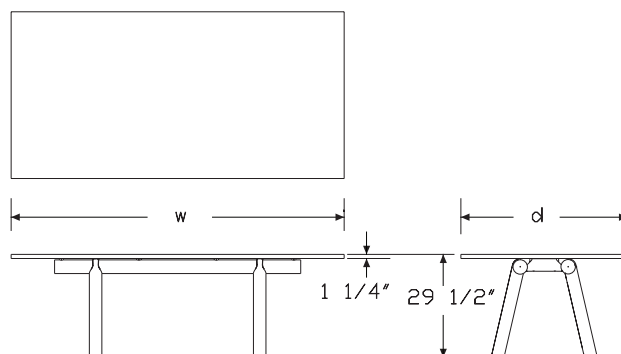

Boa Table, Rectangle, Seated Height

continued

Specification Information			
Step 1.			
BQ1A <input type="checkbox"/>			
Step 2. Edge			
S	squared-edge <input type="checkbox"/>		+\$0
T	thin-edge <input type="checkbox"/>		+\$0
Step 3. Height			
29	29.5" high <input type="checkbox"/>		+\$0
Step 4. Depth			
42	42" deep <input type="checkbox"/>		+\$0
48	48" deep <input type="checkbox"/>		+\$0
54	54" deep <input type="checkbox"/>		+\$0
60	60" deep <input type="checkbox"/>		+\$0
Step 5. Width			
For 42" deep (42)			
84	84" wide <input type="checkbox"/>		+\$5417
96	96" wide <input type="checkbox"/>		+\$5742
108	108" wide <input type="checkbox"/>		+\$6316
120	120" wide <input type="checkbox"/>		+\$6947
For 48" deep (48)			
84	84" wide <input type="checkbox"/>		+\$5579
96	96" wide <input type="checkbox"/>		+\$5914
108	108" wide <input type="checkbox"/>		+\$6505
120	120" wide <input type="checkbox"/>		+\$7156
For 54" deep (54)			
108	108" wide <input type="checkbox"/>		+\$6700
120	120" wide <input type="checkbox"/>		+\$7371
132	132" wide <input type="checkbox"/>		+\$8255
144	144" wide <input type="checkbox"/>		+\$9246
156	156" wide <input type="checkbox"/>		+\$10355
168	168" wide <input type="checkbox"/>		+\$11598
For 60" deep (60)			
108	108" wide <input type="checkbox"/>		+\$6901
120	120" wide <input type="checkbox"/>		+\$7592
132	132" wide <input type="checkbox"/>		+\$8503
144	144" wide <input type="checkbox"/>		+\$9523
156	156" wide <input type="checkbox"/>		+\$10666
168	168" wide <input type="checkbox"/>		+\$11946

Step 6. Surface Material			
For squared-edge (S) with 84" wide (84), 96" wide (96), or 108" wide (108)			
L	high-pressure laminate top/thermoplastic edge <input type="checkbox"/>		+\$0
U	high-pressure laminate/universal edge <input type="checkbox"/>		+\$0
W	natural veneer top/techwood/veneer edge <input type="checkbox"/>		+\$1482
X	natural veneer top/premium techwood/veneer edge <input type="checkbox"/>		+\$1527
Z	premium veneer top/veneer edge <input type="checkbox"/>		+\$1603
For squared-edge (S) with 120" wide (120), 132" wide (132), 144" wide (144), 156" wide (156), or 168" wide (168)			
L	high-pressure laminate top/thermoplastic edge <input type="checkbox"/>		+\$0
U	high-pressure laminate/universal edge <input type="checkbox"/>		+\$0
W	natural veneer top/techwood/veneer edge <input type="checkbox"/>		+\$2903
X	natural veneer top/premium techwood/veneer edge <input type="checkbox"/>		+\$2990
Z	premium veneer top/veneer edge <input type="checkbox"/>		+\$3140
For thin-edge (T) with 84" wide (84), 96" wide (96), or 108" wide (108)			
L	high-pressure laminate top/thermoplastic edge <input type="checkbox"/>		+\$1392
W	natural veneer top/techwood/veneer edge <input type="checkbox"/>		+\$3482
X	natural veneer top/premium techwood/veneer edge <input type="checkbox"/>		+\$3587
Z	premium veneer top/veneer edge <input type="checkbox"/>		+\$3766
For thin-edge (T) with 120" wide (120), 132" wide (132), 144" wide (144), 156" wide (156), or 168" wide (168)			
L	high-pressure laminate top/thermoplastic edge <input type="checkbox"/>		+\$1744
W	natural veneer top/techwood/veneer edge <input type="checkbox"/>		+\$6670
X	natural veneer top/premium techwood/veneer edge <input type="checkbox"/>		+\$6870
Z	premium veneer top/veneer edge <input type="checkbox"/>		+\$7214
Step 7. Number of Cutouts			
For 84" wide (84) or 96" wide (96)			
N	no cutouts <input type="checkbox"/>		+\$0
A	1 cutout <input type="checkbox"/>		+\$0
For 108" wide (108), 120" wide (120), 132" wide (132), 144" wide (144), 156" wide (156), or 168" wide (168)			
N	no cutouts <input type="checkbox"/>		+\$0
A	1 cutout <input type="checkbox"/>		+\$0
B	2 cutouts <input type="checkbox"/>		+\$0
Step 8. Cutout #1 Location			
For 84" wide (84) or 96" wide (96) with 1 cutout (A)			
C	center cutout <input type="checkbox"/>		+\$0

Boa Table, Rectangle, Seated Height

continued

For 108" wide (108), 120" wide (120), 132" wide (132), 144" wide (144), 156" wide (156), or 168" wide (168) with 1 cutout (A) or 2 cutouts (B)

L	left cutout <input type="checkbox"/>	+\$0
R	right cutout <input type="checkbox"/>	+\$0

Step 9. Cutout #2 Location

For 108" wide (108), 120" wide (120), 132" wide (132), 144" wide (144), 156" wide (156), or 168" wide (168) with 2 cutouts (B) with left cutout (L)

R	right cutout <input type="checkbox"/>	+\$0
---	---------------------------------------	------

For 108" wide (108), 120" wide (120), 132" wide (132), 144" wide (144), 156" wide (156), or 168" wide (168) with 2 cutouts (B) with right cutout (R)

L	left cutout <input type="checkbox"/>	+\$0
---	--------------------------------------	------

Step 10. Technology Integration for Cutout #1

For 1 cutout (A) or 2 cutouts (B)

L3	cutout for logic Y1425 3 port <input type="checkbox"/>	+\$65
L5	cutout for logic Y1425 5 port <input type="checkbox"/>	+\$125
TB	cutout for technology bucket <input type="checkbox"/>	+\$190

Step 11. Technology Integration for Cutout #2

For 2 cutouts (B)

L3	cutout for logic Y1425 3 port <input type="checkbox"/>	+\$65
L5	cutout for logic Y1425 5 port <input type="checkbox"/>	+\$125
TB	cutout for technology bucket <input type="checkbox"/>	+\$190

Step 12.

Top Finish

For high-pressure laminate top/thermoplastic edge (L) or high-pressure laminate/universal edge (U)

8Q	folkstone grey (CP) <input type="checkbox"/>	+\$0
91	white (CP) <input type="checkbox"/>	+\$0
98	studio white (CP) <input type="checkbox"/>	+\$0
LBA	clear on ash (CP) <input type="checkbox"/>	+\$0
LBB	oak on ash (CP) <input type="checkbox"/>	+\$0
LBC	walnut on ash (CP) <input type="checkbox"/>	+\$0
LBU	medium matte walnut (CP) <input type="checkbox"/>	+\$0
WL	warm stone (CP) <input type="checkbox"/>	+\$0

Top/Edge Finish

For natural veneer top/techwood/veneer edge (W)

652D	whitened quartered oak techwood / low gloss / open pore (CP) <input type="checkbox"/>	+\$0
------	---	------

Top/Edge Finish

For natural veneer top/premium techwood/veneer edge (X)

009D	white oak / low gloss / open pore (CP) <input type="checkbox"/>	+\$0
012D	oxford walnut / low gloss / open pore (CP) <input type="checkbox"/>	+\$0

Top/Edge Finish

For premium veneer top/veneer edge (Z)

070D	ebonized oak / low gloss / open pore (CP) <input type="checkbox"/>	+\$0
------	--	------

Step 13. Edge Finish

For 84" wide (84), 96" wide (96), 108" wide (108), 120" wide (120), 132" wide (132), 144" wide (144), 156" wide (156), or 168" wide (168) with high-pressure laminate top/thermoplastic edge (L)

8Q	folkstone grey (CP) <input type="checkbox"/>	+\$0
91	white (CP) <input type="checkbox"/>	+\$0
98	studio white (CP) <input type="checkbox"/>	+\$0
LBA	clear on ash (CP) <input type="checkbox"/>	+\$0
LBB	oak on ash (CP) <input type="checkbox"/>	+\$0
LBC	walnut on ash (CP) <input type="checkbox"/>	+\$0
LBU	medium matte walnut (CP) <input type="checkbox"/>	+\$0
WL	warm stone (CP) <input type="checkbox"/>	+\$0

For 84" wide (84) or 96" wide (96) with high-pressure laminate/universal edge (U)

PLY	plywood edge <input type="checkbox"/>	+\$75
-----	---------------------------------------	-------

For 108" wide (108), 120" wide (120), 132" wide (132), 144" wide (144), 156" wide (156), or 168" wide (168) with high-pressure laminate/universal edge (U)

PLY	plywood edge <input type="checkbox"/>	+\$150
-----	---------------------------------------	--------

Step 14. Base Finish

Metallic Paint

613	silver (CP) <input type="checkbox"/>	+\$0
-----	--------------------------------------	------

Sand Texture Paint

8Q	folkstone grey (CP) <input type="checkbox"/>	+\$0
91	white (CP) <input type="checkbox"/>	+\$0
98	studio white (CP) <input type="checkbox"/>	+\$0
BK	black <input type="checkbox"/>	+\$0
DN2	nightfall <input type="checkbox"/>	+\$0
DR1	canyon <input type="checkbox"/>	+\$0
OLF	olive <input type="checkbox"/>	+\$0
WL	warm stone (CP) <input type="checkbox"/>	+\$0

Boa Table, Rectangle, Counter Height

BQ1BS
BQ1BT

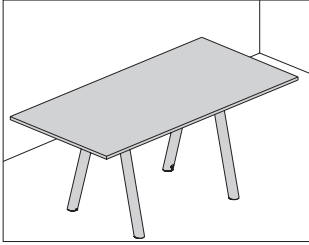

Boa Rectangle Tables

Product Information
<p>Description</p> <p>This rectangular counter-height table comes in a squared- or thin-edge style and offers a laminate top with thermoplastic edge, laminate top with universal edge, or veneer top with veneer edge. Table may be specified with cutouts to accommodate specific Herman Miller power options, ordered separately. Table comes with 1/2" leveling glides. Shipped knocked down.</p>
<p>Notes</p> <p>Laminate tops 84" to 108" wide have 1-piece construction.</p> <p>Veneer tops 84" to 96" wide have 1-piece construction.</p> <p>Veneer tops 108" wide have 2-piece construction.</p> <p>All tables are supported by 4 column legs inset from the edge. See planning guide for leg placement and clearances.</p> <p>Cutout will be in the center when specifying 1 cutout (A) in tables 84" to 96" wide.</p> <p>When specifying cutouts (A, B) in tables 108" wide, cutouts can be located on the left (L), the right (R), or the left and right side(s) of the table. No center cutouts available.</p> <p>Laminate and veneer tops are 1 1/4" thick.</p> <p>Integrated technology cutouts are sized for Logic G1000 grommet mounted power access solutions and the Headway™ technology bucket (DP5B.). See planning guide for specific units that fit in the table.</p> <p>Order the following compatible power components separately:</p> <ul style="list-style-type: none"> • Tech bucket (DP5B.) • Logic G1000 grommet mounted electrical distributor (Y1425.) <p>See planning guide for additional information.</p>

Dimensions

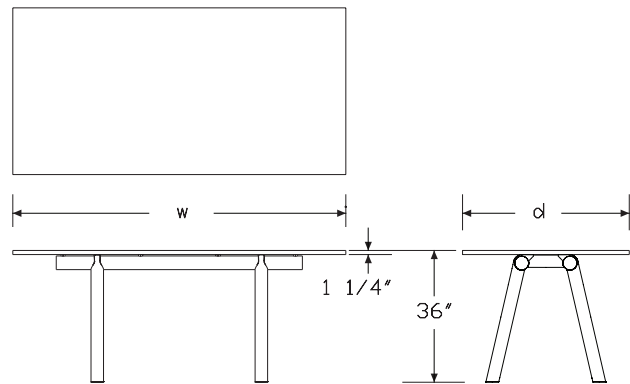

Boa Table, Rectangle, Counter Height *continued*

Specification Information			
Step 1.			
BQ1B	<input type="checkbox"/>		
Step 2. Edge			
S	squared-edge <input type="checkbox"/>		+\$0
T	thin-edge <input type="checkbox"/>		+\$0
Step 3. Height			
36	36" high <input type="checkbox"/>		+\$0
Step 4. Depth			
42	42" deep <input type="checkbox"/>		+\$0
48	48" deep <input type="checkbox"/>		+\$0
Step 5. Width			
<i>For 42" deep (42)</i>			
84	84" wide <input type="checkbox"/>		+\$5579
96	96" wide <input type="checkbox"/>		+\$5914
108	108" wide <input type="checkbox"/>		+\$6505
<i>For 48" deep (48)</i>			
84	84" wide <input type="checkbox"/>		+\$5747
96	96" wide <input type="checkbox"/>		+\$6091
108	108" wide <input type="checkbox"/>		+\$6700
Step 6. Surface Material			
<i>For squared-edge (S)</i>			
L	high-pressure laminate top/thermoplastic edge <input type="checkbox"/>		+\$0
U	high-pressure laminate/universal edge <input type="checkbox"/>		+\$0
W	natural veneer top/techwood/veneer edge <input type="checkbox"/>		+\$1482
X	natural veneer top/premium techwood/veneer edge <input type="checkbox"/>		+\$1527
Z	premium veneer top/veneer edge <input type="checkbox"/>		+\$1603
<i>For thin-edge (T)</i>			
L	high-pressure laminate top/thermoplastic edge <input type="checkbox"/>		+\$1392
W	natural veneer top/techwood/veneer edge <input type="checkbox"/>		+\$3482
X	natural veneer top/premium techwood/veneer edge <input type="checkbox"/>		+\$3587
Z	premium veneer top/veneer edge <input type="checkbox"/>		+\$3766
Step 7. Number of Cutouts			
<i>For 84" wide (84) or 96" wide (96)</i>			
N	no cutouts <input type="checkbox"/>		+\$0
A	1 cutout <input type="checkbox"/>		+\$0

<i>For 108" wide (108)</i>			
N	no cutouts <input type="checkbox"/>		+\$0
A	1 cutout <input type="checkbox"/>		+\$0
B	2 cutouts <input type="checkbox"/>		+\$0
Step 8. Cutout #1 Location			
<i>For 84" wide (84) or 96" wide (96) with 1 cutout (A)</i>			
C	center cutout <input type="checkbox"/>		+\$0
<i>For 108" wide (108) with 1 cutout (A) or 2 cutouts (B)</i>			
L	left cutout <input type="checkbox"/>		+\$0
R	right cutout <input type="checkbox"/>		+\$0
Step 9. Cutout #2 Location			
<i>For 108" wide (108) with 2 cutouts (B) with left cutout (L)</i>			
R	right cutout <input type="checkbox"/>		+\$0
<i>For 108" wide (108) with 2 cutouts (B) with right cutout (R)</i>			
L	left cutout <input type="checkbox"/>		+\$0
Step 10. Technology Integration for Cutout #1			
<i>For 1 cutout (A) or 2 cutouts (B)</i>			
L3	cutout for logic Y1425 3 port <input type="checkbox"/>		+\$65
L5	cutout for logic Y1425 5 port <input type="checkbox"/>		+\$125
TB	cutout for technology bucket <input type="checkbox"/>		+\$190
Step 11. Technology Integration for Cutout #2			
<i>For 2 cutouts (B)</i>			
L3	cutout for logic Y1425 3 port <input type="checkbox"/>		+\$65
L5	cutout for logic Y1425 5 port <input type="checkbox"/>		+\$125
TB	cutout for technology bucket <input type="checkbox"/>		+\$190
Step 12.			
Top Finish			
<i>For high-pressure laminate top/thermoplastic edge (L) or high-pressure laminate/universal edge (U)</i>			
8Q	folkstone grey (CP) <input type="checkbox"/>		+\$0
91	white (CP) <input type="checkbox"/>		+\$0
98	studio white (CP) <input type="checkbox"/>		+\$0
LBA	clear on ash (CP) <input type="checkbox"/>		+\$0
LBB	oak on ash (CP) <input type="checkbox"/>		+\$0
LBC	walnut on ash (CP) <input type="checkbox"/>		+\$0
LBU	medium matte walnut (CP) <input type="checkbox"/>		+\$0
WL	warm stone (CP) <input type="checkbox"/>		+\$0

Boa Table, Rectangle, Counter Height *continued*

Top/Edge Finish		
<i>For natural veneer top/techwood/veneer edge (W)</i>		
652D	whitened quartered oak techwood / low gloss / open pore (CP) <input type="checkbox"/>	+\$0

Top/Edge Finish		
<i>For natural veneer top/premium techwood/veneer edge (X)</i>		
009D	white oak / low gloss / open pore (CP) <input type="checkbox"/>	+\$0
012D	oxford walnut / low gloss / open pore (CP) <input type="checkbox"/>	+\$0

Top/Edge Finish		
<i>For premium veneer top/veneer edge (Z)</i>		
070D	ebonized oak / low gloss / open pore (CP) <input type="checkbox"/>	+\$0

Step 13. Edge Finish

<i>For high-pressure laminate top/thermoplastic edge (L)</i>		
8Q	folkstone grey (CP) <input type="checkbox"/>	+\$0
91	white (CP) <input type="checkbox"/>	+\$0
98	studio white (CP) <input type="checkbox"/>	+\$0
LBA	clear on ash (CP) <input type="checkbox"/>	+\$0
LBB	oak on ash (CP) <input type="checkbox"/>	+\$0
LBC	walnut on ash (CP) <input type="checkbox"/>	+\$0
LBU	medium matte walnut (CP) <input type="checkbox"/>	+\$0
WL	warm stone (CP) <input type="checkbox"/>	+\$0

<i>For high-pressure laminate/universal edge (U)</i>		
PLY	plywood edge <input type="checkbox"/>	+\$75

Step 14. Base Finish

Metallic Paint		
613	silver (CP) <input type="checkbox"/>	+\$0

Sand Texture Paint		
8Q	folkstone grey (CP) <input type="checkbox"/>	+\$0
91	white (CP) <input type="checkbox"/>	+\$0
98	studio white (CP) <input type="checkbox"/>	+\$0
BK	black <input type="checkbox"/>	+\$0
DN2	nightfall <input type="checkbox"/>	+\$0
DR1	canyon <input type="checkbox"/>	+\$0
OLF	olive <input type="checkbox"/>	+\$0
WL	warm stone (CP) <input type="checkbox"/>	+\$0

Boa Table, Rectangle, Standing Height

BQ1CS
BQ1CT

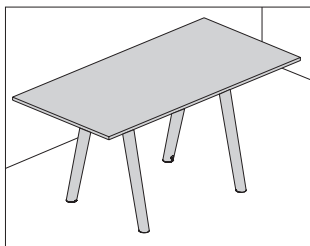

Product Information

Description

This rectangular standing-height table comes in a squared- or thin-edge style and offers a laminate top with thermoplastic edge, laminate top with universal edge, or veneer top with veneer edge. Table may be specified with cutouts to accommodate specific Herman Miller power options, ordered separately. Table comes with 1/2" leveling glides. Shipped knocked down.

Notes

Laminate tops 84" to 108" wide have 1-piece construction.

Veneer tops 84" to 96" wide have 1-piece construction.

Veneer tops 108" wide have 2-piece construction.

All tables are supported by 4 column legs inset from the edge. See planning guide for leg placement and clearances.

Cutout will be in the center when specifying 1 cutout (A) in tables 84" to 96" wide.

When specifying cutouts (A, B) in tables 108" wide, cutouts can be located on the left (L), the right (R), or the left and right side(s) of the table. No center cutouts available.

Laminate and veneer tops are 1 1/4" thick.

Integrated technology cutouts are sized for Logic G1000 grommet mounted power access solutions and the Headway™ technology bucket (DP5B.). See planning guide for specific units that fit in the table.

Order the following compatible power components separately:

- Tech bucket (DP5B.)
- Logic G1000 grommet mounted electrical distributor (Y1425.)

See planning guide for additional information.

Dimensions

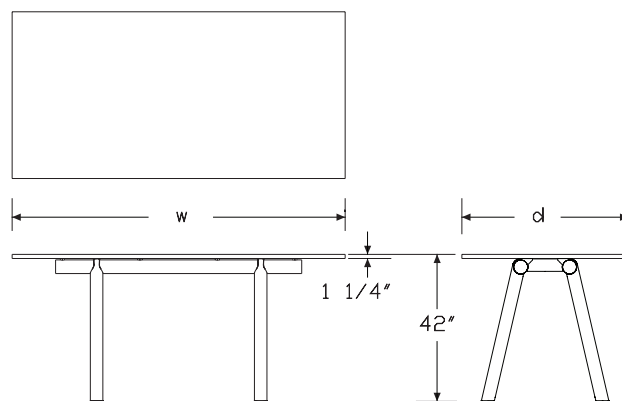

Boa Table, Rectangle, Standing Height *continued*

Specification Information			
Step 1.			
BQ1C	<input type="checkbox"/>		
Step 2. Edge			
S	squared-edge <input type="checkbox"/>		+\$0
T	thin-edge <input type="checkbox"/>		+\$0
Step 3. Height			
42	42" high <input type="checkbox"/>		+\$0
Step 4. Depth			
42	42" deep <input type="checkbox"/>		+\$0
48	48" deep <input type="checkbox"/>		+\$0
Step 5. Width			
<i>For 42" deep (42)</i>			
84	84" wide <input type="checkbox"/>		+\$5747
96	96" wide <input type="checkbox"/>		+\$6091
108	108" wide <input type="checkbox"/>		+\$6700
<i>For 48" deep (48)</i>			
84	84" wide <input type="checkbox"/>		+\$5919
96	96" wide <input type="checkbox"/>		+\$6274
108	108" wide <input type="checkbox"/>		+\$6901
Step 6. Surface Material			
<i>For squared-edge (S)</i>			
L	high-pressure laminate top/thermoplastic edge <input type="checkbox"/>		+\$0
U	high-pressure laminate/universal edge <input type="checkbox"/>		+\$0
W	natural veneer top/techwood/veneer edge <input type="checkbox"/>		+\$1482
X	natural veneer top/premium techwood/veneer edge <input type="checkbox"/>		+\$1527
Z	premium veneer top/veneer edge <input type="checkbox"/>		+\$1603
<i>For thin-edge (T)</i>			
L	high-pressure laminate top/thermoplastic edge <input type="checkbox"/>		+\$1392
W	natural veneer top/techwood/veneer edge <input type="checkbox"/>		+\$3482
X	natural veneer top/premium techwood/veneer edge <input type="checkbox"/>		+\$3587
Z	premium veneer top/veneer edge <input type="checkbox"/>		+\$3766
Step 7. Number of Cutouts			
<i>For 84" wide (84) or 96" wide (96)</i>			
N	no cutouts <input type="checkbox"/>		+\$0
A	1 cutout <input type="checkbox"/>		+\$0

<i>For 108" wide (108)</i>			
N	no cutouts <input type="checkbox"/>		+\$0
A	1 cutout <input type="checkbox"/>		+\$0
B	2 cutouts <input type="checkbox"/>		+\$0
Step 8. Cutout #1 Location			
<i>For 84" wide (84) or 96" wide (96) with 1 cutout (A)</i>			
C	center cutout <input type="checkbox"/>		+\$0
<i>For 108" wide (108) with 1 cutout (A) or 2 cutouts (B)</i>			
L	left cutout <input type="checkbox"/>		+\$0
R	right cutout <input type="checkbox"/>		+\$0
Step 9. Cutout #2 Location			
<i>For 108" wide (108) with 2 cutouts (B) with left cutout (L)</i>			
R	right cutout <input type="checkbox"/>		+\$0
<i>For 108" wide (108) with 2 cutouts (B) with right cutout (R)</i>			
L	left cutout <input type="checkbox"/>		+\$0
Step 10. Technology Integration for Cutout #1			
<i>For 1 cutout (A) or 2 cutouts (B)</i>			
L3	cutout for logic Y1425 3 port <input type="checkbox"/>		+\$65
L5	cutout for logic Y1425 5 port <input type="checkbox"/>		+\$125
TB	cutout for technology bucket <input type="checkbox"/>		+\$190
Step 11. Technology Integration for Cutout #2			
<i>For 2 cutouts (B)</i>			
L3	cutout for logic Y1425 3 port <input type="checkbox"/>		+\$65
L5	cutout for logic Y1425 5 port <input type="checkbox"/>		+\$125
TB	cutout for technology bucket <input type="checkbox"/>		+\$190
Step 12.			
Top Finish			
<i>For high-pressure laminate top/thermoplastic edge (L) or high-pressure laminate/universal edge (U)</i>			
8Q	folkstone grey (CP) <input type="checkbox"/>		+\$0
91	white (CP) <input type="checkbox"/>		+\$0
98	studio white (CP) <input type="checkbox"/>		+\$0
LBA	clear on ash (CP) <input type="checkbox"/>		+\$0
LBB	oak on ash (CP) <input type="checkbox"/>		+\$0
LBC	walnut on ash (CP) <input type="checkbox"/>		+\$0
LBU	medium matte walnut (CP) <input type="checkbox"/>		+\$0
WL	warm stone (CP) <input type="checkbox"/>		+\$0

Boa Table, Rectangle, Standing

Height *continued*

Top/Edge Finish

For natural veneer top/techwood/veneer edge (W)

652D	whitened quartered oak techwood / low gloss / open pore (CP) <input type="checkbox"/>	+\$0
-------------	---	------

Top/Edge Finish

For natural veneer top/premium techwood/veneer edge (X)

009D	white oak / low gloss / open pore (CP) <input type="checkbox"/>	+\$0
012D	oxford walnut / low gloss / open pore (CP) <input type="checkbox"/>	+\$0

Top/Edge Finish

For premium veneer top/veneer edge (Z)

070D	ebonized oak / low gloss / open pore (CP) <input type="checkbox"/>	+\$0
-------------	--	------

Step 13. Edge Finish

For high-pressure laminate top/thermoplastic edge (L)

8Q	folkstone grey (CP) <input type="checkbox"/>	+\$0
91	white (CP) <input type="checkbox"/>	+\$0
98	studio white (CP) <input type="checkbox"/>	+\$0
LBA	clear on ash (CP) <input type="checkbox"/>	+\$0
LBB	oak on ash (CP) <input type="checkbox"/>	+\$0
LBC	walnut on ash (CP) <input type="checkbox"/>	+\$0
LBU	medium matte walnut (CP) <input type="checkbox"/>	+\$0
WL	warm stone (CP) <input type="checkbox"/>	+\$0

For high-pressure laminate/universal edge (U)

PLY	plywood edge <input type="checkbox"/>	+\$75
------------	---------------------------------------	-------

Step 14. Base Finish

Metallic Paint

613	silver (CP) <input type="checkbox"/>	+\$0
------------	--------------------------------------	------

Sand Texture Paint

8Q	folkstone grey (CP) <input type="checkbox"/>	+\$0
91	white (CP) <input type="checkbox"/>	+\$0
98	studio white (CP) <input type="checkbox"/>	+\$0
BK	black <input type="checkbox"/>	+\$0
DN2	nightfall <input type="checkbox"/>	+\$0
DR1	canyon <input type="checkbox"/>	+\$0
OLF	olive <input type="checkbox"/>	+\$0
WL	warm stone (CP) <input type="checkbox"/>	+\$0

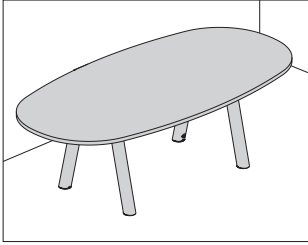

Product Information

Description

This oval seated-height table comes in a squared- or thin-edge style with rounded corners and offers a laminate top with thermoplastic edge, or veneer top with veneer edge. Table may be specified with cutouts to accommodate specific Herman Miller power options, ordered separately. Table comes with 1/2" leveling glides. Shipped knocked down.

Notes

Laminate tops 84" to 108" wide have 1-piece construction.

Veneer tops 84" to 96" wide have 1-piece construction.

Veneer tops 108" wide have 2-piece construction.

All tables are supported by 4 column legs inset from the edge. See planning guide for leg placement and clearances.

Cutout will be in the center when specifying 1 cutout (A) in tables 84" to 96" wide.

When specifying cutouts (A, B) in tables 108" wide, cutouts can be located on the left (L), the right (R), or the left and right side(s) of the table. No center cutouts available.

Laminate and veneer tops are 1 1/4" thick.

Integrated technology cutouts are sized for Logic G1000 grommet mounted power access solutions and the Headway™ technology bucket (DP5B.). See planning guide for specific units that fit in the table.

Order the following compatible power components separately:

- Tech bucket (DP5B.)
- Logic G1000 grommet mounted electrical distributor (Y1425.)

See planning guide for additional information.

Dimensions

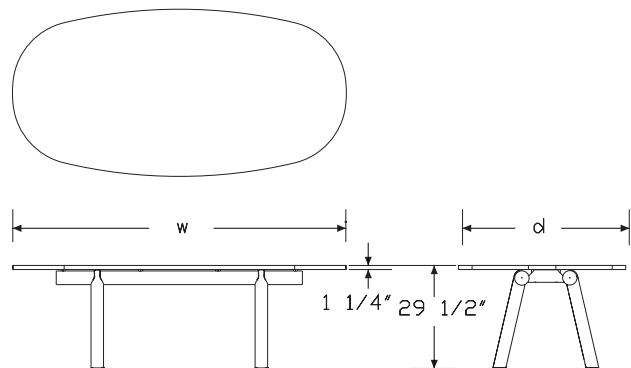

Boa Table, Oval, Seated Height

continued

Specification Information			
Step 1.			
BQ2A <input type="checkbox"/>			
Step 2. Edge			
S	squared-edge <input type="checkbox"/>		+\$0
T	thin-edge <input type="checkbox"/>		+\$0
Step 3. Height			
29	29.5" high <input type="checkbox"/>		+\$0
Step 4. Depth			
42	42" deep <input type="checkbox"/>		+\$0
48	48" deep <input type="checkbox"/>		+\$0
54	54" deep <input type="checkbox"/>		+\$0
60	60" deep <input type="checkbox"/>		+\$0
Step 5. Width			
<i>For 42" deep (42)</i>			
84	84" wide <input type="checkbox"/>		+\$5417
96	96" wide <input type="checkbox"/>		+\$5742
108	108" wide <input type="checkbox"/>		+\$6316
<i>For 48" deep (48)</i>			
84	84" wide <input type="checkbox"/>		+\$5579
96	96" wide <input type="checkbox"/>		+\$5914
108	108" wide <input type="checkbox"/>		+\$6505
<i>For 54" deep (54)</i>			
108	108" wide <input type="checkbox"/>		+\$6700
<i>For 60" deep (60)</i>			
108	108" wide <input type="checkbox"/>		+\$6901
Step 6. Surface Material			
<i>For squared-edge (S)</i>			
L	high-pressure laminate top/thermoplastic edge <input type="checkbox"/>		+\$0
W	natural veneer top/techwood/veneer edge <input type="checkbox"/>		+\$1482
X	natural veneer top/premium techwood/veneer edge <input type="checkbox"/>		+\$1527
Z	premium veneer top/veneer edge <input type="checkbox"/>		+\$1603

<i>For thin-edge (T)</i>		
L	high-pressure laminate top/thermoplastic edge <input type="checkbox"/>	+\$1392
W	natural veneer top/techwood/veneer edge <input type="checkbox"/>	+\$3482
X	natural veneer top/premium techwood/veneer edge <input type="checkbox"/>	+\$3587
Z	premium veneer top/veneer edge <input type="checkbox"/>	+\$3766
Step 7. Number of Cutouts		
<i>For 84" wide (84) or 96" wide (96)</i>		
N	no cutouts <input type="checkbox"/>	+\$0
A	1 cutout <input type="checkbox"/>	+\$0
<i>For 108" wide (108)</i>		
N	no cutouts <input type="checkbox"/>	+\$0
A	1 cutout <input type="checkbox"/>	+\$0
B	2 cutouts <input type="checkbox"/>	+\$0
Step 8. Cutout #1 Location		
<i>For 84" wide (84) or 96" wide (96) with 1 cutout (A)</i>		
C	center cutout <input type="checkbox"/>	+\$0
<i>For 108" wide (108) with 1 cutout (A) or 2 cutouts (B)</i>		
L	left cutout <input type="checkbox"/>	+\$0
R	right cutout <input type="checkbox"/>	+\$0
Step 9. Cutout #2 Location		
<i>For 108" wide (108) with 2 cutouts (B) with left cutout (L)</i>		
R	right cutout <input type="checkbox"/>	+\$0
<i>For 108" wide (108) with 2 cutouts (B) with right cutout (R)</i>		
L	left cutout <input type="checkbox"/>	+\$0
Step 10. Technology Integration for Cutout #1		
<i>For 1 cutout (A) or 2 cutouts (B)</i>		
L3	cutout for logic Y1425 3 port <input type="checkbox"/>	+\$65
L5	cutout for logic Y1425 5 port <input type="checkbox"/>	+\$125
TB	cutout for technology bucket <input type="checkbox"/>	+\$190
Step 11. Technology Integration for Cutout #2		
<i>For 2 cutouts (B)</i>		
L3	cutout for logic Y1425 3 port <input type="checkbox"/>	+\$65
L5	cutout for logic Y1425 5 port <input type="checkbox"/>	+\$125
TB	cutout for technology bucket <input type="checkbox"/>	+\$190

Boa Table, Oval, Seated Height

continued

Boa Oval Tables

Step 12.

Top Finish

For high-pressure laminate top/thermoplastic edge (L)

8Q	folkstone grey (CP) <input type="checkbox"/>	+\$0
91	white (CP) <input type="checkbox"/>	+\$0
98	studio white (CP) <input type="checkbox"/>	+\$0
LBA	clear on ash (CP) <input type="checkbox"/>	+\$0
LBB	oak on ash (CP) <input type="checkbox"/>	+\$0
LBC	walnut on ash (CP) <input type="checkbox"/>	+\$0
LBU	medium matte walnut (CP) <input type="checkbox"/>	+\$0
WL	warm stone (CP) <input type="checkbox"/>	+\$0

Top/Edge Finish

For natural veneer top/techwood/veneer edge (W)

652D	whitened quartered oak techwood / low gloss / open pore (CP) <input type="checkbox"/>	+\$0
-------------	---	------

Top/Edge Finish

For natural veneer top/premium techwood/veneer edge (X)

009D	white oak / low gloss / open pore (CP) <input type="checkbox"/>	+\$0
012D	oxford walnut / low gloss / open pore (CP) <input type="checkbox"/>	+\$0

Top/Edge Finish

For premium veneer top/veneer edge (Z)

070D	ebonized oak / low gloss / open pore (CP) <input type="checkbox"/>	+\$0
-------------	--	------

Step 13. Edge Finish

For high-pressure laminate top/thermoplastic edge (L)

8Q	folkstone grey (CP) <input type="checkbox"/>	+\$0
91	white (CP) <input type="checkbox"/>	+\$0
98	studio white (CP) <input type="checkbox"/>	+\$0
LBA	clear on ash (CP) <input type="checkbox"/>	+\$0
LBB	oak on ash (CP) <input type="checkbox"/>	+\$0
LBC	walnut on ash (CP) <input type="checkbox"/>	+\$0
LBU	medium matte walnut (CP) <input type="checkbox"/>	+\$0
WL	warm stone (CP) <input type="checkbox"/>	+\$0

Step 14. Base Finish

Metallic Paint

613	silver (CP) <input type="checkbox"/>	+\$0
------------	--------------------------------------	------

Sand Texture Paint

8Q	folkstone grey (CP) <input type="checkbox"/>	+\$0
91	white (CP) <input type="checkbox"/>	+\$0
98	studio white (CP) <input type="checkbox"/>	+\$0
BK	black <input type="checkbox"/>	+\$0
DN2	nightfall <input type="checkbox"/>	+\$0
DR1	canyon <input type="checkbox"/>	+\$0
OLF	olive <input type="checkbox"/>	+\$0
WL	warm stone (CP) <input type="checkbox"/>	+\$0

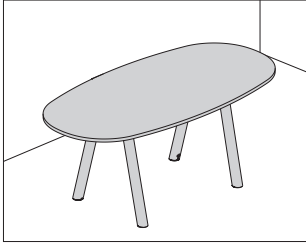

Product Information

Description

This oval counter-height table comes in a squared- or thin-edge style with rounded corners and offers a laminate top with thermoplastic edge, or veneer top with veneer edge. Table may be specified with cutouts to accommodate specific Herman Miller power options, ordered separately. Table comes with $\frac{1}{2}$ " leveling glides. Shipped knocked down.

Notes

Laminate tops 84" to 108" wide have 1-piece construction.

Veneer tops 84" to 96" wide have 1-piece construction.

Veneer tops 108" wide have 2-piece construction.

All tables are supported by 4 column legs inset from the edge. See planning guide for leg placement and clearances.

Cutout will be in the center when specifying 1 cutout (A) in tables 84" to 96" wide.

When specifying cutouts (A, B) in tables 108" wide, cutouts can be located on the left (L), the right (R), or the left and right side(s) of the table. No center cutouts available.

Laminate and veneer tops are $1\frac{1}{4}$ " thick.

Integrated technology cutouts are sized for Logic G1000 grommet mounted power access solutions and the Headway™ technology bucket (DP5B.). See planning guide for specific units that fit in the table.

Order the following compatible power components separately:

- Tech bucket (DP5B.)
- Logic G1000 grommet mounted electrical distributor (Y1425.)

See planning guide for additional information.

Dimensions

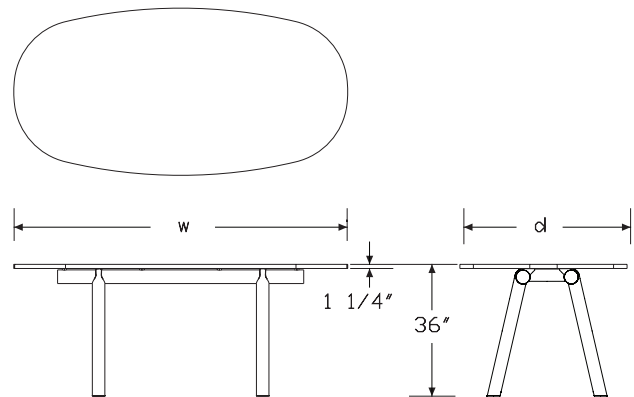

Boa Table, Oval, Counter Height

continued

Boa Oval Tables

Specification Information			
Step 1.			
BQ2B	<input type="checkbox"/>		
Step 2. Edge			
S	squared-edge <input type="checkbox"/>		+\$0
T	thin-edge <input type="checkbox"/>		+\$0
Step 3. Height			
36	36" high <input type="checkbox"/>		+\$0
Step 4. Depth			
42	42" deep <input type="checkbox"/>		+\$0
48	48" deep <input type="checkbox"/>		+\$0
Step 5. Width			
<i>For 42" deep (42)</i>			
84	84" wide <input type="checkbox"/>		+\$5747
96	96" wide <input type="checkbox"/>		+\$6091
108	108" wide <input type="checkbox"/>		+\$6700
<i>For 48" deep (48)</i>			
84	84" wide <input type="checkbox"/>		+\$5919
96	96" wide <input type="checkbox"/>		+\$6274
108	108" wide <input type="checkbox"/>		+\$6901
Step 6. Surface Material			
<i>For squared-edge (S)</i>			
L	high-pressure laminate top/thermoplastic edge <input type="checkbox"/>		+\$0
W	natural veneer top/techwood/veneer edge <input type="checkbox"/>		+\$1482
X	natural veneer top/premium techwood/veneer edge <input type="checkbox"/>		+\$1527
Z	premium veneer top/veneer edge <input type="checkbox"/>		+\$1603
<i>For thin-edge (T)</i>			
L	high-pressure laminate top/thermoplastic edge <input type="checkbox"/>		+\$1392
W	natural veneer top/techwood/veneer edge <input type="checkbox"/>		+\$3482
X	natural veneer top/premium techwood/veneer edge <input type="checkbox"/>		+\$3587
Z	premium veneer top/veneer edge <input type="checkbox"/>		+\$3766
Step 7. Number of Cutouts			
<i>For 84" wide (84) or 96" wide (96)</i>			
N	no cutouts <input type="checkbox"/>		+\$0
A	1 cutout <input type="checkbox"/>		+\$0

<i>For 108" wide (108)</i>			
N	no cutouts <input type="checkbox"/>		+\$0
A	1 cutout <input type="checkbox"/>		+\$0
B	2 cutouts <input type="checkbox"/>		+\$0
Step 8. Cutout #1 Location			
<i>For 84" wide (84) or 96" wide (96) with 1 cutout (A)</i>			
C	center cutout <input type="checkbox"/>		+\$0
<i>For 108" wide (108) with 1 cutout (A) or 2 cutouts (B)</i>			
L	left cutout <input type="checkbox"/>		+\$0
R	right cutout <input type="checkbox"/>		+\$0
Step 9. Cutout #2 Location			
<i>For 108" wide (108) with 2 cutouts (B) with left cutout (L)</i>			
R	right cutout <input type="checkbox"/>		+\$0
<i>For 108" wide (108) with 2 cutouts (B) with right cutout (R)</i>			
L	left cutout <input type="checkbox"/>		+\$0
Step 10. Technology Integration for Cutout #1			
<i>For 1 cutout (A) or 2 cutouts (B)</i>			
L3	cutout for logic Y1425 3 port <input type="checkbox"/>		+\$65
L5	cutout for logic Y1425 5 port <input type="checkbox"/>		+\$125
TB	cutout for technology bucket <input type="checkbox"/>		+\$190
Step 11. Technology Integration for Cutout #2			
<i>For 2 cutouts (B)</i>			
L3	cutout for logic Y1425 3 port <input type="checkbox"/>		+\$65
L5	cutout for logic Y1425 5 port <input type="checkbox"/>		+\$125
TB	cutout for technology bucket <input type="checkbox"/>		+\$190
Step 12.			
Top Finish			
<i>For high-pressure laminate top/thermoplastic edge (L)</i>			
8Q	folkstone grey (CP) <input type="checkbox"/>		+\$0
91	white (CP) <input type="checkbox"/>		+\$0
98	studio white (CP) <input type="checkbox"/>		+\$0
LBA	clear on ash (CP) <input type="checkbox"/>		+\$0
LBB	oak on ash (CP) <input type="checkbox"/>		+\$0
LBC	walnut on ash (CP) <input type="checkbox"/>		+\$0
LBU	medium matte walnut (CP) <input type="checkbox"/>		+\$0
WL	warm stone (CP) <input type="checkbox"/>		+\$0

Boa Table, Oval, Counter Height

continued

Top/Edge Finish

For natural veneer top/techwood/veneer edge (W)

652D	whitened quartered oak techwood / low gloss / open pore (CP) <input type="checkbox"/>	+\$0
-------------	---	------

Top/Edge Finish

For natural veneer top/premium techwood/veneer edge (X)

009D	white oak / low gloss / open pore (CP) <input type="checkbox"/>	+\$0
012D	oxford walnut / low gloss / open pore (CP) <input type="checkbox"/>	+\$0

Top/Edge Finish

For premium veneer top/veneer edge (Z)

070D	ebonized oak / low gloss / open pore (CP) <input type="checkbox"/>	+\$0
-------------	--	------

Step 13. Edge Finish

For high-pressure laminate top/thermoplastic edge (L)

8Q	folkstone grey (CP) <input type="checkbox"/>	+\$0
91	white (CP) <input type="checkbox"/>	+\$0
98	studio white (CP) <input type="checkbox"/>	+\$0
LBA	clear on ash (CP) <input type="checkbox"/>	+\$0
LBB	oak on ash (CP) <input type="checkbox"/>	+\$0
LBC	walnut on ash (CP) <input type="checkbox"/>	+\$0
LBU	medium matte walnut (CP) <input type="checkbox"/>	+\$0
WL	warm stone (CP) <input type="checkbox"/>	+\$0

Step 14. Base Finish

Metallic Paint

613	silver (CP) <input type="checkbox"/>	+\$0
------------	--------------------------------------	------

Sand Texture Paint

8Q	folkstone grey (CP) <input type="checkbox"/>	+\$0
91	white (CP) <input type="checkbox"/>	+\$0
98	studio white (CP) <input type="checkbox"/>	+\$0
BK	black <input type="checkbox"/>	+\$0
DN2	nightfall <input type="checkbox"/>	+\$0
DR1	canyon <input type="checkbox"/>	+\$0
OLF	olive <input type="checkbox"/>	+\$0
WL	warm stone (CP) <input type="checkbox"/>	+\$0

Boa Table, Oval, Standing Height

BQ2CS
BQ2CT

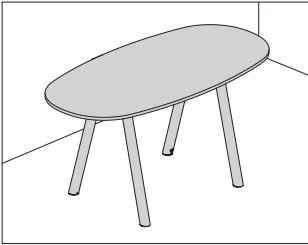

Product Information

Description

This oval standing-height table comes in a squared- or thin-edge style with rounded corners and offers a laminate top with thermoplastic edge, or veneer top with veneer edge. Table may be specified with cutouts to accommodate specific Herman Miller power options, ordered separately. Table comes with 1/2" leveling glides. Shipped knocked down.

Notes

- Laminate tops 84" to 108" wide have 1-piece construction.
- Veneer tops 84" to 96" wide have 1-piece construction.
- Veneer tops 108" wide have 2-piece construction.
- All tables are supported by 4 column legs inset from the edge. See planning guide for leg placement and clearances.
- Cutout will be in the center when specifying 1 cutout (A) in tables 84" to 96" wide.
- When specifying cutouts (A, B) in tables 108" wide, cutouts can be located on the left (L), the right (R), or the left and right side(s) of the table. No center cutouts available.
- Laminate and veneer tops are 1 1/4" thick.
- Integrated technology cutouts are sized for Logic G1000 grommet mounted power access solutions and the Headway™ technology bucket (DP5B.). See planning guide for specific units that fit in the table.
- Order the following compatible power components separately:
- Tech bucket (DP5B.)
 - Logic G1000 grommet mounted electrical distributor (Y1425.)
- See planning guide for additional information.

Dimensions

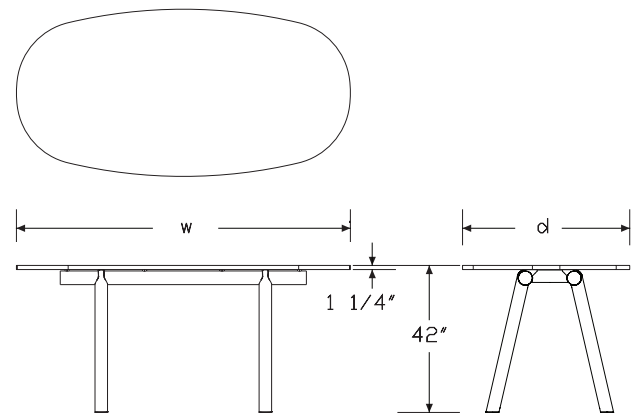

Boa Table, Oval, Standing Height

continued

Specification Information			
Step 1.			
BQ2C	<input type="checkbox"/>		
Step 2. Edge			
S	squared-edge <input type="checkbox"/>		+\$0
T	thin-edge <input type="checkbox"/>		+\$0
Step 3. Height			
42	42" high <input type="checkbox"/>		+\$0
Step 4. Depth			
42	42" deep <input type="checkbox"/>		+\$0
48	48" deep <input type="checkbox"/>		+\$0
Step 5. Width			
For 42" deep (42)			
84	84" wide <input type="checkbox"/>		+\$5919
96	96" wide <input type="checkbox"/>		+\$6274
108	108" wide <input type="checkbox"/>		+\$6901
For 48" deep (48)			
84	84" wide <input type="checkbox"/>		+\$6097
96	96" wide <input type="checkbox"/>		+\$6462
108	108" wide <input type="checkbox"/>		+\$7109
Step 6. Surface Material			
For squared-edge (S)			
L	high-pressure laminate top/thermoplastic edge <input type="checkbox"/>		+\$0
W	natural veneer top/techwood/veneer edge <input type="checkbox"/>		+\$1482
X	natural veneer top/premium techwood/veneer edge <input type="checkbox"/>		+\$1527
Z	premium veneer top/veneer edge <input type="checkbox"/>		+\$1603
For thin-edge (T)			
L	high-pressure laminate top/thermoplastic edge <input type="checkbox"/>		+\$1392
W	natural veneer top/techwood/veneer edge <input type="checkbox"/>		+\$3482
X	natural veneer top/premium techwood/veneer edge <input type="checkbox"/>		+\$3587
Z	premium veneer top/veneer edge <input type="checkbox"/>		+\$3766
Step 7. Number of Cutouts			
For 84" wide (84) or 96" wide (96)			
N	no cutouts <input type="checkbox"/>		+\$0
A	1 cutout <input type="checkbox"/>		+\$0

For 108" wide (108)			
N	no cutouts <input type="checkbox"/>		+\$0
A	1 cutout <input type="checkbox"/>		+\$0
B	2 cutouts <input type="checkbox"/>		+\$0
Step 8. Cutout #1 Location			
For 84" wide (84) or 96" wide (96) with 1 cutout (A)			
C	center cutout <input type="checkbox"/>		+\$0
For 108" wide (108) with 1 cutout (A) or 2 cutouts (B)			
L	left cutout <input type="checkbox"/>		+\$0
R	right cutout <input type="checkbox"/>		+\$0
Step 9. Cutout #2 Location			
For 108" wide (108) with 2 cutouts (B) with left cutout (L)			
R	right cutout <input type="checkbox"/>		+\$0
For 108" wide (108) with 2 cutouts (B) with right cutout (R)			
L	left cutout <input type="checkbox"/>		+\$0
Step 10. Technology Integration for Cutout #1			
For 1 cutout (A) or 2 cutouts (B)			
L3	cutout for logic Y1425 3 port <input type="checkbox"/>		+\$65
L5	cutout for logic Y1425 5 port <input type="checkbox"/>		+\$125
TB	cutout for technology bucket <input type="checkbox"/>		+\$190
Step 11. Technology Integration for Cutout #2			
For 2 cutouts (B)			
L3	cutout for logic Y1425 3 port <input type="checkbox"/>		+\$65
L5	cutout for logic Y1425 5 port <input type="checkbox"/>		+\$125
TB	cutout for technology bucket <input type="checkbox"/>		+\$190
Step 12.			
Top Finish			
For high-pressure laminate top/thermoplastic edge (L)			
8Q	folkstone grey (CP) <input type="checkbox"/>		+\$0
91	white (CP) <input type="checkbox"/>		+\$0
98	studio white (CP) <input type="checkbox"/>		+\$0
LBA	clear on ash (CP) <input type="checkbox"/>		+\$0
LBB	oak on ash (CP) <input type="checkbox"/>		+\$0
LBC	walnut on ash (CP) <input type="checkbox"/>		+\$0
LBU	medium matte walnut (CP) <input type="checkbox"/>		+\$0
WL	warm stone (CP) <input type="checkbox"/>		+\$0

Boa Table, Oval, Standing Height

continued

Boa Oval Tables

Top/Edge Finish

For natural veneer top/techwood/veneer edge (W)

652D	whitened quartered oak techwood / low gloss / open pore (CP) <input type="checkbox"/>	+\$0
-------------	---	------

Top/Edge Finish

For natural veneer top/premium techwood/veneer edge (X)

009D	white oak / low gloss / open pore (CP) <input type="checkbox"/>	+\$0
012D	oxford walnut / low gloss / open pore (CP) <input type="checkbox"/>	+\$0

Top/Edge Finish

For premium veneer top/veneer edge (Z)

070D	ebonized oak / low gloss / open pore (CP) <input type="checkbox"/>	+\$0
-------------	--	------

Step 13. Edge Finish

For high-pressure laminate top/thermoplastic edge (L)

8Q	folkstone grey (CP) <input type="checkbox"/>	+\$0
91	white (CP) <input type="checkbox"/>	+\$0
98	studio white (CP) <input type="checkbox"/>	+\$0
LBA	clear on ash (CP) <input type="checkbox"/>	+\$0
LBB	oak on ash (CP) <input type="checkbox"/>	+\$0
LBC	walnut on ash (CP) <input type="checkbox"/>	+\$0
LBU	medium matte walnut (CP) <input type="checkbox"/>	+\$0
WL	warm stone (CP) <input type="checkbox"/>	+\$0

Step 14. Base Finish

Metallic Paint

613	silver (CP) <input type="checkbox"/>	+\$0
------------	--------------------------------------	------

Sand Texture Paint

8Q	folkstone grey (CP) <input type="checkbox"/>	+\$0
91	white (CP) <input type="checkbox"/>	+\$0
98	studio white (CP) <input type="checkbox"/>	+\$0
BK	black <input type="checkbox"/>	+\$0
DN2	nightfall <input type="checkbox"/>	+\$0
DR1	canyon <input type="checkbox"/>	+\$0
OLF	olive <input type="checkbox"/>	+\$0
WL	warm stone (CP) <input type="checkbox"/>	+\$0

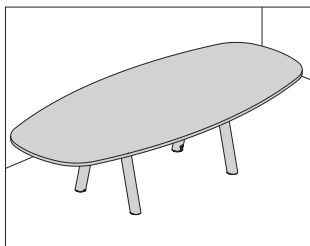

Product Information

Description

This boat-shaped seated-height table comes in a squared- or thin-edge style and offers a laminate top with thermoplastic edge, or veneer top with veneer edge. Table may be specified with cutouts to accommodate specific Herman Miller power options, ordered separately. Table comes with $\frac{1}{2}$ " leveling glides. Shipped knocked down.

Notes

Laminate and veneer tops have 2-piece construction.

All tables are supported by 4 column legs inset from the edge. See planning guide for leg placement and clearances.

When specifying cutouts (A, B) in tables 120" to 168" wide, cutouts can be located on the left (L), the right (R), or the left and right side(s) of the table.

No center cutouts available.

Laminate and veneer tops are $1\frac{1}{4}$ " thick.

Integrated technology cutouts are sized for Logic G1000 grommet mounted power access solutions and the Headway™ technology bucket (DP5B.). See planning guide for specific units that fit in the table.

Order the following compatible power components separately:

- Tech bucket (DP5B.)
- Logic G1000 grommet mounted electrical distributor (Y1425.)

See planning guide for additional information.

Dimensions

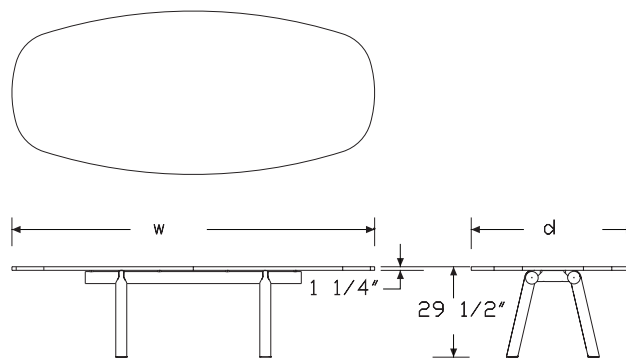

Boa Table, Boat, Seated Height

continued

Boa Boat Tables

Specification Information			
Step 1.			
BQ3A <input type="checkbox"/>			
Step 2. Edge			
S	squared-edge <input type="checkbox"/>		+\$0
T	thin-edge <input type="checkbox"/>		+\$0
Step 3. Height			
29	29.5" high <input type="checkbox"/>		+\$0
Step 4. Depth			
42	42" deep <input type="checkbox"/>		+\$0
48	48" deep <input type="checkbox"/>		+\$0
54	54" deep <input type="checkbox"/>		+\$0
60	60" deep <input type="checkbox"/>		+\$0
Step 5. Width			
<i>For 42" deep (42)</i>			
120	120" wide <input type="checkbox"/>		+\$6947
<i>For 48" deep (48)</i>			
120	120" wide <input type="checkbox"/>		+\$7156
<i>For 54" deep (54)</i>			
120	120" wide <input type="checkbox"/>		+\$7371
132	132" wide <input type="checkbox"/>		+\$8255
144	144" wide <input type="checkbox"/>		+\$9246
156	156" wide <input type="checkbox"/>		+\$10355
168	168" wide <input type="checkbox"/>		+\$11598
<i>For 60" deep (60)</i>			
120	120" wide <input type="checkbox"/>		+\$7582
132	132" wide <input type="checkbox"/>		+\$8503
144	144" wide <input type="checkbox"/>		+\$9523
156	156" wide <input type="checkbox"/>		+\$10666
168	168" wide <input type="checkbox"/>		+\$11946
Step 6. Surface Material			
<i>For squared-edge (S)</i>			
L	high-pressure laminate top/thermoplastic edge <input type="checkbox"/>		+\$0
W	natural veneer top/techwood/veneer edge <input type="checkbox"/>		+\$2903
X	natural veneer top/premium techwood/veneer edge <input type="checkbox"/>		+\$2990
Z	premium veneer top/veneer edge <input type="checkbox"/>		+\$3140

<i>For thin-edge (T)</i>			
L	high-pressure laminate top/thermoplastic edge <input type="checkbox"/>		+\$1744
W	natural veneer top/techwood/veneer edge <input type="checkbox"/>		+\$6670
X	natural veneer top/premium techwood/veneer edge <input type="checkbox"/>		+\$6870
Z	premium veneer top/veneer edge <input type="checkbox"/>		+\$7214
Step 7. Number of Cutouts			
N	no cutouts <input type="checkbox"/>		+\$0
A	1 cutout <input type="checkbox"/>		+\$0
B	2 cutouts <input type="checkbox"/>		+\$0
Step 8. Cutout #1 Location			
<i>For 1 cutout (A) or 2 cutouts (B)</i>			
L	left cutout <input type="checkbox"/>		+\$0
R	right cutout <input type="checkbox"/>		+\$0
Step 9. Cutout #2 Location			
<i>For 2 cutouts (B) with left cutout (L)</i>			
R	right cutout <input type="checkbox"/>		+\$0
<i>For 2 cutouts (B) with right cutout (R)</i>			
L	left cutout <input type="checkbox"/>		+\$0
Step 10. Technology Integration for Cutout #1			
<i>For 1 cutout (A) or 2 cutouts (B)</i>			
L3	cutout for logic Y1425 3 port <input type="checkbox"/>		+\$65
L5	cutout for logic Y1425 5 port <input type="checkbox"/>		+\$125
TB	cutout for technology bucket <input type="checkbox"/>		+\$190
Step 11. Technology Integration for Cutout #2			
<i>For 2 cutouts (B)</i>			
L3	cutout for logic Y1425 3 port <input type="checkbox"/>		+\$65
L5	cutout for logic Y1425 5 port <input type="checkbox"/>		+\$125
TB	cutout for technology bucket <input type="checkbox"/>		+\$190

Boa Table, Boat, Seated Height

continued

Step 12.

Top Finish

For high-pressure laminate top/thermoplastic edge (L)

8Q	folkstone grey (CP) <input type="checkbox"/>	+\$0
91	white (CP) <input type="checkbox"/>	+\$0
98	studio white (CP) <input type="checkbox"/>	+\$0
LBA	clear on ash (CP) <input type="checkbox"/>	+\$0
LBB	oak on ash (CP) <input type="checkbox"/>	+\$0
LBC	walnut on ash (CP) <input type="checkbox"/>	+\$0
LBU	medium matte walnut (CP) <input type="checkbox"/>	+\$0
WL	warm stone (CP) <input type="checkbox"/>	+\$0

Top/Edge Finish

For natural veneer top/techwood/veneer edge (W)

652D	whitened quartered oak techwood / low gloss / open pore (CP) <input type="checkbox"/>	+\$0
-------------	---	------

Top/Edge Finish

For natural veneer top/premium techwood/veneer edge (X)

009D	white oak / low gloss / open pore (CP) <input type="checkbox"/>	+\$0
012D	oxford walnut / low gloss / open pore (CP) <input type="checkbox"/>	+\$0

Top/Edge Finish

For premium veneer top/veneer edge (Z)

070D	ebonized oak / low gloss / open pore (CP) <input type="checkbox"/>	+\$0
-------------	--	------

Step 13. Edge Finish

For high-pressure laminate top/thermoplastic edge (L)

8Q	folkstone grey (CP) <input type="checkbox"/>	+\$0
91	white (CP) <input type="checkbox"/>	+\$0
98	studio white (CP) <input type="checkbox"/>	+\$0
LBA	clear on ash (CP) <input type="checkbox"/>	+\$0
LBB	oak on ash (CP) <input type="checkbox"/>	+\$0
LBC	walnut on ash (CP) <input type="checkbox"/>	+\$0
LBU	medium matte walnut (CP) <input type="checkbox"/>	+\$0
WL	warm stone (CP) <input type="checkbox"/>	+\$0

Step 14. Base Finish

Metallic Paint

613	silver (CP) <input type="checkbox"/>	+\$0
------------	--------------------------------------	------

Sand Texture Paint

8Q	folkstone grey (CP) <input type="checkbox"/>	+\$0
91	white (CP) <input type="checkbox"/>	+\$0
98	studio white (CP) <input type="checkbox"/>	+\$0
BK	black <input type="checkbox"/>	+\$0
DN2	nightfall <input type="checkbox"/>	+\$0
DR1	canyon <input type="checkbox"/>	+\$0
OLF	olive <input type="checkbox"/>	+\$0
WL	warm stone (CP) <input type="checkbox"/>	+\$0

Boa Table, Teardrop, Seated Height

BQ4AS
BQ4AT

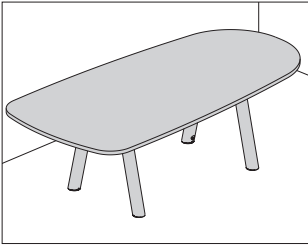

Product Information

Description

This teardrop-shaped seated-height table comes in a squared- or thin-edge style and offers a laminate top with thermoplastic edge, or veneer top with veneer edge. Table may be specified with cutouts to accommodate specific Herman Miller power options, ordered separately. Table comes with 1/2" leveling glides. Shipped knocked down.

Notes

- Laminate tops 84" to 108" wide have 1-piece construction.
- Veneer tops 84" to 96" wide have 1-piece construction.
- Veneer tops 108" wide have 2-piece construction.
- All tables are supported by 4 column legs inset from the edge. See planning guide for leg placement and clearances.
- Cutout will be in the center when specifying 1 cutout (A) in tables 84" to 96" wide.
- When specifying cutouts (A, B) in tables 108" wide, cutouts can be located on the left (L), the right (R), or the left and right side(s) of the table. No center cutouts available.
- Laminate and veneer tops are 1 1/4" thick.
- Integrated technology cutouts are sized for Logic G1000 grommet mounted power access solutions and the Headway™ technology bucket (DP5B.). See planning guide for specific units that fit in the table.
- Order the following compatible power components separately:
- Tech bucket (DP5B.)
 - Logic G1000 grommet mounted electrical distributor (Y1425.)
- See planning guide for additional information.

Dimensions

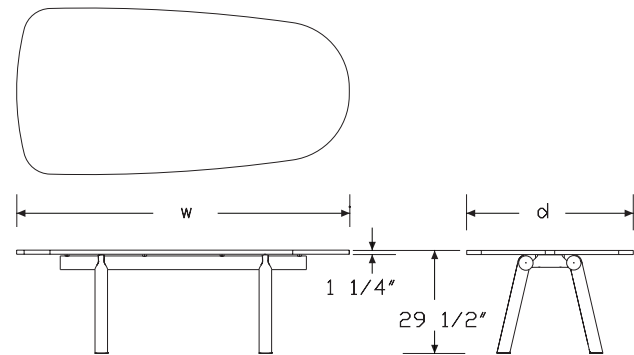

Boa Table, Teardrop, Seated Height

continued

Specification Information			
Step 1.			
BQ4A <input type="checkbox"/>			
Step 2. Edge			
S	squared-edge <input type="checkbox"/>		+\$0
T	thin-edge <input type="checkbox"/>		+\$0
Step 3. Height			
29	29.5" high <input type="checkbox"/>		+\$0
Step 4. Depth			
42	42" deep <input type="checkbox"/>		+\$0
48	48" deep <input type="checkbox"/>		+\$0
54	54" deep <input type="checkbox"/>		+\$0
60	60" deep <input type="checkbox"/>		+\$0
Step 5. Width			
<i>For 42" deep (42)</i>			
84	84" wide <input type="checkbox"/>		+\$5417
96	96" wide <input type="checkbox"/>		+\$5742
108	108" wide <input type="checkbox"/>		+\$6316
<i>For 48" deep (48)</i>			
84	84" wide <input type="checkbox"/>		+\$5579
96	96" wide <input type="checkbox"/>		+\$5914
108	108" wide <input type="checkbox"/>		+\$6505
<i>For 54" deep (54)</i>			
108	108" wide <input type="checkbox"/>		+\$6700
<i>For 60" deep (60)</i>			
108	108" wide <input type="checkbox"/>		+\$6901
Step 6. Surface Material			
<i>For squared-edge (S)</i>			
L	high-pressure laminate top/thermoplastic edge <input type="checkbox"/>		+\$0
W	natural veneer top/techwood/veneer edge <input type="checkbox"/>		+\$1482
X	natural veneer top/premium techwood/veneer edge <input type="checkbox"/>		+\$1527
Z	premium veneer top/veneer edge <input type="checkbox"/>		+\$1603

<i>For thin-edge (T)</i>		
L	high-pressure laminate top/thermoplastic edge <input type="checkbox"/>	+\$1392
W	natural veneer top/techwood/veneer edge <input type="checkbox"/>	+\$3482
X	natural veneer top/premium techwood/veneer edge <input type="checkbox"/>	+\$3587
Z	premium veneer top/veneer edge <input type="checkbox"/>	+\$3766
Step 7. Number of Cutouts		
<i>For 84" wide (84) or 96" wide (96)</i>		
N	no cutouts <input type="checkbox"/>	+\$0
A	1 cutout <input type="checkbox"/>	+\$0
<i>For 108" wide (108)</i>		
N	no cutouts <input type="checkbox"/>	+\$0
A	1 cutout <input type="checkbox"/>	+\$0
B	2 cutouts <input type="checkbox"/>	+\$0
Step 8. Cutout #1 Location		
<i>For 84" wide (84) or 96" wide (96) with 1 cutout (A)</i>		
C	center cutout <input type="checkbox"/>	+\$0
<i>For 108" wide (108) with 1 cutout (A) or 2 cutouts (B)</i>		
L	left cutout <input type="checkbox"/>	+\$0
R	right cutout <input type="checkbox"/>	+\$0
Step 9. Cutout #2 Location		
<i>For 108" wide (108) with 2 cutouts (B) with left cutout (L)</i>		
R	right cutout <input type="checkbox"/>	+\$0
<i>For 108" wide (108) with 2 cutouts (B) with right cutout (R)</i>		
L	left cutout <input type="checkbox"/>	+\$0
Step 10. Technology Integration for Cutout #1		
<i>For 1 cutout (A) or 2 cutouts (B)</i>		
L3	cutout for logic Y1425 3 port <input type="checkbox"/>	+\$65
L5	cutout for logic Y1425 5 port <input type="checkbox"/>	+\$125
TB	cutout for technology bucket <input type="checkbox"/>	+\$190
Step 11. Technology Integration for Cutout #2		
<i>For 2 cutouts (B)</i>		
L3	cutout for logic Y1425 3 port <input type="checkbox"/>	+\$65
L5	cutout for logic Y1425 5 port <input type="checkbox"/>	+\$125
TB	cutout for technology bucket <input type="checkbox"/>	+\$190

Boa Table, Teardrop, Seated Height

continued

Step 12.

Top Finish

For high-pressure laminate top/thermoplastic edge (L)

8Q	folkstone grey (CP) <input type="checkbox"/>	+\$0
91	white (CP) <input type="checkbox"/>	+\$0
98	studio white (CP) <input type="checkbox"/>	+\$0
LBA	clear on ash (CP) <input type="checkbox"/>	+\$0
LBB	oak on ash (CP) <input type="checkbox"/>	+\$0
LBC	walnut on ash (CP) <input type="checkbox"/>	+\$0
LBU	medium matte walnut (CP) <input type="checkbox"/>	+\$0
WL	warm stone (CP) <input type="checkbox"/>	+\$0

Top/Edge Finish

For natural veneer top/techwood/veneer edge (W)

652D	whitened quartered oak techwood / low gloss / open pore (CP) <input type="checkbox"/>	+\$0
-------------	---	------

Top/Edge Finish

For natural veneer top/premium techwood/veneer edge (X)

009D	white oak / low gloss / open pore (CP) <input type="checkbox"/>	+\$0
012D	oxford walnut / low gloss / open pore (CP) <input type="checkbox"/>	+\$0

Top/Edge Finish

For premium veneer top/veneer edge (Z)

070D	ebonized oak / low gloss / open pore (CP) <input type="checkbox"/>	+\$0
-------------	--	------

Step 13. Edge Finish

For high-pressure laminate top/thermoplastic edge (L)

8Q	folkstone grey (CP) <input type="checkbox"/>	+\$0
91	white (CP) <input type="checkbox"/>	+\$0
98	studio white (CP) <input type="checkbox"/>	+\$0
LBA	clear on ash (CP) <input type="checkbox"/>	+\$0
LBB	oak on ash (CP) <input type="checkbox"/>	+\$0
LBC	walnut on ash (CP) <input type="checkbox"/>	+\$0
LBU	medium matte walnut (CP) <input type="checkbox"/>	+\$0
WL	warm stone (CP) <input type="checkbox"/>	+\$0

Step 14. Base Finish

Metallic Paint

613	silver (CP) <input type="checkbox"/>	+\$0
------------	--------------------------------------	------

Sand Texture Paint

8Q	folkstone grey (CP) <input type="checkbox"/>	+\$0
91	white (CP) <input type="checkbox"/>	+\$0
98	studio white (CP) <input type="checkbox"/>	+\$0
BK	black <input type="checkbox"/>	+\$0
DN2	nightfall <input type="checkbox"/>	+\$0
DR1	canyon <input type="checkbox"/>	+\$0
OLF	olive <input type="checkbox"/>	+\$0
WL	warm stone (CP) <input type="checkbox"/>	+\$0

Boa Table, Teardrop, Counter Height

BQ4BS BQ4BT

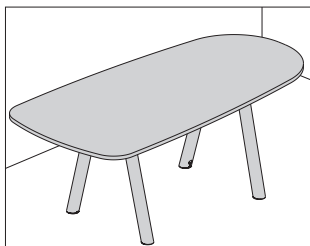

Product Information

Description

This teardrop-shaped counter-height table comes in a squared- or thin-edge style and offers a laminate top with thermoplastic edge, or veneer top with veneer edge. Table may be specified with cutouts to accommodate specific Herman Miller power options, ordered separately. Table comes with 1/2" leveling glides. Shipped knocked down.

Notes

Laminate tops 84" to 108" wide have 1-piece construction.

Veneer tops 84" to 96" wide have 1-piece construction.

Veneer tops 108" wide have 2-piece construction.

All tables are supported by 4 column legs inset from the edge. See planning guide for leg placement and clearances.

Cutout will be in the center when specifying 1 cutout (A) in tables 84" to 96" wide.

When specifying cutouts (A, B) in tables 108" wide, cutouts can be located on the left (L), the right (R), or the left and right side(s) of the table. No center cutouts available.

Laminate and veneer tops are 1 1/4" thick.

Integrated technology cutouts are sized for Logic G1000 grommet mounted power access solutions and the Headway™ technology bucket (DP5B.). See planning guide for specific units that fit in the table.

Order the following compatible power components separately:

- Tech bucket (DP5B.)
- Logic G1000 grommet mounted electrical distributor (Y1425.)

See planning guide for additional information.

Dimensions

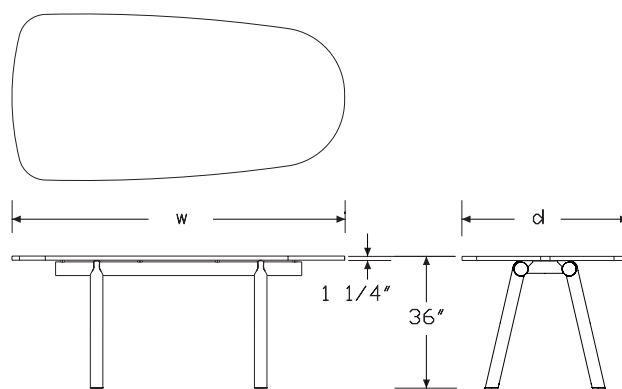

Boa Table, Teardrop, Counter Height

continued

Specification Information			
Step 1.			
BQ4B	<input type="checkbox"/>		
Step 2. Edge			
S	squared-edge <input type="checkbox"/>		+\$0
T	thin-edge <input type="checkbox"/>		+\$0
Step 3. Height			
36	36" high <input type="checkbox"/>		+\$0
Step 4. Depth			
42	42" deep <input type="checkbox"/>		+\$0
48	48" deep <input type="checkbox"/>		+\$0
Step 5. Width			
<i>For 42" deep (42)</i>			
84	84" wide <input type="checkbox"/>		+\$5747
96	96" wide <input type="checkbox"/>		+\$6091
108	108" wide <input type="checkbox"/>		+\$6700
<i>For 48" deep (48)</i>			
84	84" wide <input type="checkbox"/>		+\$5919
96	96" wide <input type="checkbox"/>		+\$6274
108	108" wide <input type="checkbox"/>		+\$6901
Step 6. Surface Material			
<i>For squared-edge (S)</i>			
L	high-pressure laminate top/thermoplastic edge <input type="checkbox"/>		+\$0
W	natural veneer top/techwood/veneer edge <input type="checkbox"/>		+\$1482
X	natural veneer top/premium techwood/veneer edge <input type="checkbox"/>		+\$1527
Z	premium veneer top/veneer edge <input type="checkbox"/>		+\$1603
<i>For thin-edge (T)</i>			
L	high-pressure laminate top/thermoplastic edge <input type="checkbox"/>		+\$1392
W	natural veneer top/techwood/veneer edge <input type="checkbox"/>		+\$3482
X	natural veneer top/premium techwood/veneer edge <input type="checkbox"/>		+\$3587
Z	premium veneer top/veneer edge <input type="checkbox"/>		+\$3766
Step 7. Number of Cutouts			
<i>For 84" wide (84) or 96" wide (96)</i>			
N	no cutouts <input type="checkbox"/>		+\$0
A	1 cutout <input type="checkbox"/>		+\$0

<i>For 108" wide (108)</i>			
N	no cutouts <input type="checkbox"/>		+\$0
A	1 cutout <input type="checkbox"/>		+\$0
B	2 cutouts <input type="checkbox"/>		+\$0
Step 8. Cutout #1 Location			
<i>For 84" wide (84) or 96" wide (96) with 1 cutout (A)</i>			
C	center cutout <input type="checkbox"/>		+\$0
<i>For 108" wide (108) with 1 cutout (A) or 2 cutouts (B)</i>			
L	left cutout <input type="checkbox"/>		+\$0
R	right cutout <input type="checkbox"/>		+\$0
Step 9. Cutout #2 Location			
<i>For 108" wide (108) with 2 cutouts (B) with left cutout (L)</i>			
R	right cutout <input type="checkbox"/>		+\$0
<i>For 108" wide (108) with 2 cutouts (B) with right cutout (R)</i>			
L	left cutout <input type="checkbox"/>		+\$0
Step 10. Technology Integration for Cutout #1			
<i>For 1 cutout (A) or 2 cutouts (B)</i>			
L3	cutout for logic Y1425 3 port <input type="checkbox"/>		+\$65
L5	cutout for logic Y1425 5 port <input type="checkbox"/>		+\$125
TB	cutout for technology bucket <input type="checkbox"/>		+\$190
Step 11. Technology Integration for Cutout #2			
<i>For 2 cutouts (B)</i>			
L3	cutout for logic Y1425 3 port <input type="checkbox"/>		+\$65
L5	cutout for logic Y1425 5 port <input type="checkbox"/>		+\$125
TB	cutout for technology bucket <input type="checkbox"/>		+\$190
Step 12.			
Top Finish			
<i>For high-pressure laminate top/thermoplastic edge (L)</i>			
8Q	folkstone grey (CP) <input type="checkbox"/>		+\$0
91	white (CP) <input type="checkbox"/>		+\$0
98	studio white (CP) <input type="checkbox"/>		+\$0
LBA	clear on ash (CP) <input type="checkbox"/>		+\$0
LBB	oak on ash (CP) <input type="checkbox"/>		+\$0
LBC	walnut on ash (CP) <input type="checkbox"/>		+\$0
LBU	medium matte walnut (CP) <input type="checkbox"/>		+\$0
WL	warm stone (CP) <input type="checkbox"/>		+\$0

Boa Table, Teardrop, Counter Height

continued

Top/Edge Finish

For natural veneer top/techwood/veneer edge (W)

652D	whitened quartered oak techwood / low gloss / open pore (CP) <input type="checkbox"/>	+\$0
-------------	---	------

Top/Edge Finish

For natural veneer top/premium techwood/veneer edge (X)

009D	white oak / low gloss / open pore (CP) <input type="checkbox"/>	+\$0
012D	oxford walnut / low gloss / open pore (CP) <input type="checkbox"/>	+\$0

Top/Edge Finish

For premium veneer top/veneer edge (Z)

070D	ebonized oak / low gloss / open pore (CP) <input type="checkbox"/>	+\$0
-------------	--	------

Step 13. Edge Finish

For high-pressure laminate top/thermoplastic edge (L)

8Q	folkstone grey (CP) <input type="checkbox"/>	+\$0
91	white (CP) <input type="checkbox"/>	+\$0
98	studio white (CP) <input type="checkbox"/>	+\$0
LBA	clear on ash (CP) <input type="checkbox"/>	+\$0
LBB	oak on ash (CP) <input type="checkbox"/>	+\$0
LBC	walnut on ash (CP) <input type="checkbox"/>	+\$0
LBU	medium matte walnut (CP) <input type="checkbox"/>	+\$0
WL	warm stone (CP) <input type="checkbox"/>	+\$0

Step 14. Base Finish

Metallic Paint

613	silver (CP) <input type="checkbox"/>	+\$0
------------	--------------------------------------	------

Sand Texture Paint

8Q	folkstone grey (CP) <input type="checkbox"/>	+\$0
91	white (CP) <input type="checkbox"/>	+\$0
98	studio white (CP) <input type="checkbox"/>	+\$0
BK	black <input type="checkbox"/>	+\$0
DN2	nightfall <input type="checkbox"/>	+\$0
DR1	canyon <input type="checkbox"/>	+\$0
OLF	olive <input type="checkbox"/>	+\$0
WL	warm stone (CP) <input type="checkbox"/>	+\$0

Boa Table, Teardrop, Standing Height

BQ4CS
BQ4CT

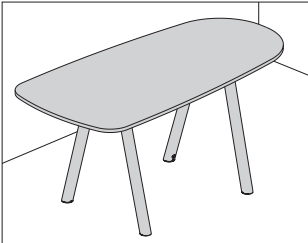

Product Information

Description

This teardrop-shaped standing-height table comes in a squared- or thin-edge style and offers a laminate top with thermoplastic edge, or veneer top with veneer edge. Table may be specified with cutouts to accommodate specific Herman Miller power options, ordered separately. Table comes with 1/2" leveling glides. Shipped knocked down.

Notes

Laminate tops 84" to 108" wide have 1-piece construction.
Veneer tops 84" to 96" wide have 1-piece construction.
Veneer tops 108" wide have 2-piece construction.
All tables are supported by 4 column legs inset from the edge. See planning guide for leg placement and clearances.
Cutout will be in the center when specifying 1 cutout (A) in tables 84" to 96" wide.
When specifying cutouts (A, B) in tables 108" wide, cutouts can be located on the left (L), the right (R), or the left and right side(s) of the table. No center cutouts available.
Laminate and veneer tops are 1 1/4" thick.
Integrated technology cutouts are sized for Logic G1000 grommet mounted power access solutions and the Headway™ technology bucket (DP5B.). See planning guide for specific units that fit in the table.
Order the following compatible power components separately:
• Tech bucket (DP5B.)
• Logic G1000 grommet mounted electrical distributor (Y1425.)
See planning guide for additional information.

Dimensions

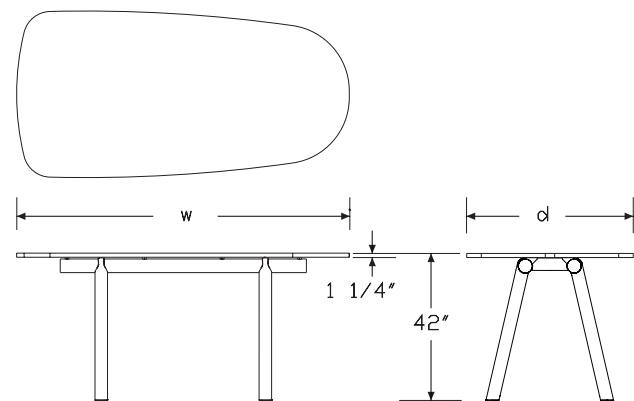

Boa Table, Teardrop, Standing Height

continued

Specification Information			
Step 1.			
BQ4C	<input type="checkbox"/>		
Step 2. Edge			
S	squared-edge <input type="checkbox"/>		+\$0
T	thin-edge <input type="checkbox"/>		+\$0
Step 3. Height			
42	42" high <input type="checkbox"/>		+\$0
Step 4. Depth			
42	42" deep <input type="checkbox"/>		+\$0
48	48" deep <input type="checkbox"/>		+\$0
Step 5. Width			
For 42" deep (42)			
84	84" wide <input type="checkbox"/>		+\$5919
96	96" wide <input type="checkbox"/>		+\$6274
108	108" wide <input type="checkbox"/>		+\$6901
For 48" deep (48)			
84	84" wide <input type="checkbox"/>		+\$6097
96	96" wide <input type="checkbox"/>		+\$6462
108	108" wide <input type="checkbox"/>		+\$7109
Step 6. Surface Material			
For squared-edge (S)			
L	high-pressure laminate top/thermoplastic edge <input type="checkbox"/>		+\$0
W	natural veneer top/techwood/veneer edge <input type="checkbox"/>		+\$1482
X	natural veneer top/premium techwood/veneer edge <input type="checkbox"/>		+\$1527
Z	premium veneer top/veneer edge <input type="checkbox"/>		+\$1603
For thin-edge (T)			
L	high-pressure laminate top/thermoplastic edge <input type="checkbox"/>		+\$1392
W	natural veneer top/techwood/veneer edge <input type="checkbox"/>		+\$3482
X	natural veneer top/premium techwood/veneer edge <input type="checkbox"/>		+\$3587
Z	premium veneer top/veneer edge <input type="checkbox"/>		+\$3766
Step 7. Number of Cutouts			
For 84" wide (84) or 96" wide (96)			
N	no cutouts <input type="checkbox"/>		+\$0
A	1 cutout <input type="checkbox"/>		+\$0

For 108" wide (108)			
N	no cutouts <input type="checkbox"/>		+\$0
A	1 cutout <input type="checkbox"/>		+\$0
B	2 cutouts <input type="checkbox"/>		+\$0
Step 8. Cutout #1 Location			
For 84" wide (84) or 96" wide (96) with 1 cutout (A)			
C	center cutout <input type="checkbox"/>		+\$0
For 108" wide (108) with 1 cutout (A) or 2 cutouts (B)			
L	left cutout <input type="checkbox"/>		+\$0
R	right cutout <input type="checkbox"/>		+\$0
Step 9. Cutout #2 Location			
For 108" wide (108) with 2 cutouts (B) with left cutout (L)			
R	right cutout <input type="checkbox"/>		+\$0
For 108" wide (108) with 2 cutouts (B) with right cutout (R)			
L	left cutout <input type="checkbox"/>		+\$0
Step 10. Technology Integration for Cutout #1			
For 1 cutout (A) or 2 cutouts (B)			
L3	cutout for logic Y1425 3 port <input type="checkbox"/>		+\$65
L5	cutout for logic Y1425 5 port <input type="checkbox"/>		+\$125
TB	cutout for technology bucket <input type="checkbox"/>		+\$190
Step 11. Technology Integration for Cutout #2			
For 2 cutouts (B)			
L3	cutout for logic Y1425 3 port <input type="checkbox"/>		+\$65
L5	cutout for logic Y1425 5 port <input type="checkbox"/>		+\$125
TB	cutout for technology bucket <input type="checkbox"/>		+\$190
Step 12.			
Top Finish			
For high-pressure laminate top/thermoplastic edge (L)			
8Q	folkstone grey (CP) <input type="checkbox"/>		+\$0
91	white (CP) <input type="checkbox"/>		+\$0
98	studio white (CP) <input type="checkbox"/>		+\$0
LBA	clear on ash (CP) <input type="checkbox"/>		+\$0
LBB	oak on ash (CP) <input type="checkbox"/>		+\$0
LBC	walnut on ash (CP) <input type="checkbox"/>		+\$0
LBU	medium matte walnut (CP) <input type="checkbox"/>		+\$0
WL	warm stone (CP) <input type="checkbox"/>		+\$0

Boa Table, Teardrop, Standing Height

continued

Top/Edge Finish

For natural veneer top/techwood/veneer edge (W)

652D	whitened quartered oak techwood / low gloss / open pore (CP) <input type="checkbox"/>	+\$0
-------------	---	------

Top/Edge Finish

For natural veneer top/premium techwood/veneer edge (X)

009D	white oak / low gloss / open pore (CP) <input type="checkbox"/>	+\$0
012D	oxford walnut / low gloss / open pore (CP) <input type="checkbox"/>	+\$0

Top/Edge Finish

For premium veneer top/veneer edge (Z)

070D	ebonized oak / low gloss / open pore (CP) <input type="checkbox"/>	+\$0
-------------	--	------

Step 13. Edge Finish

For high-pressure laminate top/thermoplastic edge (L)

8Q	folkstone grey (CP) <input type="checkbox"/>	+\$0
91	white (CP) <input type="checkbox"/>	+\$0
98	studio white (CP) <input type="checkbox"/>	+\$0
LBA	clear on ash (CP) <input type="checkbox"/>	+\$0
LBB	oak on ash (CP) <input type="checkbox"/>	+\$0
LBC	walnut on ash (CP) <input type="checkbox"/>	+\$0
LBU	medium matte walnut (CP) <input type="checkbox"/>	+\$0
WL	warm stone (CP) <input type="checkbox"/>	+\$0

Step 14. Base Finish

Metallic Paint

613	silver (CP) <input type="checkbox"/>	+\$0
------------	--------------------------------------	------

Sand Texture Paint

8Q	folkstone grey (CP) <input type="checkbox"/>	+\$0
91	white (CP) <input type="checkbox"/>	+\$0
98	studio white (CP) <input type="checkbox"/>	+\$0
BK	black <input type="checkbox"/>	+\$0
DN2	nightfall <input type="checkbox"/>	+\$0
DR1	canyon <input type="checkbox"/>	+\$0
OLF	olive <input type="checkbox"/>	+\$0
WL	warm stone (CP) <input type="checkbox"/>	+\$0

Boa Table, Tapered, Seated Height

BQ5AS
BQ5AT

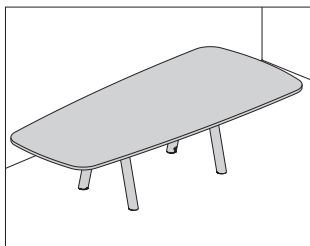

Product Information

Description

This tapered seated-height table comes in a squared- or thin-edge style and offers a laminate top with thermoplastic edge, or veneer top with veneer edge. Table may be specified with cutouts to accommodate specific Herman Miller power options, ordered separately. Table comes with 1/2" leveling glides. Shipped knocked down.

Notes

Laminate tops 120" wide have 1-piece construction.

Laminate tops 132" to 168" wide have 2-piece construction.

Veneer tops 120" to 168" wide have 2-piece construction.

All tables are supported by 4 column legs inset from the edge. See planning guide for leg placement and clearances.

When specifying cutouts (A, B) in tables 120" to 168" wide, cutouts can be located on the left (L), the right (R), or the left and right side(s) of the table.

No center cutouts available.

Laminate and veneer tops are 1 1/4" thick.

Integrated technology cutouts are sized for Logic G1000 grommet mounted power access solutions and the Headway™ technology bucket (DP5B.). See planning guide for specific units that fit in the table.

Order the following compatible power components separately:

- Tech bucket (DP5B.)
- Logic G1000 grommet mounted electrical distributor (Y1425.)

See planning guide for additional information.

Dimensions

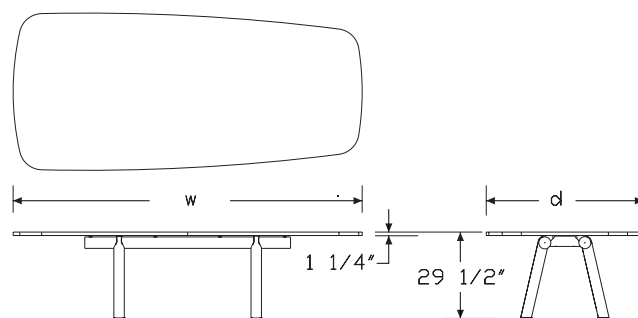

Boa Tapered Tables

Boa Table, Tapered, Seated Height

continued

Boa Tapered Tables

Specification Information			
Step 1.			
BQ5A <input type="checkbox"/>			
Step 2. Edge			
S	squared-edge <input type="checkbox"/>		+\$0
T	thin-edge <input type="checkbox"/>		+\$0
Step 3. Height			
29	29.5" high <input type="checkbox"/>		+\$0
Step 4. Depth			
42	42" deep <input type="checkbox"/>		+\$0
48	48" deep <input type="checkbox"/>		+\$0
54	54" deep <input type="checkbox"/>		+\$0
60	60" deep <input type="checkbox"/>		+\$0
Step 5. Width			
<i>For 42" deep (42)</i>			
120	120" wide <input type="checkbox"/>		+\$6947
<i>For 48" deep (48)</i>			
120	120" wide <input type="checkbox"/>		+\$7156
<i>For 54" deep (54)</i>			
120	120" wide <input type="checkbox"/>		+\$7371
132	132" wide <input type="checkbox"/>		+\$8255
144	144" wide <input type="checkbox"/>		+\$9246
156	156" wide <input type="checkbox"/>		+\$10355
168	168" wide <input type="checkbox"/>		+\$11598
<i>For 60" deep (60)</i>			
120	120" wide <input type="checkbox"/>		+\$7592
132	132" wide <input type="checkbox"/>		+\$8503
144	144" wide <input type="checkbox"/>		+\$9523
156	156" wide <input type="checkbox"/>		+\$10666
168	168" wide <input type="checkbox"/>		+\$11946
Step 6. Surface Material			
<i>For squared-edge (S)</i>			
L	high-pressure laminate top/thermoplastic edge <input type="checkbox"/>		+\$0
W	natural veneer top/techwood/veneer edge <input type="checkbox"/>		+\$2903
X	natural veneer top/premium techwood/veneer edge <input type="checkbox"/>		+\$2990
Z	premium veneer top/veneer edge <input type="checkbox"/>		+\$3140

<i>For thin-edge (T)</i>			
L	high-pressure laminate top/thermoplastic edge <input type="checkbox"/>		+\$1744
W	natural veneer top/techwood/veneer edge <input type="checkbox"/>		+\$6670
X	natural veneer top/premium techwood/veneer edge <input type="checkbox"/>		+\$6870
Z	premium veneer top/veneer edge <input type="checkbox"/>		+\$7214
Step 7. Number of Cutouts			
N	no cutouts <input type="checkbox"/>		+\$0
A	1 cutout <input type="checkbox"/>		+\$0
B	2 cutouts <input type="checkbox"/>		+\$0
Step 8. Cutout #1 Location			
<i>For 1 cutout (A) or 2 cutouts (B)</i>			
L	left cutout <input type="checkbox"/>		+\$0
R	right cutout <input type="checkbox"/>		+\$0
Step 9. Cutout #2 Location			
<i>For 2 cutouts (B) with left cutout (L)</i>			
R	right cutout <input type="checkbox"/>		+\$0
<i>For 2 cutouts (B) with right cutout (R)</i>			
L	left cutout <input type="checkbox"/>		+\$0
Step 10. Technology Integration for Cutout #1			
<i>For 1 cutout (A) or 2 cutouts (B)</i>			
L3	cutout for logic Y1425 3 port <input type="checkbox"/>		+\$65
L5	cutout for logic Y1425 5 port <input type="checkbox"/>		+\$125
TB	cutout for technology bucket <input type="checkbox"/>		+\$190
Step 11. Technology Integration for Cutout #2			
<i>For 2 cutouts (B)</i>			
L3	cutout for logic Y1425 3 port <input type="checkbox"/>		+\$65
L5	cutout for logic Y1425 5 port <input type="checkbox"/>		+\$125
TB	cutout for technology bucket <input type="checkbox"/>		+\$190

Boa Table, Tapered, Seated Height

continued

Step 12.

Top Finish

For high-pressure laminate top/thermoplastic edge (L)

8Q	folkstone grey (CP) <input type="checkbox"/>	+\$0
91	white (CP) <input type="checkbox"/>	+\$0
98	studio white (CP) <input type="checkbox"/>	+\$0
LBA	clear on ash (CP) <input type="checkbox"/>	+\$0
LBB	oak on ash (CP) <input type="checkbox"/>	+\$0
LBC	walnut on ash (CP) <input type="checkbox"/>	+\$0
LBU	medium matte walnut (CP) <input type="checkbox"/>	+\$0
WL	warm stone (CP) <input type="checkbox"/>	+\$0

Top/Edge Finish

For natural veneer top/techwood/veneer edge (W)

652D	whitened quartered oak techwood / low gloss / open pore (CP) <input type="checkbox"/>	+\$0
-------------	---	------

Top/Edge Finish

For natural veneer top/premium techwood/veneer edge (X)

009D	white oak / low gloss / open pore (CP) <input type="checkbox"/>	+\$0
012D	oxford walnut / low gloss / open pore (CP) <input type="checkbox"/>	+\$0

Top/Edge Finish

For premium veneer top/veneer edge (Z)

070D	ebonized oak / low gloss / open pore (CP) <input type="checkbox"/>	+\$0
-------------	--	------

Step 13. Edge Finish

For high-pressure laminate top/thermoplastic edge (L)

8Q	folkstone grey (CP) <input type="checkbox"/>	+\$0
91	white (CP) <input type="checkbox"/>	+\$0
98	studio white (CP) <input type="checkbox"/>	+\$0
LBA	clear on ash (CP) <input type="checkbox"/>	+\$0
LBB	oak on ash (CP) <input type="checkbox"/>	+\$0
LBC	walnut on ash (CP) <input type="checkbox"/>	+\$0
LBU	medium matte walnut (CP) <input type="checkbox"/>	+\$0
WL	warm stone (CP) <input type="checkbox"/>	+\$0

Step 14. Base Finish

Metallic Paint

613	silver (CP) <input type="checkbox"/>	+\$0
------------	--------------------------------------	------

Sand Texture Paint

8Q	folkstone grey (CP) <input type="checkbox"/>	+\$0
91	white (CP) <input type="checkbox"/>	+\$0
98	studio white (CP) <input type="checkbox"/>	+\$0
BK	black <input type="checkbox"/>	+\$0
DN2	nightfall <input type="checkbox"/>	+\$0
DR1	canyon <input type="checkbox"/>	+\$0
OLF	olive <input type="checkbox"/>	+\$0
WL	warm stone (CP) <input type="checkbox"/>	+\$0

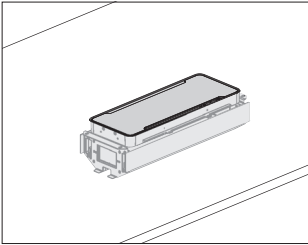

Product Information

Description

This tech bucket is grommet mounted in Headway™ cabinet-base and Y-base tables to conceal cords off the table surface. It can be customized with faceplates to accommodate hard-wired power and data needs. It has 4 pass-through openings for data cords to be routed into the bucket. Lid opens toward either side of the table and pivots 95° from closed to open allowing easy access to the bucket. Bucket is black. Lid comes in a choice of finishes.

Notes

Tech bucket has knockouts at both ends to allow for data faceplates. See [planning guide for specific knockout dimensions](#).
For Chicago power, specify the tech bucket and hardwire in a junction box. A licensed electrician must wire junction box to the building's electrical supply.

Dimensions

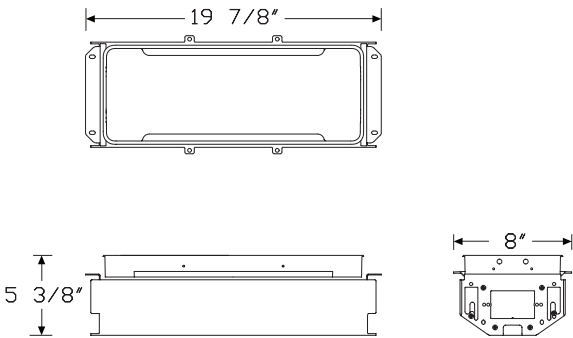

Specification Information

Step 1.

DP5B.

\$767

Step 2. Lid Finish

91	white (CP)	+\$0
98	studio white (CP)	+\$0
G1	graphite (CP)	+\$0
UBK	ultra black (CP)	+\$0

Headway™ Power Module for Tech Bucket

DP6B.

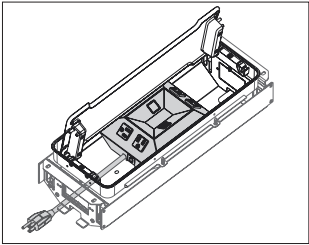

Product Information

Description

This power module mounts inside of the tech bucket. It comes with 4 AC simplex receptacles and has the option of 4 USB (2 Type-A, 2 Type-C). The module is powered using a standard power cord with plug end. Power module finish is black. Product is UL Listed. Attachment hardware included.

Notes

USB Type-A ports supply up to 10 watts of power, and USB Type-C ports supply up to 15 watts of power for charging most devices such as tablets and phones. Smart Power Sharing limits Type-A port to 5 watts when USB-C port is in use.

Order the tech bucket (DP5B.) separately.

Dimensions

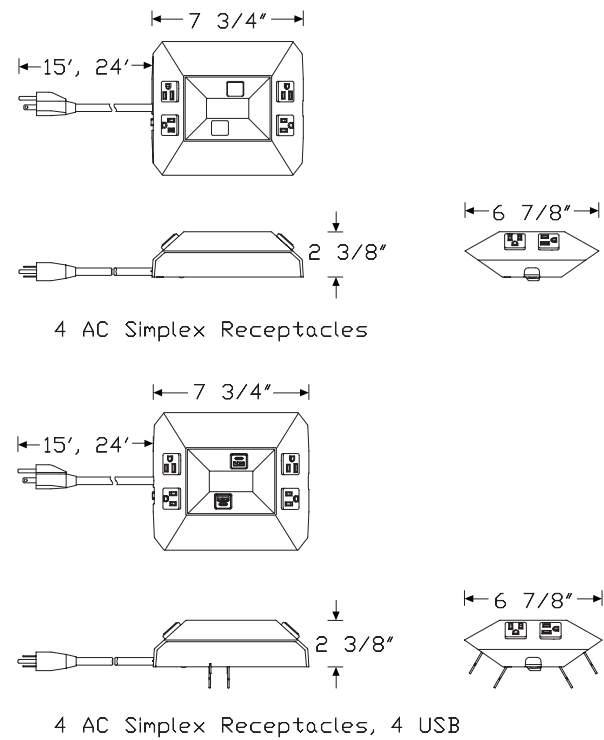

Specification Information			
Step 1.			
DP6B.			
Step 2. Configuration			
A	4 AC simplex receptacles		
B	4 AC simplex receptacles, 4 USB (2 Type-A, 2 Type C)		
Step 3. Cord Length			
15	15' long		
24	24' long		
Prices for Steps 1-3.			
		15	24
DP6B.	A	\$715	815
	B	\$1549	1655

Technology/Accessories

Logic G1000 Grommet Mounted Electrical Distributor

Y1425.

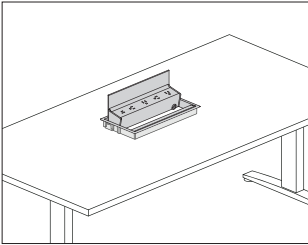

Product Information

Description

This Logic Power Access Solutions™ grommet mounted electrical distributor comes in several widths and configurations of simplex receptacles and USB-A and USB-C charging ports. The unit is powered using a standard power cord with plug end, or an IEC connector when used with Renew™ Sit-to-Stand tables. An integrated cord keeper at the face of the unit captures data cords. The unit pivots from a closed position to 135° allowing easy access to power and data cords stored beneath the unit. Product is UL listed.

Notes

Field cutting of grommet cutout is possible.

IEC connector for Renew power type (C) includes short cord designed to connect to the Renew table power cord through-leg option. Actual cord length may vary.

Simplex receptacles have alternating orientation and greater than normal plug spacing to accommodate most plug types.

USB ports provide a combined 20 watts of power to charge most devices and tablets at full speed. USB-C provides 15 watts of power and USB-A provides 10 watts of power individually. When using the USB-C and USB-A ports simultaneously, USB-C remains at 15 watts and USB-A reduces to 5 watts. Refer to Renew Sit-to-Stand Tables planning guide for specific application information.

20' cord/conduit length (20) is recommended for Exclave® applications.

Dimensions

2 simplex receptacles with 1 powered USB A/C combo (H)

4 simplex receptacles with 1 powered USB A/C combo (I)

3 simplex receptacles (E)

5 simplex receptacles (F)

Logic G1000 Grommet Mounted Electrical Distributor *continued*

Specification Information

Step 1.

Y1425.

Step 2. Configuration

H 2 simplex receptacles, 1 powered USB A/C Combo

I 4 simplex receptacles, 1 powered USB A/C Combo

E 3 simplex receptacles

F 5 simplex receptacles

Step 3. Power Type

A power cord with plug end

C IEC connector for Renew Tables

Step 4. Cord Length

For power cord with plug end (A)

03 3' cord

06 6' cord

10 10' cord

20 20' cord

For IEC connector for Renew Tables (C)

03 3' cord

Prices for Steps 1-4.

		03	06	10	20
Y1425.	H A	\$943	943	958	974
	C	\$958	—	—	—
	I A	\$1092	1092	1110	1126
	C	\$1110	—	—	—
	E A	\$726	726	740	753
	C	\$740	—	—	—
	F A	\$876	876	892	909
	C	\$892	—	—	—

Step 5. Finish

613	silver (CP)	+\$0
91	white (CP) <input type="checkbox"/>	+\$0
98	studio white (CP) <input type="checkbox"/>	+\$0
G1	graphite (CP) <input type="checkbox"/>	+\$0
UBK	ultra black (CP)	+\$0

Index by Product Name

Boa Tables	
Boa Table, Boat, Seated Height	page(s) 23
Boa Table, Oval, Counter Height	17
Boa Table, Oval, Seated Height	14
Boa Table, Oval, Standing Height	20
Boa Table, Rectangle, Counter Height	8
Boa Table, Rectangle, Seated Height	5
Boa Table, Rectangle, Standing Height	11
Boa Table, Tapered, Seated Height	35
Boa Table, Teardrop, Counter Height	29
Boa Table, Teardrop, Seated Height	26
Boa Table, Teardrop, Standing Height	32
Headway™ Power Module for Tech Bucket	39
Headway™ Tech Bucket	38
Logic G1000 Grommet Mounted Electrical Distributor	40



Index by Product Number



BQ1AS	Boa Table, Rectangle, Seated Height	page(s) 5
BQ1AT		
BQ1BS	Boa Table, Rectangle, Counter Height	8
BQ1BT		
BQ1CS	Boa Table, Rectangle, Standing Height	11
BQ1CT		
BQ2AS	Boa Table, Oval, Seated Height	14
BQ2AT		
BQ2BS	Boa Table, Oval, Counter Height	17
BQ2BT		
BQ2CS	Boa Table, Oval, Standing Height	20
BQ2CT		
BQ3AS	Boa Table, Boat, Seated Height	23
BQ3AT		
BQ4AS	Boa Table, Teardrop, Seated Height	26
BQ4AT		
BQ4BS	Boa Table, Teardrop, Counter Height	29
BQ4BT		
BQ4CS	Boa Table, Teardrop, Standing Height	32
BQ4CT		
BQ5AS	Boa Table, Tapered, Seated Height	35
BQ5AT		
DP5B.	Headway™ Tech Bucket	38
DP6B.	Headway™ Power Module for Tech Bucket	39
Y1425.	Logic G1000 Grommet Mounted Electrical Distributor	40



20-Day or Less/Assigned Lead-Time Order Information

20-Day or Less and Assigned Lead-Time Programs

20-day or less and assigned lead-time products are designed for established Herman Miller dealers with pre-approved credit.

Products are distributed from multiple manufacturing facilities across the United States. All products and options not designated by an Assigned Lead-Time icon  will ship in 20 business days or less after being acknowledged by Herman Miller. Products and options designated by an  are on the assigned lead-time program and will ship in 20 days, less than 20 days, or more than 20 days from order acknowledgement.

Ordering Procedure

Please place orders through Order Manager. If this is not available to you, place orders through mail or fax. Verbal purchase orders will not be accepted.

Order Entry fax number for Meridian®

Filing and Storage: (616) 846 9236.

Order Entry fax number for all other products:

(616) 654 3085.

For more information, contact your Customer Care representative at: (866) 854 3048 ext 3400.

Shipments and Delivery

Per Herman Miller Terms and Conditions.

Changes and Cancellation

Per Herman Miller Terms and Conditions.



Central Palette Overview

Central Palette

Program Overview

The Central Palette is the result of an intentional effort to integrate future design direction, field insights, and long-term business strategy. The palette provides a foundation of design continuity between Herman Miller and Knoll products, while each brand retains their distinct colors, materials, and finishes.

A centralized palette allows designers to create a greater variety of cross-branded premium workplace solutions at a variety of price points.

Finishes

A consolidation of like colors focused in the neutral color space. Painted and plastic components within the palette meet consistent performance and aesthetic criteria, allowing for improved efficiency and reliability.

Paint & Plastic:

8Q Folkstone Grey
91 White
98 Studio White
CRB Carbon
G1 Graphite
UBK Ultra Black
WL Warm Stone

Metallics:

611 Beige Mist Metallic
613 Silver

Laminate

The following solid color and woodgrain laminates will be available in high pressure (HPL) and thermally fused (TFL) versions with coordinating edgbands to support both brands of products.

Solid Color:

8Q Folkstone Grey
91 White
98 Studio White
UBK Ultra Black
WL Warm Stone

Woodgrain:

125 Natural Maple
126 Natural Cherry
127 Walnut
139 Light Ash
140 Warm Ash
LBA Clear on Ash *
LBB Oak on Ash *
LBC Walnut on Ash *
LBU Medium Matte Walnut

Matte:

NSD Celestial Grey
NSJ Asteroid Grey
NSK Nebula Black

* HPL features a woodgrain textured surface; TFL (Melamine) has a smooth surface.

Veneer

The following veneers will be available in aligned gloss and pore options across workspace products for Knoll and Herman Miller.

Techwood:

639 Light Cherry Techwood
651 Soft Grey Techwood
652 Whitened Quartered Oak Techwood
658 Clear Techwood
683 Soft Walnut Techwood
684 Dark Umber Techwood

Natural Veneer & Premium Techwood:

008 Blonde Oak
009 White Oak
010 Golden Oak
012 Oxford Walnut
016 Umber on Oak
017 Light Walnut
021 Peacock Green Walnut
653 Vivid Oak Techwood
659 Brushed Teak Techwood
660 White Maple Techwood
670 Deep Rosewood Techwood

Premium Veneer:

070 Ebonized Oak

Gloss & Pore Options include:

A - low gloss/closed pore
B - medium gloss/closed pore
C - high gloss/closed pore
D - low gloss/open pore
E - medium gloss/open pore
F - high gloss/open pore

Textiles

Textiles are not yet part of the Central Palette program. Refer to the COM Database for Textiles approved on products from various MillerKnoll Brands.

For more information about our products and services or to see a list of dealers, please visit us at HermanMiller.com or call (800) 851 1196.

© 2025 Herman Miller, Inc., Zeeland, Michigan

Distribution Rights

Working together since 1956, Herman Miller and Vitra are the authentic sources of designs by Charles and Ray Eames, Alexander Girard, and George Nelson. All the designs shown in this book are protected by law. Herman Miller has obtained all rights to make and sell these designs. Also, Herman Miller holds exclusive worldwide manufacturing and distribution rights for these products with the following exceptions:

Charles and Ray Eames, George Nelson, and Alexander Girard—Worldwide distribution rights for furniture in all areas except Europe and the Middle East. For those areas, please contact Vitra.

Isamu Noguchi—Worldwide distribution rights for the Noguchi Rudder Table. Distribution rights for the Noguchi Table in North America and Central America only. For all other areas, please contact Vitra.

Magis—Exclusive distribution rights in the US and Canada. For all other areas, please contact Magis.

® **HermanMiller**, ●, 3D Intelligent, 8Z Pellicle, AO, Action Office, Aeron, Aside, Bubble Lamps, Canvas Office Landscape, Caper, Celle, Cosm, Co/Struc, Daisyone, Distil, Eames, Eco-Dematerialized, Embody, Envelop, Ethospace, Exclave, Fine-Tune, FlexFront, Flo, Formcoat, Formwork, Ground Cloth, Intent, Kinemat, Layout Studio, Lino, Live Unframed, Living Office, Maharam, Meridian, Mirra, Motia, Nelson, Pari, Pellicle, Perspectives, Plex, PostureFit, PostureFit SL, Public Office Landscape, Sayl, Setu, Striad, Tu, Ubi, Verus, Wishbone, Y-Tower and Zeph are among the registered trademarks of Herman Miller, Inc., and its owned subsidiaries.

™ About Face, AireWeave, Airia, Ambit, Asari Chair by HermanMiller, Backfit, Bubbletack, Burdick Group, Butterfly Back, Canvas Vista, Cellular Suspension, Commend, Compass, Connect, DOT, Duracare, Durawrap, EnhancedAccess, Everywhere, Flex-Edge, Flute, Harmonic, Headway, Herman Miller Select, Hopsak 2, Iota, Keyless Entry, Latitude, Logic Mini, Logic Power Access Solutions, Lyris, Lyris 2, Made-to-Measure Storage, Mora, Multiscrim, Nevi, OE1, OE1 Workspace Collection, Overlay, Pixelated Support, Pronta, Renew, Sense, Soft Pad, Stackable, Stackable Storage, Swoop, Thrive, Tone, TriFlex, Twist and Wireframe are among the trademarks of Herman Miller, Inc., and its owned subsidiaries.

SM Herman Miller Options is among the service marks of Herman Miller, Inc.

AAP™ is a trademark of Extron Electronics.

Alexander Girard® is a registered trademark of The Alexander Girard Estate.

Chemsurf® is a registered trademark of Wilsonart International.

Corian® is a registered trademark of E. I. du Pont de Nemours and Company Corporation.

Crypton® is a registered trademark of Crypton, Inc.

DACRON® is a registered trademark of INVISTA S.a r.l.

Danzer® is a registered trademark of Danzer Holding AG.

Decora® is a registered trademark of Leviton Manufacturing Co., Inc.

Edelman® Leather is a registered trademark of Edelman Leather, Inc.

Extron® is a registered trademark of RGB Systems, Inc.

FENIX NTM® is a registered trademark of Arpa Industriale S.p.A.

FLEXNET™ is a trademark of Milliken & Company.

Floor Saver Glide® is a registered trademark of Carpin Manufacturing, Inc.

Forest Stewardship Council® is a registered trademark of the Forest Stewardship Council A.C. (FSC). We are FSC® certified (FSC® C102895).

FSC® is a registered trademark of the Forest Stewardship Council A.C. (FSC).

Geiger® is a registered trademark, and Bumper™, Saiba™, and Ward Bennett™ are trademarks, of Geiger International.

Hang-It-All® is a registered trademark of Lucia Eames Demetrios, d.b.a. Eames Office.

Holophane® is a registered trademark of Holophane.

Ingeo™ is a trademark of Cargill Dow LLC.

iPad® and Mac mini® are registered trademarks of Apple Inc.

Leviton® is a registered trademark of Leviton Manufacturing Co., Inc.

LifeSize® is a registered trademark of LifeSize Communications, Inc.

Lisocore® is a registered trademark of Pyrus Panels GmbH.

Logitech G® is a registered trademark of Logitech International S.A.

Magis®, Bombo®, and Me Too® are registered trademarks of Magis S.p.A.

MicrobeCare™ is a trademark of Parasol Medical LLC.

Microsoft® and Natural® Keyboard are registered trademarks of Microsoft Corporation.

Noguchi® and the Noguchi table configuration (trade dress) are registered trademarks, and Rudder Table™ is a trademark, of The Isamu Noguchi Foundation and Garden Museum.

Place Textiles® is a registered trademark of Place Textiles.

Sunbrella® is a registered trademark of Glen Raven, Inc.

SuperSeat™ is a trademark of Dahti Seating, a division of ITW.

Valor™ is among the trademarks owned by Nemschoff, Inc.