

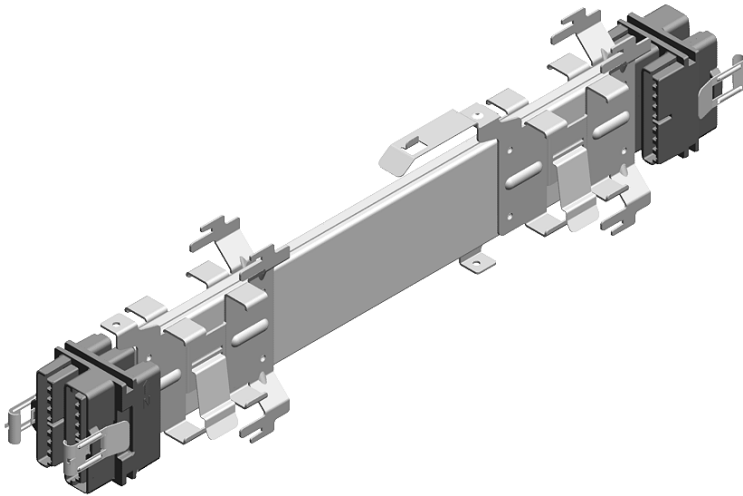

Canvas Office Landscape® Interiors Base Power Harness Assembly Installation and Disassembly for Recycling Instructions

Parts Included:



A Base Power Harness Assembly 30"-48"

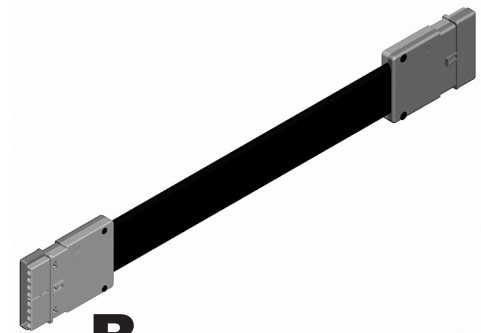

B Festoon Connector

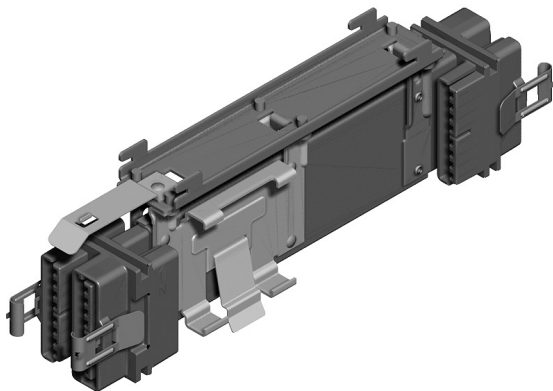

A Base Power Harness Assembly 24"

Electrical Rating:

120/208V, 120/240V 20A (15A CSA)

15A when powered with energy manager (PT 130, PT 131)

1. A 20A rated circuit can supply a maximum of 13 receptacles at 15 A.
2. A 15A rated circuit can supply a maximum of 10 receptacles rated at 15A. Receptacles rated at 20A are not allowed.



WARNING

Disconnect power before installation. Failure to do so can cause electrical shock and personal injury.



WARNING

Electrically interconnected units must be mechanically interconnected.

Tools Required:



Safety Glass

Assembly Instructions:

1

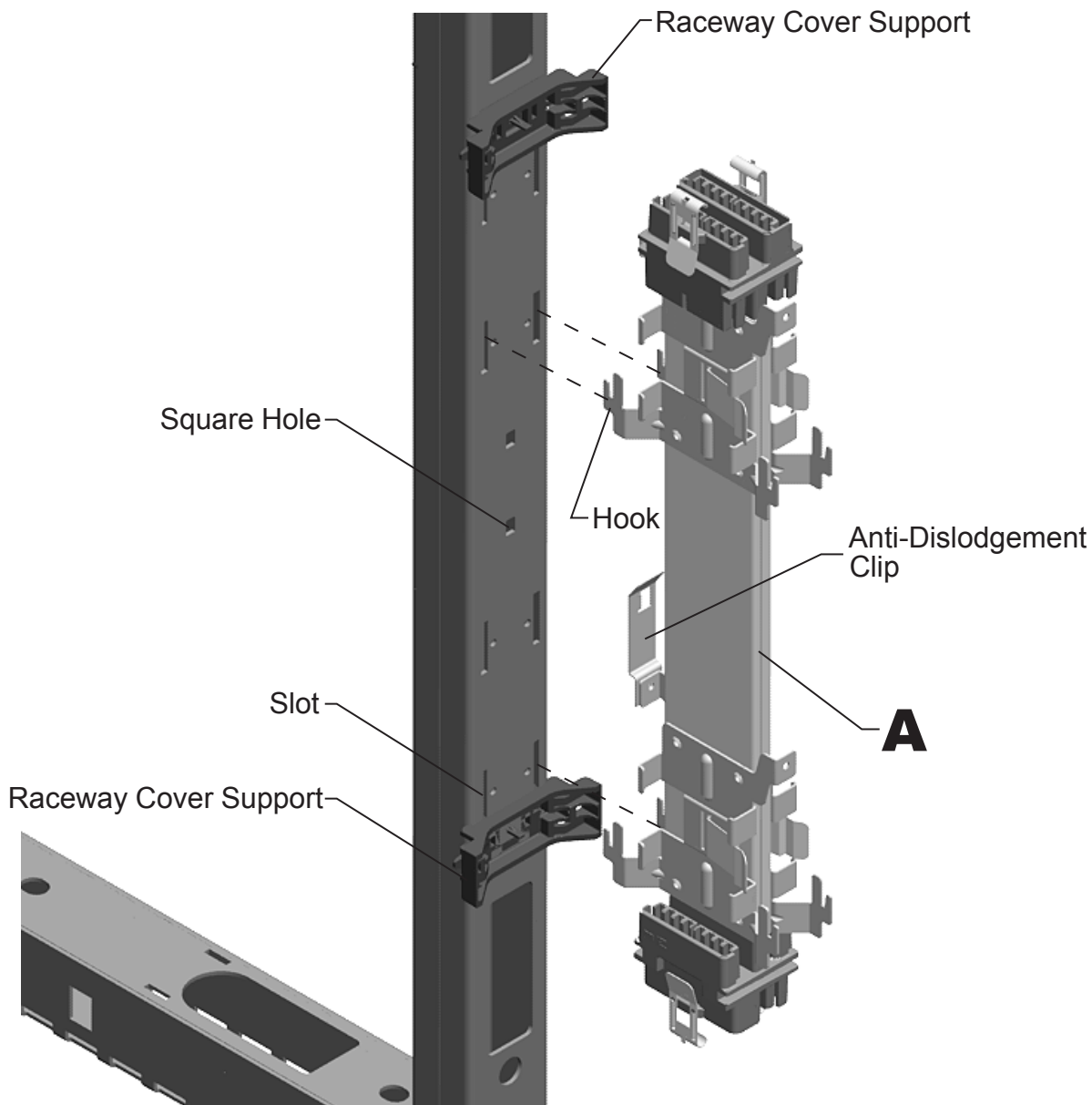

1. Set frame on side.
2. Insert Hooks on Harness Assembly (A) into Slots in bottom of Frame. Slide Harness Assembly along frame until Hooks engage in slots and Anti-Dislodgement clip engages into Square Hole.

Note: Installing Raceway Cover Supports before Harness Assembly will make installing Raceway Covers easier.

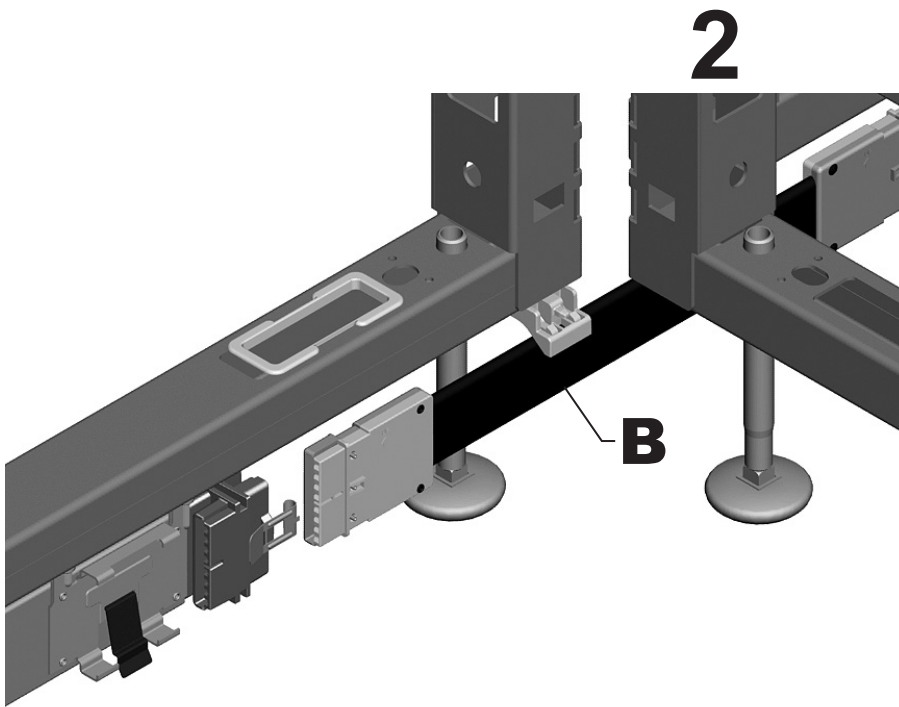

1. Connect Power Harness Assemblies together, Frame to Frame, with Festoon Connector (B).
2. See diagrams at right for proper panel connections.

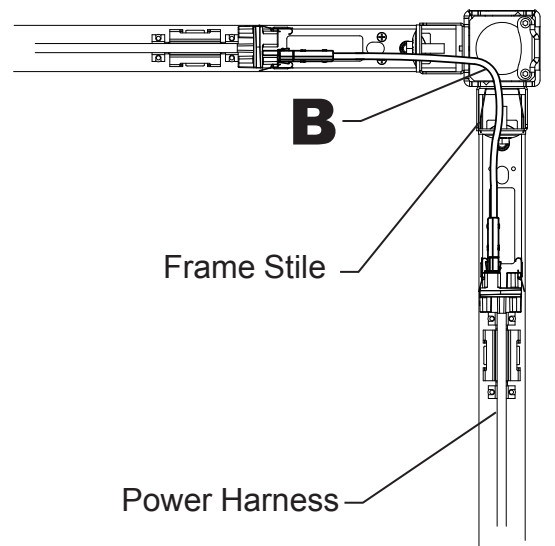

2-Way Intersection Connection

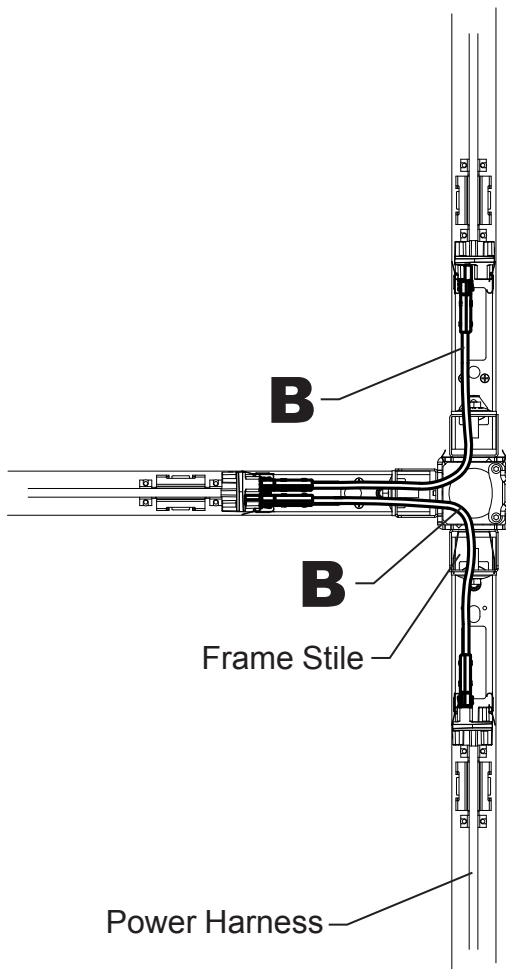

3-Way Intersection Connection

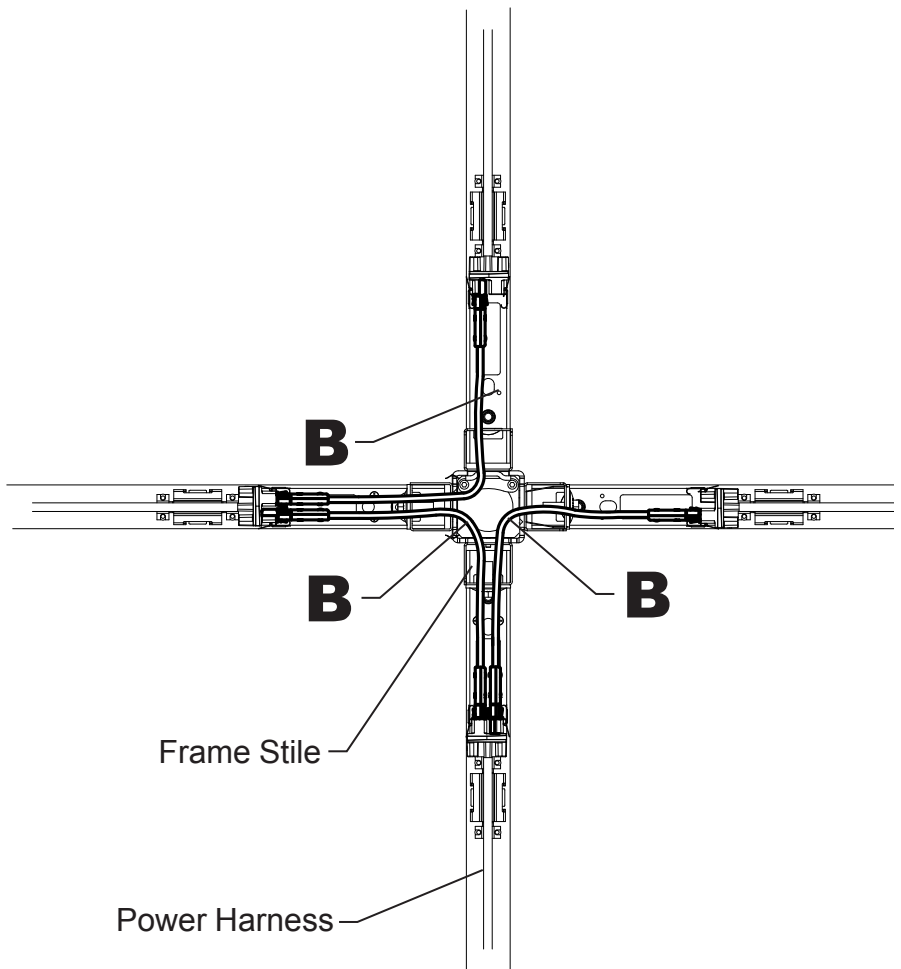

4-Way Intersection Connection

Disassembly for Recycling:

Materials Identification and Segregation:

Where possible, plastic components are marked with ASTM recycling codes. Use these codes to identify material type for recycling. Non marked components should be treated as mixed plastic. Ferrous metals can be identified using a small magnet for recycling. Non-ferrous metals should be separated and recycled separately.

To disassemble product, reverse steps 2 through 1.