

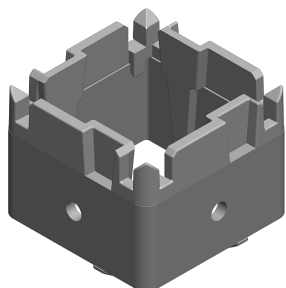

Canvas Office Landscape® 90° Connector Installation and Disassembly for Recycling Instructions

Parts Included:



A Connector Tube
(Included with
FT121.X46(2)
FT121.X57(3))
FT122.XX (1))



E Light Seal
FT122.2 & XFT121.2XX (1)
FT122.3 & XFT121.3XX (2)
FT122.4 & XFT121.4XX (4)

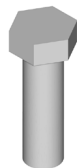

C 3/8-16 Hex Head
Cap Screw (8 or 12)



D Washer (8 or 12)

Hardware Pack

FT121.246 (4)
FT121.356 (6)
FT121.456 (8)
FT121.257 (6)
FT121.357 (9)
FT121.457 (12)
FT122.XX (4)

Notice:

Do not tighten screws until at least 2 frames are completely connected.

Notice:

Make certain that fasteners are torqued to the specified values.

Tools Required:

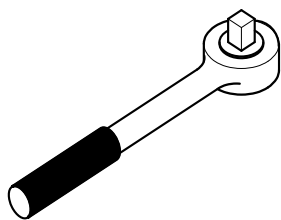

Ratchet

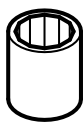

9/16" Socket

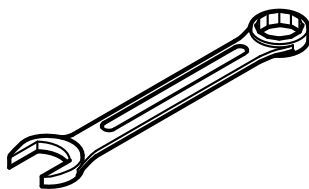

9/16" Wrench

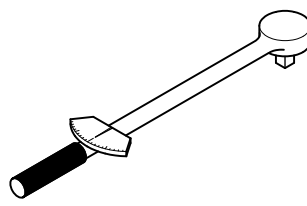

Torque Wrench



Safety Glass

HermanMiller

Part no. 1b2glt rev R.

© 2013 Herman Miller, Inc. Zeeland, Michigan. Printed in the U.S.A.

© Herman Miller and Canvas Office Landscape are among the registered trademarks of Herman Miller, Inc.

Illustrations and specifications are based on the latest product information available at the time of publication.

The right is reserved to make changes in design and specifications at any time, without notice, and also to discontinue products.

Assembly Instructions:

1

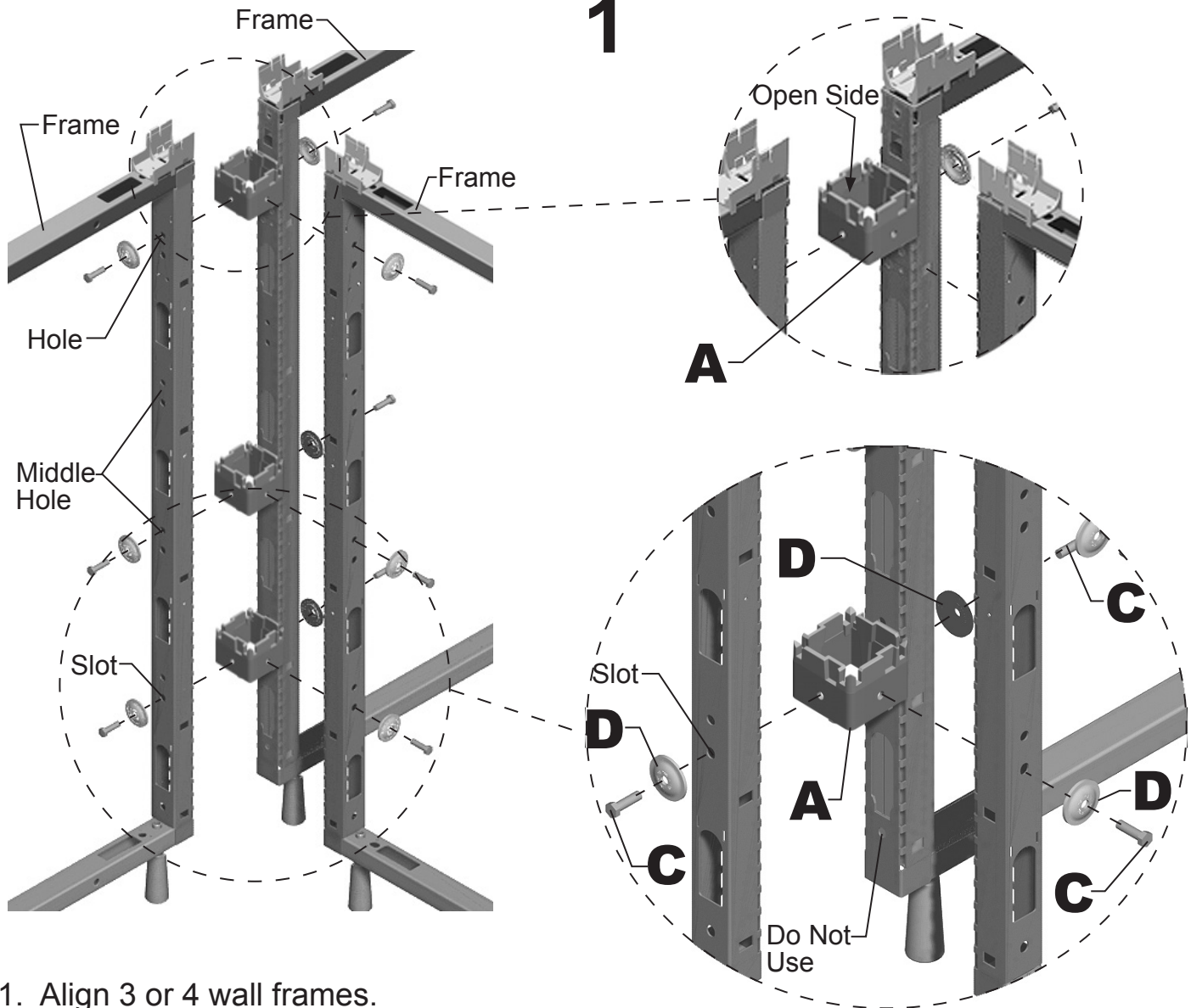

1. Align 3 or 4 wall frames.
 2. Connect frames to Top Connector Tube (A) if using the FT121 product using Screws (C) and Washers (D) at top hole location. For 3 way connection make sure Top Connector Tube open side faces outward. Do not tighten screws. For change of height configuration, see next page.
 3. Assemble Connector Tube (A) to frames at slot location second from bottom with Screws (C) and Washers (D). Do not tighten screws.
 4. For frames 53" and taller: install Connector (A), Screws and Washers in middle hole.
- Important: Torque screws to 200 in-lbs. Start with top connector tube, then bottom and middle last.**

HermanMiller

Part no. 1b2glt rev R.

© 2013 Herman Miller, Inc. Zeeland, Michigan. Printed in the U.S.A.

© Herman Miller and Canvas Office Landscape are among the registered trademarks of Herman Miller, Inc.

Illustrations and specifications are based on the latest product information available at the time of publication.

The right is reserved to make changes in design and specifications at any time, without notice, and also to discontinue products.

Change of Height Configuration:

1 Cont.

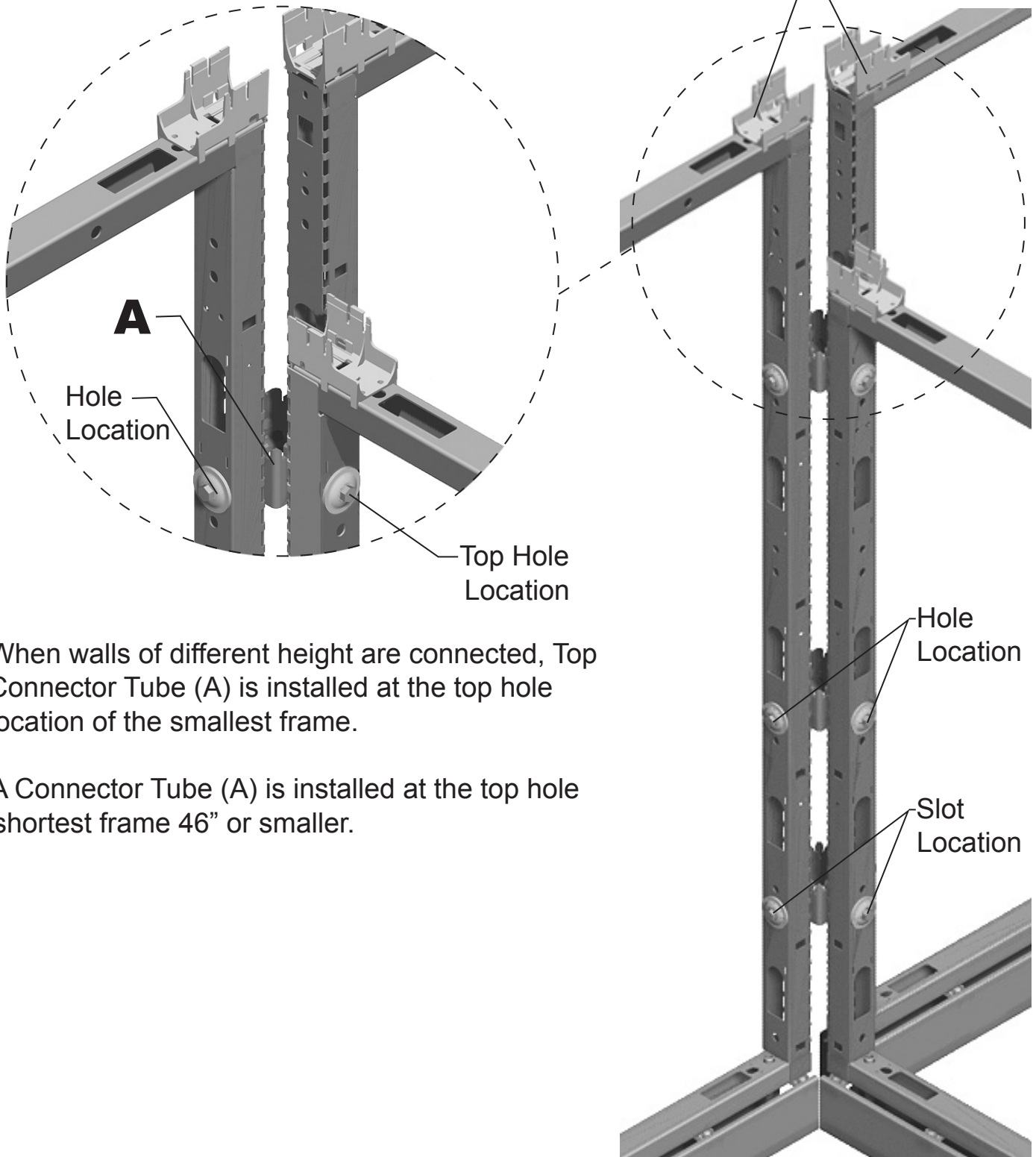

1. When walls of different height are connected, Top Connector Tube (A) is installed at the top hole location of the smallest frame.

2. A Connector Tube (A) is installed at the top hole of shortest frame 46" or smaller.

HermanMiller

Part no. 1b2glt rev R.

© 2013 Herman Miller, Inc. Zeeland, Michigan. Printed in the U.S.A.

©  HermanMiller and Canvas Office Landscape are among the registered trademarks of Herman Miller, Inc.

Illustrations and specifications are based on the latest product information available at the time of publication.

The right is reserved to make changes in design and specifications at any time, without notice, and also to discontinue products.

Change of Height Configuration Examples:

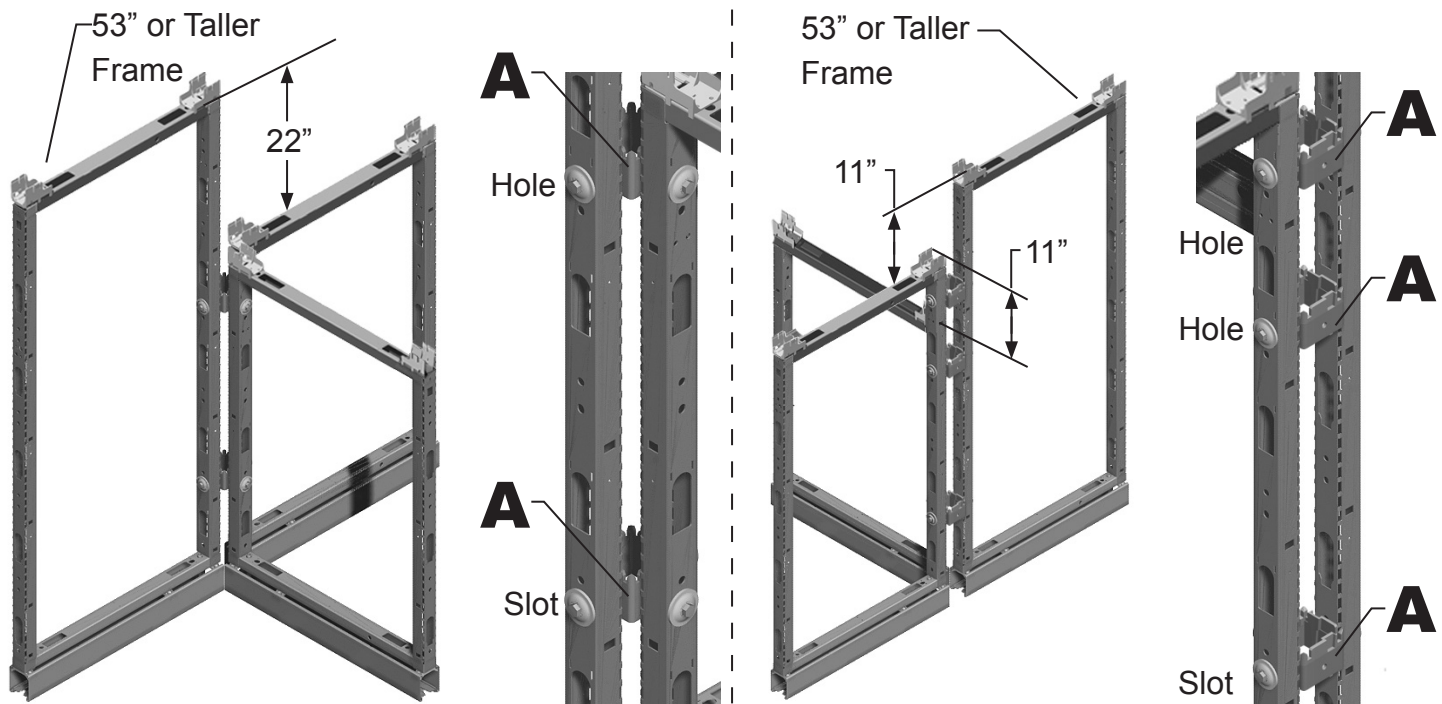
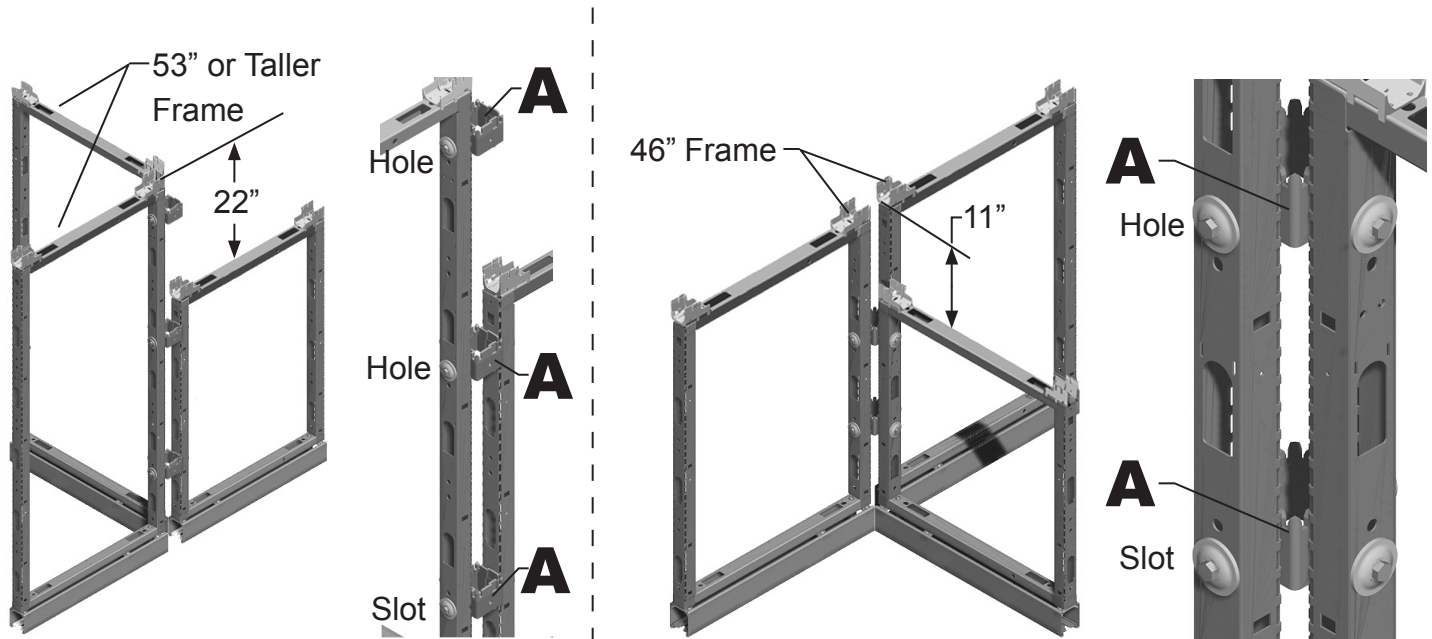

HermanMiller

Part no. 1b2glt rev R.

© 2013 Herman Miller, Inc. Zeeland, Michigan. Printed in the U.S.A.

© Herman Miller and Canvas Office Landscape are among the registered trademarks of Herman Miller, Inc.

Illustrations and specifications are based on the latest product information available at the time of publication.

The right is reserved to make changes in design and specifications at any time, without notice, and also to discontinue products.

Change of Height Configuration Examples:

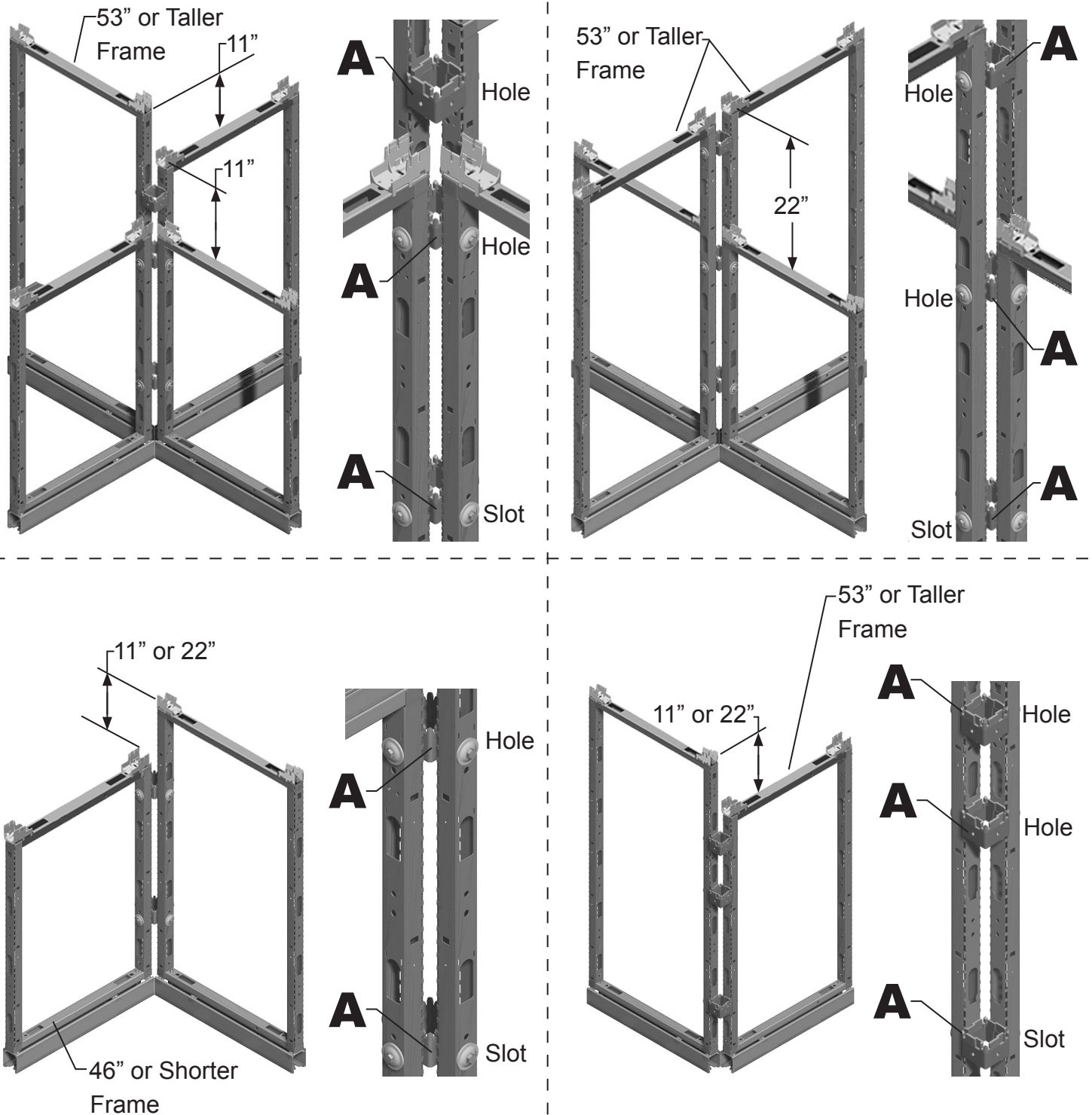

HermanMiller

Part no. 1b2glt rev R.

© 2013 Herman Miller, Inc. Zeeland, Michigan. Printed in the U.S.A.

© Herman Miller and Canvas Office Landscape are among the registered trademarks of Herman Miller, Inc.

Illustrations and specifications are based on the latest product information available at the time of publication.

The right is reserved to make changes in design and specifications at any time, without notice, and also to discontinue products.

2

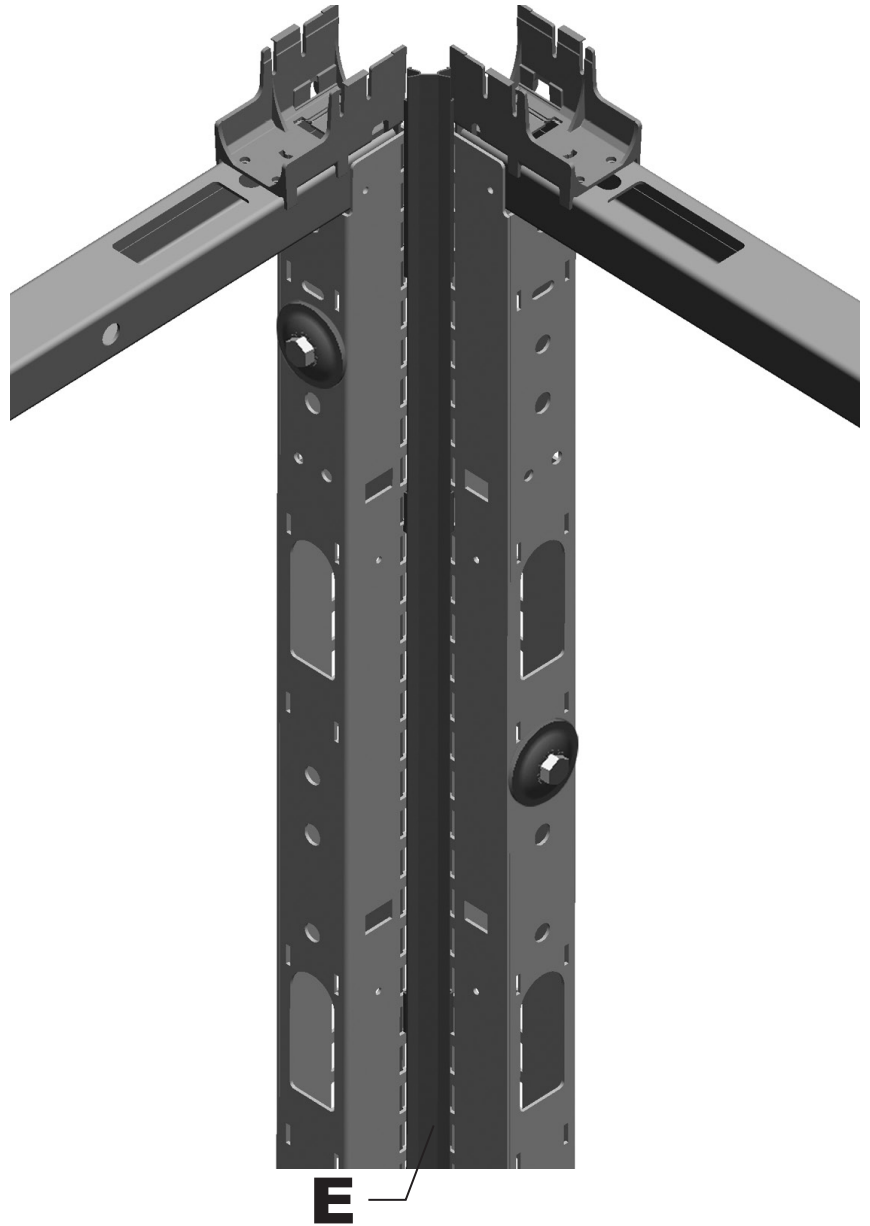
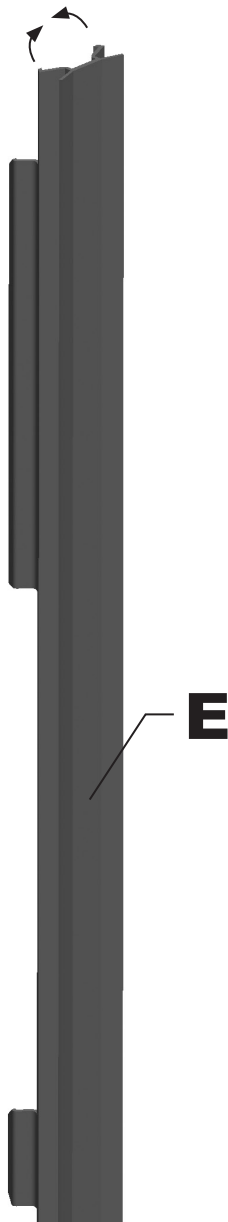

1. Before cladding has been installed, install Light Seal (E) in inside corners.
2. With the one-inch cut-out in the light seal facing up, rest the top set of arms on the top connector block.
3. Place one arm so that the curved portion sits well on the bend of the frame.
4. Push the other arm in, so that it snaps. Repeat for the entire length.
5. Cut light seal off even with bottom of frame.

Disassembly for Recycling:

Materials Identification and Segregation:

Where possible, plastic components are marked with ASTM recycling codes. Use these codes to identify material type for recycling. Non marked components should be treated as mixed plastic. Ferrous metals can be identified using a small magnet for recycling. Non-ferrous metals should be separated and recycled separately.

To disassemble product, reverse the above installation steps.