



Canvas Office Landscape® Work Surface Installation and Disassembly for Recycling Instructions

NOTICE

With FORMCOAT work surfaces, if any screw is to be relocated for any reason, a 1/8" X 5/8" - 3/4" pilot hole MUST be drilled at a new location.

NOTICE

Herman Miller, Inc., will not under any circumstances guarantee or assume responsibility for loading performance beyond individual component load capacities listed below.



WARNING

Load capacities as listed below for work surfaces include the total load of fully loaded components attached to the underside of the work surface plus the load placed on the top of the work surface. Failure to observe the recommended practices, such as loading beyond the capacities, will result in unsafe usage conditions and may result in failure of components and personal injury.



CAUTION

Be sure all work surface supports being used to support the same work surface are installed at the same height.

Work surface load capacities upto and including 48" width:

for 30" depth - 200 pounds

for 24" depth - 200 pounds

for 18" depth - 250 pounds

Work surface load capacities from 48" up to and including 96" width:

for 24" depth with three work surface supports or two work surface supports and two work surface support clips - 250 pounds.

for 30" depth with three work surface supports - 250 pounds.

for 24" and 30" depth with four work surface supports - 500 pounds with half of the load bearing on each half of the work surface.

Curvilinear work surface load capacities up to and including 96" width:

18-24" depth - 200 pounds

24-30" depth - 200 pounds

Recommended support bracket sizes for curvilinear work surfaces:

	24" Deep Side	30" Deep Side
End Supports	24"	30"
Center Supports	Heavy Duty	Heavy Duty

Parts Included:

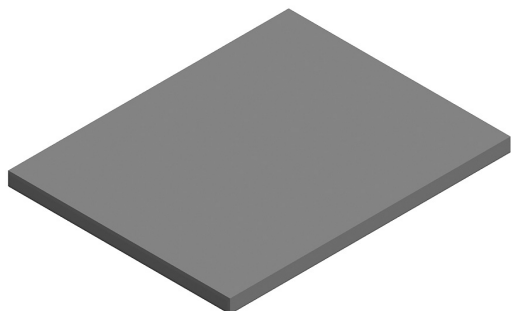

A Work Surface

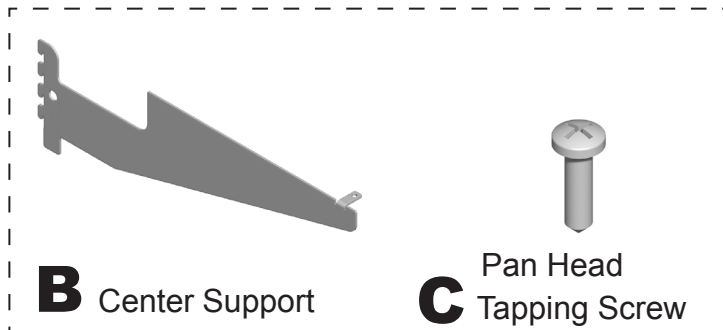

B Center Support

C Pan Head Tapping Screw

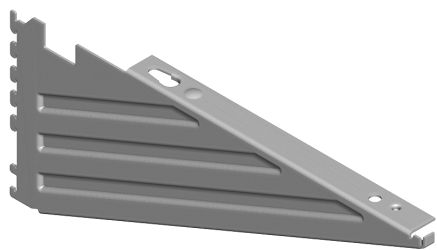

D Support LH

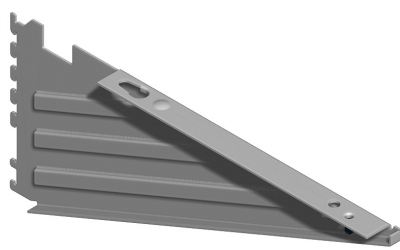

E Support RH



F Pan Head Tapping Screw
(needed when Support is used
as Center Support)

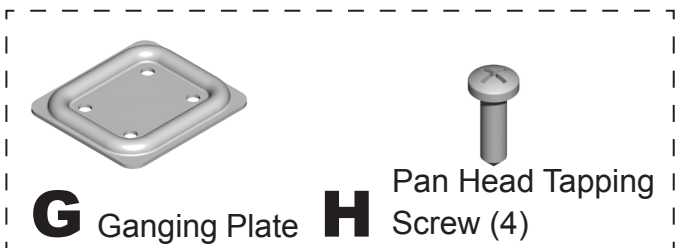

G Ganging Plate

H Pan Head Tapping
Screw (4)

Tools Required:

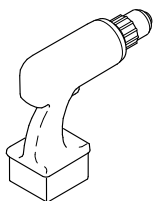

Power Driver



#2 Phillips Bit

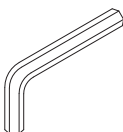

5/32" Hex Key

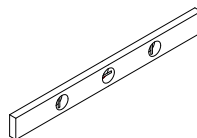

Level

HermanMiller

Part no. 1b2td3 rev D.

© 2015 Herman Miller, Inc. Zeeland, Michigan. Printed in the U.S.A.
© Herman Miller Canvas Office Landscape are among the registered trademarks of Herman Miller, Inc.

Illustrations and specifications are based on the latest product information available at the time of publication.
The right is reserved to make changes in design and specifications at any time, without notice, and also to discontinue products.

Note: Install Wall Cladding before installing Work Surface Supports.

1

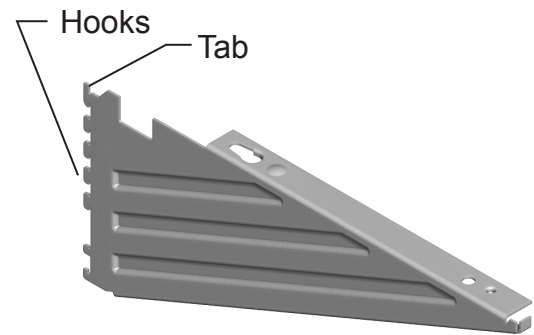
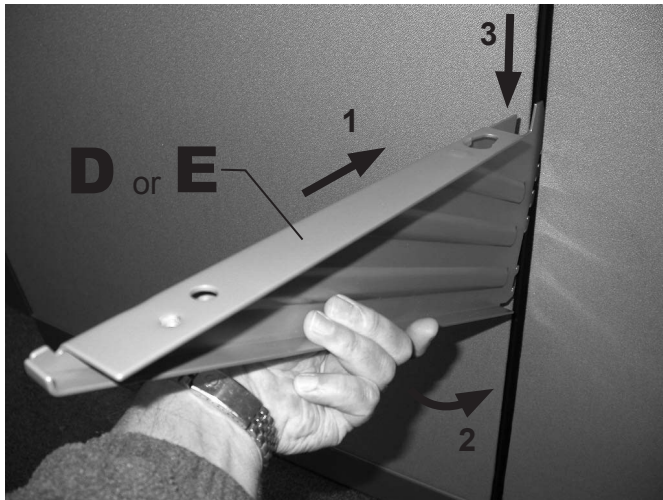

1. Tilt Support (“D” Shown). Insert Tab into slot in frame at desired height.
2. Rotate Support downward until all hooks are in slots.
3. Push down on Supports until all hooks engage into slots.
4. Repeat installation for other Support (“E”)

Notice:

Only standard center supports are to be used with curvilinear and all FORMCOAT work surfaces regardless of width.

2

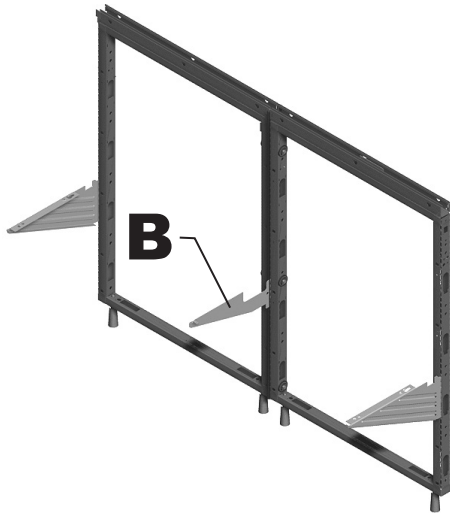

Center Support for 60", 66" & 72" wide laminate rectangular work surfaces only.

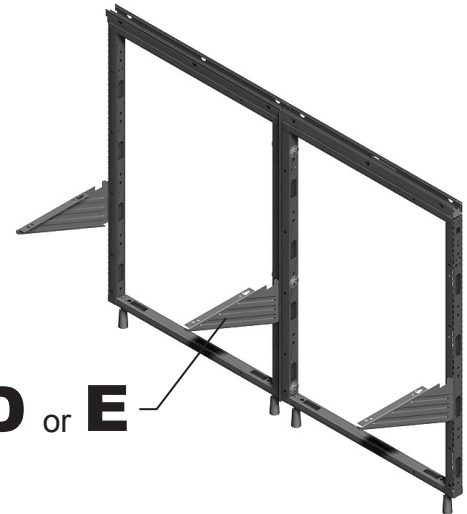

Center Support for 78", 84", 90", 96" wide & 60" thru 96" wide Formcoat and HPL curvilinear work surfaces only.

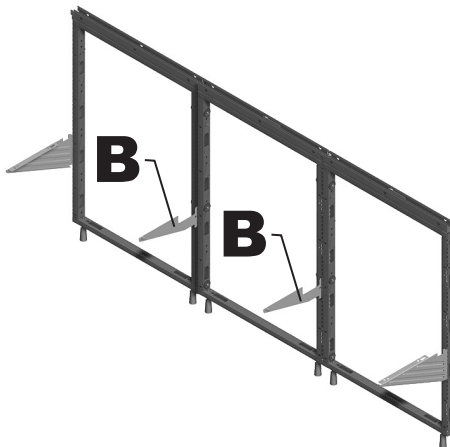

Center Support for 60", 66" & 72" wide HPL rectangular work surfaces only.

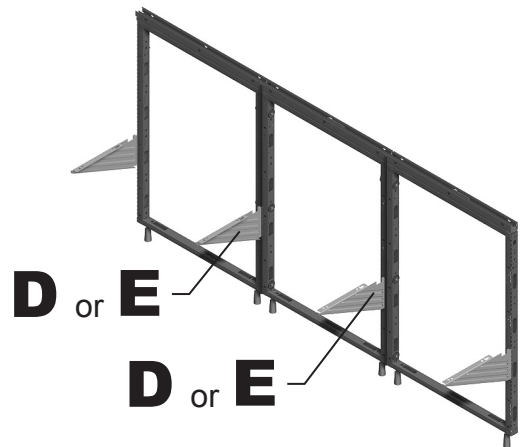

Center Support for 78", 84", 90", 96" wide & 60" thru 96" wide Formcoat and HPL curvilinear work surfaces only.

1. If Work Surface is 68" or 72" wide, install Center Support on center frame style at same height as Work Surface Supports. If Work Surface is 78", 84", 90" or 96" wide, install Standard Center Support ("D" and/or "E") on frame styles at same height as Work Surface Supports.

HermanMiller

Part no. 1b2td3 rev D.

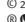
© 2015 Herman Miller, Inc. Zeeland, Michigan. Printed in the U.S.A.
©  Herman Miller Canvas Office Landscape are among the registered trademarks of Herman Miller, Inc.

Illustrations and specifications are based on the latest product information available at the time of publication.
The right is reserved to make changes in design and specifications at any time, without notice, and also to discontinue products.

3

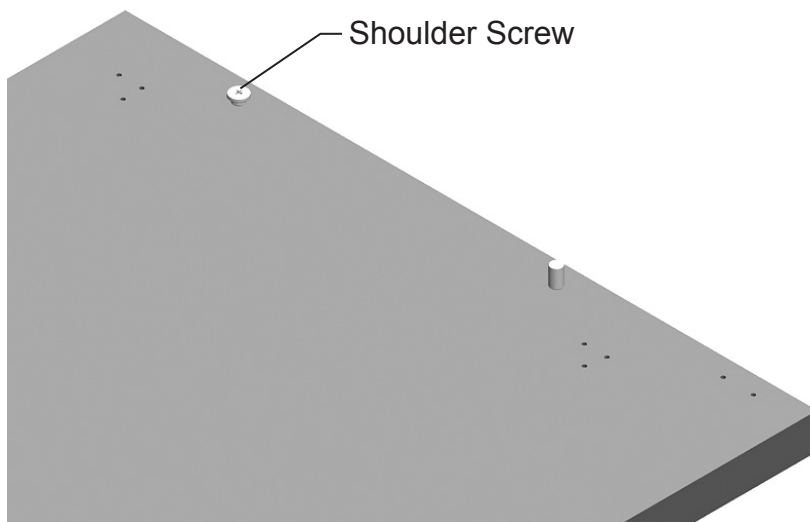
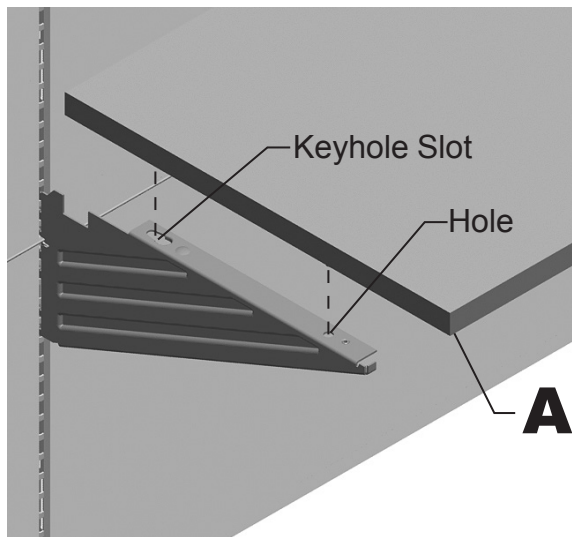

1. Install Work Surface (A) by inserting Shoulder Screws into Keyhole Slots in rear of Work Surface Supports. Push Work Surface back until front Spacers engage front holes in Supports. If Work Surface is 84", 90" or 96" wide, Shoulder Screws and front Spacers must also engage in heavy duty Center Supports.
2. Level Work Surface by adjusting Set Screw in Support.

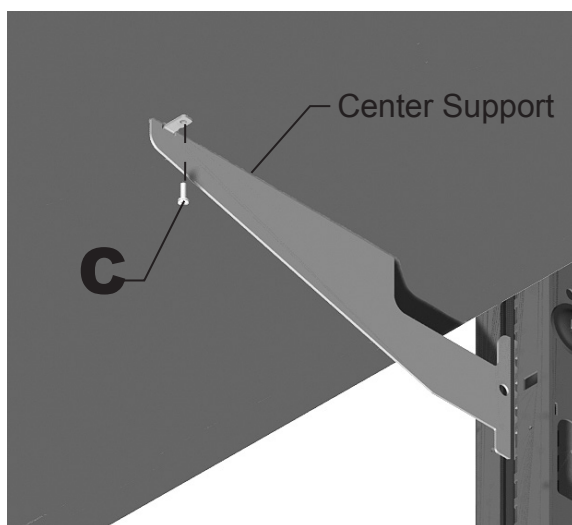

3. On 60", 66" & 72" wide Work Surface, Align Center Support with center of Work Surface. Secure Center Support with Screw (C) supplied with Support. For 78", 84", 90" & 96" wide Work Surfaces with heavy duty Center Support, install Screw (F) supplied with heavy duty Center Supports.

4

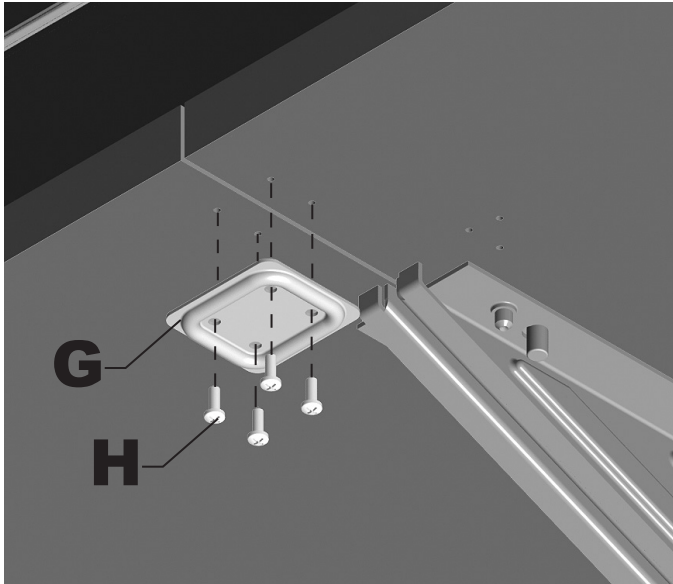

1. Install Ganging Plate (G) between adjacent Work Surfaces with (4) Pan Head Screws (H)

Disassembly and Recycling:

Materials Identification and Segregation:

Where possible, plastic components are marked with ASTM recycling codes. Use these codes to identify material type for recycling. Non marked components should be treated as mixed plastic. Ferrous metals can be identified using a small magnet for recycling. Non-ferrous metals should be separated and recycled separately.

To disassemble product, reverse the above installation steps: