

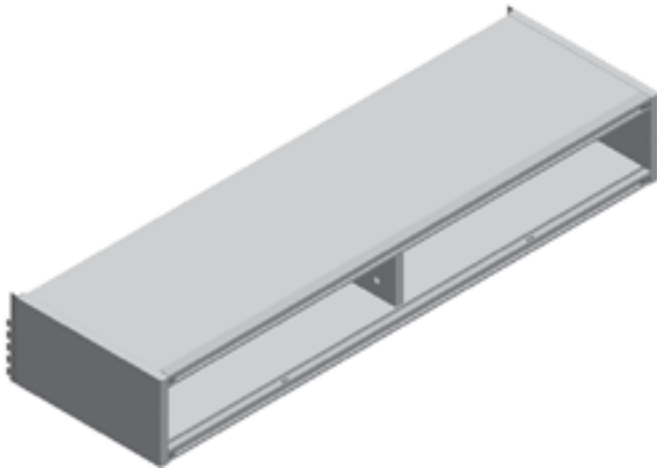

Canvas Office Landscape® Private Office Overhead Storage Installation and Disassembly for Recycling Instructions

Parts Included:



A Frame Mounted Storage Cabinet



A Wall Mounted Storage Cabinet

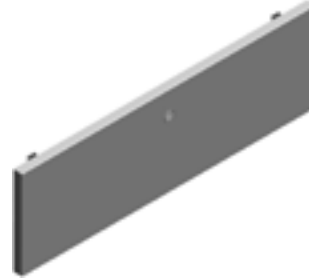

B Bin Door (1 or 2)



C Thin Door (1 or 2)



D Cleat



E Trim Cap



F Cleat Interlock Bracket



G Cleat Screw

Tools Required:

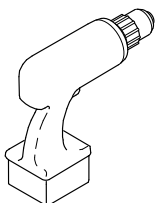

Power Driver



Phillips Bit



Flathead Screw Driver



Safety Glass

HermanMiller

Part no. 1b54fj rev J.

© 2017 Herman Miller, Inc. Zeeland, Michigan. Printed in the U.S.A.
© Herman Miller and Canvas Office Landscape are among the registered trademarks of Herman Miller, Inc.

Illustrations and specifications are based on the latest product information available at the time of publication.
The right is reserved to make changes in design and specifications at any time, without notice, and also to discontinue products.

All Frame Mounted Cabinets:

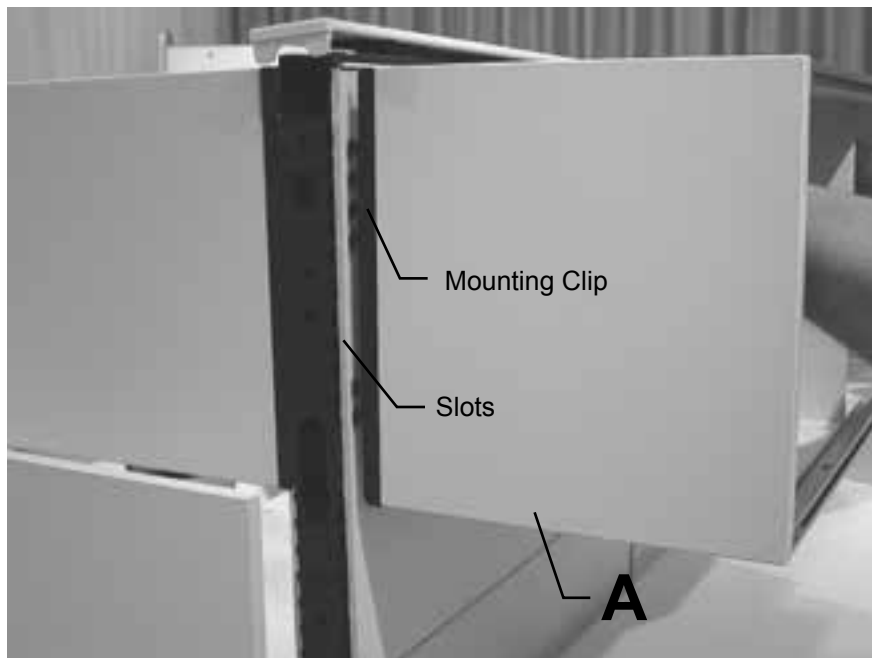

1. Insert Mounting Clips on Storage Unit (A) into slots in frame. Push down on unit, making sure clips fully engage into slots.

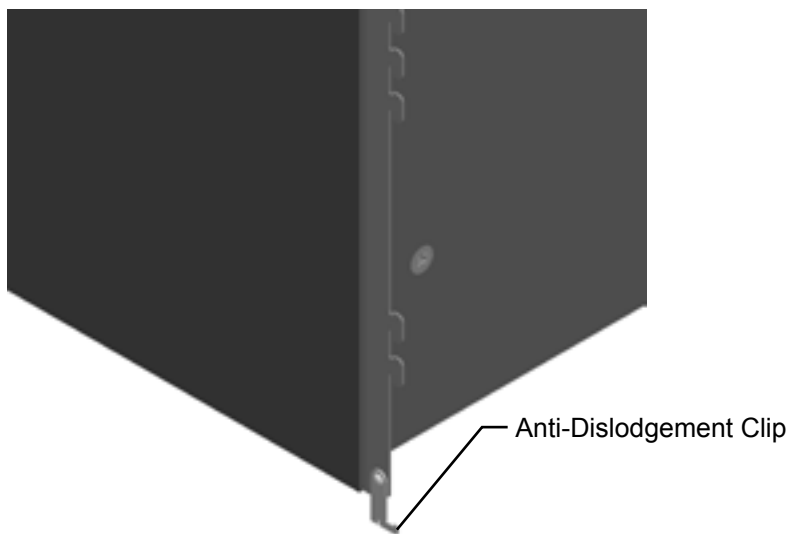

2. Engage Anti-Dislodgement Clips.

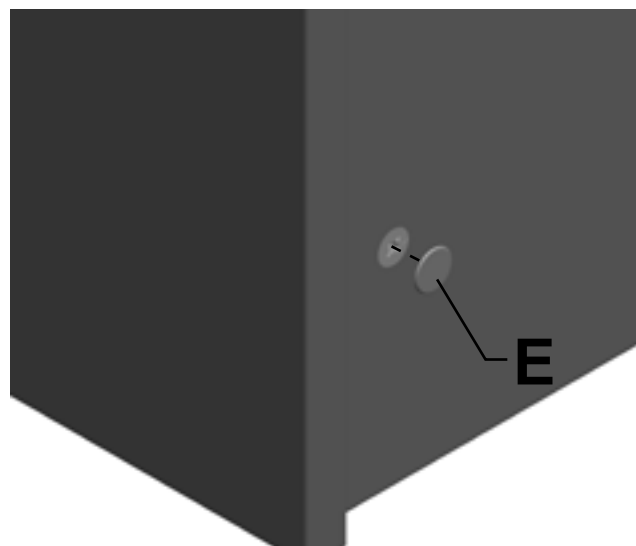

3. Install Trim Caps (E) where visible.

HermanMiller

Part no. 1b54fj rev J.

© 2017 Herman Miller, Inc. Zeeland, Michigan. Printed in the U.S.A.
©  HermanMiller and Canvas Office Landscape are among the registered trademarks of Herman Miller, Inc.

Illustrations and specifications are based on the latest product information available at the time of publication.
The right is reserved to make changes in design and specifications at any time, without notice, and also to discontinue products.

All Wall Mounted Cabinets:

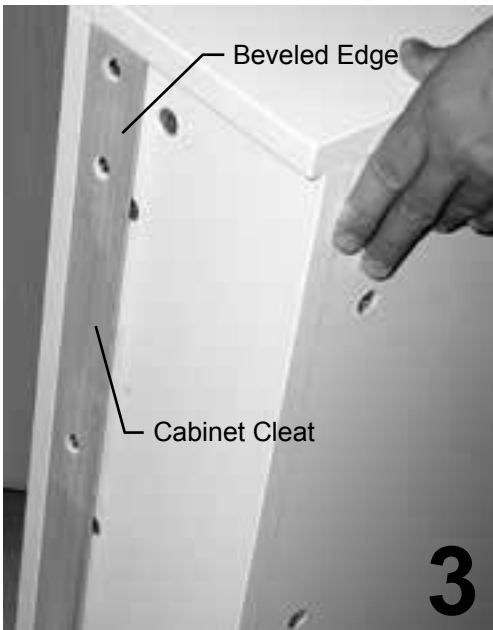
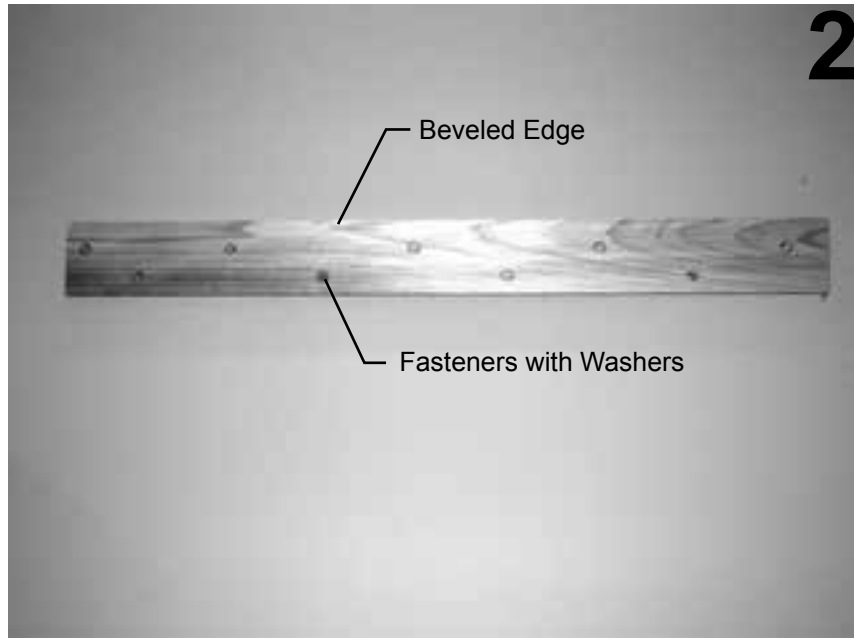
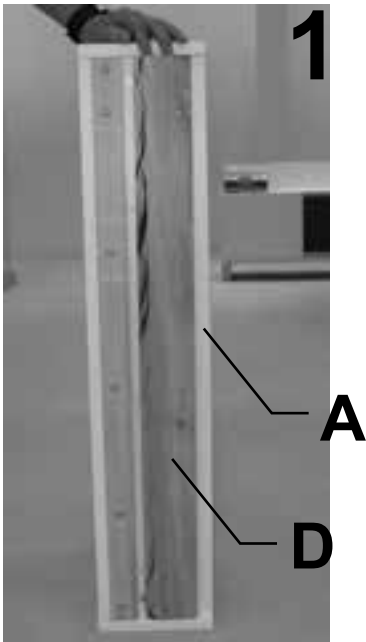

1. Remove Bracket Screw(G), Interlock Bracket(F) and Wall Cleat(D) from back of Cabinet.
2. Mount Wall Cleat onto Wall using fasteners appropriate for wall type. Washers are required under screw heads. **See Pages 4 & 5 for mounting specifications.**
3. Hang cabinet onto Wall Cleat by mating beveled edge on Cabinet Cleat with beveled edge on Wall Cleat. If needed, shim cabinet by adding shim between end panel and wall. Install Trim Caps (E) where visible.
4. Locate bracket(F) approximately centered about the width and tight to the wall and cabinet top. For thin top product, install bracket prior to attaching the thin top. Using supplied flathead screw(G), attach bracket(F) to cabinet first. Appropriate pilot hole is recommended. Using installer provided fastener, attach bracket(F) to wall using appropriate fastener for wall type.

HermanMiller

Part no. 1b54fj rev J.

© 2017 Herman Miller, Inc. Zeeland, Michigan. Printed in the U.S.A.
 © Herman Miller and Canvas Office Landscape are among the registered trademarks of Herman Miller, Inc.

Illustrations and specifications are based on the latest product information available at the time of publication.
 The right is reserved to make changes in design and specifications at any time, without notice, and also to discontinue products.

Definition of a Structural Wall

An architectural wall is defined as a load-bearing wall constructed of materials such as poured concrete or concrete block or a composite board (dry wall) attached to metal or wood studs.

Composite board (dry wall) must be 5/8" or more thick.

Wood studs must be nominal 2" x 4" size.

Metal studs must be "C" channel 20 gauge thick.

Metal or wood studs must be on centers no greater than 24" apart and have a maximum height of 14' and restrained at the floor and the ceiling.

* Determine desired height of Cabinet and position wall cleat from there.

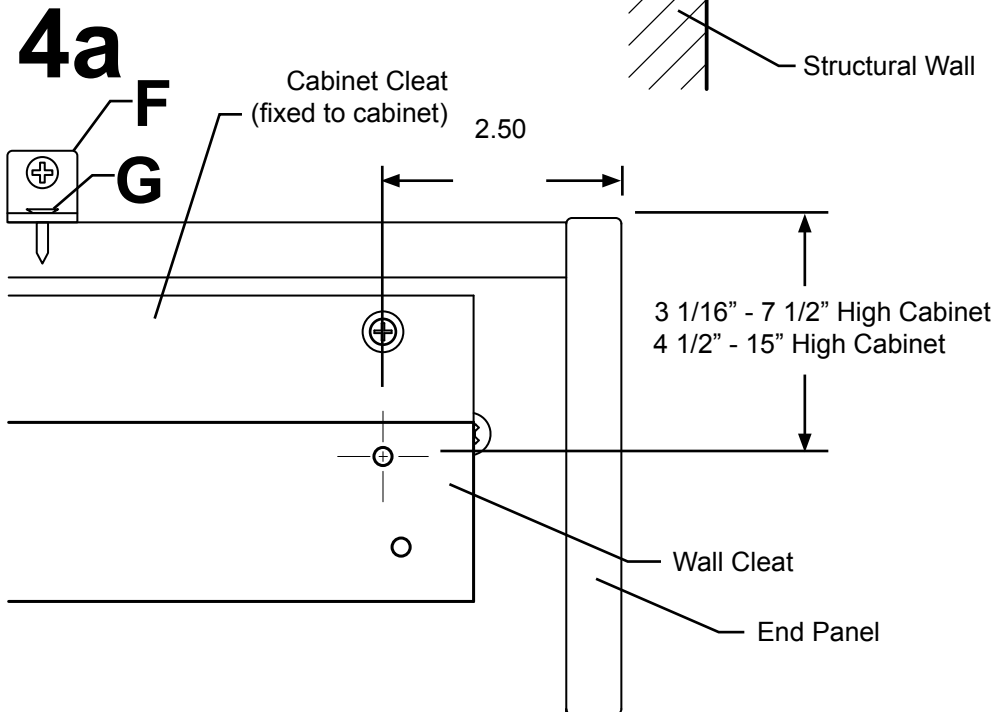
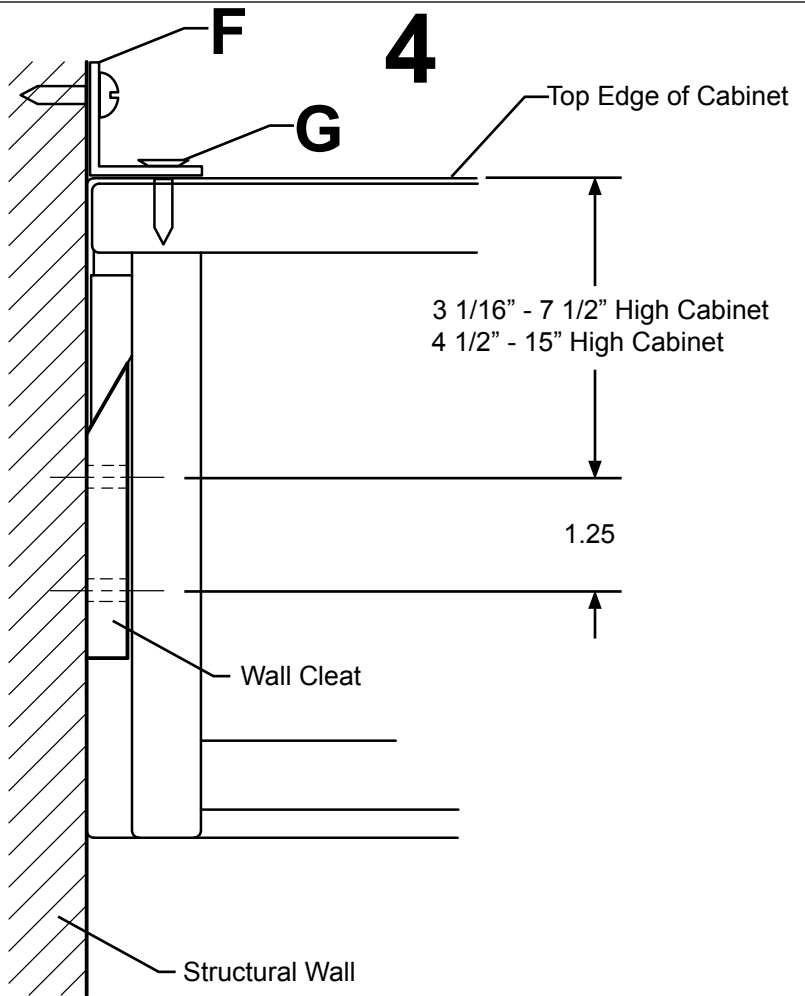

* For the horizontal location, the first hole is 2 1/2" in from End Panel.

HermanMiller

Part no. 1b54fj rev J.

© 2017 Herman Miller, Inc. Zeeland, Michigan. Printed in the U.S.A.
© Herman Miller and Canvas Office Landscape are among the registered trademarks of Herman Miller, Inc.

Illustrations and specifications are based on the latest product information available at the time of publication.
The right is reserved to make changes in design and specifications at any time, without notice, and also to discontinue products.

Wall Fastener (X1192.)

Black panhead fastener attaches a wall strip to a wall.

Pkg of 100

Specify fastener based on wall construction.

(X1192.1) - 1 ½" long #10 pan head sheet metal screw fastens into anchors in cement blocks, poured walls, and brick.

(X1192.2) - 3" long #10 pan head sheet metal screw fastens into studs.

(X1192.3) - 3" long #10 pan head machine screw fastens into toggle wall strip anchor (#X1191.) or wing toggles in drywall.

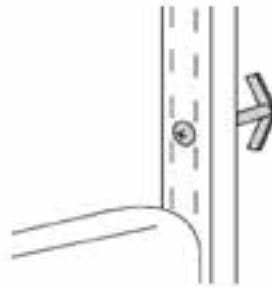

For drywall applications specify X1192.3 wall fasteners.

And



Toggle wall strip anchors (X1191.) or equivalent fasteners must be specified in dry wall applications.

Toggle Wall Strip Anchor (X1191.)

Anchor provides extra support for a wall strip attached to drywall.

Recommended for use in all drywall installations. Use with X1192.3 wall fasteners.

Package of 100

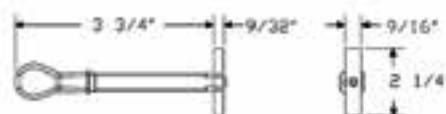

Wall Cleats require the following quantities of fasteners: (X1192.) specify separately.

Width - Fasteners

24" - 6

30" - 6

36" - 8

42" - 8

48" - 9

60" - 9

66" - 10

72" - 12

Door Installation (Sliding Doors):

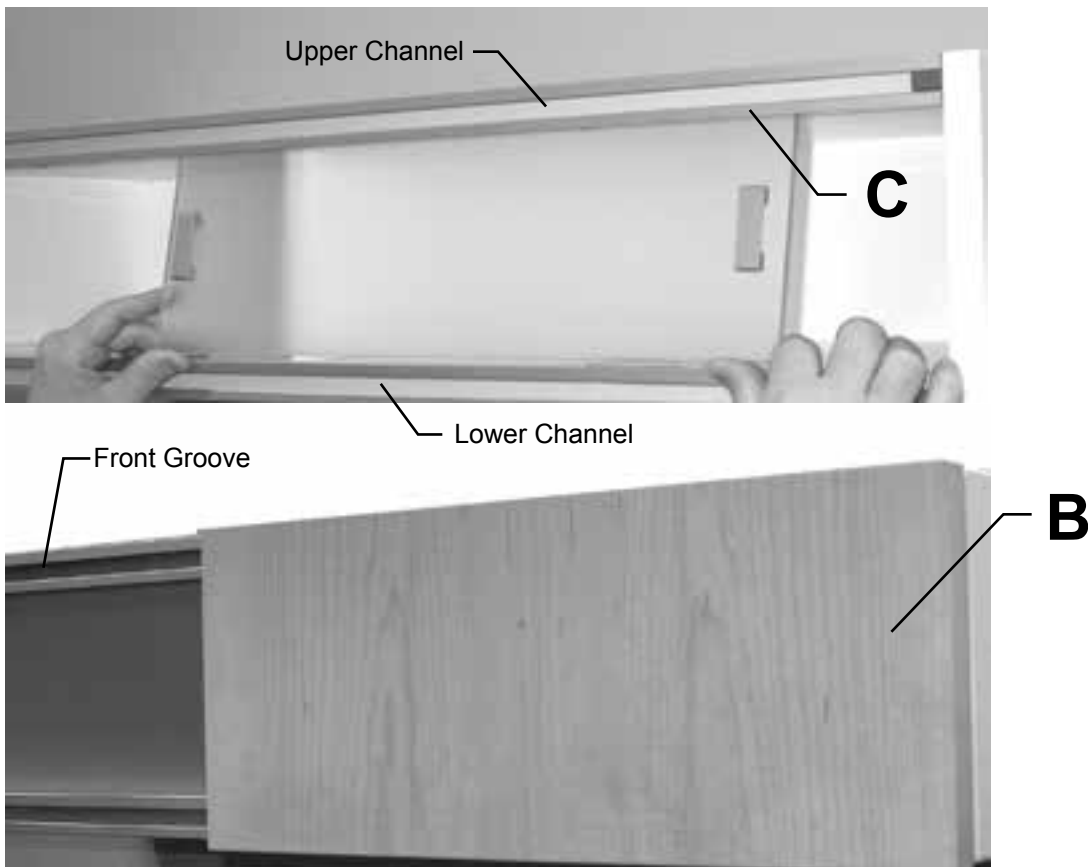

1. Insert top of Thin Door (C) into back groove of Upper Channel. Lower bottom of door into back groove of Lower Channel.
2. Insert top clips on back of Bin Door (B) into Front Groove of Upper Channel. Snap bottom clips on back of Bin Door into Front Groove of Lower Channel.

Door Installation (Hinged Doors):

1. Adjust hinges as needed to align door.

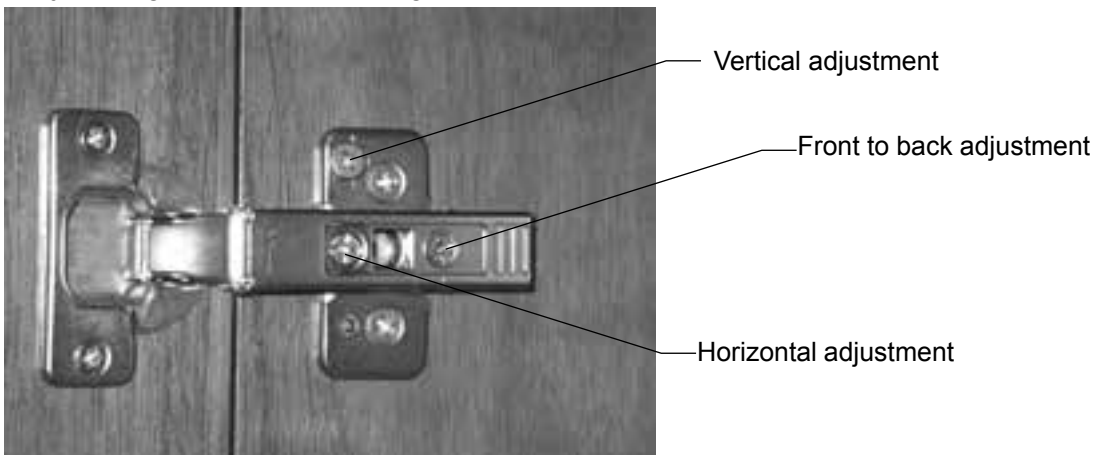

HermanMiller

Part no. 1b54fj rev J.

© 2017 Herman Miller, Inc. Zeeland, Michigan. Printed in the U.S.A.
© Herman Miller and Canvas Office Landscape are among the registered trademarks of Herman Miller, Inc.

Illustrations and specifications are based on the latest product information available at the time of publication.
The right is reserved to make changes in design and specifications at any time, without notice, and also to discontinue products.

Keyed Alike Lock Plug Installation

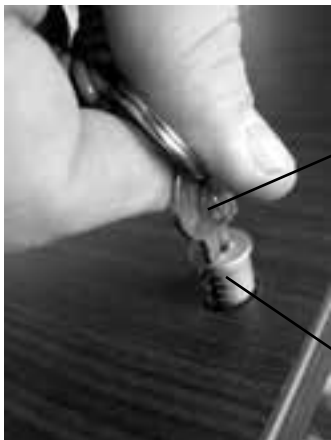

Plug Removal Key

Metal Lock Plug

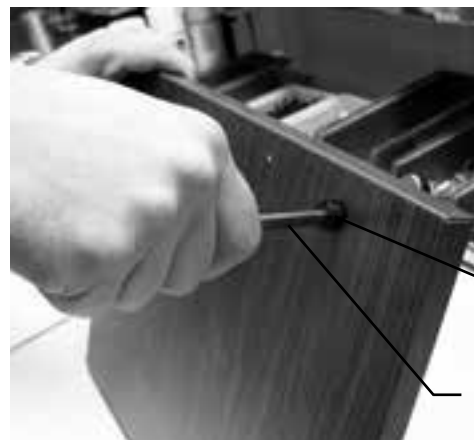

Plastic Plug

Hex Wrench

1. Metal Lock Plug Removal: Insert Universal key into Lock Plug, rotate to unlocked position. Insert Plug Removal Key into lock. Gently wiggle with light outward pressure.
2. Black Plastic Plug Removal: With Hex Wrench, rotate plug to unlocked position. Gently pull outward. Be careful not to catch plug on wood surface around lock hole.
3. On units with no lock plug installed, use a flathead screwdriver to rotate the adaptor to the unlock position.



Adaptor



Lock Plug

Universal Key



4. On overhead units, be certain while removing plug not to dislodge Adaptor located in bottom of lock shell.

5. With universal key inserted in keyed lock plug, insert at angle to clear sharp edge on plug. When leading edge is inside lock shell, straighten. Push in until fully seated or a snap is heard.

HermanMiller

Part no. 1b54fj rev J.

© 2017 Herman Miller, Inc. Zeeland, Michigan. Printed in the U.S.A.
© Herman Miller and Canvas Office Landscape are among the registered trademarks of Herman Miller, Inc.

Illustrations and specifications are based on the latest product information available at the time of publication.
The right is reserved to make changes in design and specifications at any time, without notice, and also to discontinue products.

Disassembly and Recycling:

Materials Identification and Segregation:

Where possible, plastic components are marked with ASTM recycling codes. Use these codes to identify material type for recycling. Non marked components should be treated as mixed plastic. Ferrous metals can be identified using a small magnet for recycling. Non-ferrous metals should be separated and recycled separately.

To disassemble product, reverse the above installation steps and also do the following.

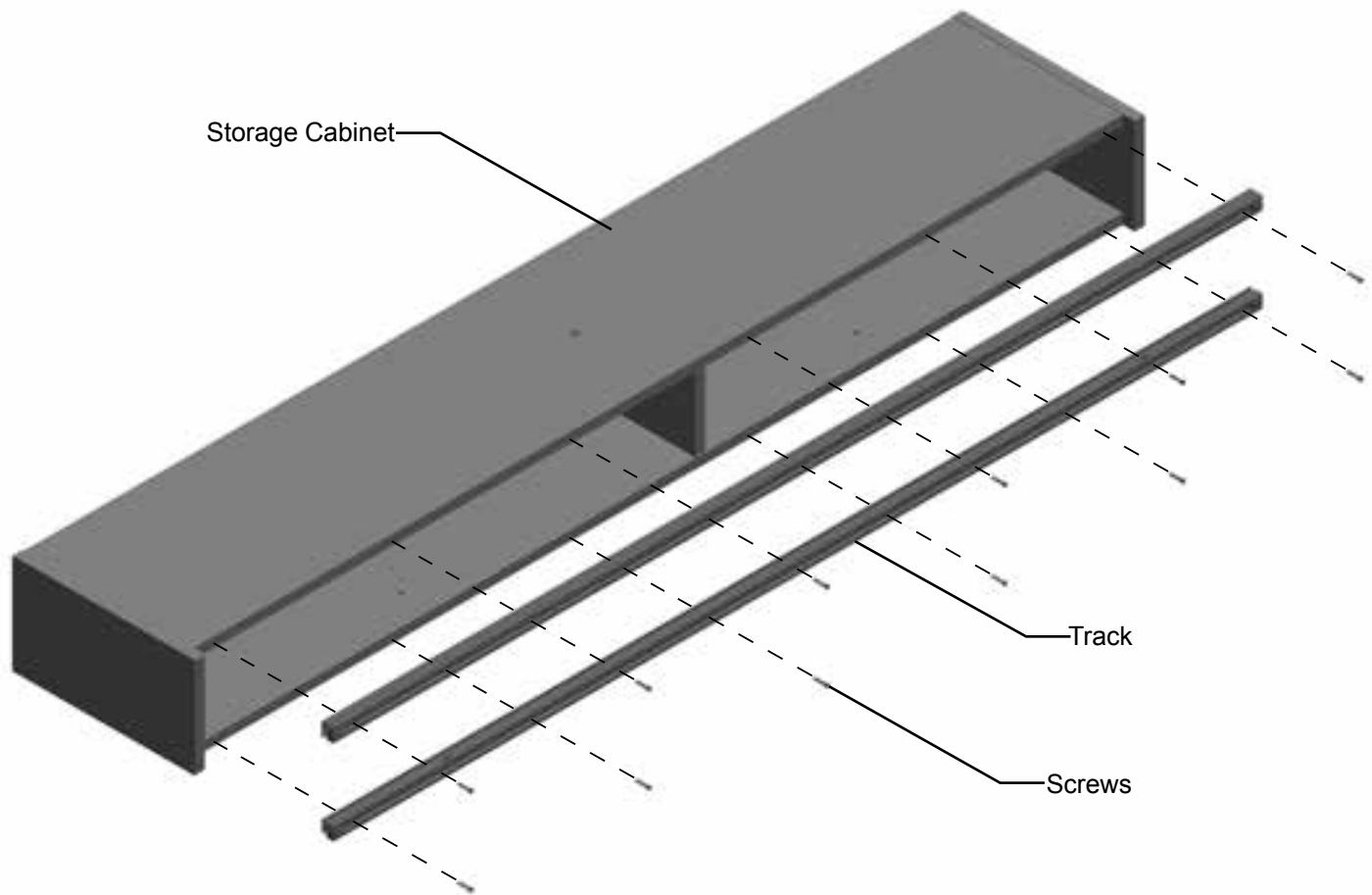

1. Remove screws from track.
2. Remove track from storage assembly.

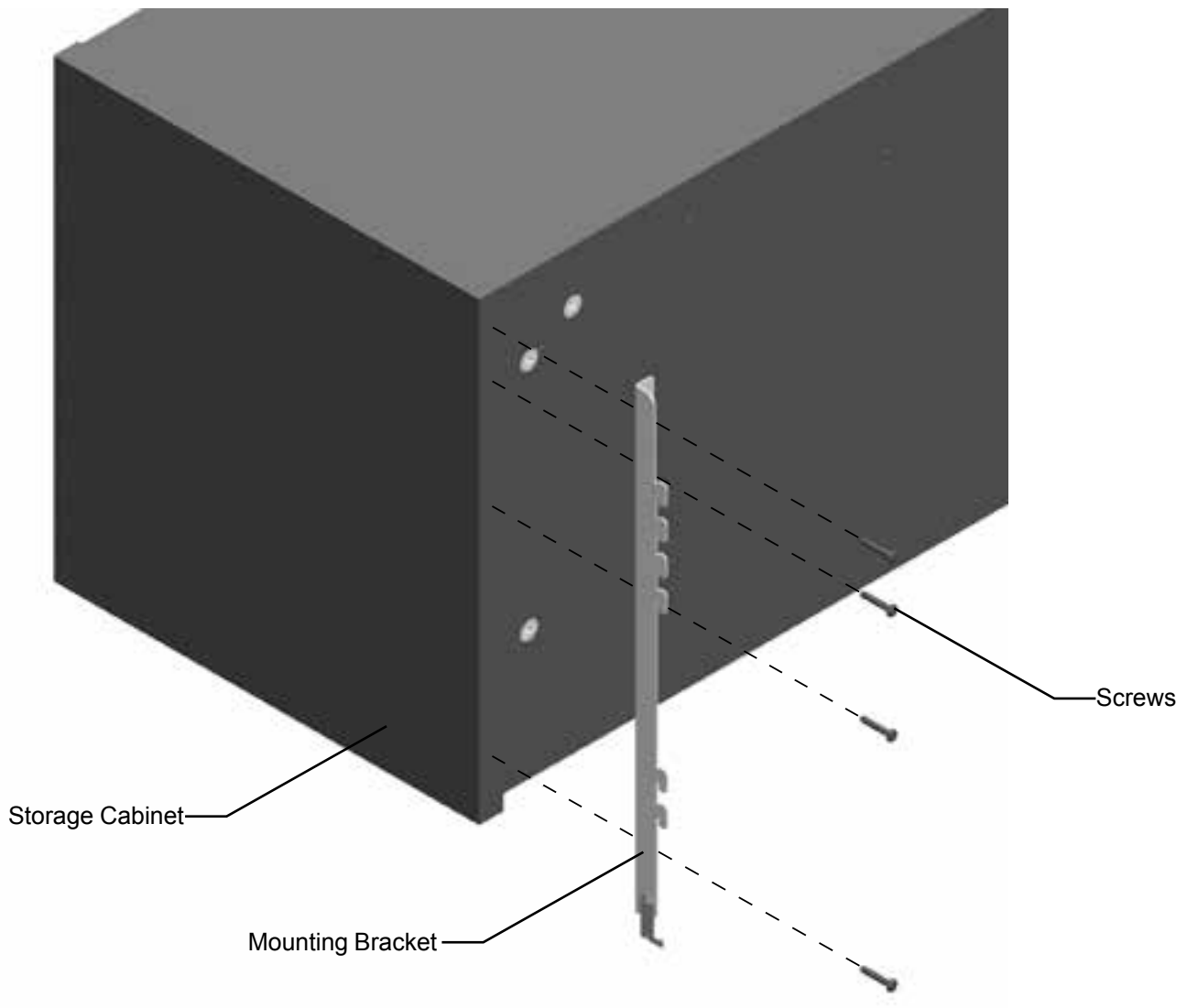

1. Remove screws from mounting bracket.
2. Remove mounting bracket from storage assembly.
3. Repeat step 1 and 2 to remove other side bracket.

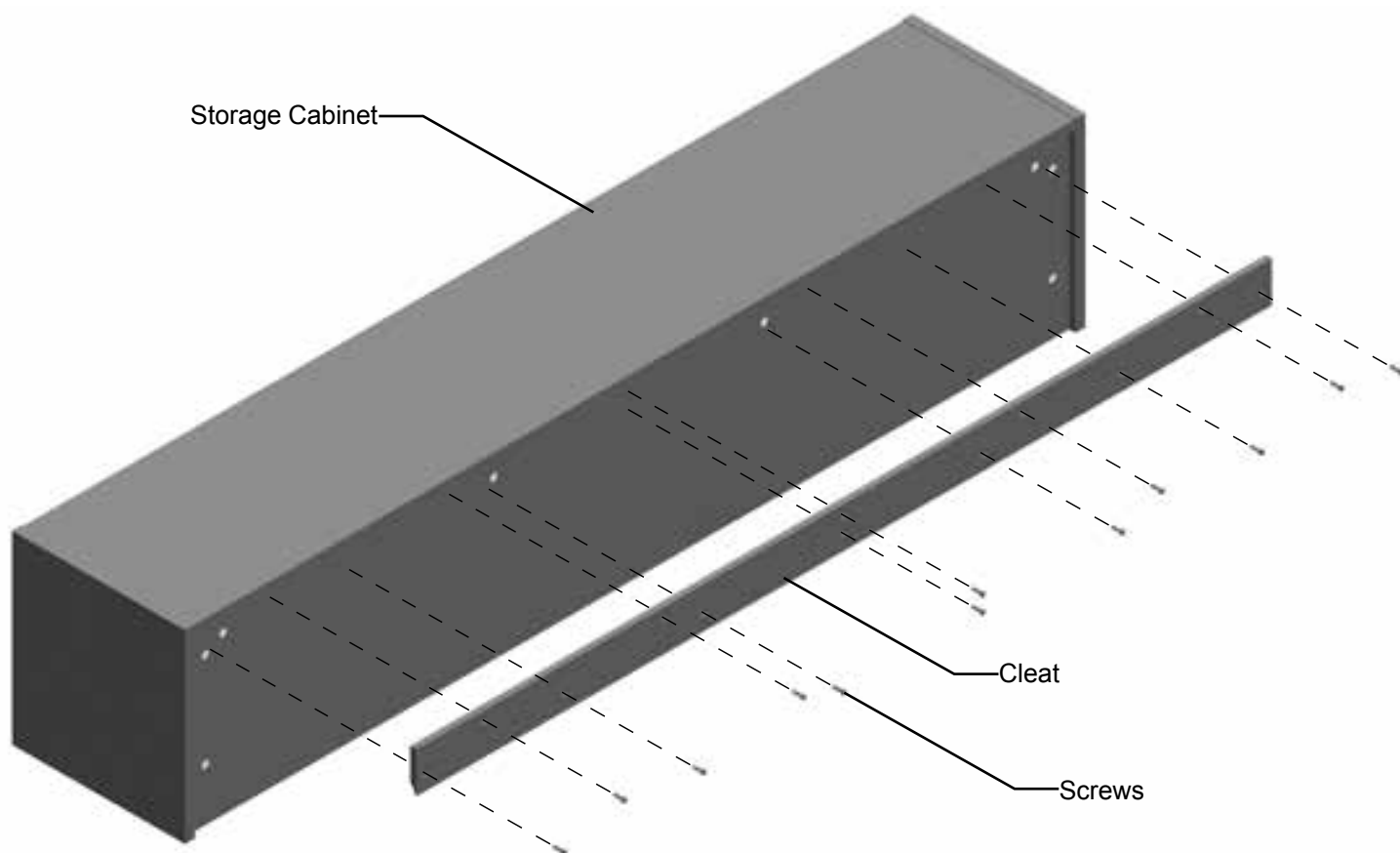

1. Remove screws from cleat.
2. Remove cleat from storage assembly.

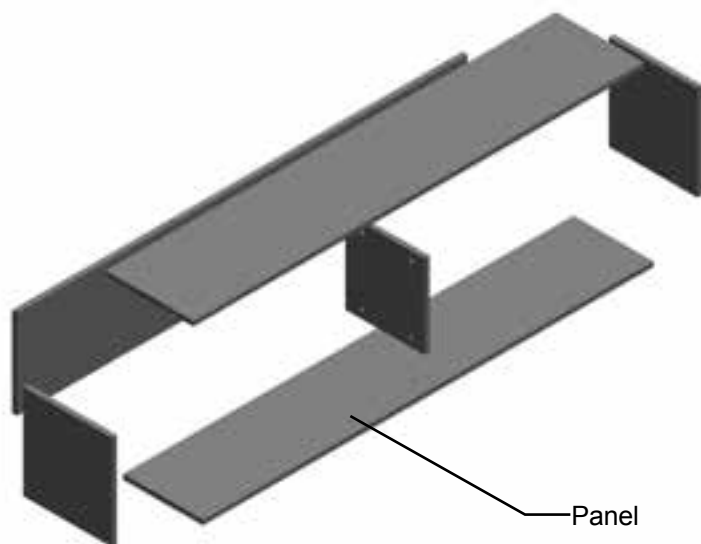

1. Pull hard to remove the panels.

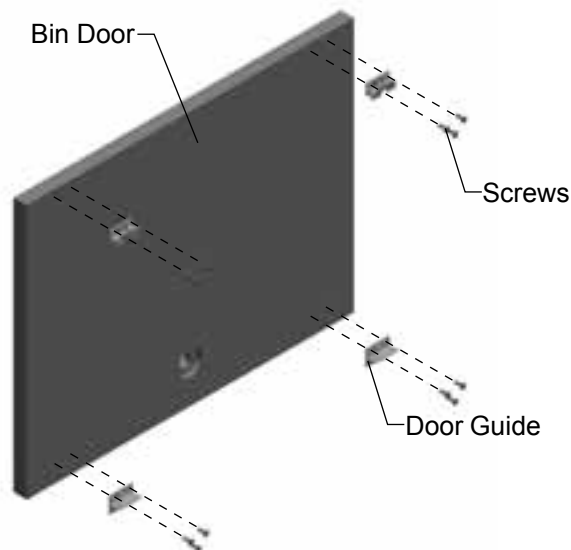

1. Remove screws from door guide.
2. Remove door guides from door.

HermanMiller

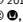
© 2017 Herman Miller, Inc. Zeeland, Michigan. Printed in the U.S.A.
 ©  HermanMiller and Canvas Office Landscape are among the registered trademarks of Herman Miller, Inc.

Illustrations and specifications are based on the latest product information available at the time of publication.
 The right is reserved to make changes in design and specifications at any time, without notice, and also to discontinue products.

Part no. 1b54lj rev J.