

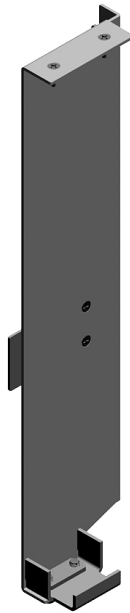

# Canvas Office Landscape® Credenza-to-Frame Support Bracket Installation and Disassembly for Recycling Instructions



FT292.MLN:



FT292.MRN:



FT292.WLG:

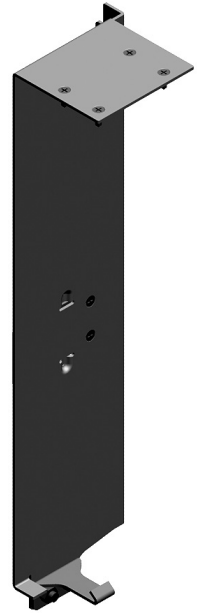

FT292.WRG:

## Parts Included:

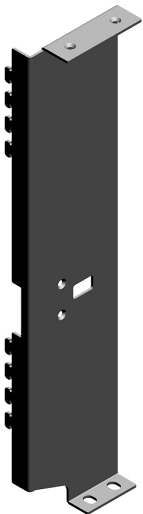

FT292.M



FT292.W



**B** Anti-Dislodgement Bracket

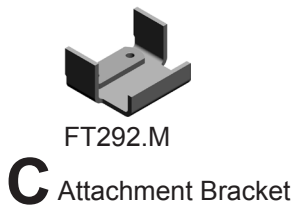

**C** Attachment Bracket



**G** Attachment Bracket

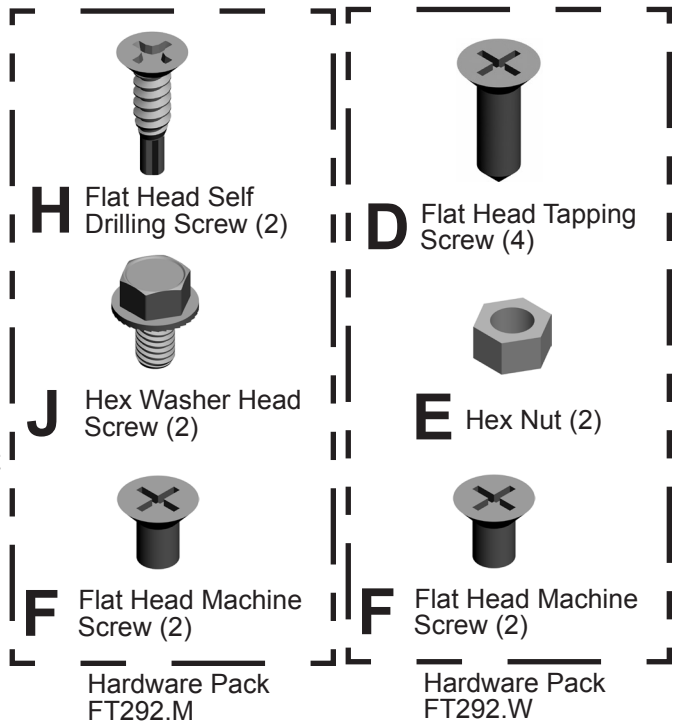

**H** Flat Head Self Drilling Screw (2)



**J** Hex Washer Head Screw (2)



**F** Flat Head Machine Screw (2)

Hardware Pack FT292.M



**D** Flat Head Tapping Screw (4)



**E** Hex Nut (2)



**F** Flat Head Machine Screw (2)

Hardware Pack FT292.W

## Tool Required:

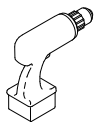

Power Driver



#2 Phillips Bit

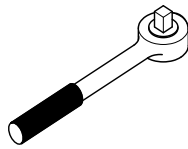

Ratchet Wrench



1/2" Socket



3/32 Drill Bit



Safety Glass

HermanMiller

Part no. 1b6cst rev D.

© 2013 Herman Miller, Inc. Zeeland, Michigan. Printed in the U.S.A.

© Herman Miller and Canvas Office Landscape are among the registered trademarks of Herman Miller, Inc.

Illustrations and specifications are based on the latest product information available at the time of publication.

The right is reserved to make changes in design and specifications at any time, without notice, and also to discontinue products.

## Assembly Instructions:

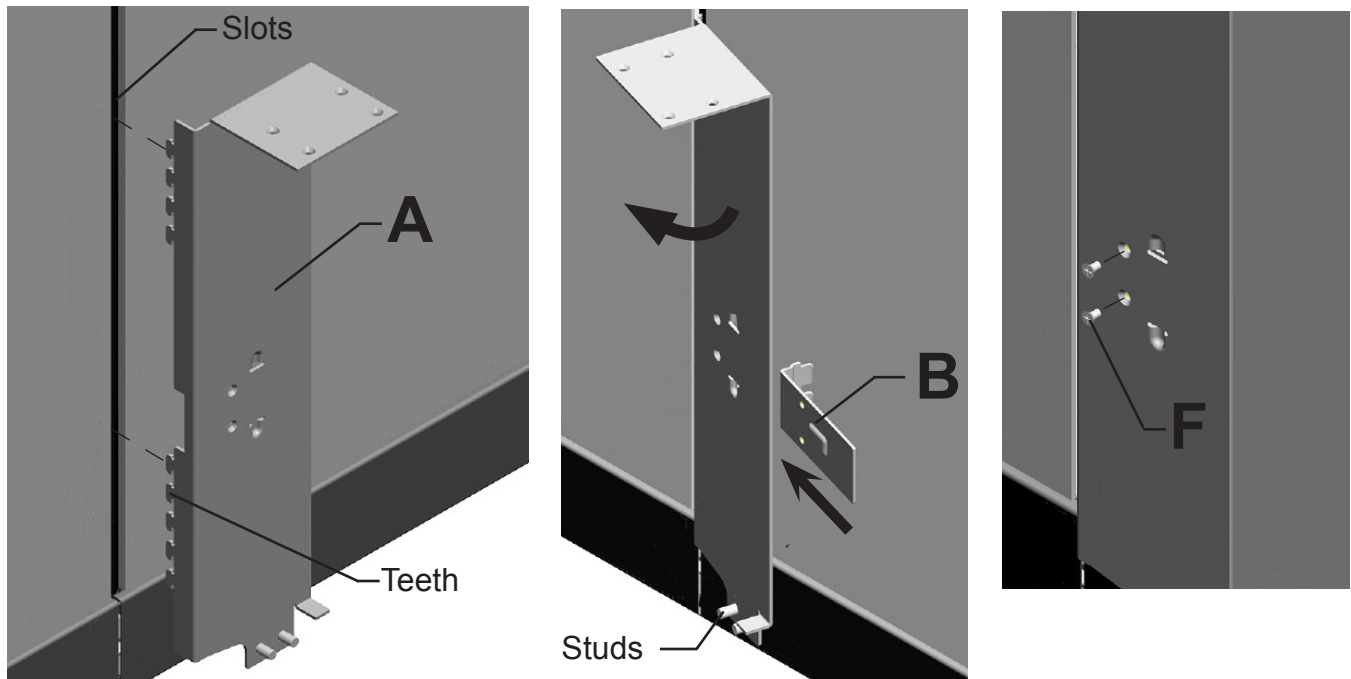

1. Insert teeth of Wall Bracket(A) into slots in frame at desired height.
2. Lift up on Wall Bracket(A). Rotate Bracket outward.
3. Insert Anti-dislodgement Bracket(B) behind Wall Bracket and into frame.
4. Install 2 Flat Head Machine Screws(F).

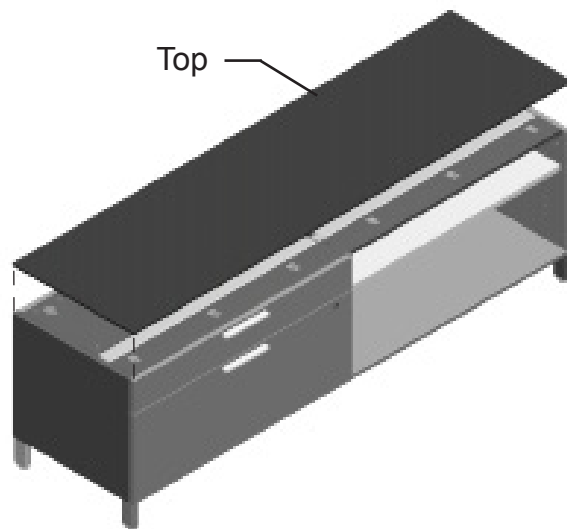

5 Remove Top from Storage Unit.

**HermanMiller**

Part no. 1b6cst rev D.

© 2013 Herman Miller, Inc. Zeeland, Michigan. Printed in the U.S.A.  
©  HermanMiller and Canvas Office Landscape are among the registered trademarks of Herman Miller, Inc.  
Illustrations and specifications are based on the latest product information available at the time of publication.  
The right is reserved to make changes in design and specifications at any time, without notice, and also to discontinue products.

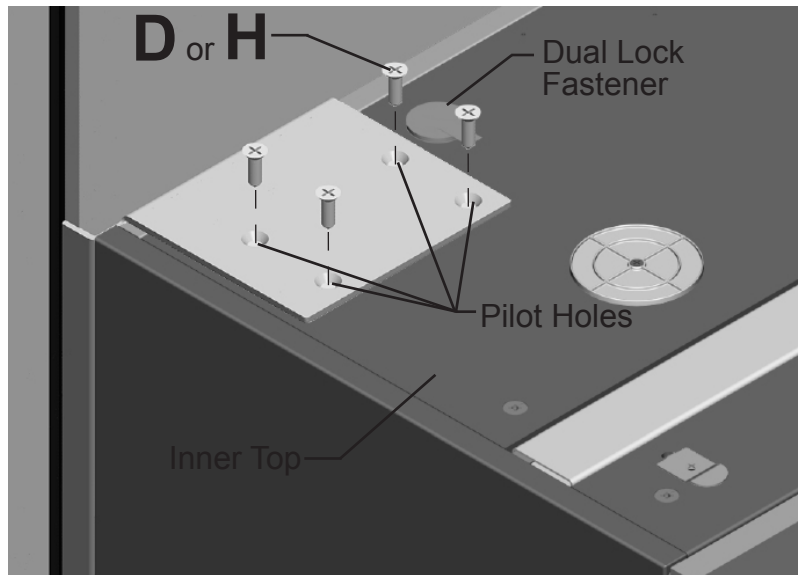
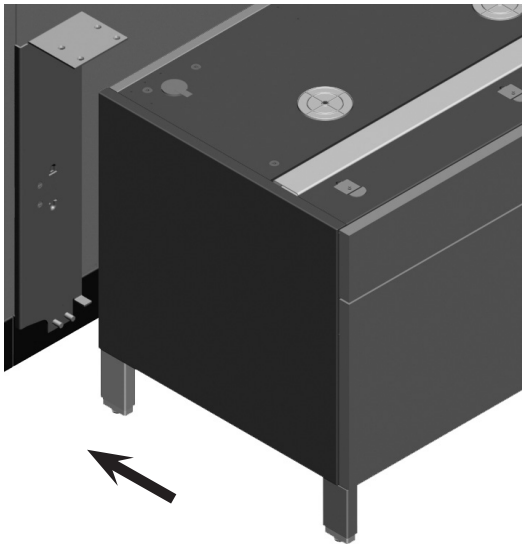

FT292.W Shown

6. Place Storage Unit under Wall Bracket. Align side to side to desired position.
7. Dual Lock Fastener may need to be repositioned on Storage Unit and Top for Wall Bracket attachment.
8. Using 3/32" drill bit, drill Pilot Holes into Inner Top.
9. Notch corrugated Spacer corners to clear Bracket and Dual Lock.
10. Install 4 Flat Head Tapping Screws(D) for FT292.W or 2 Flat Head Drilling Screws(H) for FT292.M.

### **FT292.W:**

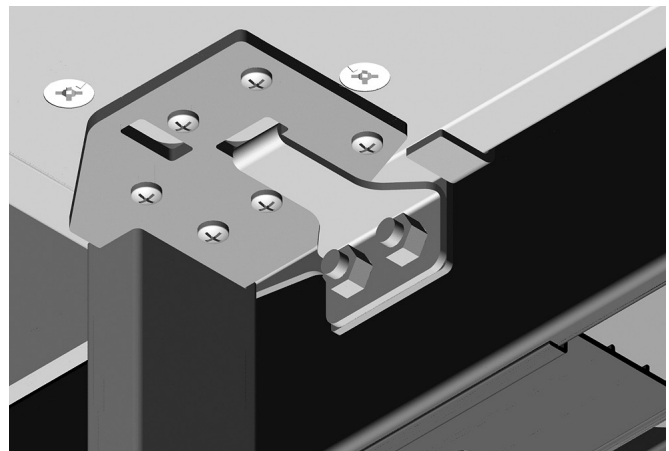
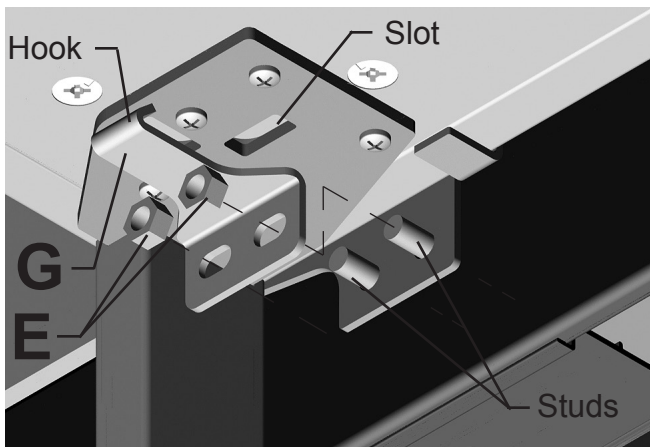

11. From under Storage Unit, position Attachment Bracket(G) onto Studs on Anti-Dislodgement Bracket. Engage Hook on Bracket into Slot in Leg Assembly.
12. Install 2 Hex Nuts(E) onto Studs.

## **FT292.M:**

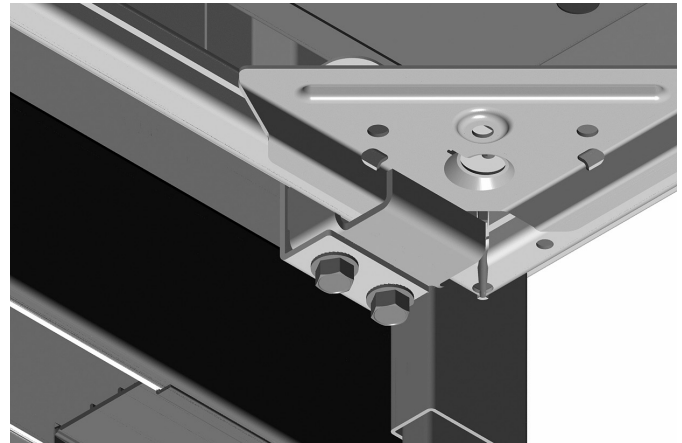
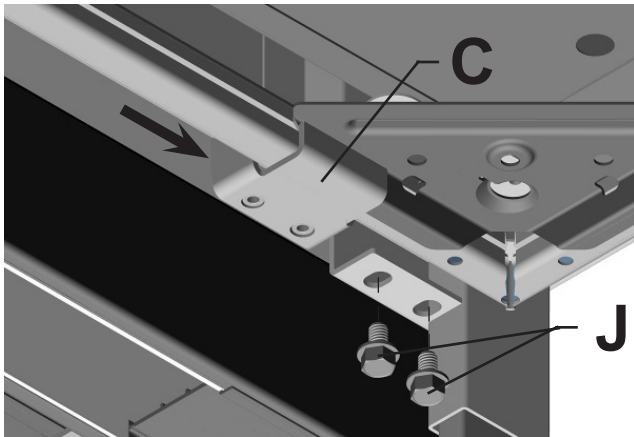

13. From under Storage Unit, position Attachment Bracket(C) onto bottom edge of storage unit . Slide Attachment Bracket onto Lip on Support Bracket.
14. Install 2 Hex Washer Head Screws.

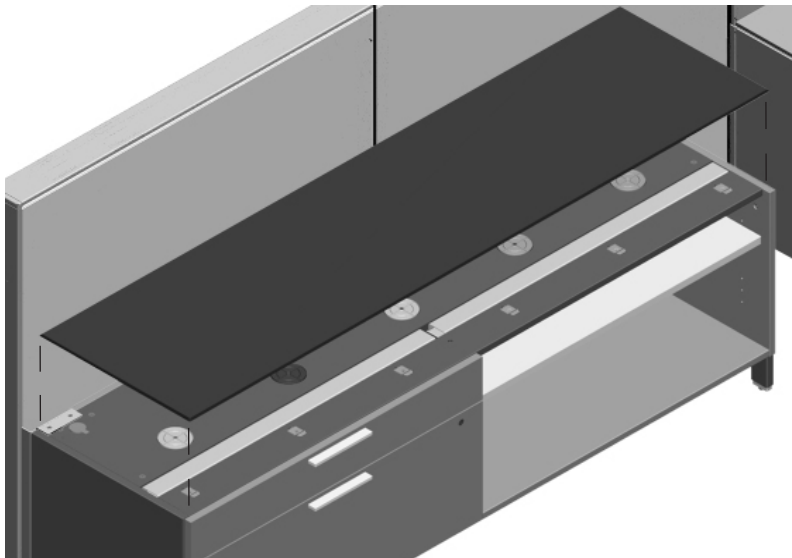

15. Return Top to Storage Unit.

### Leveling:

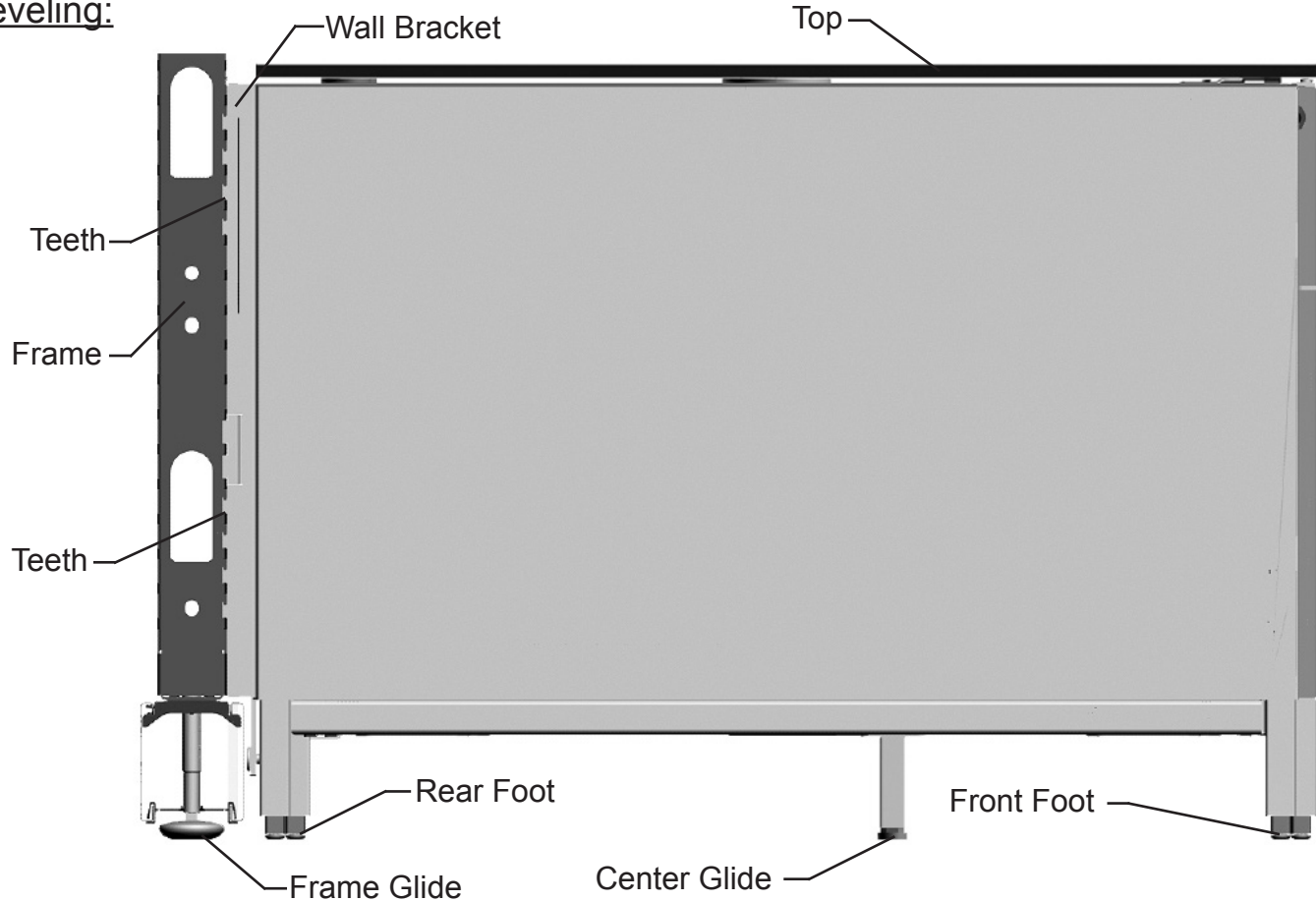

16. Make sure Wall Bracket Teeth are fully engaged into Wall Frame.
17. Adjust Frame and Front Foot of credenza while Rear Foot of credenza should be elevated until unit is leveled. Then lower Rear Foot until touching floor. Be careful not to create gap between credenza Top and Wall Bracket.

## **Disassembly for Recycling:**

### **Materials Identification and Segregation:**

Where possible, plastic components are marked with ASTM recycling codes. Use these codes to identify material type for recycling. Non marked components should be treated as mixed plastic. Ferrous metals can be identified using a small magnet for recycling. Non-ferrous metals should be separated and recycled separately.

To disassemble product, reverse steps 17 through 1.