

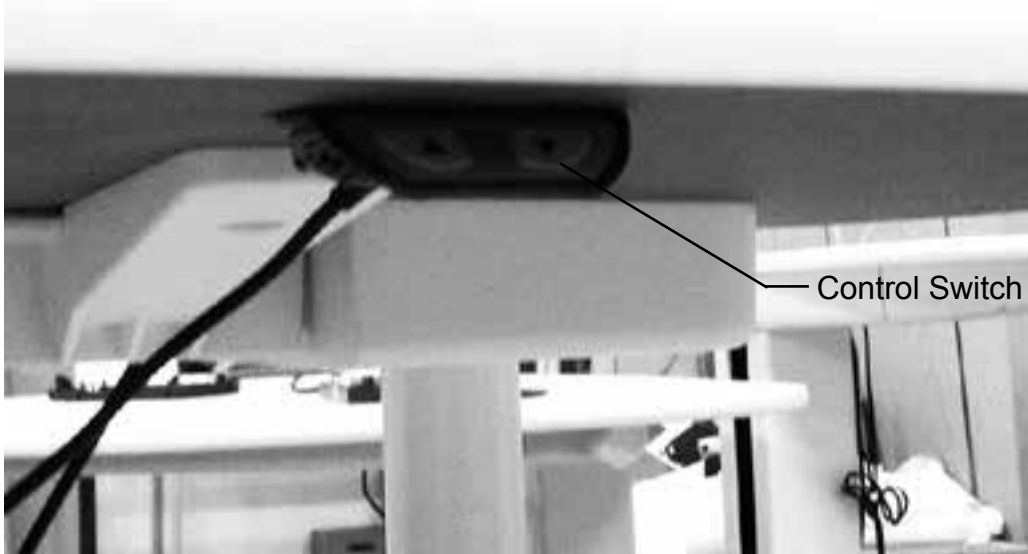

LOCALE HEIGHT ADJUSTABLE DESK OPERATING INSTRUCTIONS

CAUTION: WHEN OPERATING THIS DESK, MAKE SURE TO REMOVE ANY OBJECTS OR OBSTRUCTIONS THAT COULD BE IN THE WAY OF THE MOVING DESK TOP. The rated load For the desk is 200 lbs. maximum.

- 1) To operate the height adjustable desk, press the up or down arrows on the control switch located under the front edge of the desk top.
- 2) Press the up arrow to move the desk top higher.
- 3) Press the down arrow to move the desk top lower.



PARAMÈTRES RÉGIONAUX RÉGLABLE EN HAUTEUR BUREAU INSTRUCTION DE FONCTIONNEMENT

ATTENTION : LORS DE L'UTILISATION DE CE BUREAU, ASSUREZ-VOUS DE RETIRER TOUT OBJESCTS OU OBSTRUCTIONS QUI POURRAIENT ÊTRE DANS LA FACON DE LE DEPLACER DESSUS DE BUREAU. LA CHARGE NOMINAL POUR LE BUREAU EST DE 90.7 KG MAXIMUM.

- 1) Pour faire fonctionner la hauteur réglable de bureau, appuyez sur les flèches vers le haut ou le bassur le commutateur de commande situé sous le bord du bureau.
- 2) Appuyez sur la flèche vers le haut pour déplacer le desk top supérieur.
- 3) Appuyez sur la flèche vers le bas pour déplacer le bureau inférieur le plus haut.

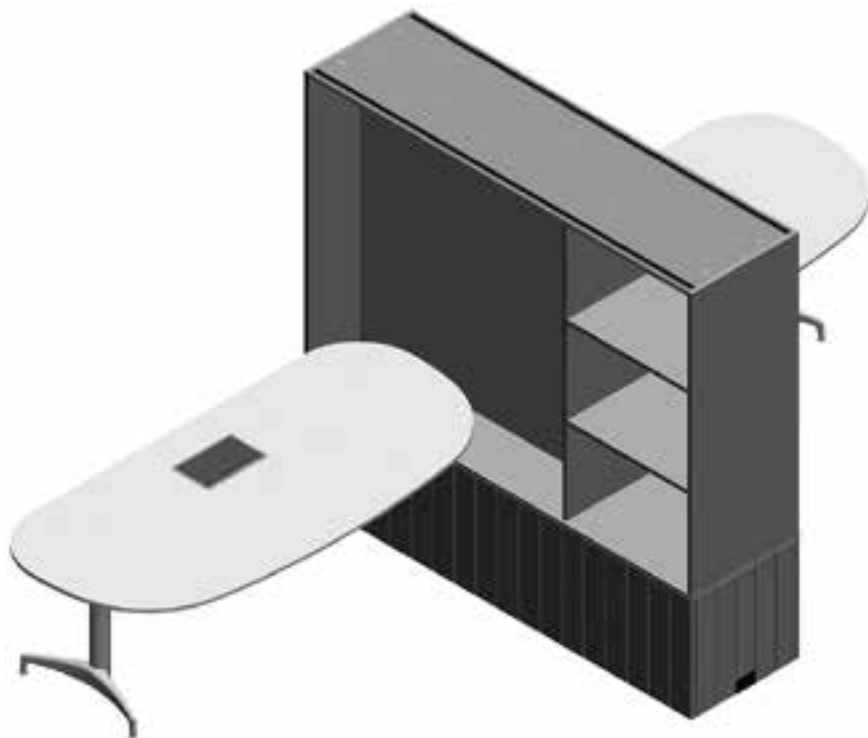

L-Desk
(Shown throughout instructions)

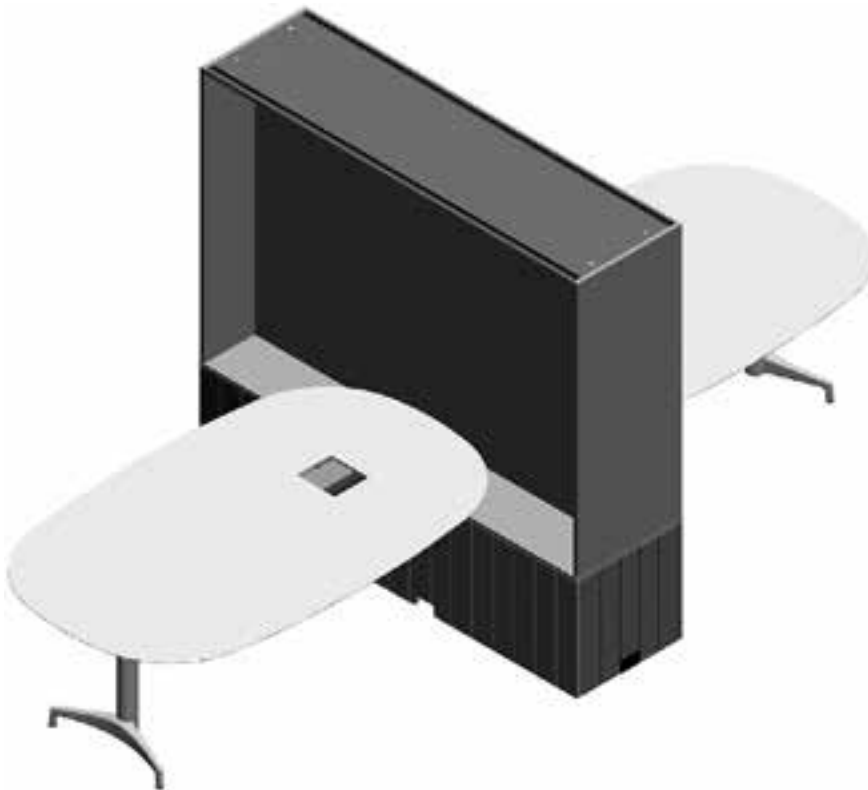

T-Desk

Parts Included:



A Base Assembly

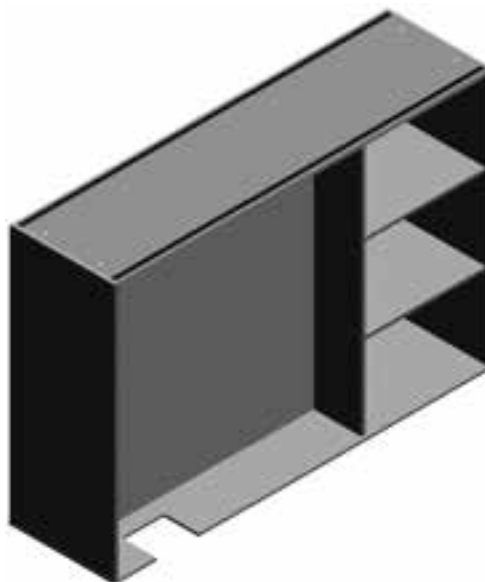

B Upper Case

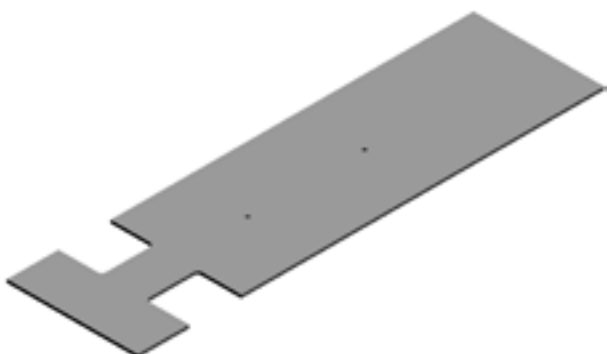

C Base Top



D Column



E M8 x 16 Hex Socket Head Machine Screw (4)



F M6 x 20 Socket Flange Head Screw(8)



G Column Shroud



H Wire Guide



J End Column



K Rail



L Work Surface Support



M M8 x 30 Socket Flat Head Machine Screw(12)



N Control Switch

HermanMiller

Part no. 1bch5g rev D.

© 2017 Herman Miller, Inc. Zeeland, Michigan. Printed in the U.S.A.
™ Sense, Setu, Tu, Traverse and Locale are among the trademarks of Herman Miller, Inc.

Illustrations and specifications are based on the latest product information available at the time of publication.
The right is reserved to make changes in design and specifications at any time, without notice, and also to discontinue products.



P Motor Cable



R Power Cable



T Cable Clamp



U Service Chain

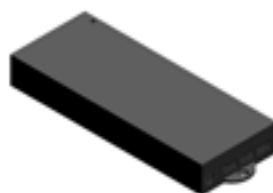

W Control Box

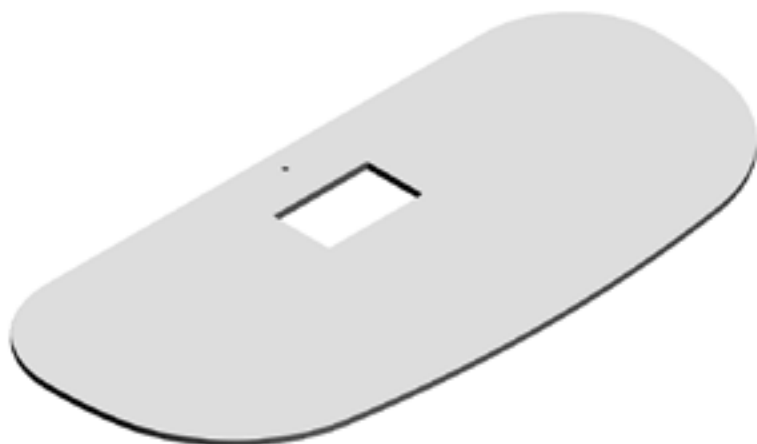

V Work Surface



X M5 x 12 Socket Button Head Cap Screw(4)



Z M5 x 12 Socket Button Flange Head Machine Screw(22)



Y Mushroom Fastener(6)



AJ M5 x 16 Socket Button Head Flange Screw(6)



AA Cable Tray

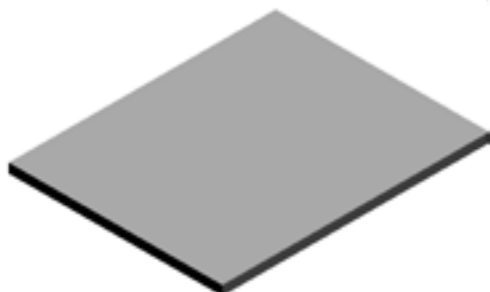

AC Shelf(2)



AD Shelf Pins(8)



AB Wire Tray



AE Grommet Clamp(2)



AF M3.5 x 12 Plastite Pozi Pan Head Screw



AG Clamping Screw

HermanMiller

Part no. 1bch5g rev D.

© 2017 Herman Miller, Inc. Zeeland, Michigan. Printed in the U.S.A.
™ Sense, Setu, Tu, Traverse and Locale are among the trademarks of Herman Miller, Inc.

Illustrations and specifications are based on the latest product information available at the time of publication.
The right is reserved to make changes in design and specifications at any time, without notice, and also to discontinue products.

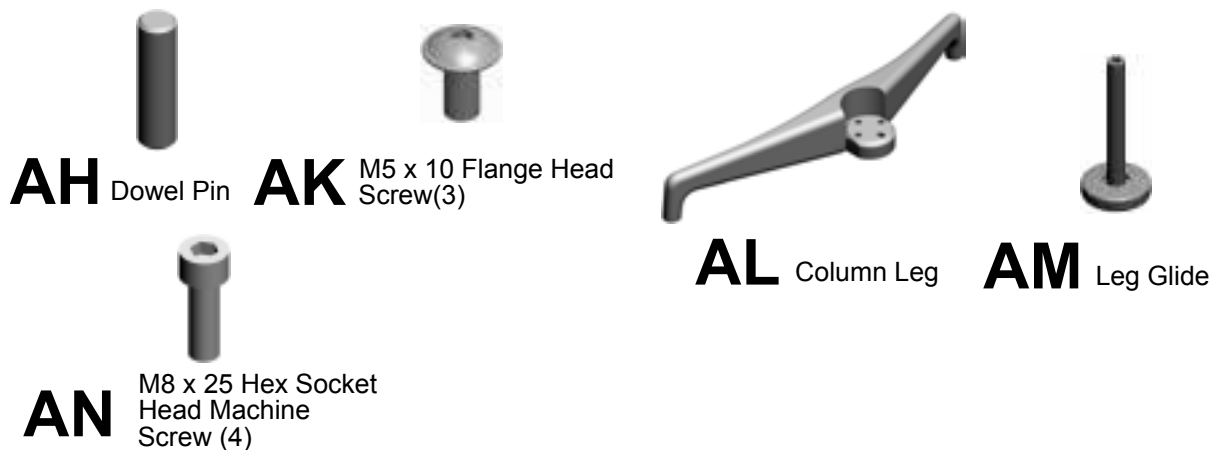

Tools Needed:

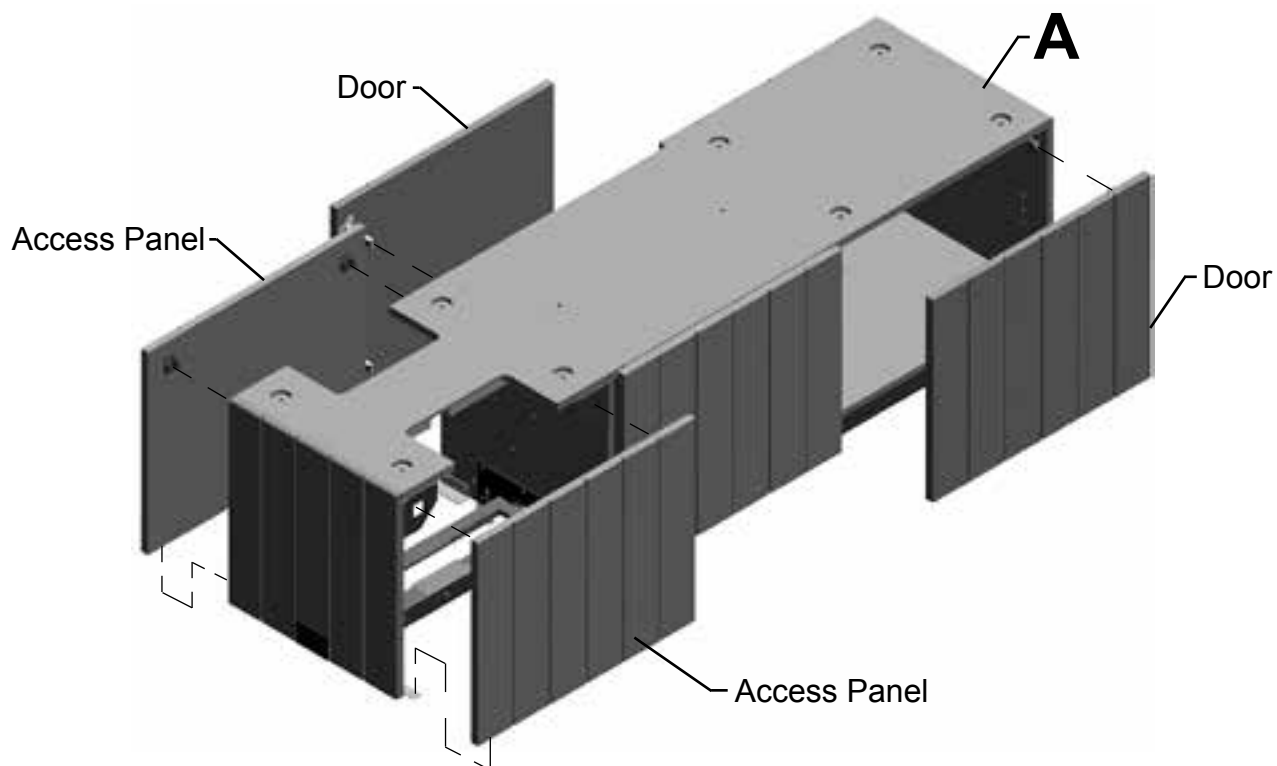
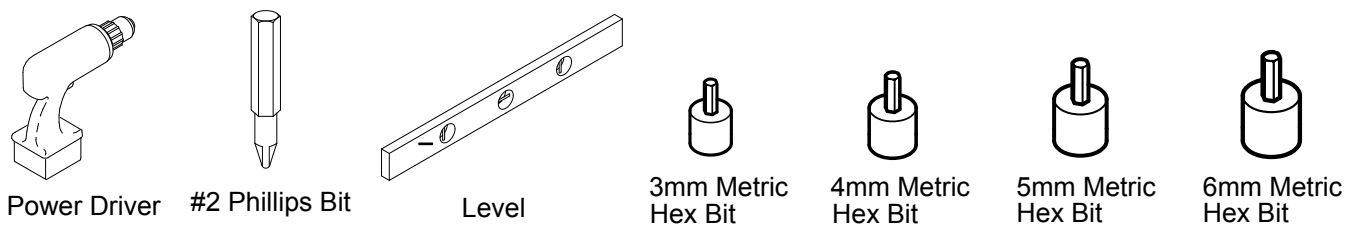

1. Place Base at desired location.
2. Open or remove Doors.
3. Remove Access Panels by pulling out at top of panel, then lifting up and out.

HermanMiller

Part no. 1bch5g rev D.

© 2017 Herman Miller, Inc. Zeeland, Michigan. Printed in the U.S.A.
™ Sense, Setu, Tu, Traverse and Locale are among the trademarks of Herman Miller, Inc.

Illustrations and specifications are based on the latest product information available at the time of publication.
The right is reserved to make changes in design and specifications at any time, without notice, and also to discontinue products.

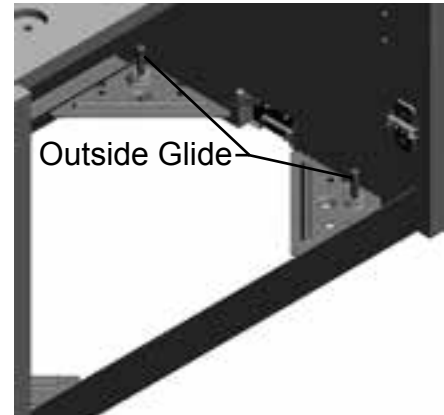
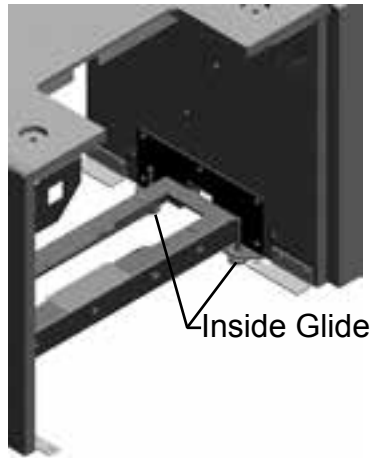
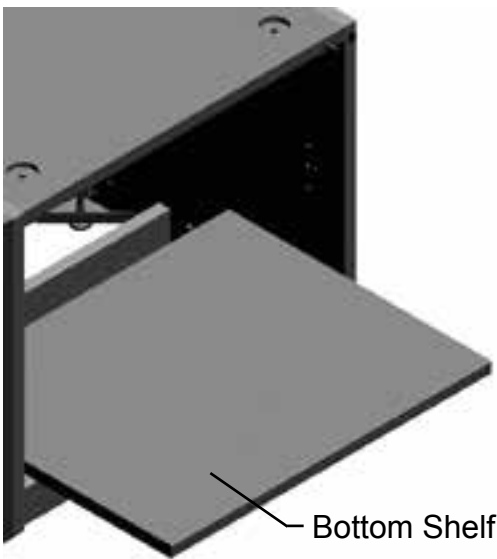

4. Remove Bottom Shelves from Base.
5. Level base by adjusting Outside Glides first. Then adjust Inside Glides down to touch floor.

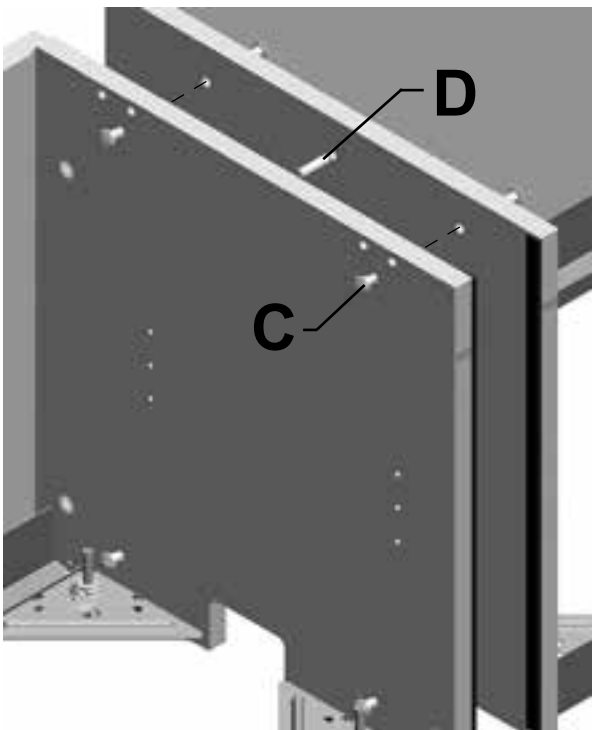

(Note: View shown with top panel removed for clarity.)

6. If More than one unit are to be installed in a run; position adjoining unit next to one already in position.
7. Level and align that unit to mate with other.
8. Connect bases with 4 Clamping Screws (C) and 1 Dowel Pin (D).

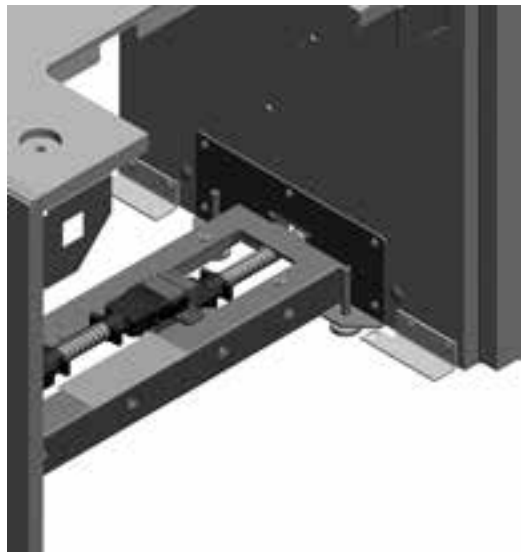
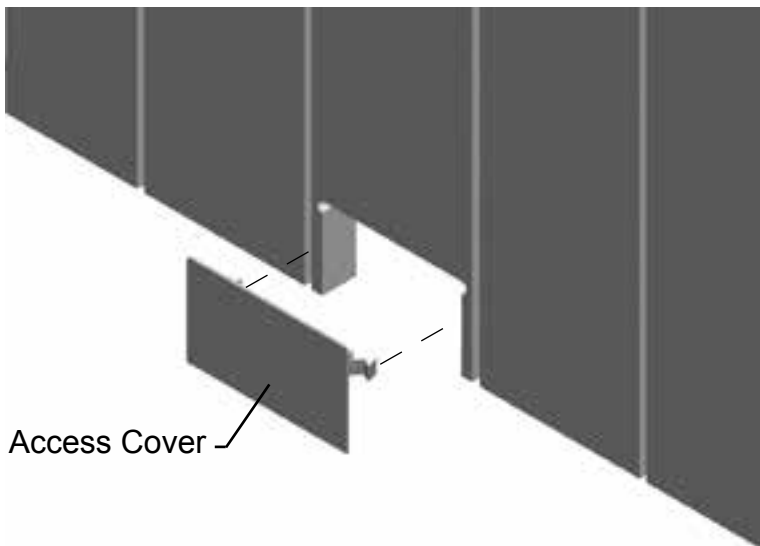

9. Remove Access Covers from Base End Panels.
10. Install Electrical Harnesses to Base.

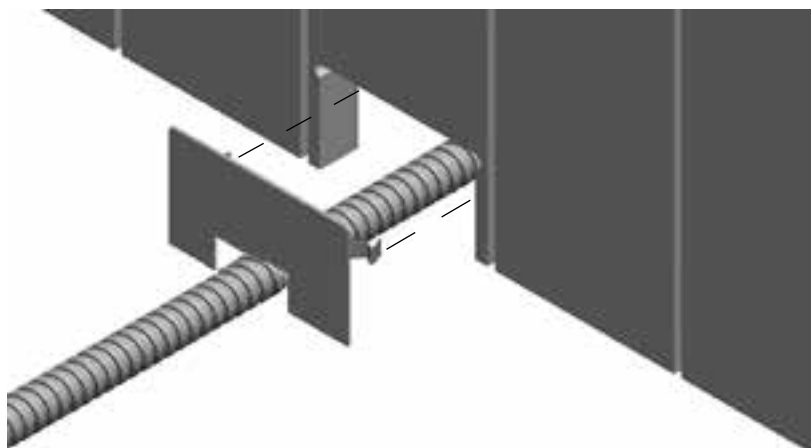
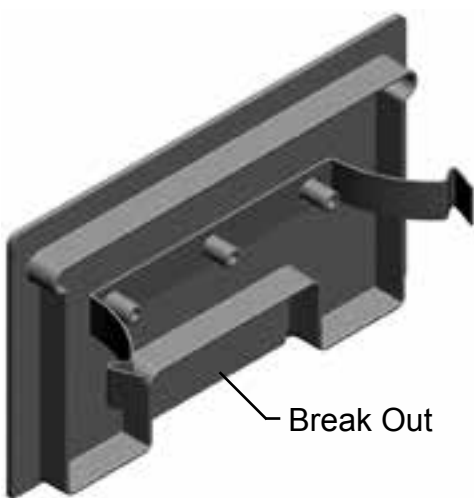

11. Break out opening in Access Covers if required.
12. Return Access covers to Base.

HermanMiller

Part no. 1bch5g rev D.

© 2017 Herman Miller, Inc. Zeeland, Michigan. Printed in the U.S.A.
™ Sense, Setu, Tu, Traverse and Locale are among the trademarks of Herman Miller, Inc.

Illustrations and specifications are based on the latest product information available at the time of publication.
The right is reserved to make changes in design and specifications at any time, without notice, and also to discontinue products.

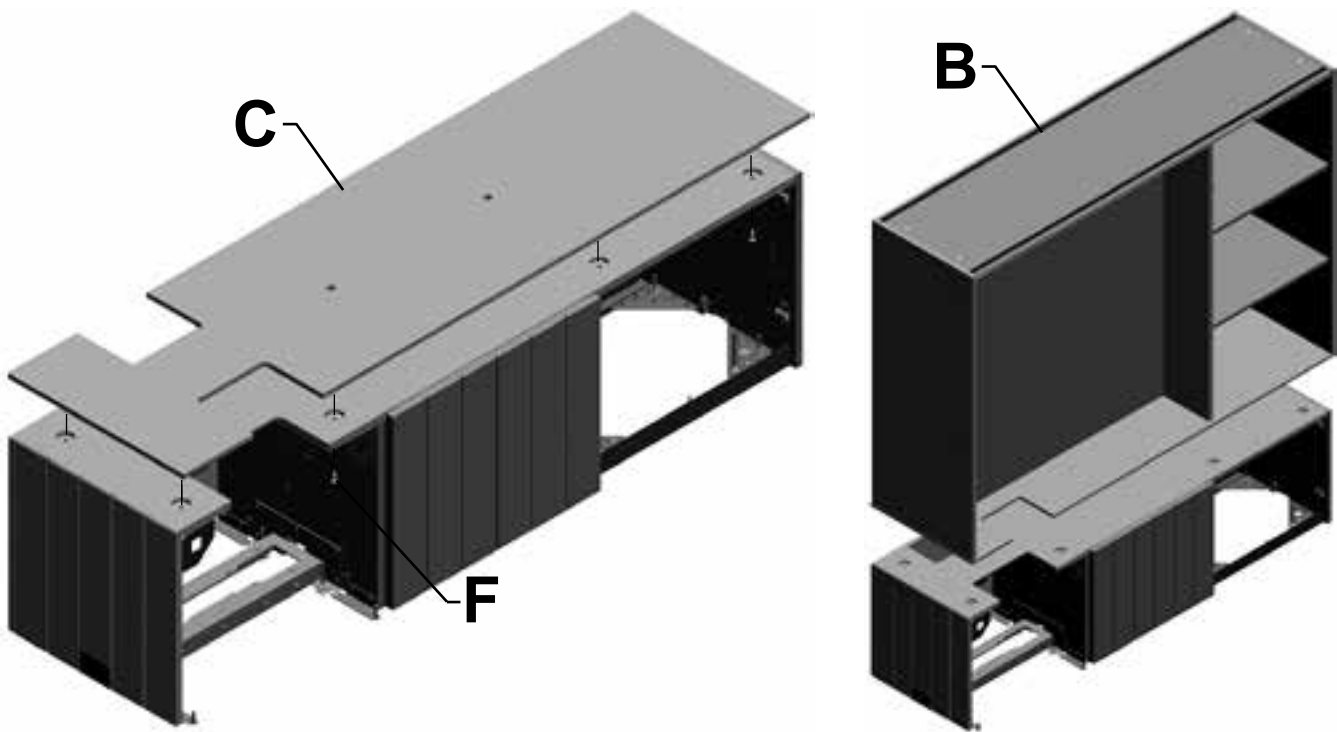

13. Position Base Top (C) or Upper Case(B) onto Base. Secure to Base with 8 Pan Head Machine Screws (F).

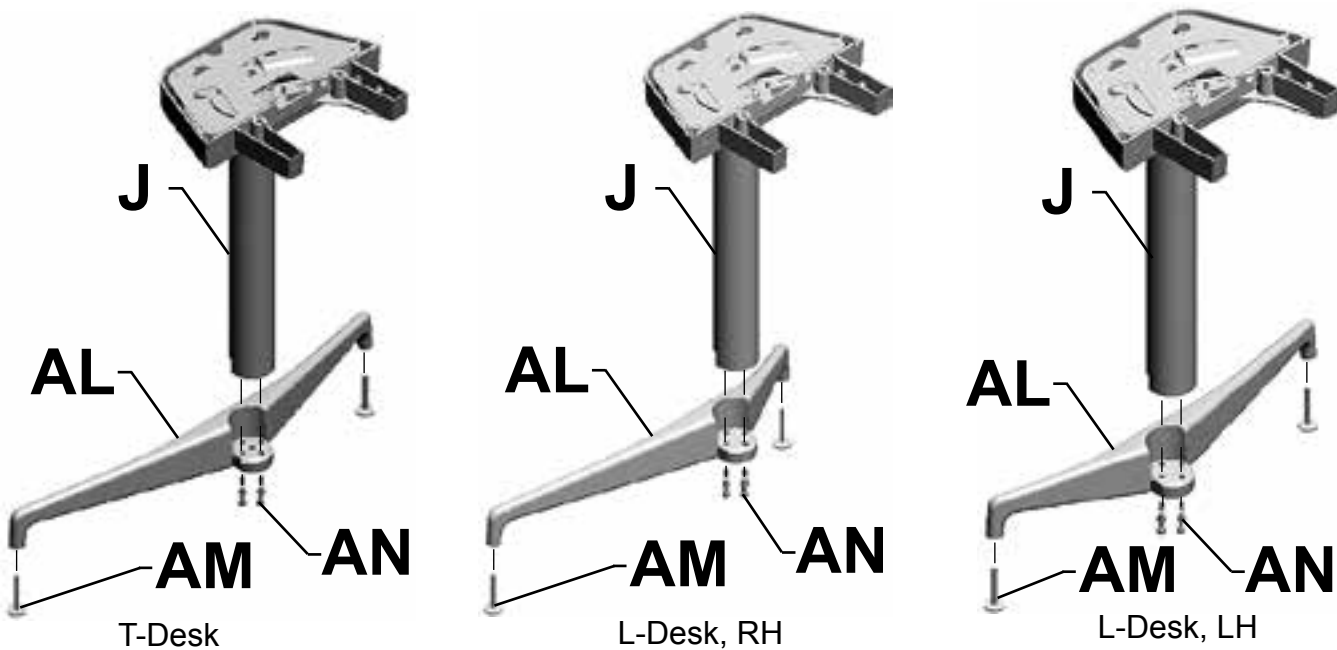

14. Turn Glides (AM) into Column Leg (AL).
15. Attach Column Leg to End Column (J) with 4 Hex Socket Head Machine Screws (AN) with the torque 130 inch lbs or 15 Nm force.

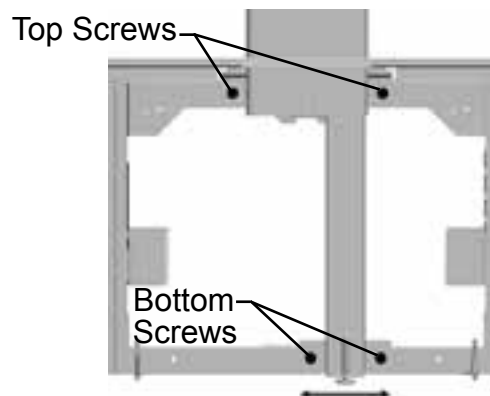
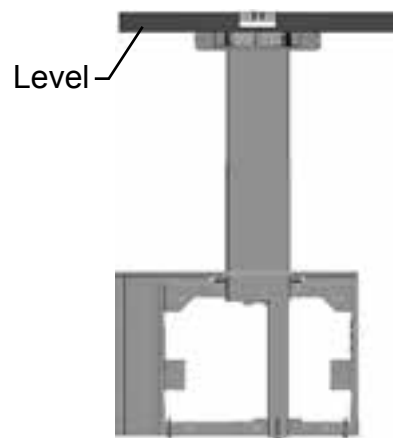
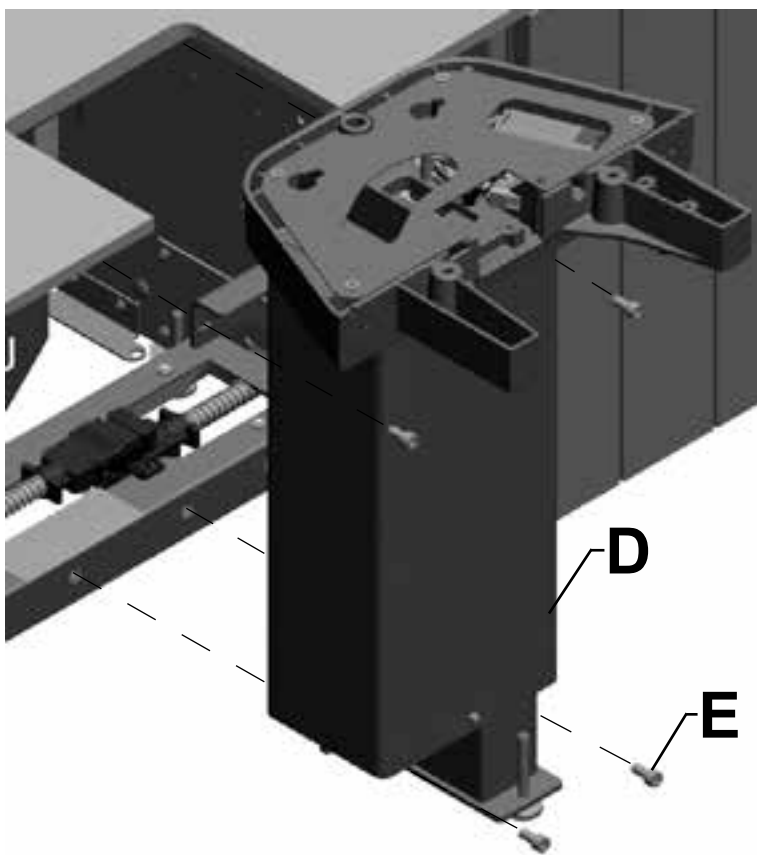

16. Assemble Column(s) (D) to Base with 4 Socket Head Machine Screws (E).
17. Fully Tighten Top Screws. Loosely tighten Bottom Screws.
18. Move lower end end of column until Level on top casting shows true.
19. Fully tighten Bottom Screws.

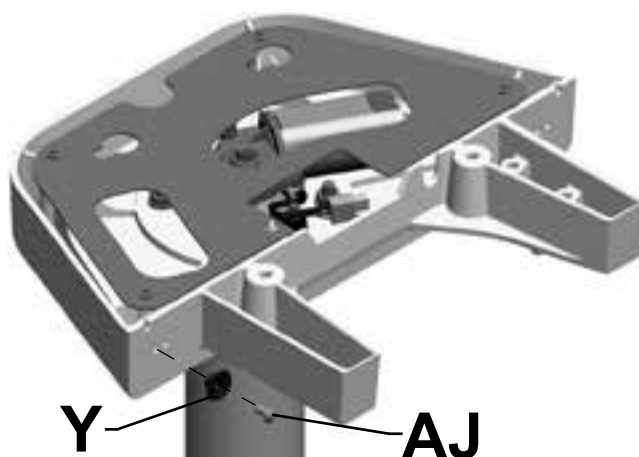
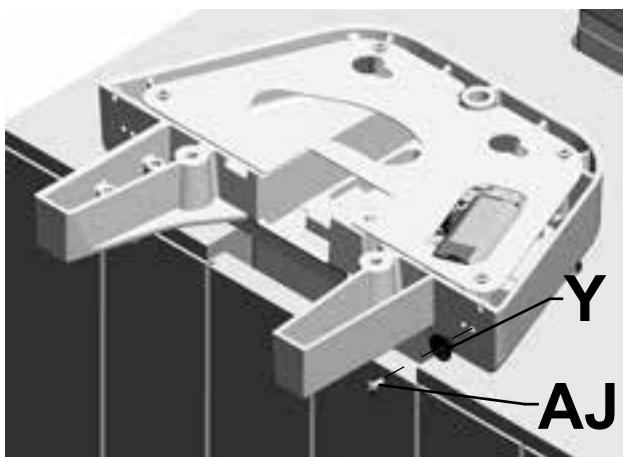

20. Determine which side of Work Surface Wire Cover will be accessed from. Attach Mushroom Fastener (Y) to Column and End Column with Flange Screws (AJ) where cover will latch. Image shows correct position for T-Desk.

HermanMiller

Part no. 1bch5g rev D.

© 2017 Herman Miller, Inc. Zeeland, Michigan. Printed in the U.S.A.

™ Sense, Setu, Tu, Traverse and Locale are among the trademarks of Herman Miller, Inc.

Illustrations and specifications are based on the latest product information available at the time of publication.

The right is reserved to make changes in design and specifications at any time, without notice, and also to discontinue products.

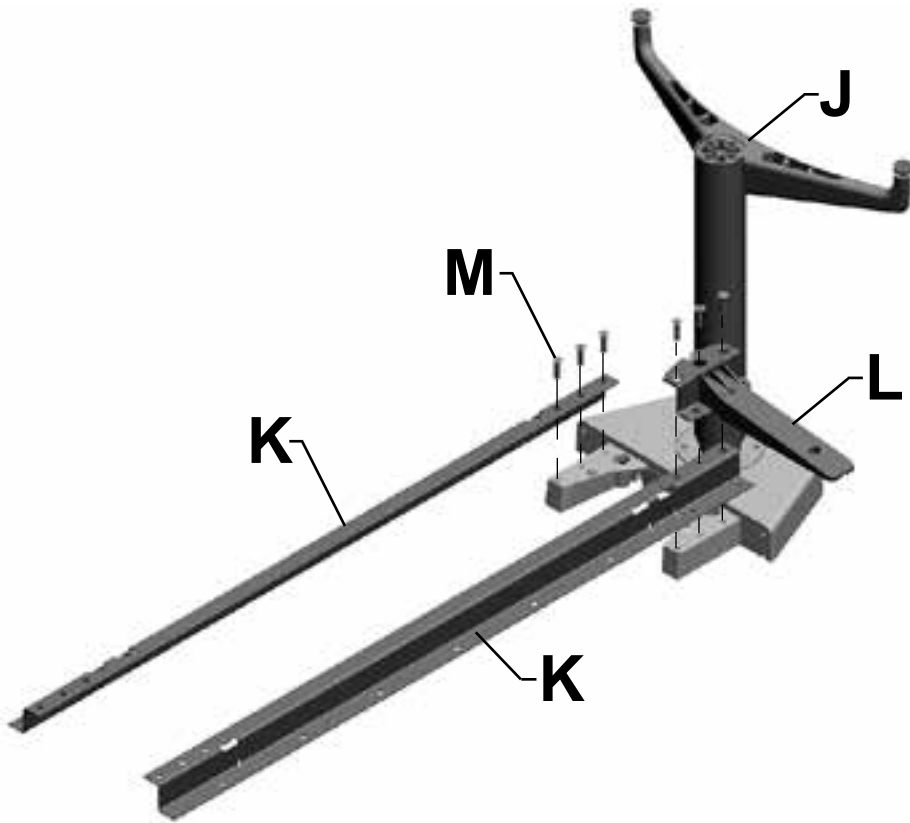

21. Place End Column (J) bottom side up.
22. Set Rails (K) onto Column (J).
23. Position Work Surface Support (L) onto Rail.
24. Secure all together with 6 Flat Head Machine Screws (M).

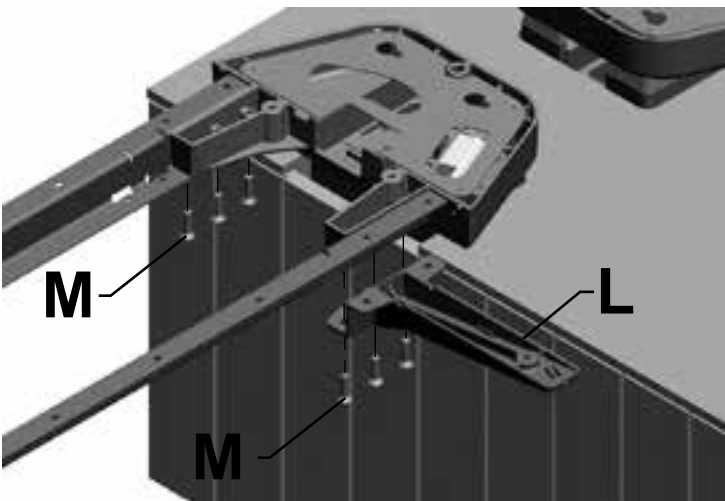

25. Place the assembly onto the Column.
26. Position the other Work Surface Support (K) onto Rail.
27. Secure all in place with 6 Flat Head Machine Screws (L).

HermanMiller

Part no. 1bch5g rev D.

© 2017 Herman Miller, Inc. Zeeland, Michigan. Printed in the U.S.A.
™ Sense, Setu, Tu, Traverse and Locale are among the trademarks of Herman Miller, Inc.

Illustrations and specifications are based on the latest product information available at the time of publication.
The right is reserved to make changes in design and specifications at any time, without notice, and also to discontinue products.

28. Level outboard round column by placing level on top of casting.

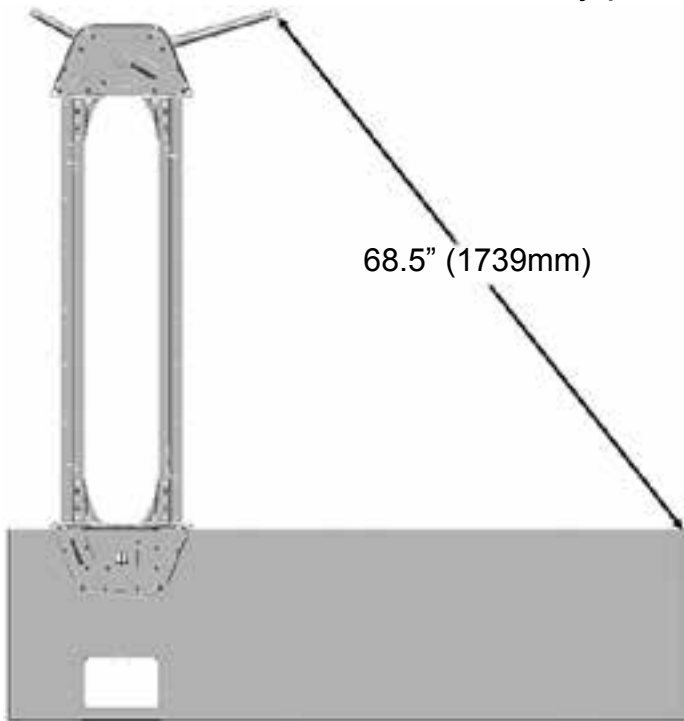

29. Adjust Positioning of Outboard Leg on L-desk by measuring from edge of workbase to front glide of column.

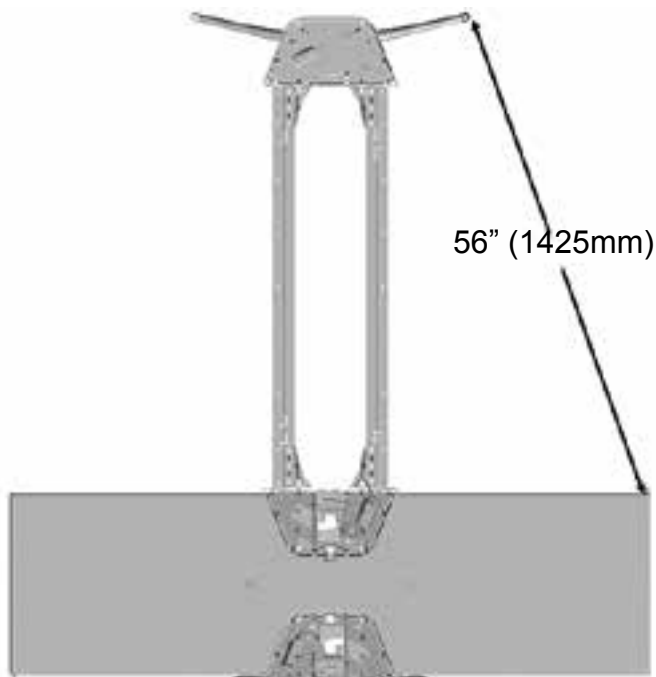

30. Adjust Positioning of Outboard Leg on T-desk by measuring from edge of workbase to front glide of column.

HermanMiller

Part no. 1bch5g rev D.

© 2017 Herman Miller, Inc. Zeeland, Michigan. Printed in the U.S.A.
™ Sense, Setu, Tu, Traverse and Locale are among the trademarks of Herman Miller, Inc.

Illustrations and specifications are based on the latest product information available at the time of publication.
The right is reserved to make changes in design and specifications at any time, without notice, and also to discontinue products.

31. For connecting to building power, refer to BRE01. and BRE02. installation instructions.



32. Connect lift wiring to Control Box (W).



33. Run cycle test on column. Raise column to full height.

HermanMiller

Part no. 1bch5g rev D.

© 2017 Herman Miller, Inc. Zeeland, Michigan. Printed in the U.S.A.

™ Sense, Setu, Tu, Traverse and Locale are among the trademarks of Herman Miller, Inc.

Illustrations and specifications are based on the latest product information available at the time of publication.

The right is reserved to make changes in design and specifications at any time, without notice, and also to discontinue products.

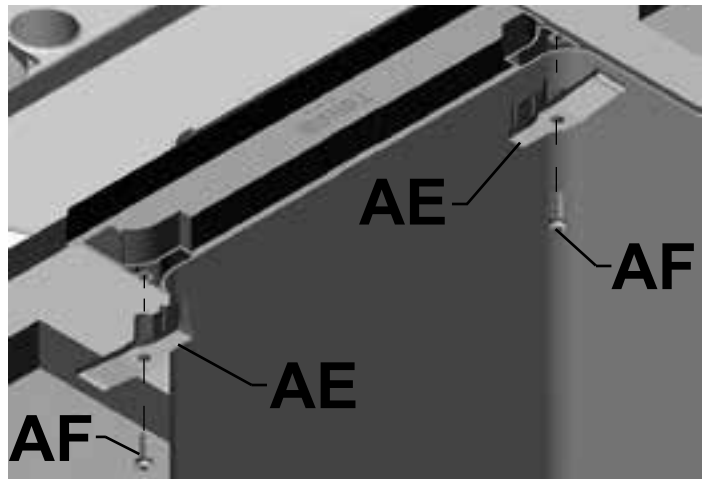
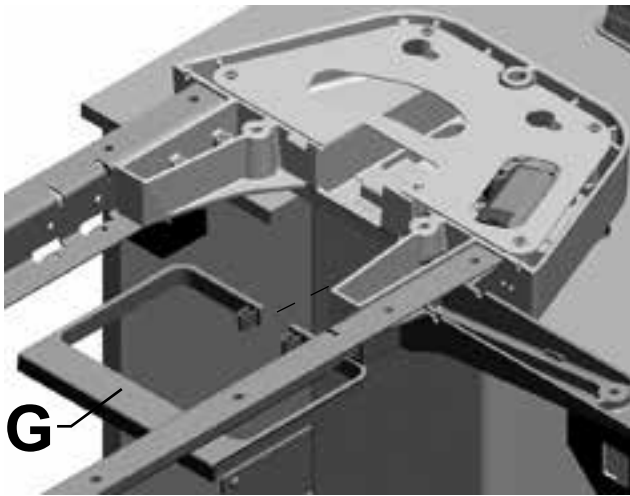

34. Position Shroud (G) around top of Column. Press down onto Base Top.

35. Secure Shroud in place with 2 Shroud Clamps (AE) and Pan Head Screw (AF).

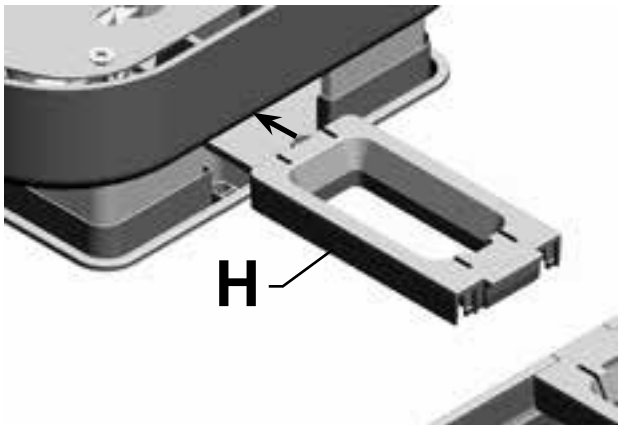

36. Insert Wire Guide (H) into Column. Press down to snap into Shroud and steel bracket.



37. Lay chain on the floor with the open side of both end links point up. Then use a Straight / Flat blade screwdriver to open each clasp.

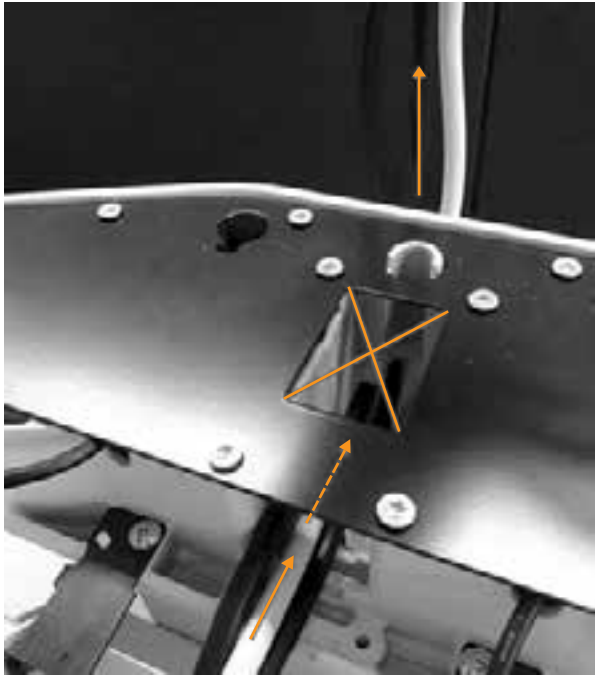

38. Fully raise the column before installing chain and cords. Feed your cords from the front all the way through the column and out the back side.



39. Place your cords into the chain, either end of the chain can be the top side. Then close all but the top 3 or 4 links open for ease of attaching brackets later.

HermanMiller

Part no. 1bch5g rev D.

© 2017 Herman Miller, Inc. Zeeland, Michigan. Printed in the U.S.A.
™ Sense, Setu, Tu, Traverse and Locale are among the trademarks of Herman Miller, Inc.

Illustrations and specifications are based on the latest product information available at the time of publication.
The right is reserved to make changes in design and specifications at any time, without notice, and also to discontinue products.

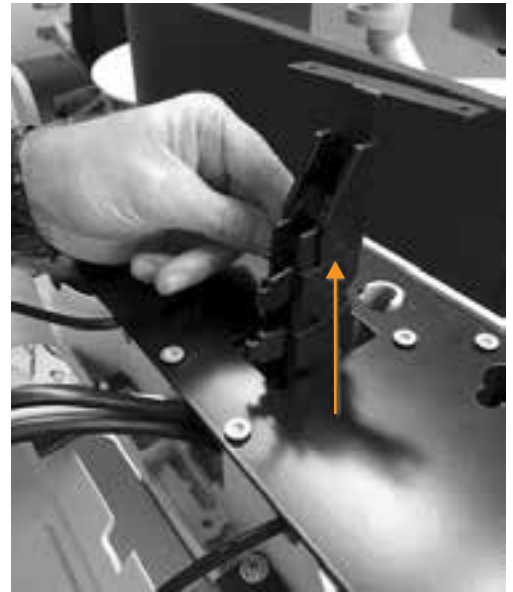
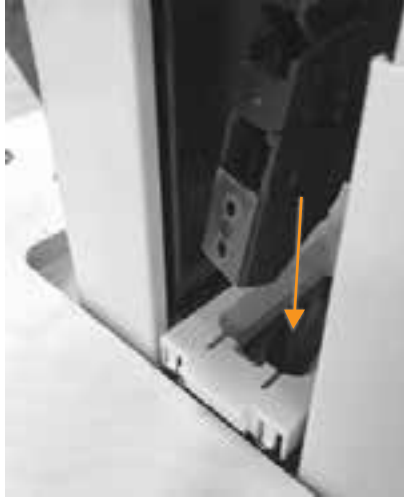

40. Feed energy chain through the grommet which is even with the work base top and then through the top of the plate on the leg column making sure the snap open side is facing towards the desk side of the leg. (Make sure the plastic grommet is installed before you feed the chain through)



41. Attach top bracket.

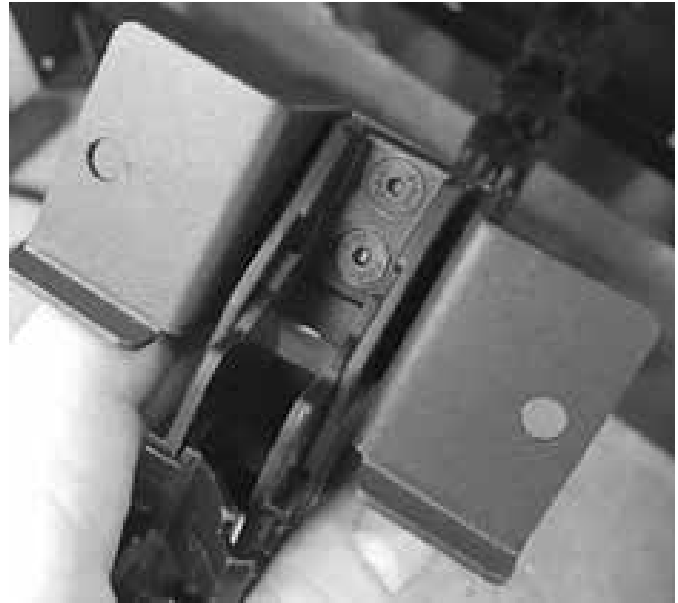

42. After the chain is through the grommet and inside the work base install the bottom bracket to the chain.

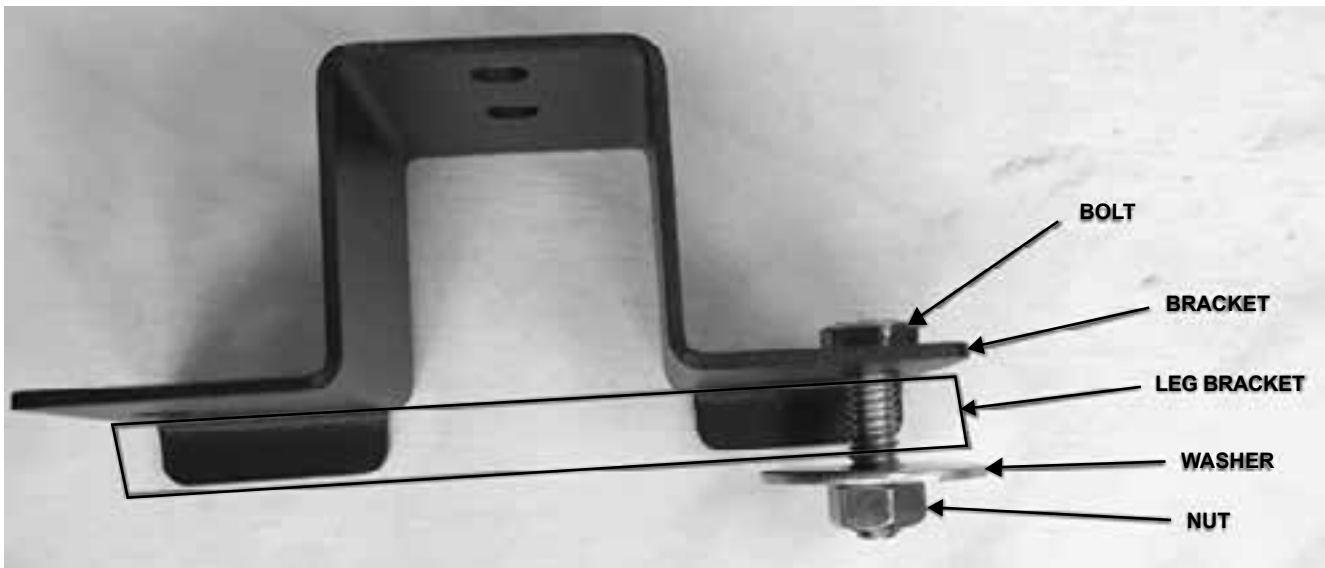

43. Install the bottom bracket to the upper inner framework hardware that attaches the leg to the upper part of the work base. The bolt goes through bracket, then the triangular opening of the leg attachment bracket, with the washer and nut on the other side. (For a clearer view pictures do not show the chain)



44. At the top of the leg feed the cords into the trough area and close the top clasps that remained open on both ends of the chain.

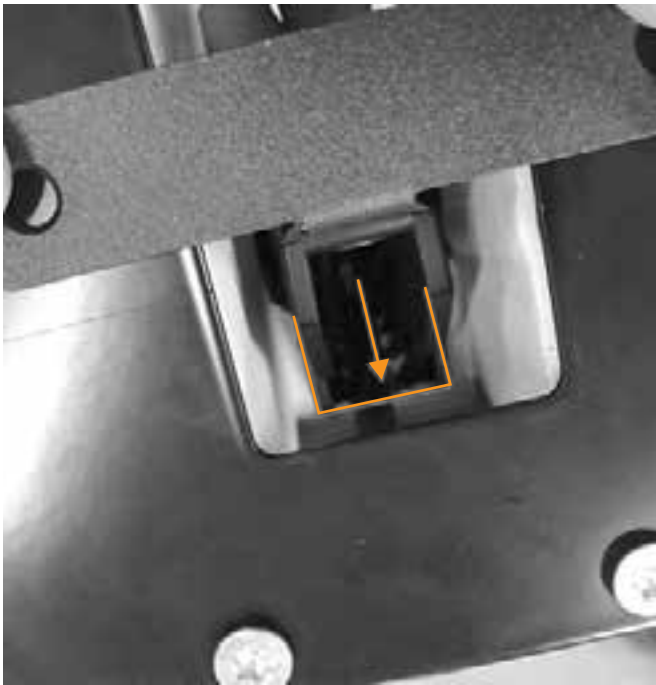

45. Push the chain as far forward as possible while keeping the top bracket flush on the top plate.

HermanMiller

Part no. 1bch5g rev D.

© 2017 Herman Miller, Inc. Zeeland, Michigan. Printed in the U.S.A.

™ Sense, Setu, Tu, Traverse and Locale are among the trademarks of Herman Miller, Inc.

Illustrations and specifications are based on the latest product information available at the time of publication.

The right is reserved to make changes in design and specifications at any time, without notice, and also to discontinue products.



46. Screw bracket down to the top plate using the self-drilling screws. (NOTE: On L and T desks, only one side of the bracket will screw onto the top plate)

HermanMiller

Part no. 1bch5g rev D.

© 2017 Herman Miller, Inc. Zeeland, Michigan. Printed in the U.S.A.

™ Sense, Setu, Tu, Traverse and Locale are among the trademarks of Herman Miller, Inc.

Illustrations and specifications are based on the latest product information available at the time of publication.

The right is reserved to make changes in design and specifications at any time, without notice, and also to discontinue products.

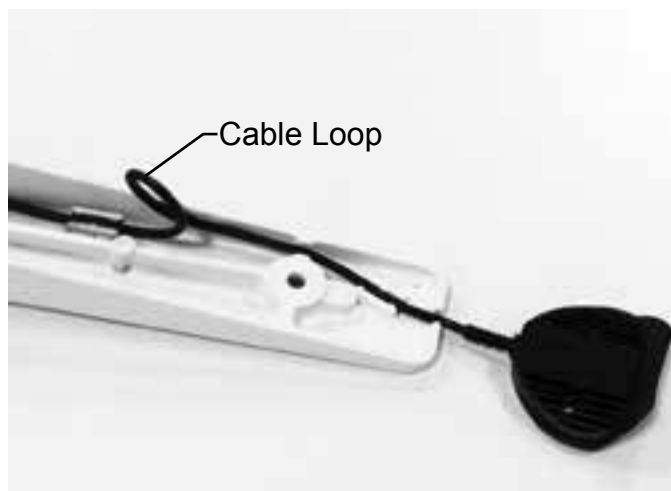

47. Wrap Control Switch Cable underneath z rails so it is trapped in gap between two castings.

48. Press Control Switch cable firmly into cable retaining guides in Work Surface Supports. Make loop in cable to take up slack in cable.

CARE Point - cable needs to be taught to aid retention.

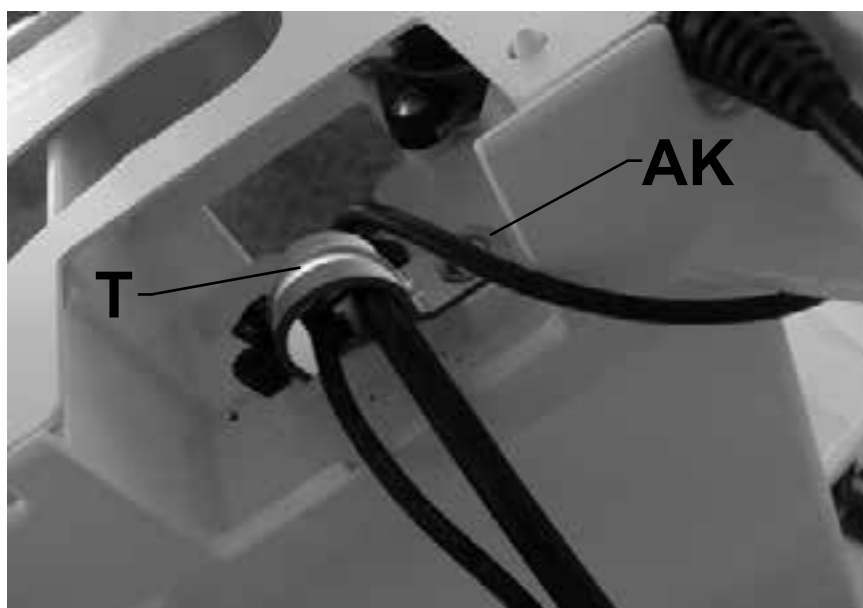

49. Gather all cabling and capture with Cable Clamp (T).

50. Install Flange Screw (AK).

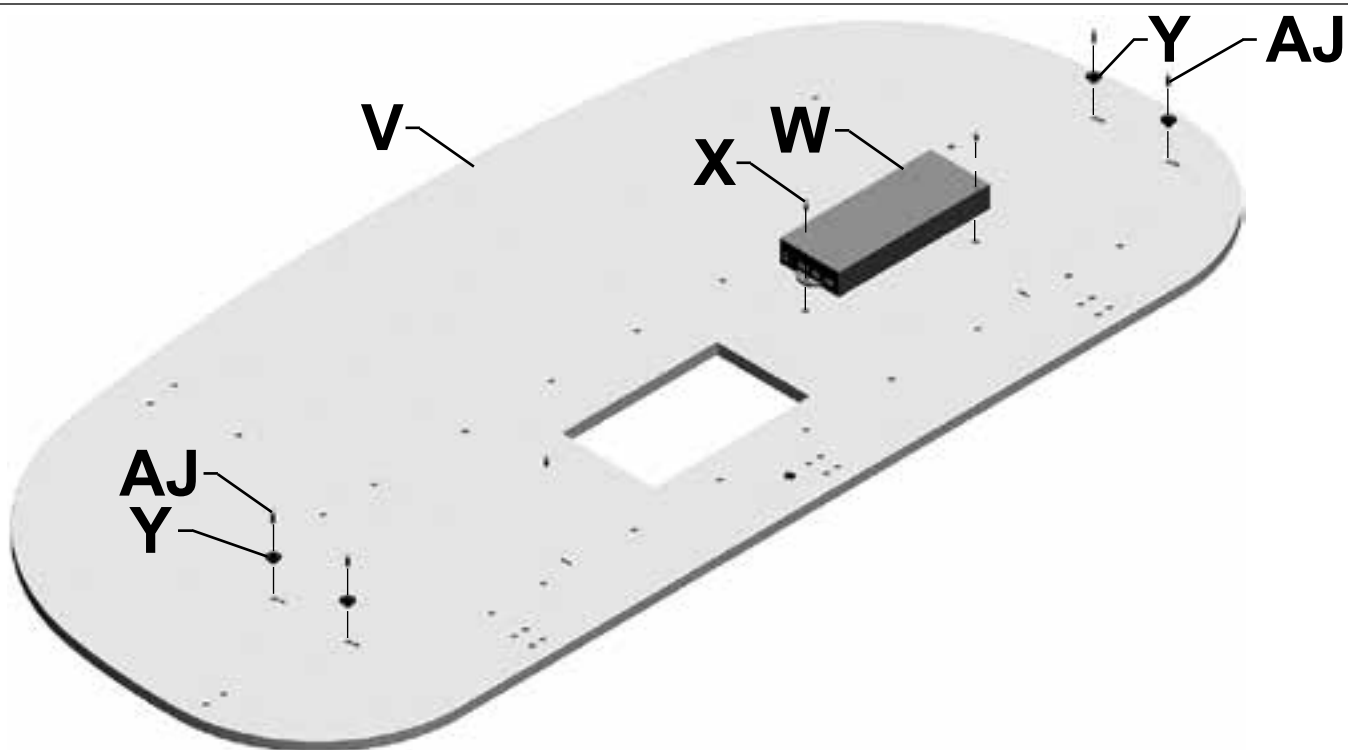

51. Place Work Surface (V) bottom side up on clean, dry, padded surface.
52. Mount Control Box (W) onto Work Surface with Button head Screws (X).
53. Install 4 Mushrooms (Y) onto Work Surface with 4 Button Head Flange Screws (AJ).

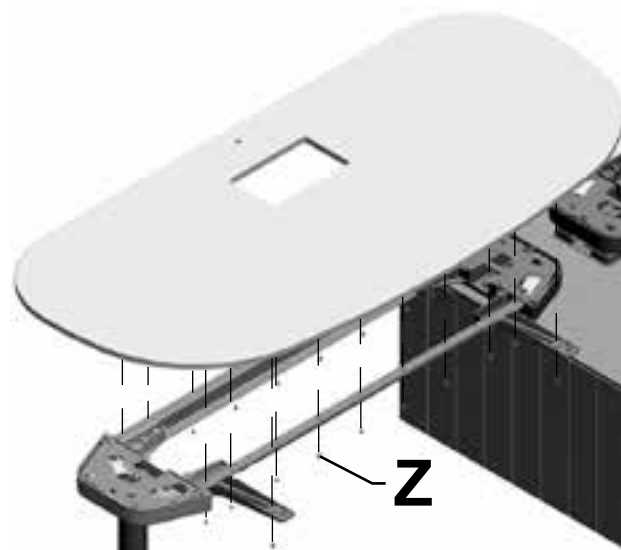

54. Place Work Surface onto Work Surface Supports.
55. Insert Mushrooms Fasteners on Work Surface into keyhole slots in column.
56. Push Work Surface over to engage Mushrooms Fasteners into slots.
57. Secure Work Surface to Rails and Surface Supports with Flange Screws (Z).

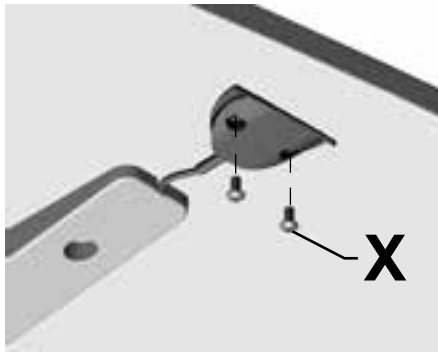

58. Make all cable connections.
 59. Pull Control Switch into position. Secure Switch to Work Surface with 2 Button Head Machine Screws (X).

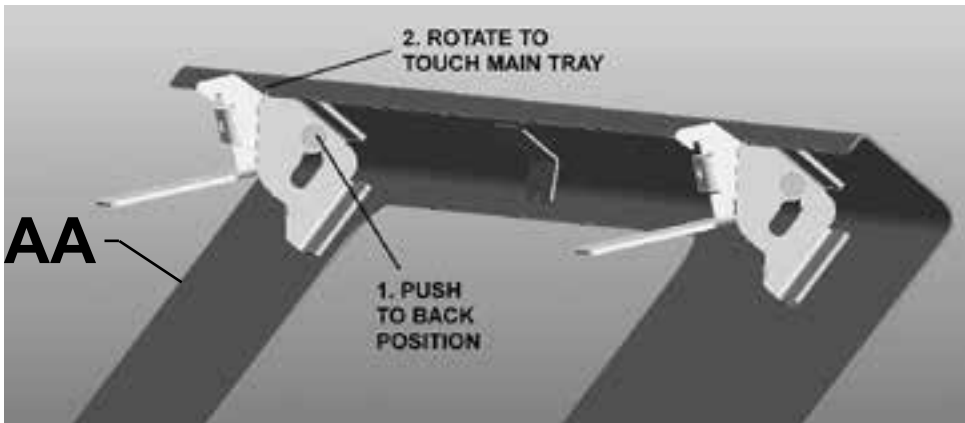

60. Before installing Wire Cover (AA): Ensure Hinges are pushed furthest back and rotated as far up as possible.

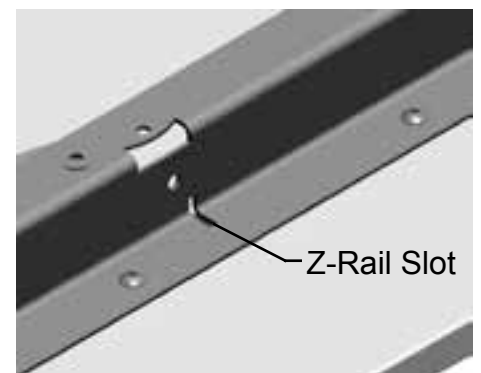
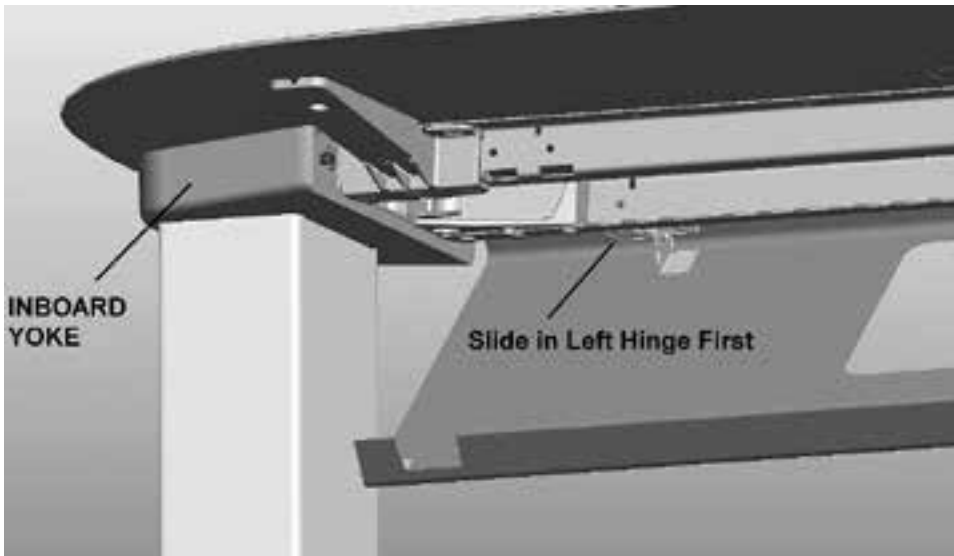

- 61a. Slide Left Hinge Hook into Z-Rail Slot, then align Right Hinge. (Right Hand Desk shown)

HermanMiller

Part no. 1bch5g rev D.

© 2017 Herman Miller, Inc. Zeeland, Michigan. Printed in the U.S.A.
 ™ Sense, Setu, Tu, Traverse and Locale are among the trademarks of Herman Miller, Inc.

Illustrations and specifications are based on the latest product information available at the time of publication.
 The right is reserved to make changes in design and specifications at any time, without notice, and also to discontinue products.

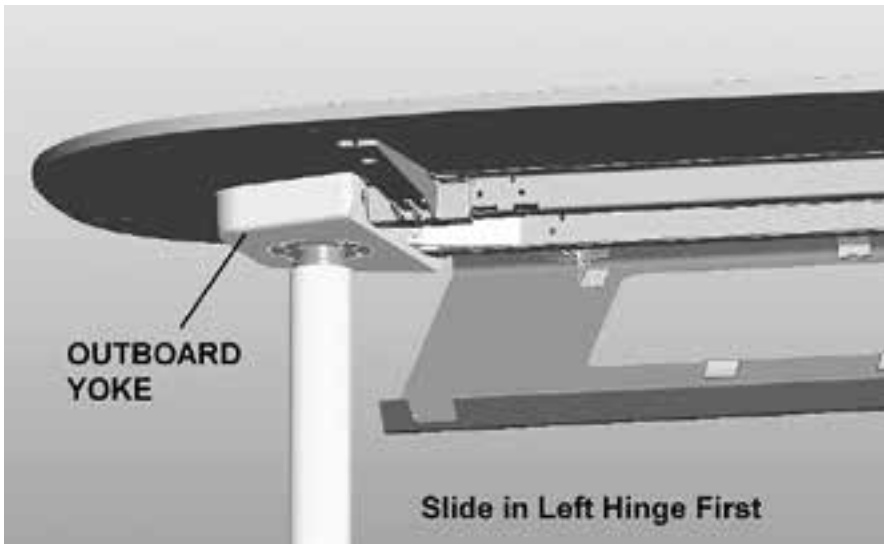

62b. Alternatively, slide Left Hinge into Z-Rail then align Right Hinge. (Left Hand Desk shown)

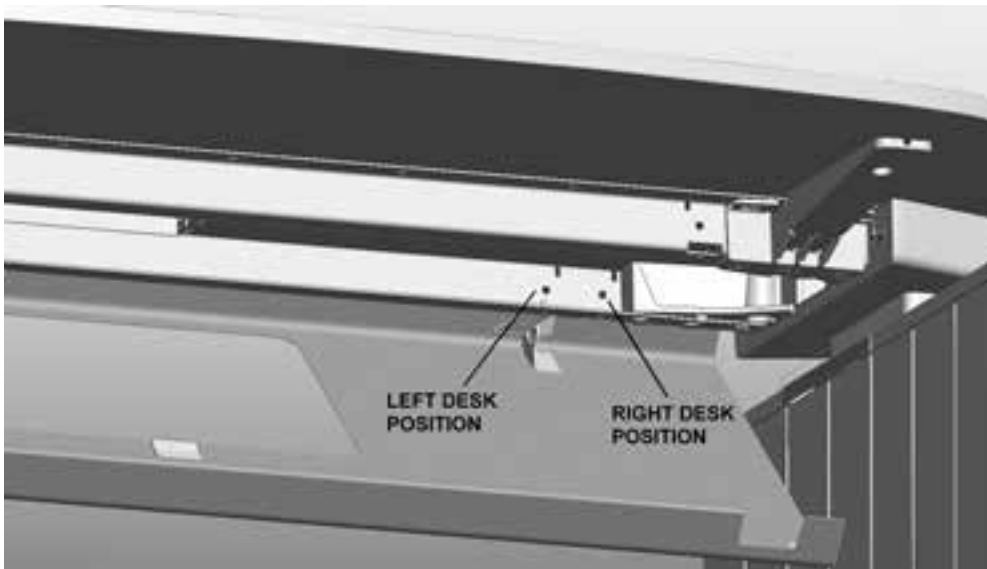

63. Slide Right Hinge into Z-Rail. Right screw hole will align with Right Hand Desk. Left screw hole will align with Left Hand Desk.

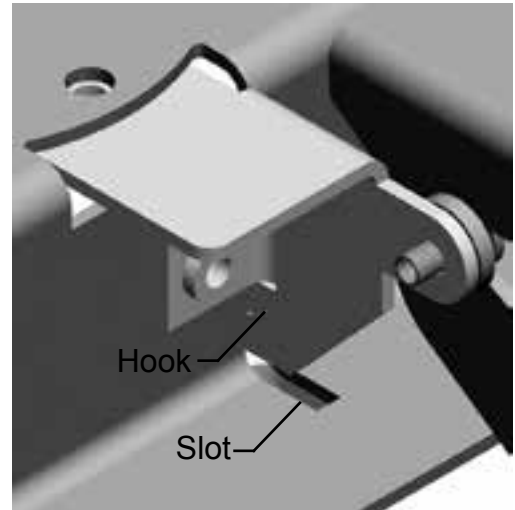
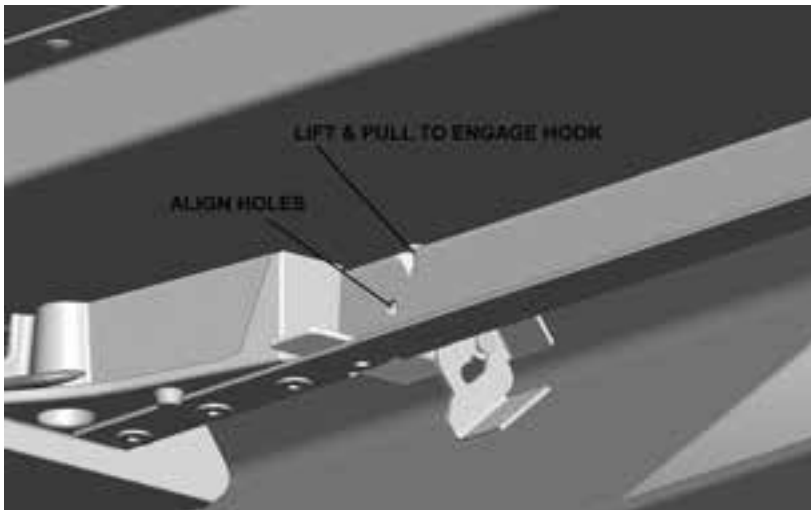

64. Lift and pull assembly to engage both hooks into slots in Z-Rail.

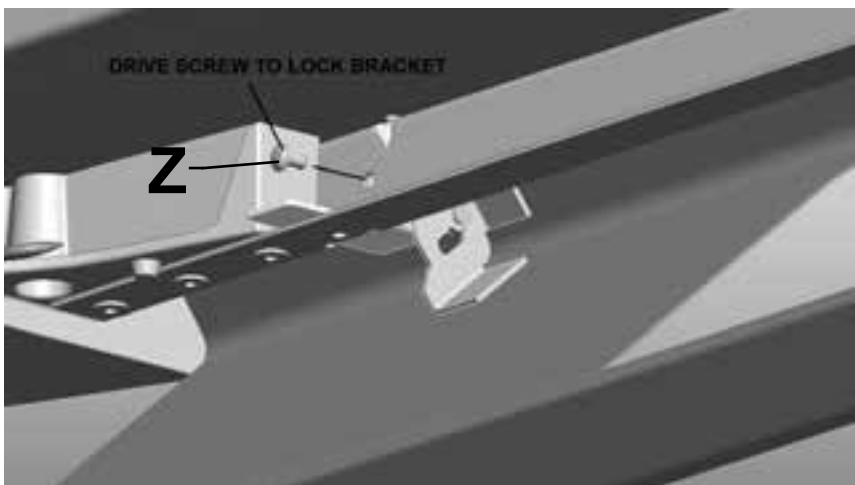

65. Install Button Head Flange Screw (Z). Repeat for other Hinge.

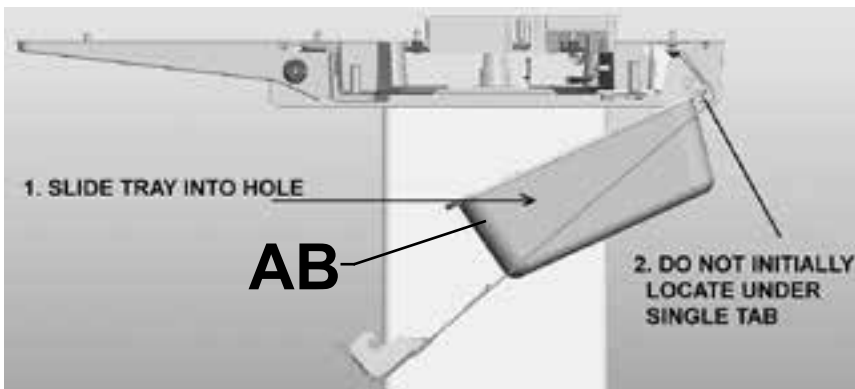

66. Place Wire Tray (AB) into Cable Cover.

HermanMiller

Part no. 1bch5g rev D.

© 2017 Herman Miller, Inc. Zeeland, Michigan. Printed in the U.S.A.

™ Sense, Setu, Tu, Traverse and Locale are among the trademarks of Herman Miller, Inc.

Illustrations and specifications are based on the latest product information available at the time of publication.

The right is reserved to make changes in design and specifications at any time, without notice, and also to discontinue products.

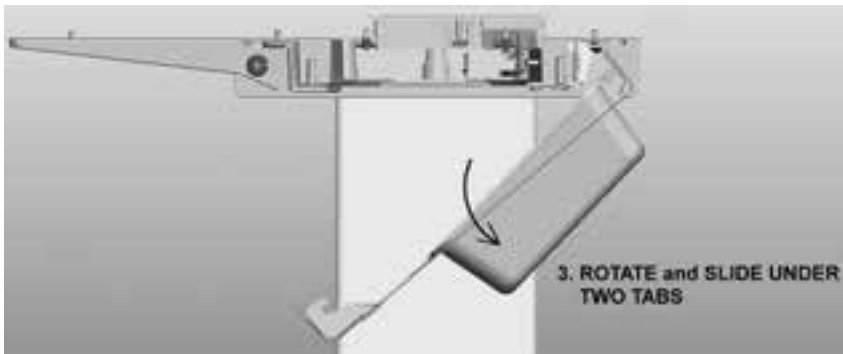

67. Slide edge of Wire Tray Under 2 Tabs in Cable Cover.

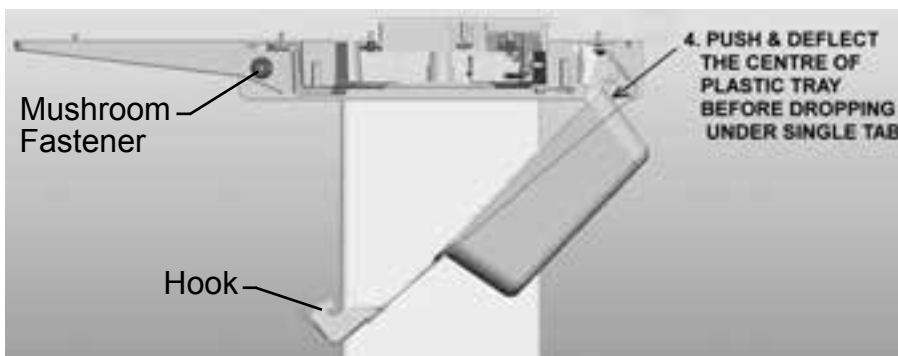

68. Press in on middle of Wire Tray until lip fits under single bracket on Cable Cover.

69. Close cover by engaging Hooks on Cable Cover onto Mushroom Fasteners.

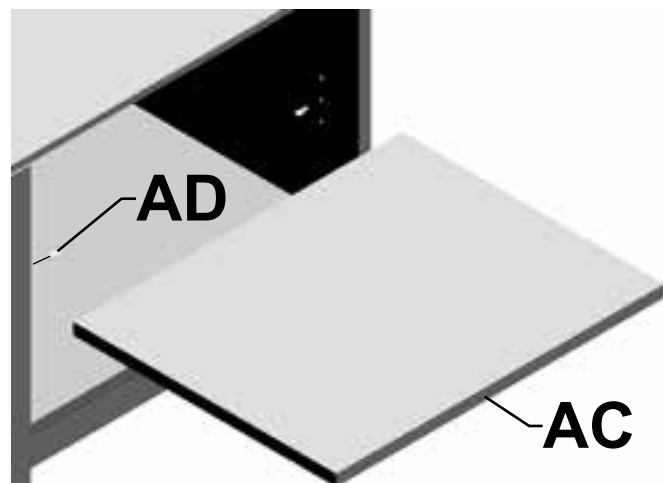
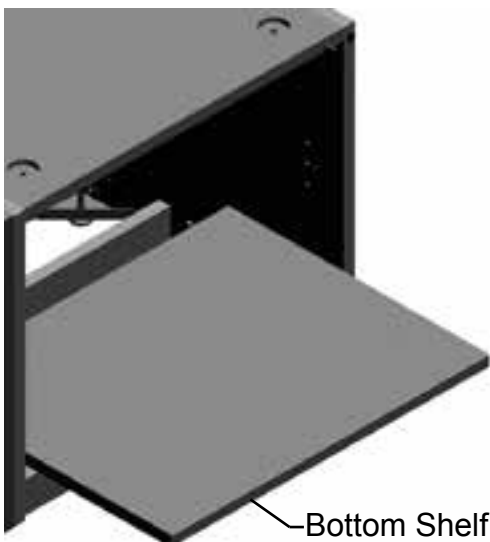

70. Return Bottom Shelf to Base.

71. Install Shelf Pins (AD) into Shelf locations in base. Set Shelf (AC) onto Pins.

HermanMiller

Part no. 1bch5g rev D.

© 2017 Herman Miller, Inc. Zeeland, Michigan. Printed in the U.S.A.
™ Sense, Setu, Tu, Traverse and Locale are among the trademarks of Herman Miller, Inc.

Illustrations and specifications are based on the latest product information available at the time of publication.
The right is reserved to make changes in design and specifications at any time, without notice, and also to discontinue products.

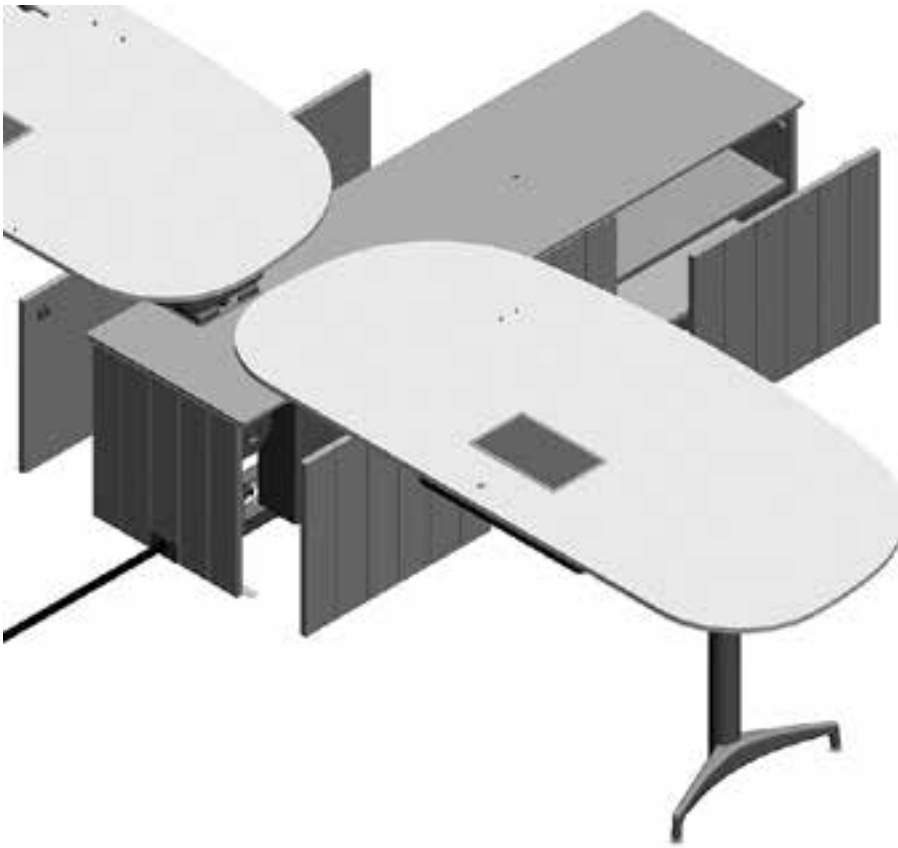

72. Return Access Panels and Doors, if removed, to Base.

Disassembly and Recycling:

Materials Identification and Segregation:

Where possible, plastic components are marked with ASTM recycling codes. Use these codes to identify material type for recycling. Non-marked components should be treated as mixed plastic. Ferrous metals can be identified using a small magnet for recycling. Non-ferrous metals should be separated and recycled separately.

To disassemble product, reverse the above installation steps and also do the following.

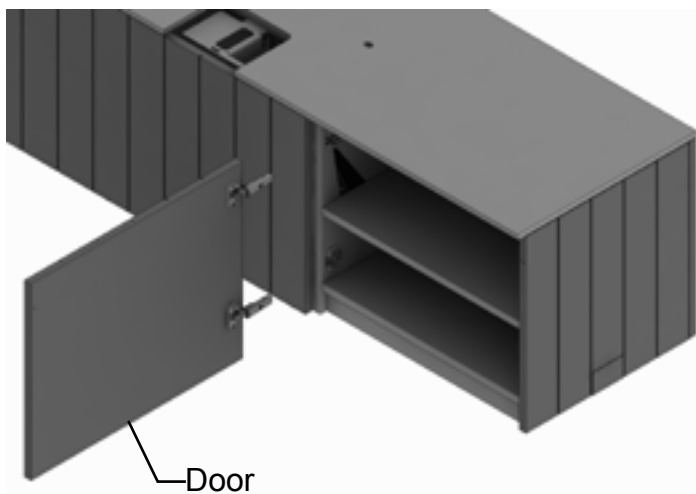

1. Disengage the hinge from the base and remove the door.

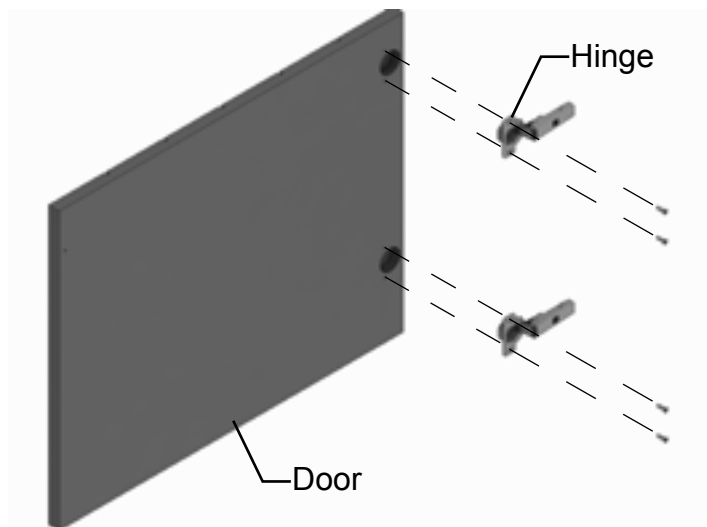

2. Using a phillips head screw driver uninstall the screws and remove hinge from door. Repeat step 1 and 2 to remove other side door.

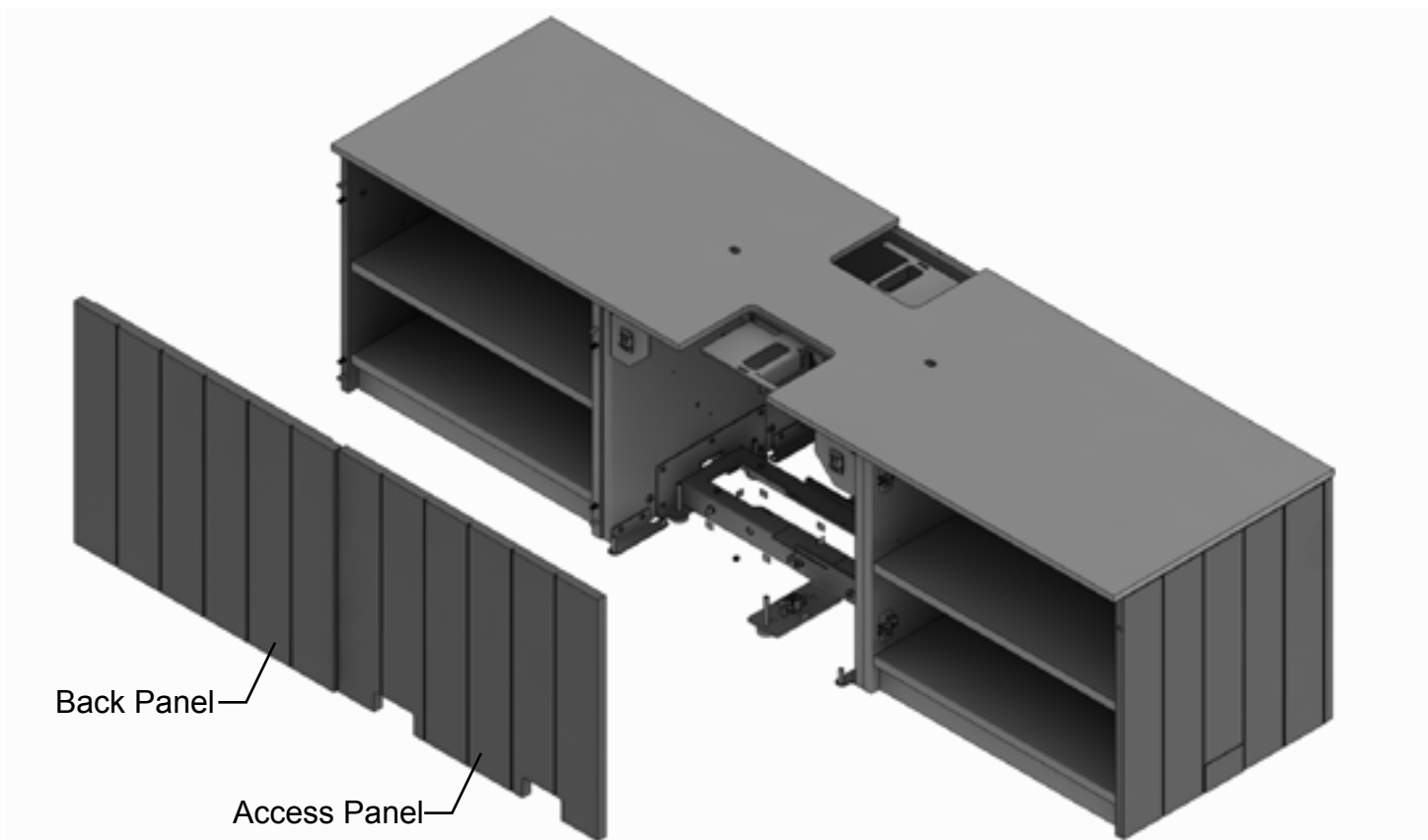

3. Using a straight head screw driver remove the access and back panel from both side of the base.

HermanMiller

Part no. 1bch5g rev D.

© 2017 Herman Miller, Inc. Zeeland, Michigan. Printed in the U.S.A.
™ Sense, Setu, Tu, Traverse and Locale are among the trademarks of Herman Miller, Inc.

Illustrations and specifications are based on the latest product information available at the time of publication.
The right is reserved to make changes in design and specifications at any time, without notice, and also to discontinue products.

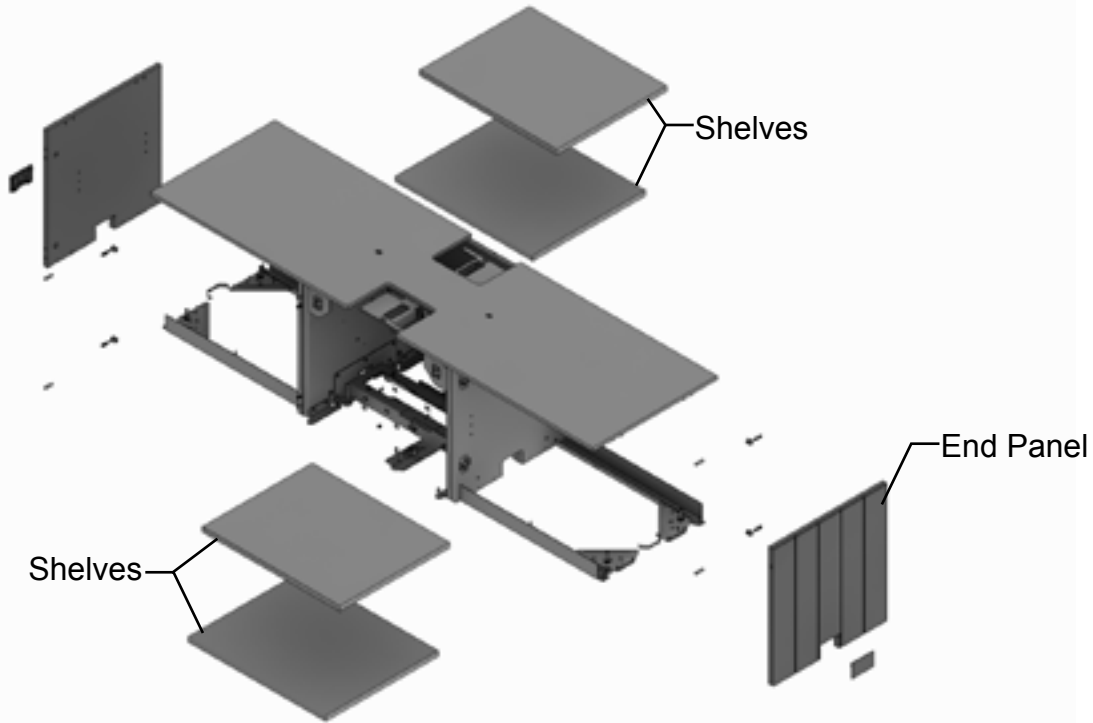

4. Using a straight head screw driver remove end panel. Remove the dowel pins and spreading bolt - minifix.

5. Remove the shelves from the base.

6. Using the phillips head screw driver remove 8 screws under the inner top.

7. Remove the thin top.

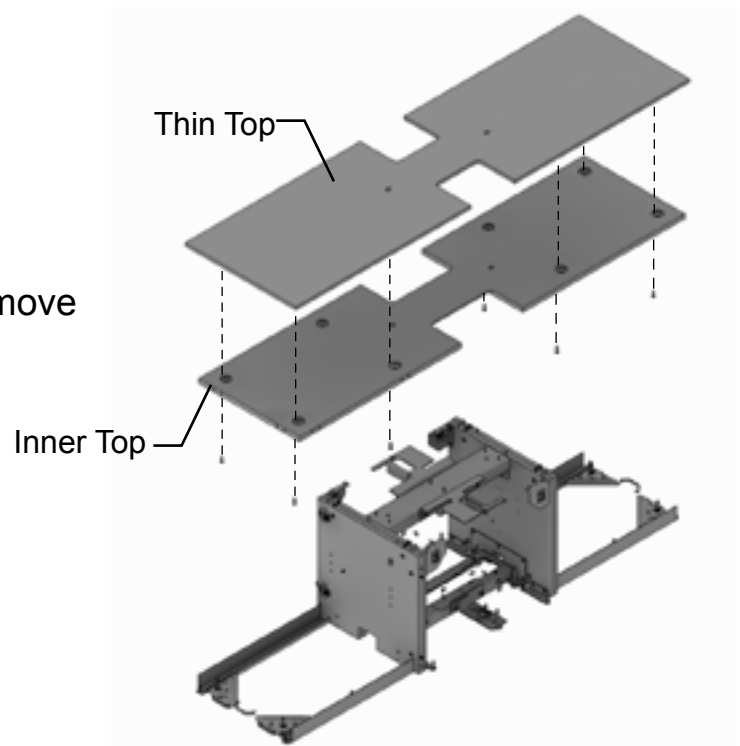

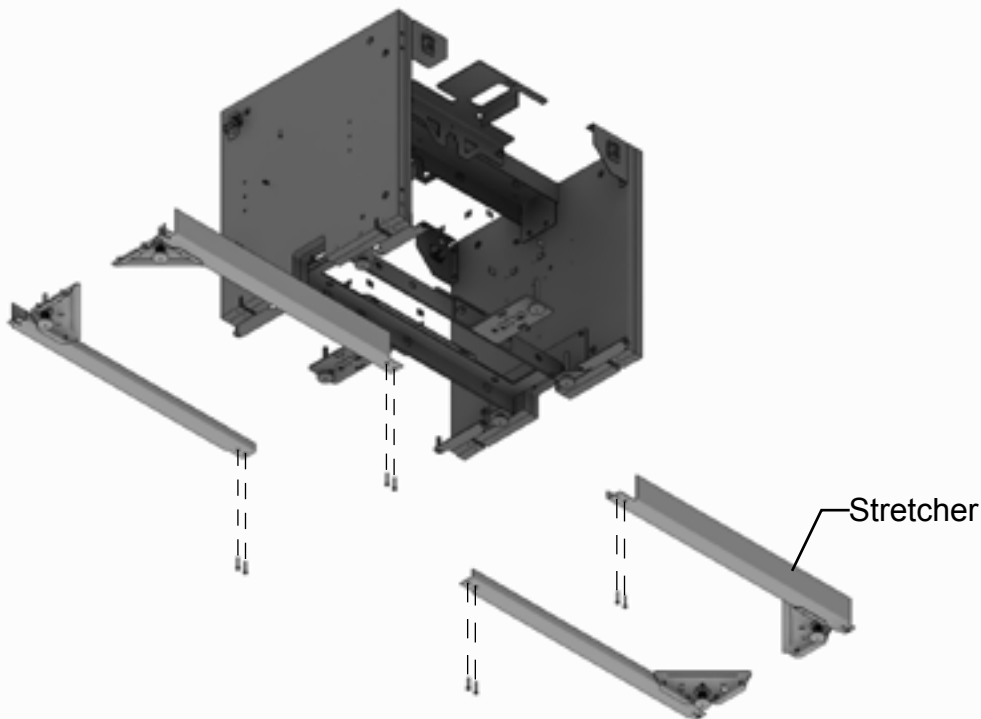

8. Using a phillips head screw driver remove screws from stretcher and remove the stretcher from the inner side panel.

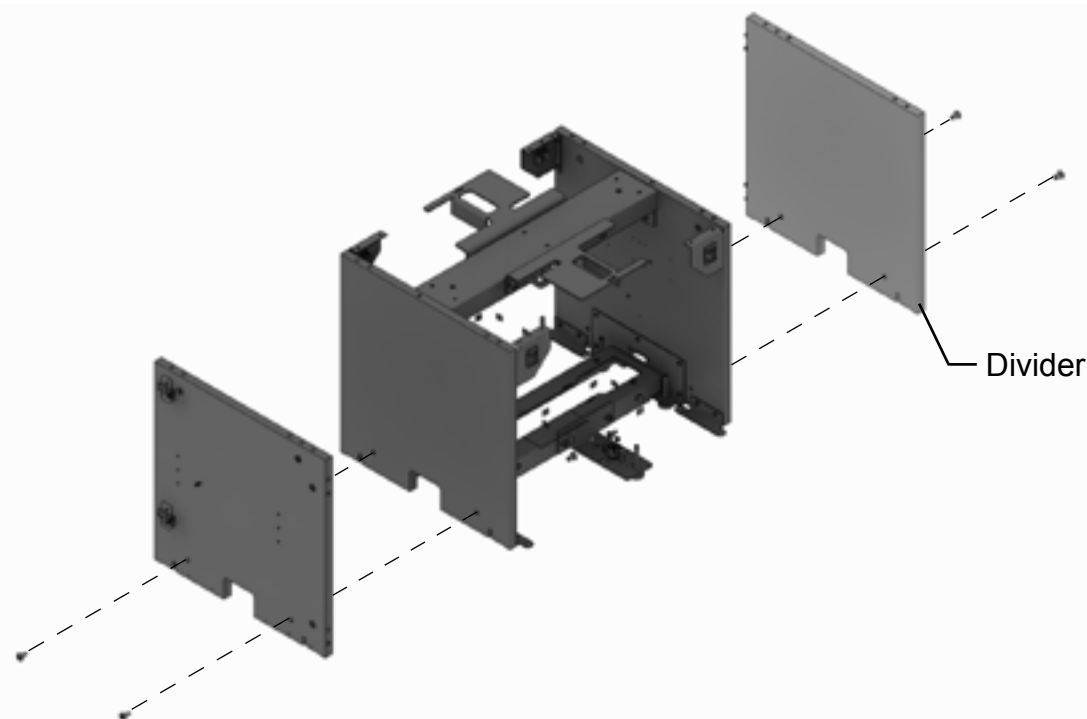

9. Using a phillips head screw driver loosen the screw bolts from the front RH divider and LH divider. Remove the both dividers from back dividers.

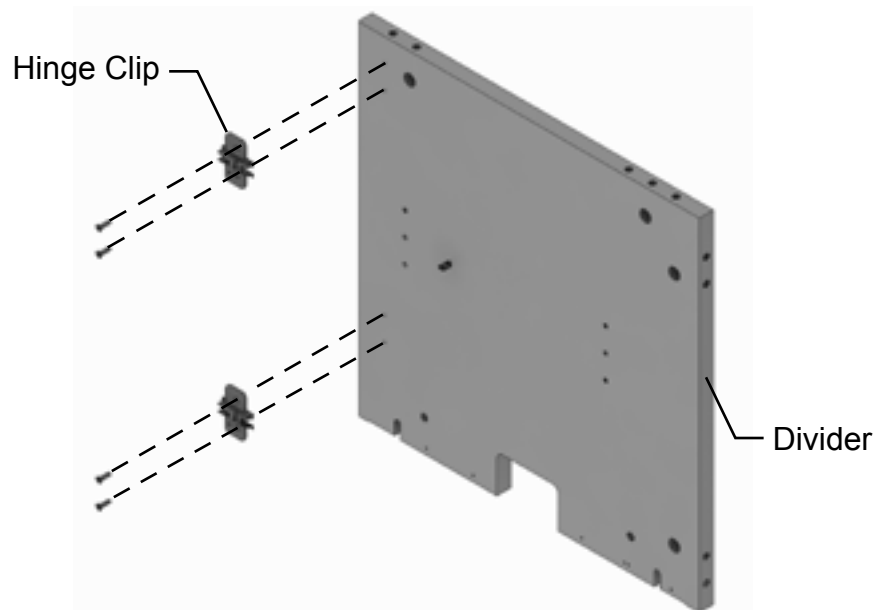

10. Using a phillips head screw driver loosen the screws and remove the screws and hinge clips from the panel.

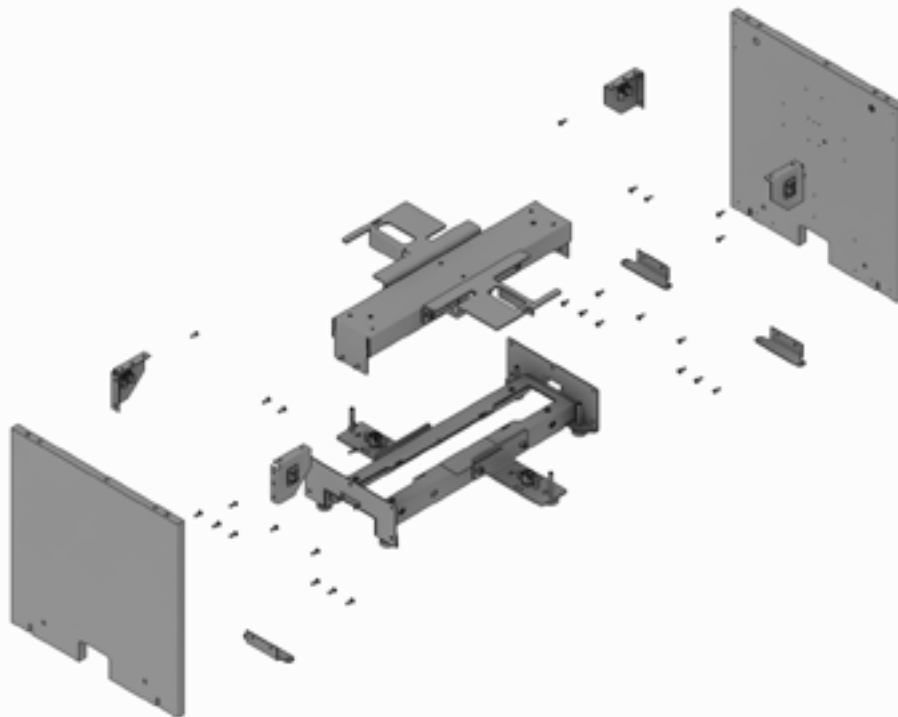

11. Using a phillips head screw driver loosen the screws from hot box weldment lower and upper and remove the screws and panels.

HermanMiller

Part no. 1bch5g rev D.

© 2017 Herman Miller, Inc. Zeeland, Michigan. Printed in the U.S.A.
™ Sense, Setu, Tu, Traverse and Locale are among the trademarks of Herman Miller, Inc.

Illustrations and specifications are based on the latest product information available at the time of publication.
The right is reserved to make changes in design and specifications at any time, without notice, and also to discontinue products.

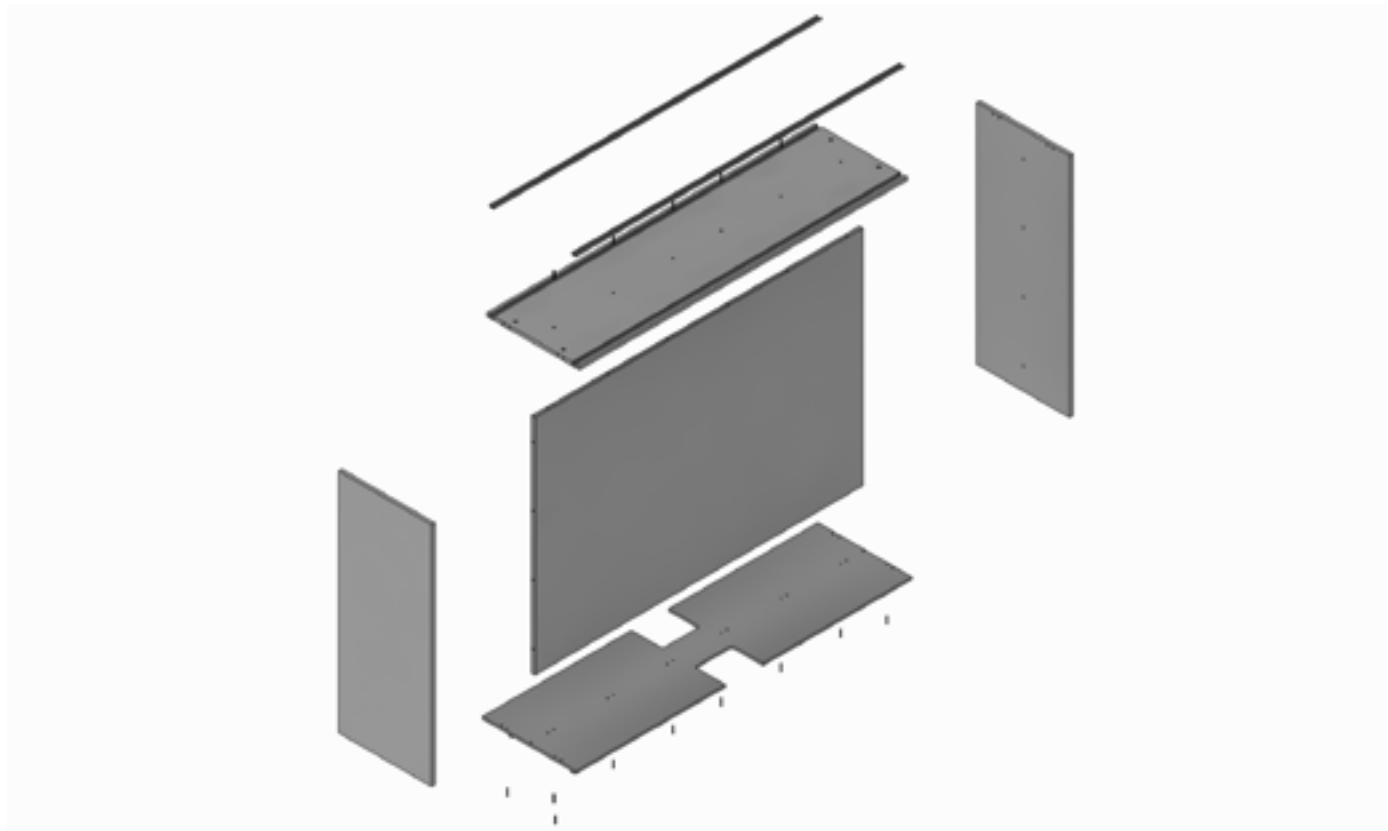

12. Using a phillips head screw driver loosen the screws and separate the panels.