

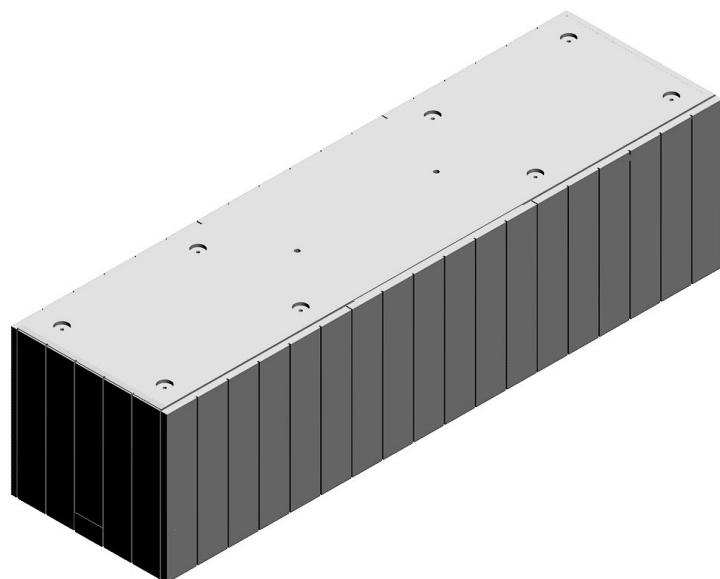

Locale™ Workbase with Upper Unit Disassembly for Recycling Instructions

Parts Included:



A Workbase

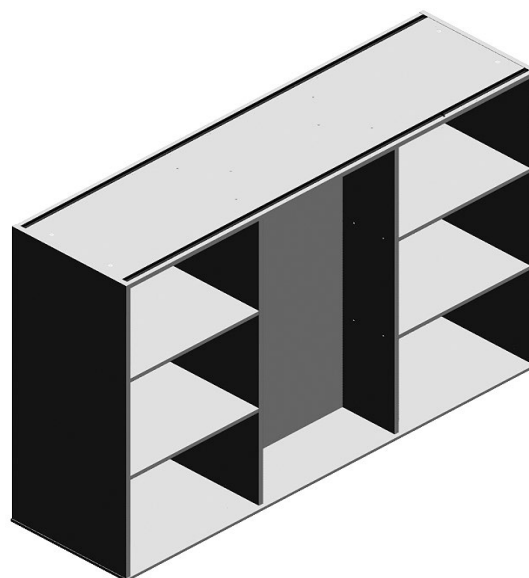

B Upper Unit



C Clamping Screw(4)



D Dowel Pin

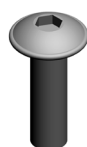

E M6 x 20 Flange Head Screw(8)

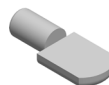

F Shelf Pins(24)

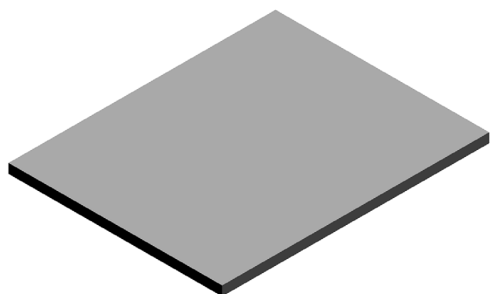

G Shelf(2)

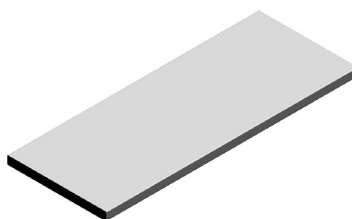

H Shelf(4)

Tools Needed:

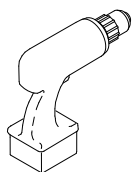

Power Driver



#2 Phillips Bit

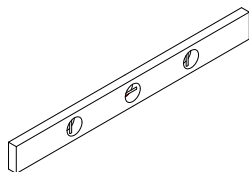

Level

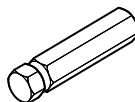

#6 Metric Hex Bit

HermanMiller

Part no. 1bcpn4 rev B.

© 2015 Herman Miller, Inc. Zeeland, Michigan. Printed in the U.S.A.
™ Locale is among the trademarks of Herman Miller, Inc.

Illustrations and specifications are based on the latest product information available at the time of publication.
The right is reserved to make changes in design and specifications at any time, without notice, and also to discontinue products.

(Note: Views shown with doors removed for clarity.)

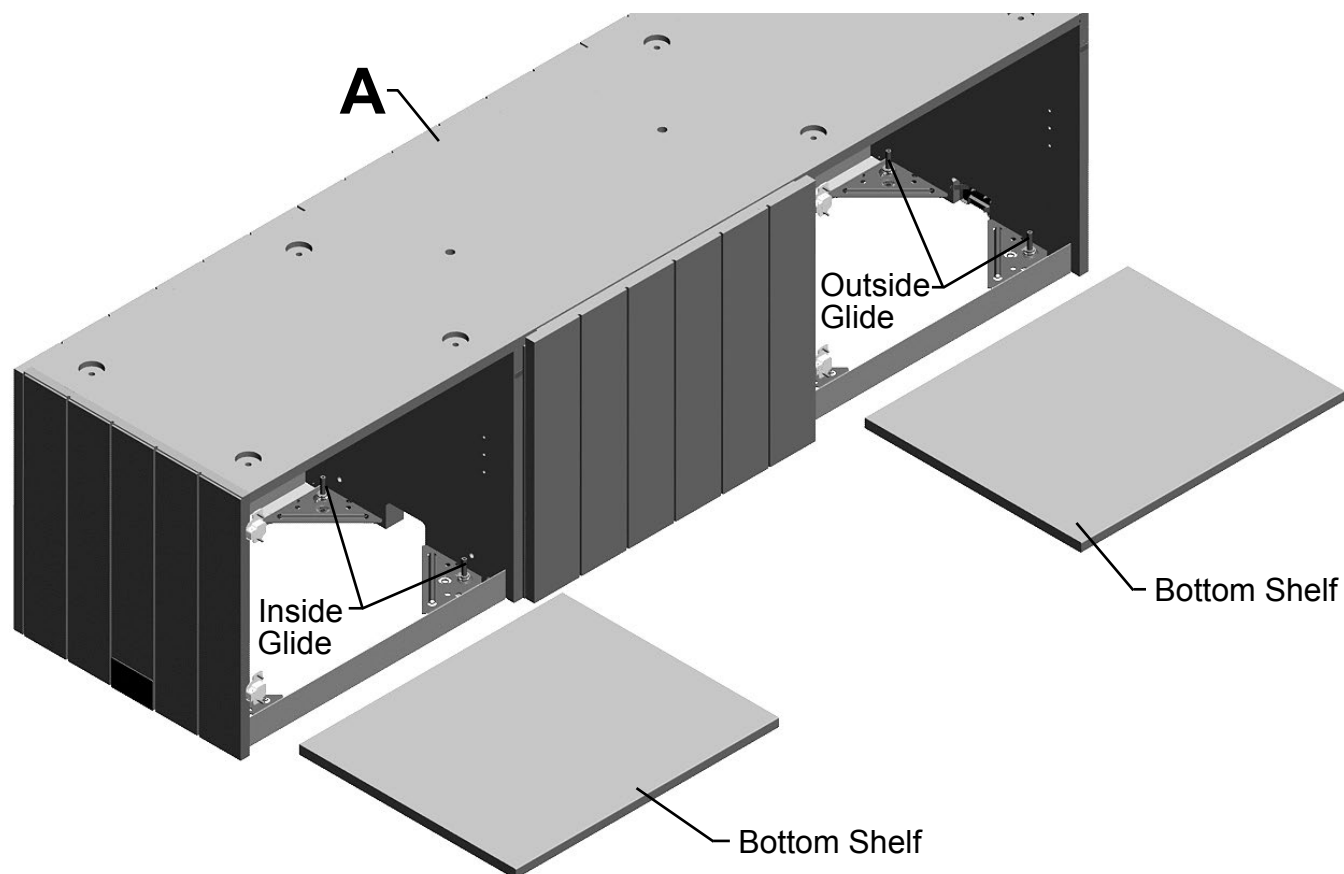

1. Remove Bottom Shelves from Base (A).
2. Level base by adjusting Outside Glides first. Then adjust Inside Glides down to touch floor.

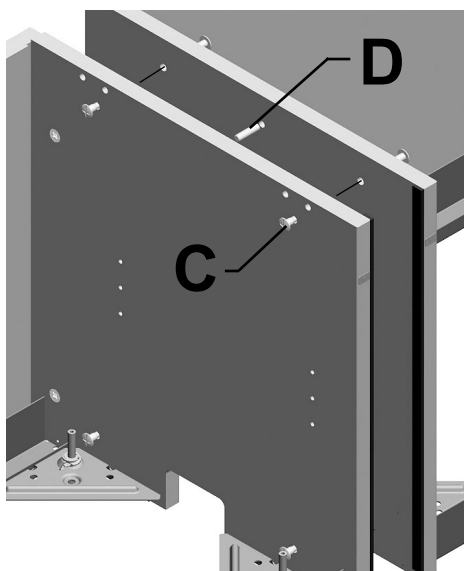

(Note: View shown with top panel removed for clarity.)

3. If More than one unit is to be installed in a run; position adjoining unit next to one already in position.
4. Level and align that unit to mate with other.
5. Connect bases with 4 Clamping Screws (C) and 1 Dowel Pin (D).
6. Return Bottom shelves to Workbase.

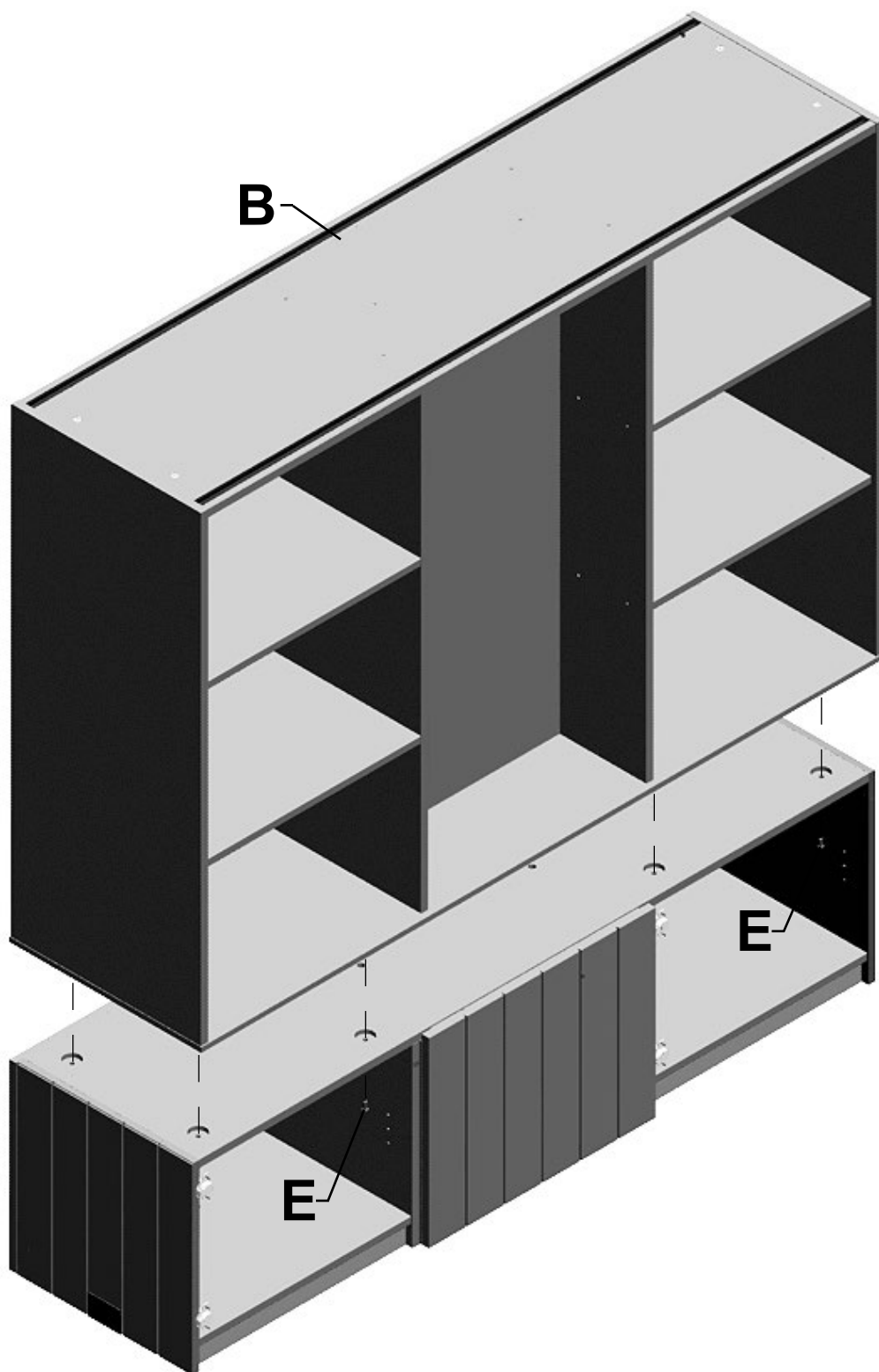

7. Position Upper Unit (B) onto Workbase.
8. Secure to Base with 8 Flange Head Screws (E).

HermanMiller

Part no. 1bcpn4 rev B.

© 2015 Herman Miller, Inc. Zeeland, Michigan. Printed in the U.S.A.
™ Locale is among the trademarks of Herman Miller, Inc.

Illustrations and specifications are based on the latest product information available at the time of publication.
The right is reserved to make changes in design and specifications at any time, without notice, and also to discontinue products.

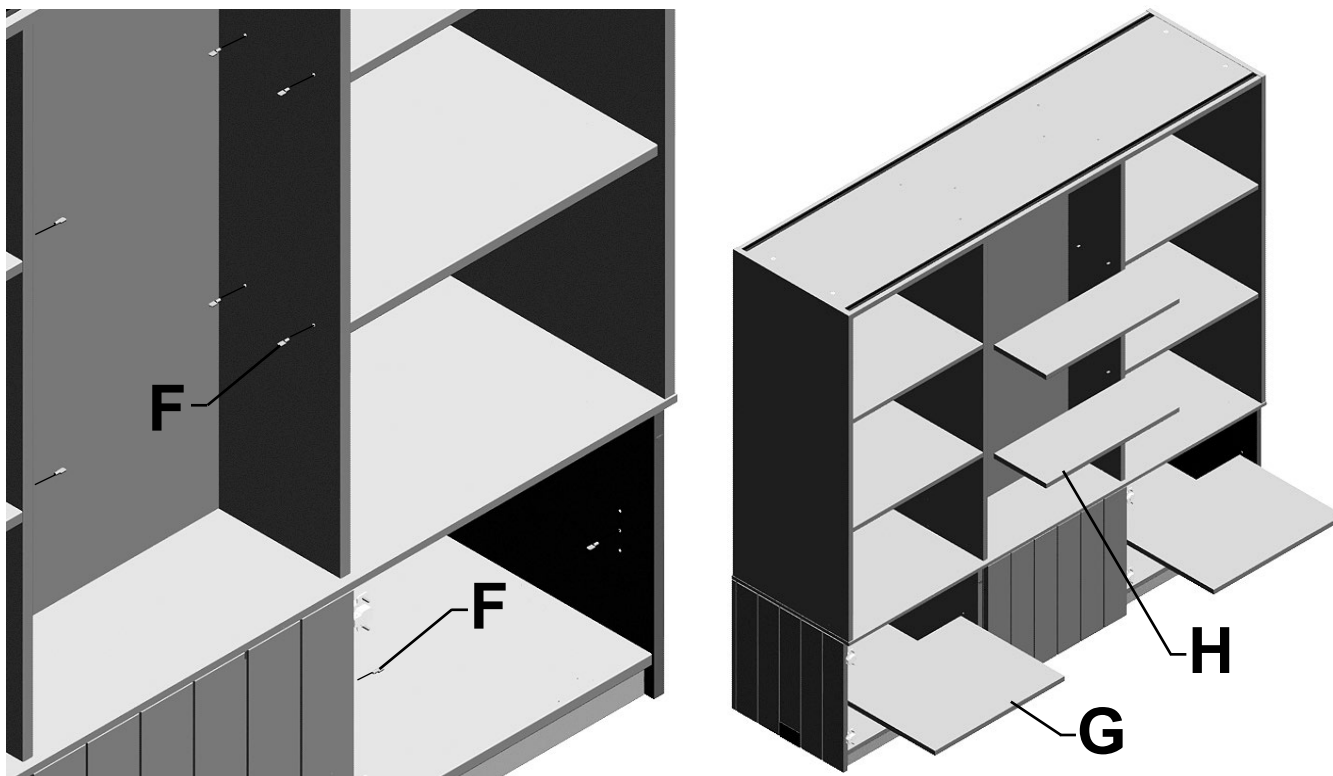

9. Install Shelf Pins (F) into Shelf locations in Workbase and Upper Unit.
10. Set Shelves (G and H) onto Pins.

Disassembly and Recycling:

Materials Identification and Segregation:

Where possible, plastic components are marked with ASTM recycling codes. Use these codes to identify material type for recycling. Non-marked components should be treated as mixed plastic. Ferrous metals can be identified using a small magnet for recycling. Non-ferrous metals should be separated and recycled separately.