

HermanMiller

Canvas Channel 90° Connector Installation and Disassembly for Recycling Instructions



How to assemble and reassemble your 90° Connector

Tools Required

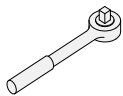

Ratchet



9/16" Socket

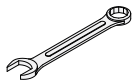

9/16" Wrench

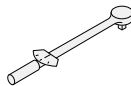

Torque Wrench



Safety Glass

Assembly Instructions

Step 1

1.1 Align 2, 3 or 4 wall frames.

1.2 Connect frames to Top Connector Tube if using the FZ121 product using Screws and Washers at top hole location. For 3 way connection make sure Top Connector Tube open side faces outward. Do not tighten screws.

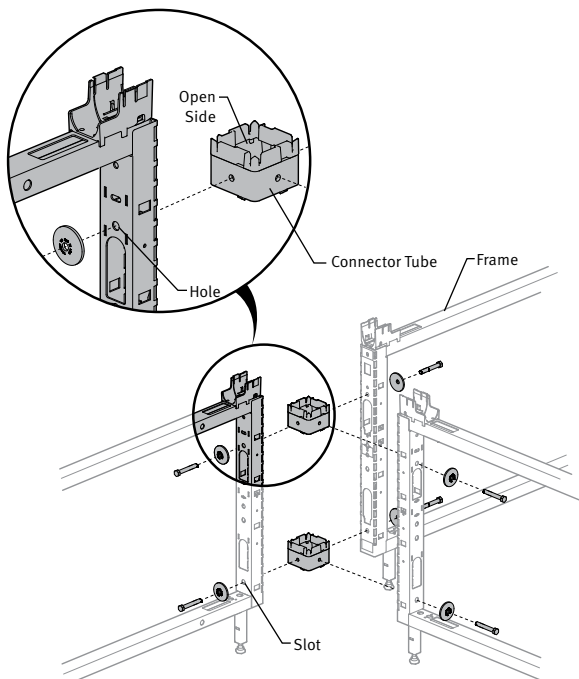

Parts Included

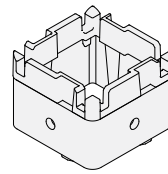

Connector Tube(2)



Light Seal

FZ121.2(1)

FZ121.3(2)

FZ121.4(4)

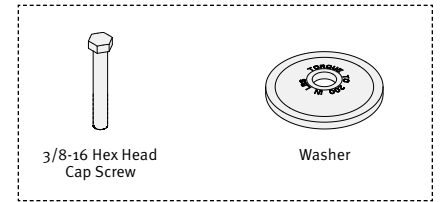

3/8-16 Hex Head
Cap Screw

Washer

Hardware Pack
FZ121.2(4)
FZ121.3(6)
FZ121.4(8)

Notice:

Do not tighten screws until at least 2 frames are completely connected.

Notice:

Make certain that fasteners are torqued to the specified values.

Step 2

For 22" High Products when used with Structural Foot:

2.1 Assemble Connector Tube to frames at slot location as shown below with Screws and Washers. Tighten screws. Continue to Step 3.

Important: Torque screws to 200 in-lbs. Start with top connector tube, then bottom.

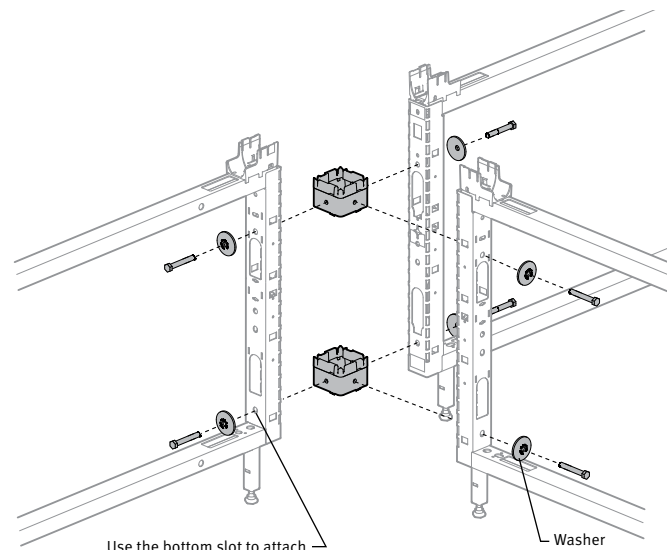

For 22" High Products when used with Architectural Foot:

2.2 Assemble Connector Tube to frames at slot location as shown below with Screws and Washers. Tighten screws.

Important: Torque screws to 200 in-lbs.

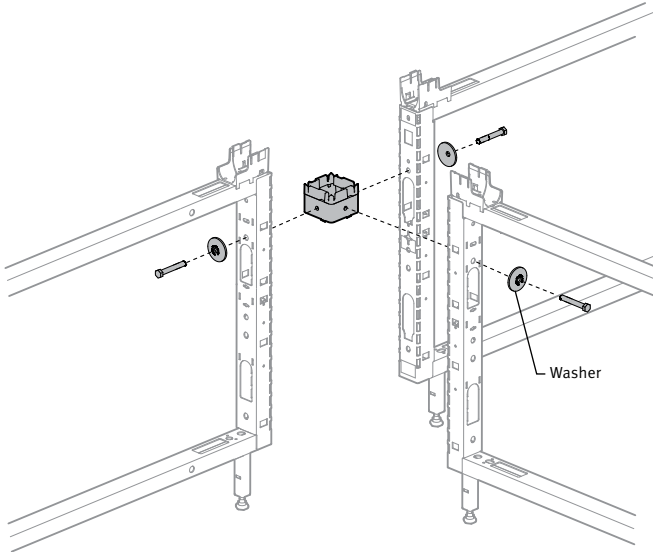

For 29" High Products

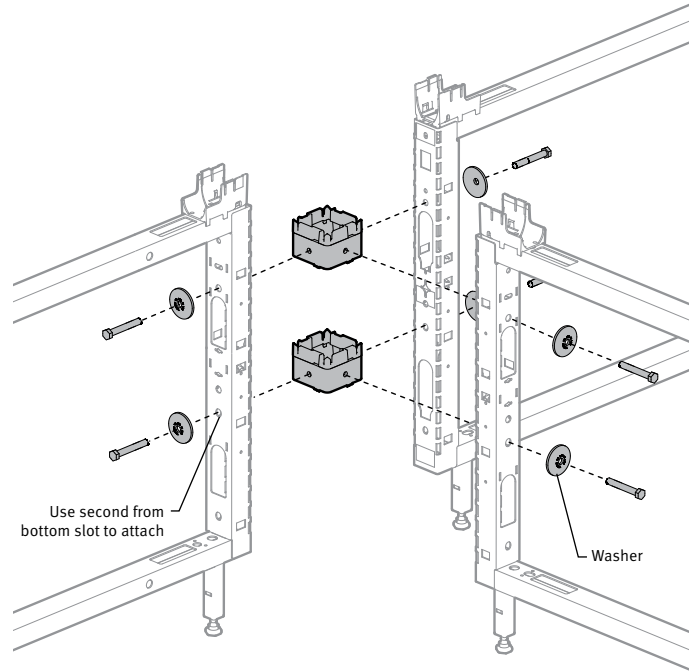

Step 3

3.1 Before cladding has been installed, install Light Seal in inside corners.

3.2 With the one-inch cut-out in the light seal facing up, rest the top set of arms on the top connector block.

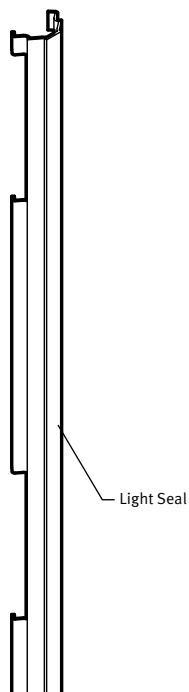

Step 4

4.1 Place one arm so that the curved portion sits well on the bend of the frame.

4.2 Push the other arm in, so that it snaps. Repeat for the entire length.

4.3 Cut light seal off even with bottom of frame.

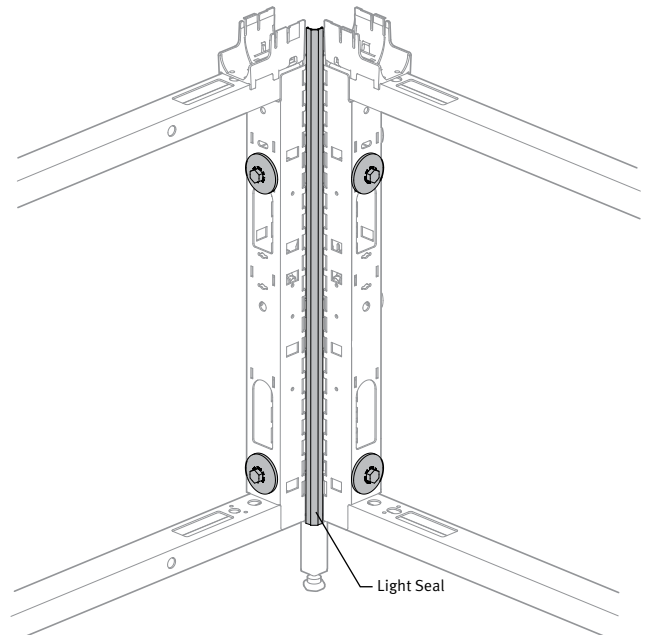

Disassembly for Recycling:

Materials Identification and Segregation:

Where possible, plastic components are marked with ASTM recycling codes.
Use these codes to identify material type for recycling.
Non marked components should be treated as mixed plastic.
Ferrous metals can be identified using a small magnet for recycling.
Non-ferrous metals should be separated and recycled separately.

To disassemble product, reverse the above installation steps.

For more information about our products and services please visit us at
hermanmiller.com or call (800) 851 1196.

©2019 Herman Miller, Inc., Zeeland, Michigan Printed in U.S.A. Part No. **1BKRBR – B**