

# HermanMiller

## Canvas Channel 120° Connector Cover Top Caps Installation and Disassembly for Recycling Instructions



### How to assemble your 120° Connector Cover

**IMPORTANT: Save these instructions for layout changes.**

#### Assembly Instructions:

##### Two-way & Three-way 120° Top Cap Cover

###### Step 1

1.1 Install tiles and vertical connector covers. (Shown without tiles for clarity)

1.2 Slide top caps onto top cap covers.

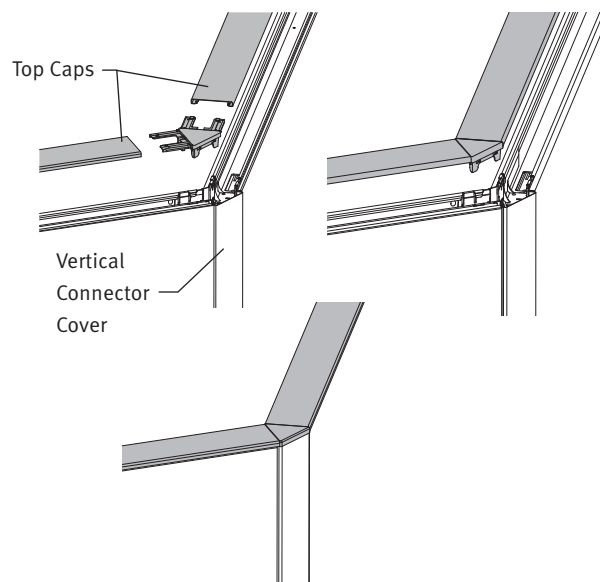

#### Parts Included

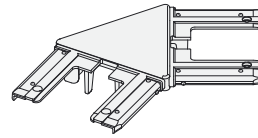

Two Way 120° Connector  
Top Cap Cover (Painted)

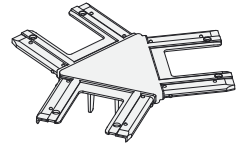

Three Way 120° Connector  
Top Cap Cover (Painted)

1.3 Snap top caps and covers onto wire channels.

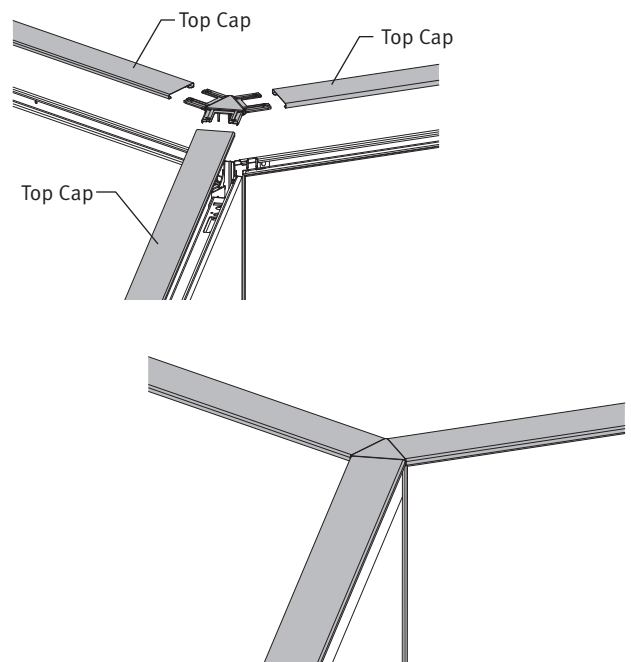

### **Disassembly for Recycling:**

#### **Materials Identification and Segregation:**

Where possible, plastic components are marked with ASTM recycling codes. Use these codes to identify material type for recycling. Non marked components should be treated as mixed plastic. Ferrous metals can be identified using a small magnet for recycling. Non-ferrous metals should be separated and recycled separately.

To disassemble product, reverse the above installation steps.

---

For more information about our products and services please visit us at  
[hermanmiller.com](http://hermanmiller.com) or call (800) 851 1196.

©2017 Herman Miller, Inc., Zeeland, Michigan Printed in U.S.A. Part No. **1BKTm8 – A**