

HermanMiller

Canvas Vista Cable Management Products Installation and Disassembly for Recycling Instructions



How to assemble Cable Management Products

Tools Required

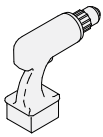

Power Driver



#2 Phillips
Bit



Metric Allen
Wrench



Square
Drive Bit

Parts Included

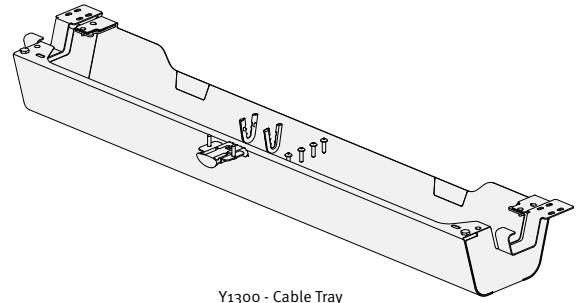

Y1300 - Cable Tray

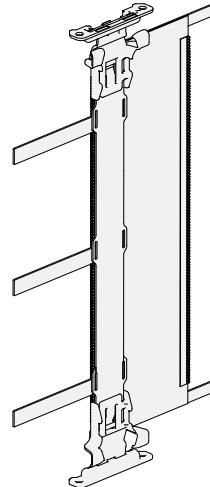

FG198 - Cable Management Sleeve



Data Box (FG159)



Clip (FG197)

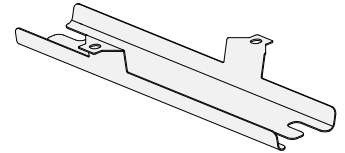

Wire Manager
(FG199)

Install Cable Trough

Note: Install cable trough with worksurface upside down and elevated

Step 1

1.1 Locate the wire clip and tray bracket with the predrilled holes on the worksurface. (There will be two holes per side). Orient the hook on the wire clips to face the front side of the worksurface (where the person sits). The holes on the wire clip that are closest to the tray should be aligned with the predrilled holes on the worksurface. (i.e. use inboard holes on the wire clips). Fasten both the wire clip and tray bracket using the self tapping screws.

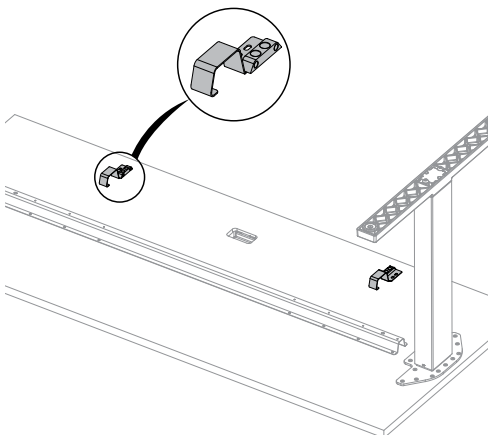

1.2 Slide the wire tray pin onto the hinge bracket on one side of the tray. The hinge pin should be located in the rear most side-hole of the tray bracket (furthest from person).

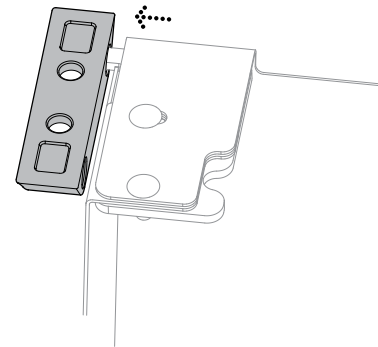

1.3 Place the second tray bracket on top of the wire clip so that the holes on the tray bracket are aligned with the inboard holes on each of the wire brackets and slide the tray bracket over the Hinge pin.

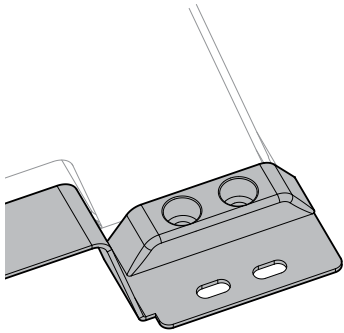

1.4 Fasten wire clip and tray bracket to the worksurface with two screws from hardware pack.

1.5 Place bumpers on front upper corners of the tray. They are located with a cross-pattern etched into the tray.

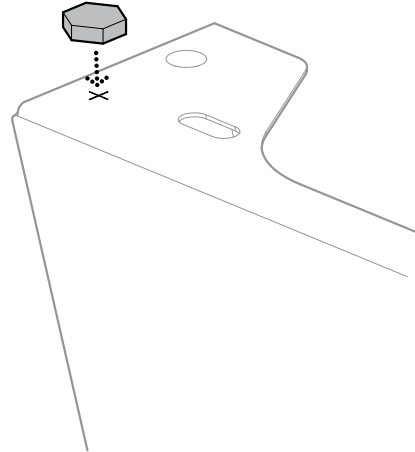

1.6 Locate the tray latch on the work surface so that the latch hooks/ clips into the slot on the front of the tray. Adjust this manually until the latch is seated properly in the tray. Note: Do NOT compress the latch spring while locating the latch.

1.7 While holding the latch bracket in place, slide the latch to the open position to verify the proper orientation.

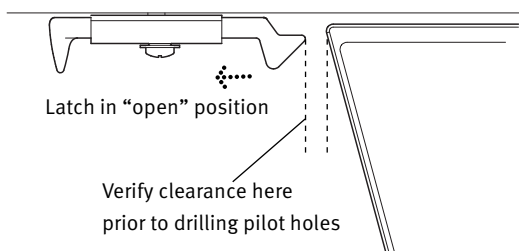

Note: The rear wall of the cable tray has two knock-outs that can be removed to allow easier access for the monitor arm bracket installation.

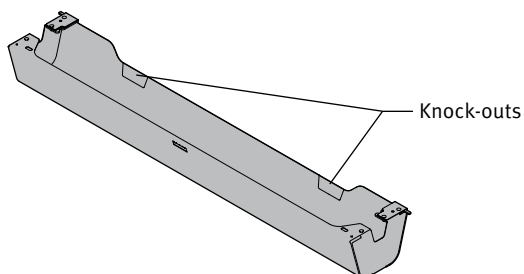

1.8 Fasten the latch with the two screws provided in the latch assembly kit.

Note: V-Grommets from the hardware pack 1BCD8C are not used.

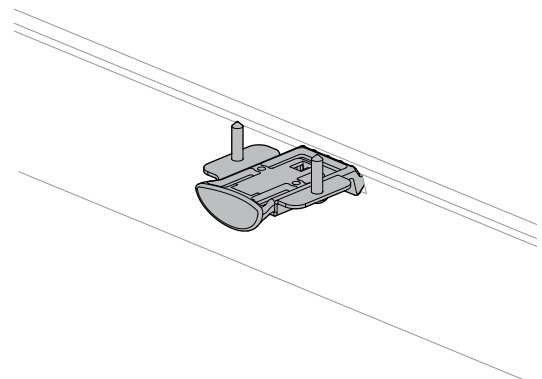

FG199 - Wire Manager

Step 1

1.1 Insert button head screws through holes in wire manager and into nut plate.

1.2 Position wire manager up to underside of chase extrusion at desired location. Engage nut plate inside chase groove by fully inserting button head screw and turning until tight.

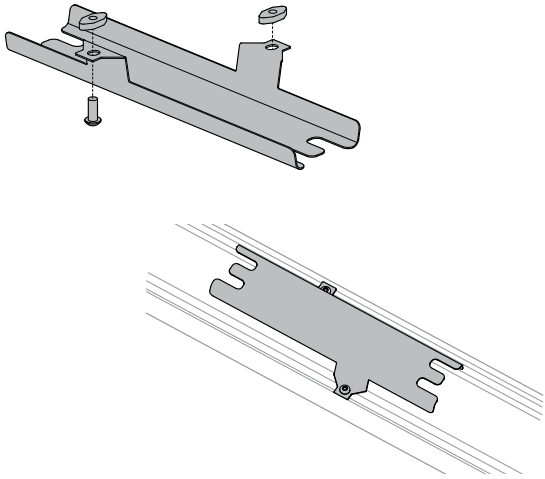

FG197 - Cable Management Clip

Step 1

1.1 Insert cable management clip in chase extrusion as shown.

1.2 To remove cable management clip push on end of clip.

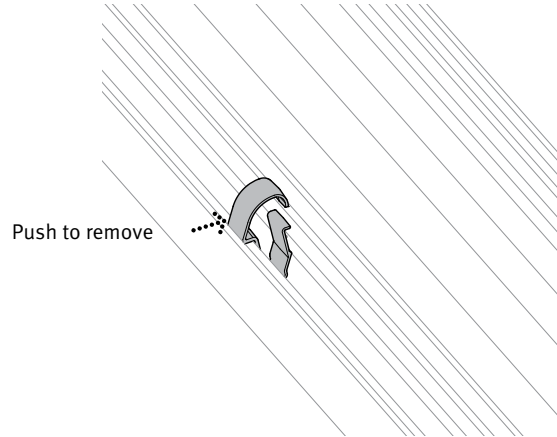

FG198 - Cable Management Sleeve

Step 1

1.1 Insert button head screws through holes in Cable Management Sleeve and into nut plate.

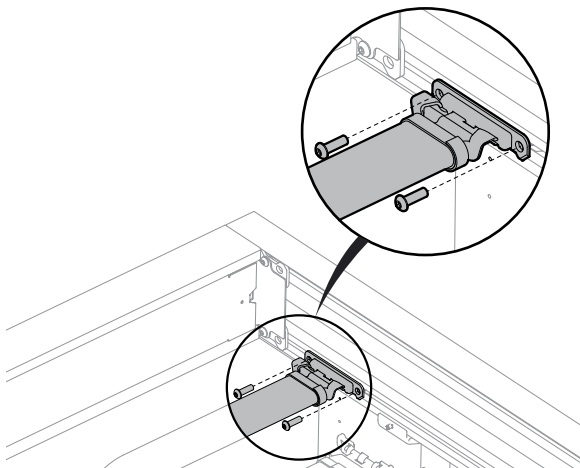

1.2 Position Cable Management Sleeve up to underside of chase extrusion at desired location. Engage nut plate inside chase groove by fully inserting button head screw and turning until tight.

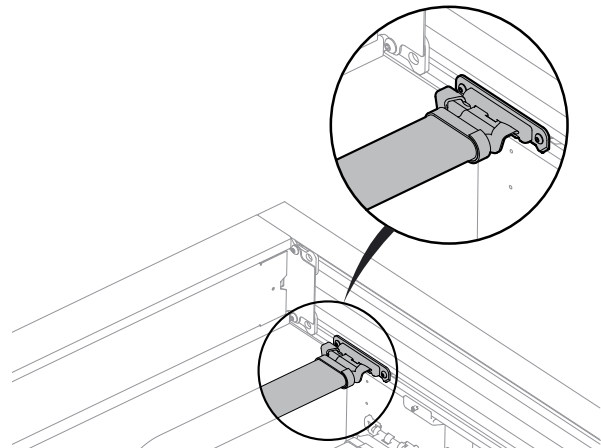

1.3 Position other side of Cable Management Sleeve up to underside of the work surface at desired location. Use holes in the hinge plate to mark hole locations. Drill pilot holes.

1.4 Secure hinge plate with pan head screws.

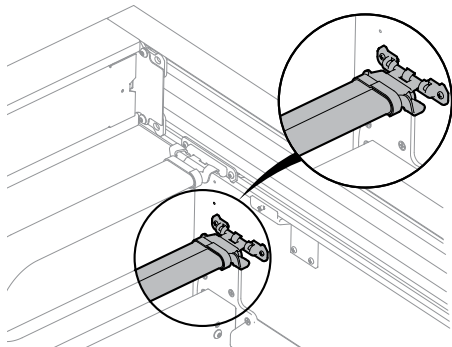
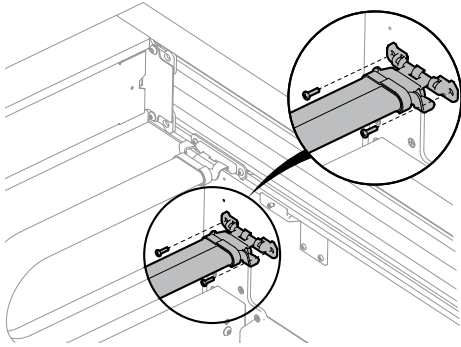

1.5 Unzip and remove the fabric cover.

1.6 Position wires over wire catch and along track.

1.7 Secure with velcro straps on track.

1.8 Wrap wires and track with sock. Zip wires and track inside sock.

1.9 Velcro ends of sock over hinge housing.

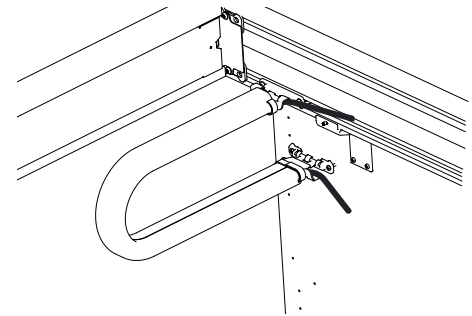
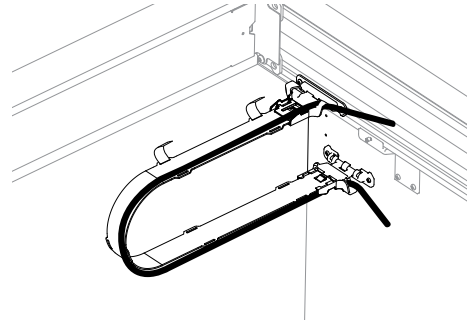

FG159 - Data Box

Step 1

1.1 Insert button head screws through holes in wire manager and into nut plate.

1.2 Position wire manager up to underside of chase extrusion at desired location. Engage nut plate inside chase groove by fully inserting button head screw and turning until tight.

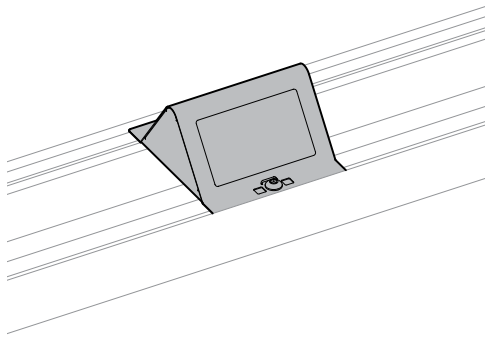

Disassembly and Recycling:

Materials Identification and Segregation:

Where possible, plastic components are marked with ASTM recycling codes. Use these codes to identify material type for recycling. Non marked components should be treated as mixed plastic. Ferrous metals can be identified using a small magnet for recycling. Non-ferrous metals should be separated and recycled separately.

To disassemble product, reverse the above installation steps:

For more information about our products and services please visit us at hermanmiller.com or call (800) 851 1196.

©2018 Herman Miller, Inc., Zeeland, Michigan Printed in U.S.A. Part No. **1BNOMC - A**