

HermanMiller

Canvas Vista UBI Shelf Installation and Disassembly for Recycling Instructions

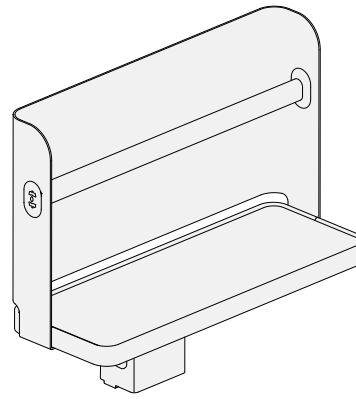

Parts Included



YT300

How to assemble UBI Shelf

Tools Required

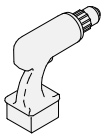

Power Driver



#2 Phillips
Bit

Step 1

- 1.1 Remove protective backing from tape on bottom side of filler.
- 1.2 Align filler with shelf surface. Firmly press in place.

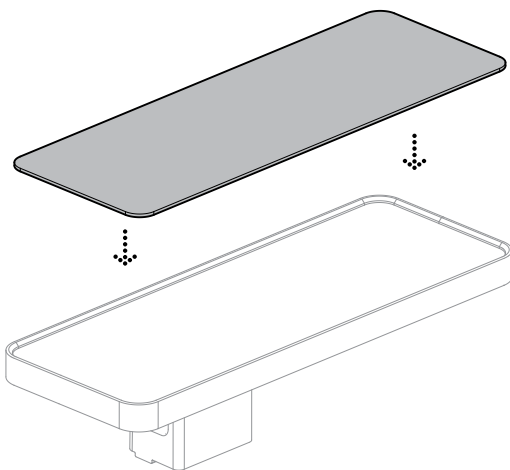

Step 2

- 2.1 Slide brackets on backdrop assembly under shelf surface.
- 2.2 Secure backdrop to shelf surface with 4 truss head screws.

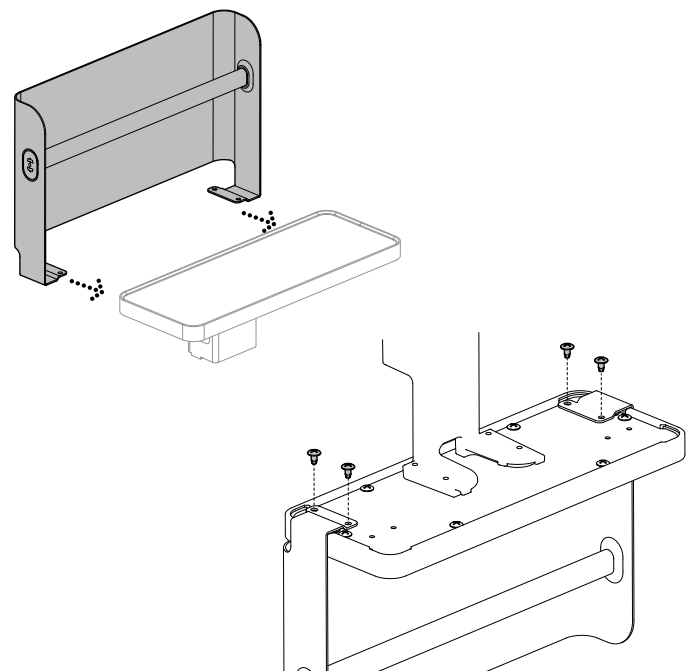

Step 3

- 3.1 Place Shelf Assembly into desired location on chase rail.
- 3.2 Turn knob right to move nut clamp into position. Continue turning knob to tighten clamp.

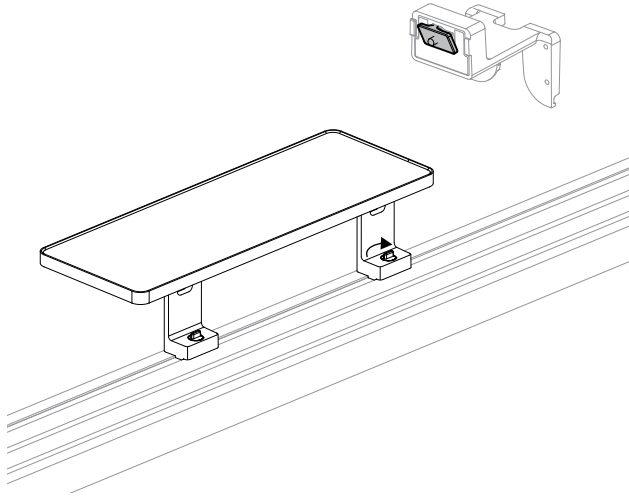

Disassembly and Recycling:

Materials Identification and Segregation:

Where possible, plastic components are marked with ASTM recycling codes. Use these codes to identify material type for recycling. Non marked components should be treated as mixed plastic. Ferrous metals can be identified using a small magnet for recycling. Non-ferrous metals should be separated and recycled separately.

To disassemble product, reverse the above installation steps:

For more information about our products and services please visit us at hermanmiller.com or call (800) 851 1196.

©2018 Herman Miller, Inc., Zeeland, Michigan Printed in U.S.A. Part No. **1BN3RH-A**