

HermanMiller

Canvas Vista Credenza Installation and Disassembly for Recycling Instructions



How to assemble Canvas Vista Credenza

Tools Required

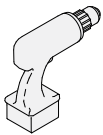

Power Driver



#2 Phillips Bit



Allen wrench (1/8")

Step 1

1.1 Set driver on low torque setting to ensure that the screws do not strip the wood during installation.

1.2 Place the legs in the corner and align with pilot holes, drive (6) screws to fasten the legs to storage's bottom panel.

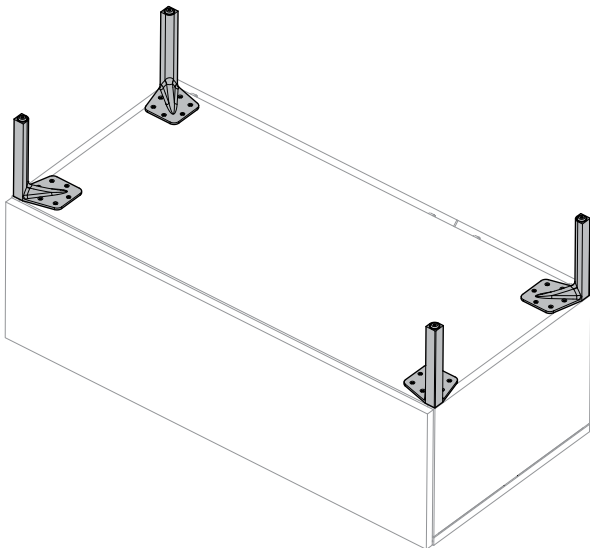

Parts Included

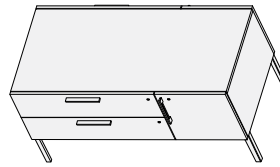

L2CFS

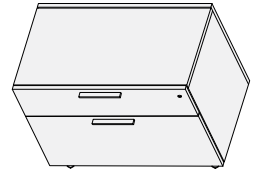

L2CF



Tip Out Stud

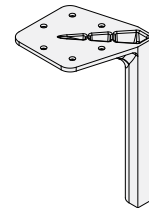

Storage Leg

Step 1

1.1 Once cabinet is leveled and in place, adjust the hinges on the tip out bins to create consistent gaps and alignment of the drawer fronts.

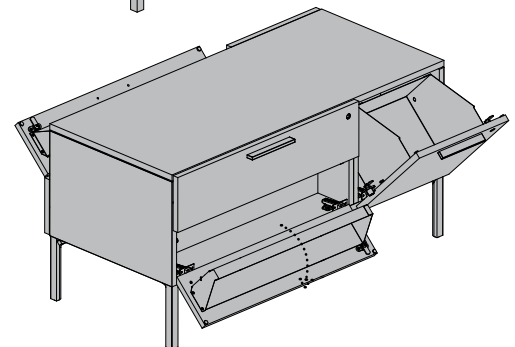
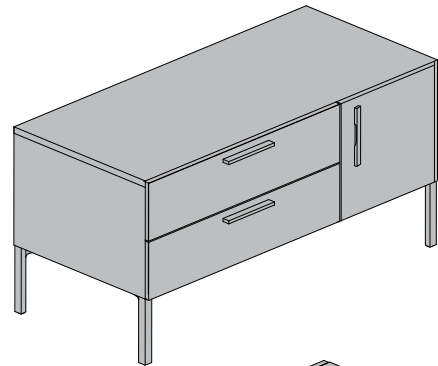

Step 2

2.1 Once the drawer fronts are adjusted properly, tip back tip out bin so that circular cutout is just inside the tab in side of cabinet (roughly 45 degrees).

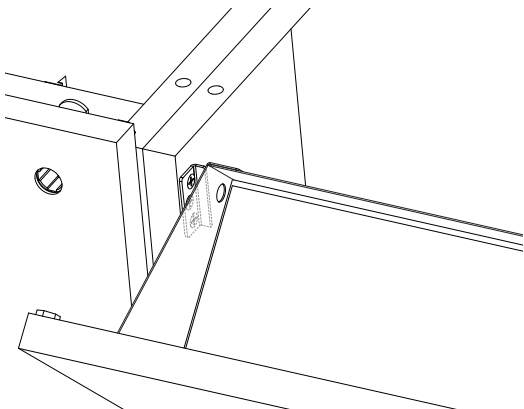

Step 3

3.1 Take Tip Out stud and insert it into the LEFT circle cutout in the tip out bin or tray.

Note: The stud must be behind the stop tab.

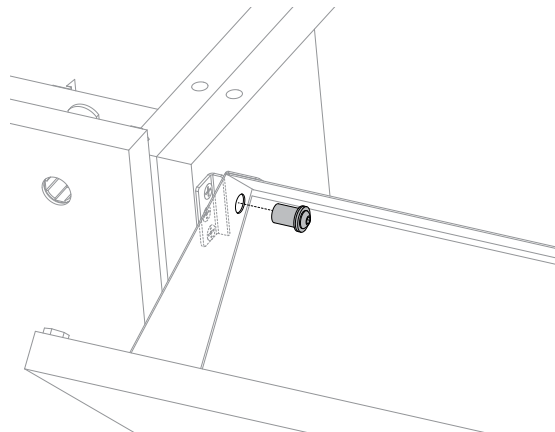

Step 4

4.1 Once inserted, use an allen wrench to Apply an axial force while tightening the screw so that the rubber well nut compresses on the opposing side. Tighten the screw until snug, but do not over tighten.

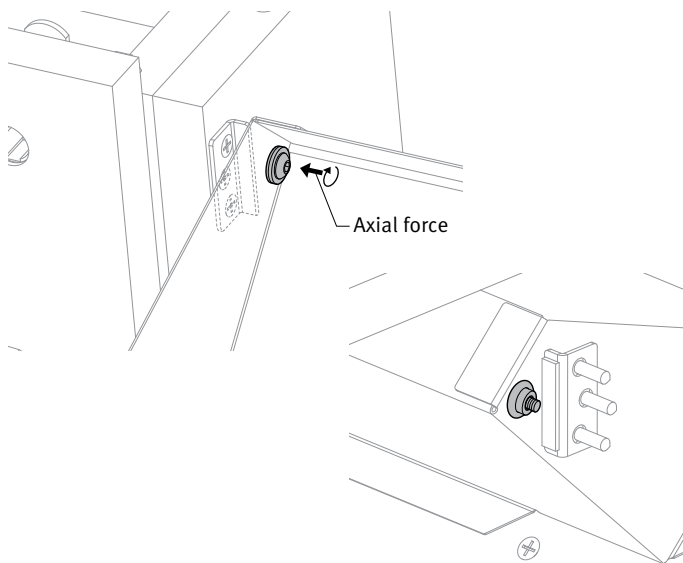

View from back side of the tip out stud

For more information about our products and services please visit us at hermanmiller.com or call (800) 851 1196.

©2018 Herman Miller, Inc., Zeeland, Michigan Printed in U.S.A. Part No. **1BNR09 - A**