



Layout Studio™ Cabinet End Bracket Kit Installation and Disassembly for Recycling Instructions

Parts Included:



A Cabinet End Bracket

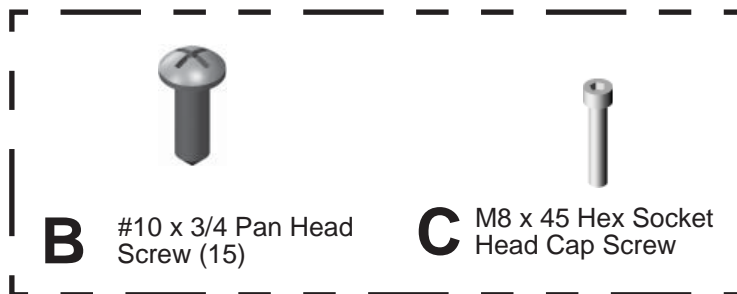

Hardware Pack

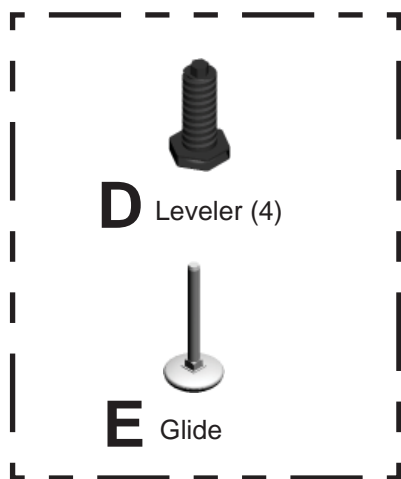

L2SL.481
L2SL.483
L2SL.601
L2SL.603

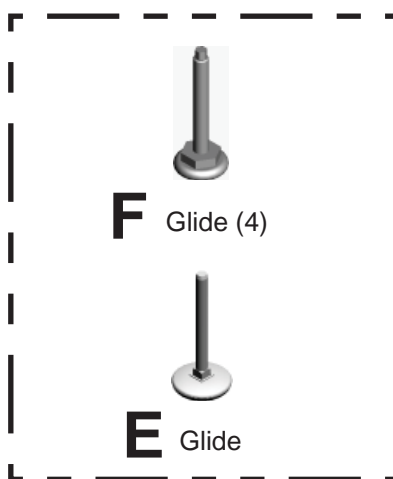

L2SL.489
L2SL.609



L2SL.485
L2SL.605

Tools Required:

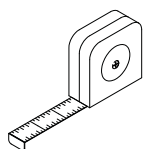

Tape Measure

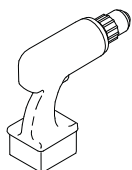

Power Driver



1/8" Drill Bit



#2 Phillips Bit

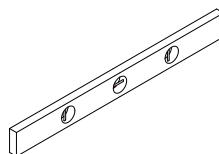

Level

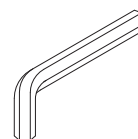

#5 Allen Wrench

HermanMiller

© 2012 Herman Miller, Inc. Zeeland, Michigan. Printed in the U.S.A.

Part no. 1BGJ9F rev C.

™, ®, Herman Miller, Canvas are among the trademarks of Herman Miller, Inc.

Illustrations and specifications are based on the latest product information available at the time of publication.

The right is reserved to make changes in design and specifications at any time, without notice, and also to discontinue products.

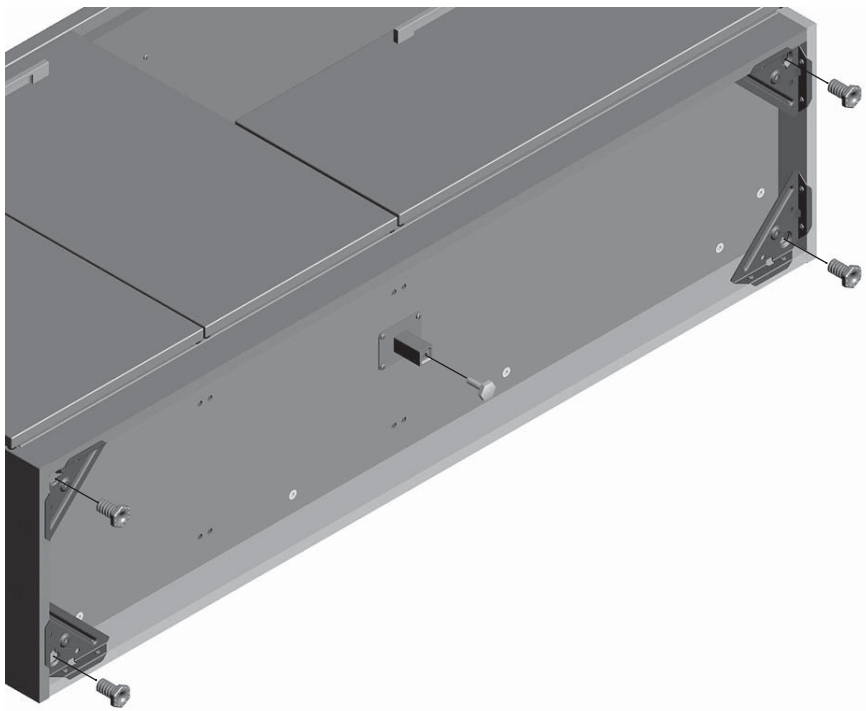

1. If additional glide adjustment is needed, lay storage unit on it's back.
2. Remove glides from storage unit.

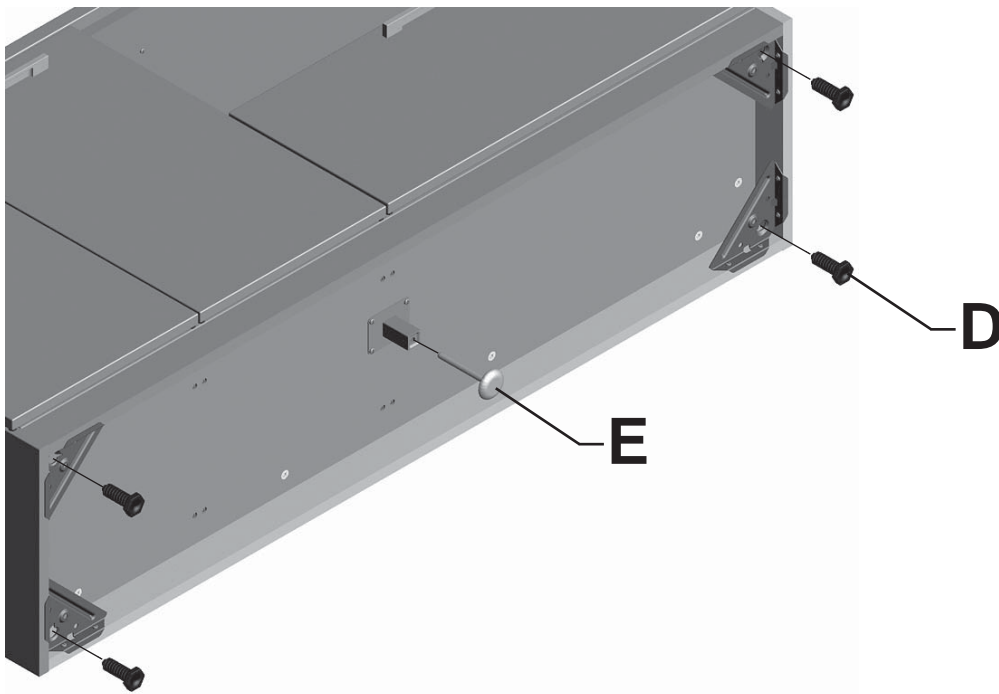

3. Install longer glides onto unit.
4. Stand unit upright.

HermanMiller

© 2012 Herman Miller, Inc. Zeeland, Michigan. Printed in the U.S.A.

Part no. 1BGJ9F rev C.

TM  Herman Miller, Canvas are among the trademarks of Herman Miller, Inc.

Illustrations and specifications are based on the latest product information available at the time of publication.
The right is reserved to make changes in design and specifications at any time, without notice, and also to discontinue products.

Storage End Attachment Bracket Mounting (Product L2SL000) Mounting to TU Cabinets

For cabinets or lockers Mounted to seated height layout benching applications

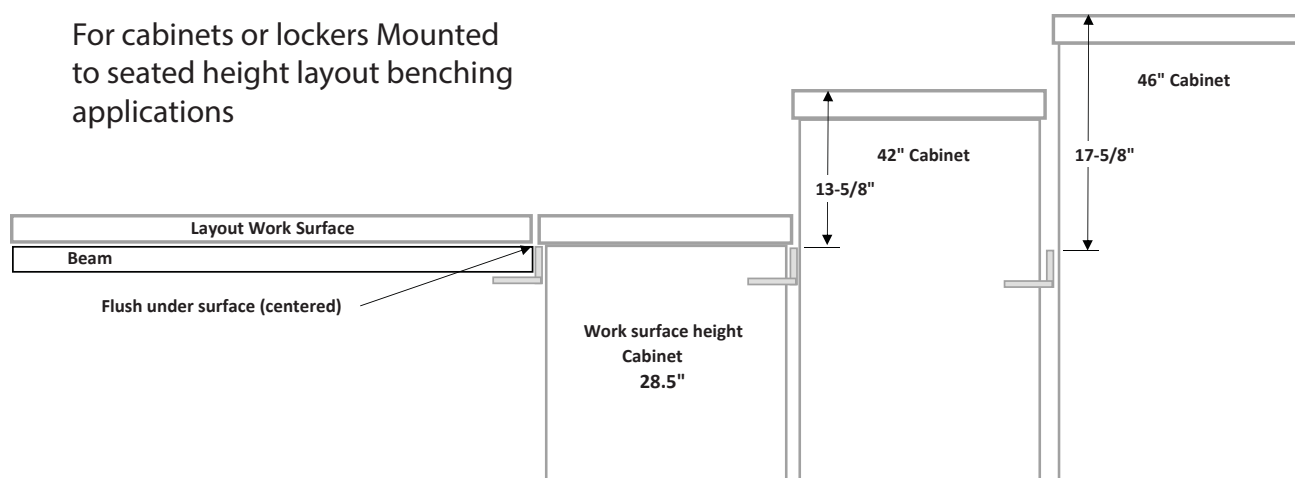

Measurements shown from bottom of cabinet top to top of bracket (28.5" Assumes 1" top thickness)

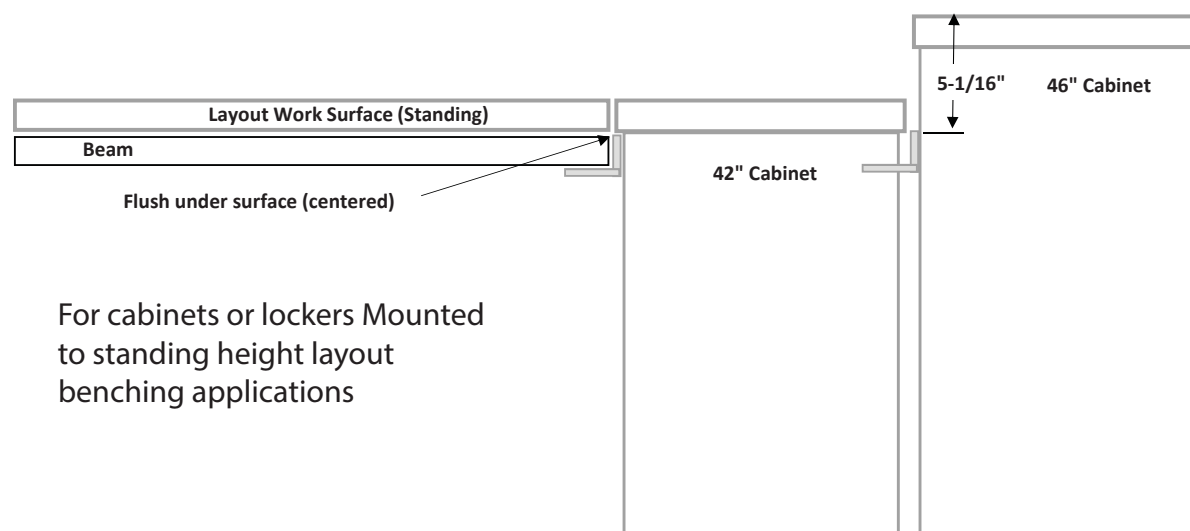

Measurements shown from bottom of cabinet top to top of bracket (42" Assumes 1" top thickness)

5. Use Illustrations above to find the proper location for installing end bracket.

HermanMiller

© 2012 Herman Miller, Inc. Zeeland, Michigan. Printed in the U.S.A.

Part no. 1BGJ9F rev C.

™, ®, Herman Miller, Canvas are among the trademarks of Herman Miller, Inc.

Illustrations and specifications are based on the latest product information available at the time of publication.

The right is reserved to make changes in design and specifications at any time, without notice, and also to discontinue products.

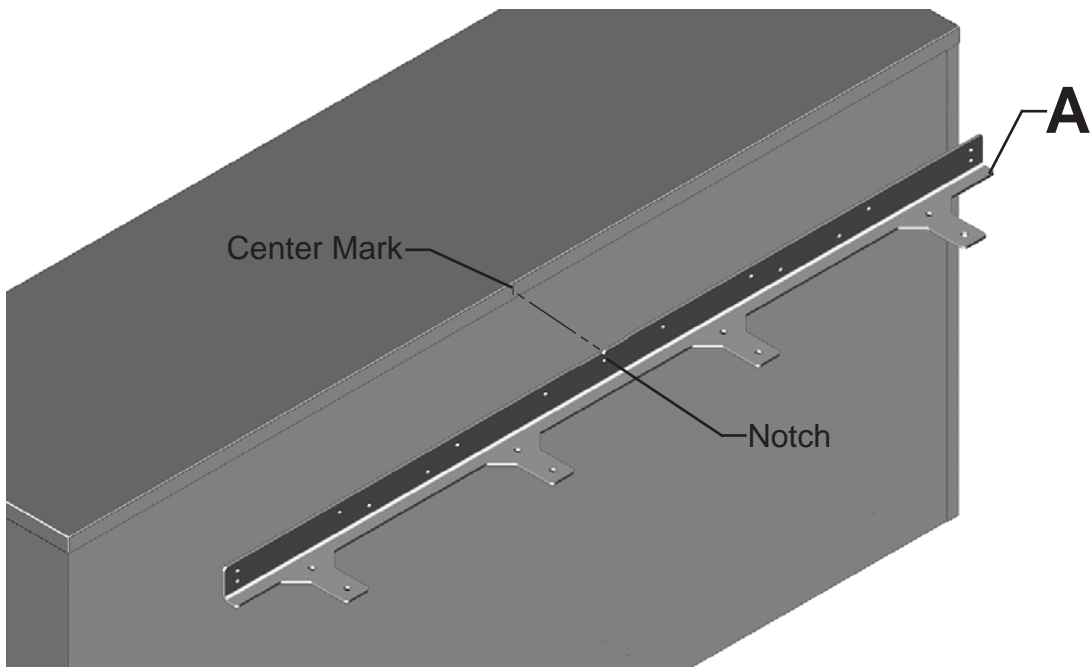

6. Measure width of cabinet along back side to find center point. Mark that spot on back edge of top panel.
7. Align center notch in End Bracket (A) with that mark.

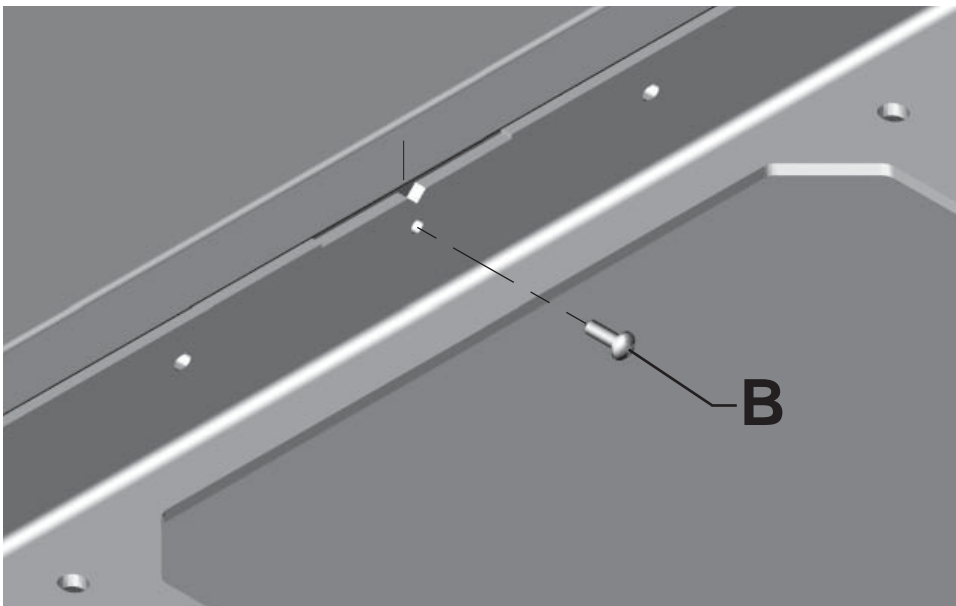

8. Position top edge of bracket to bottom edge of top panel (when height of cabinet is same as system height). For taller cabinets, refer to step 5. Mark center screw hole.
9. Remove bracket. Drill pilot hole for center screw.
10. Re-position bracket to cabinet. Install pan head screw (B) into center screw hole.

HermanMiller

© 2012 Herman Miller, Inc. Zeeland, Michigan. Printed in the U.S.A.

Part no. 1BGJ9F rev C.

TM  Herman Miller, Canvas are among the trademarks of Herman Miller, Inc.

Illustrations and specifications are based on the latest product information available at the time of publication.

The right is reserved to make changes in design and specifications at any time, without notice, and also to discontinue products.

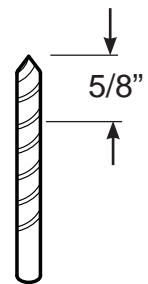
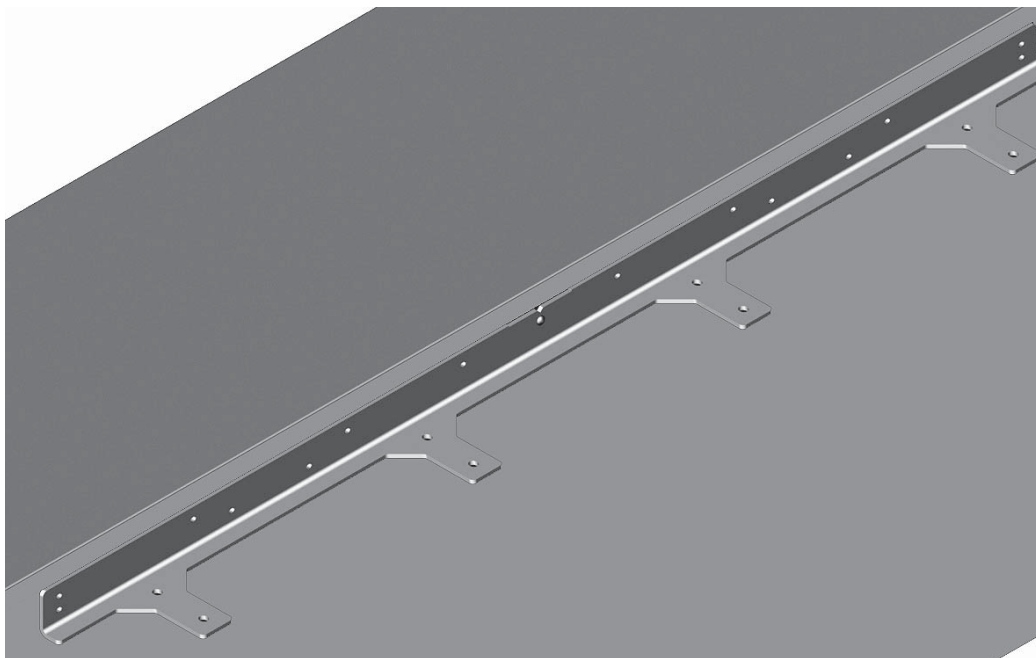

11. Using bracket as template, drill (14) 1/8" diameter pilot holes in cabinet.
Note: Mark drill bit depth so not to drill through back of cabinet.

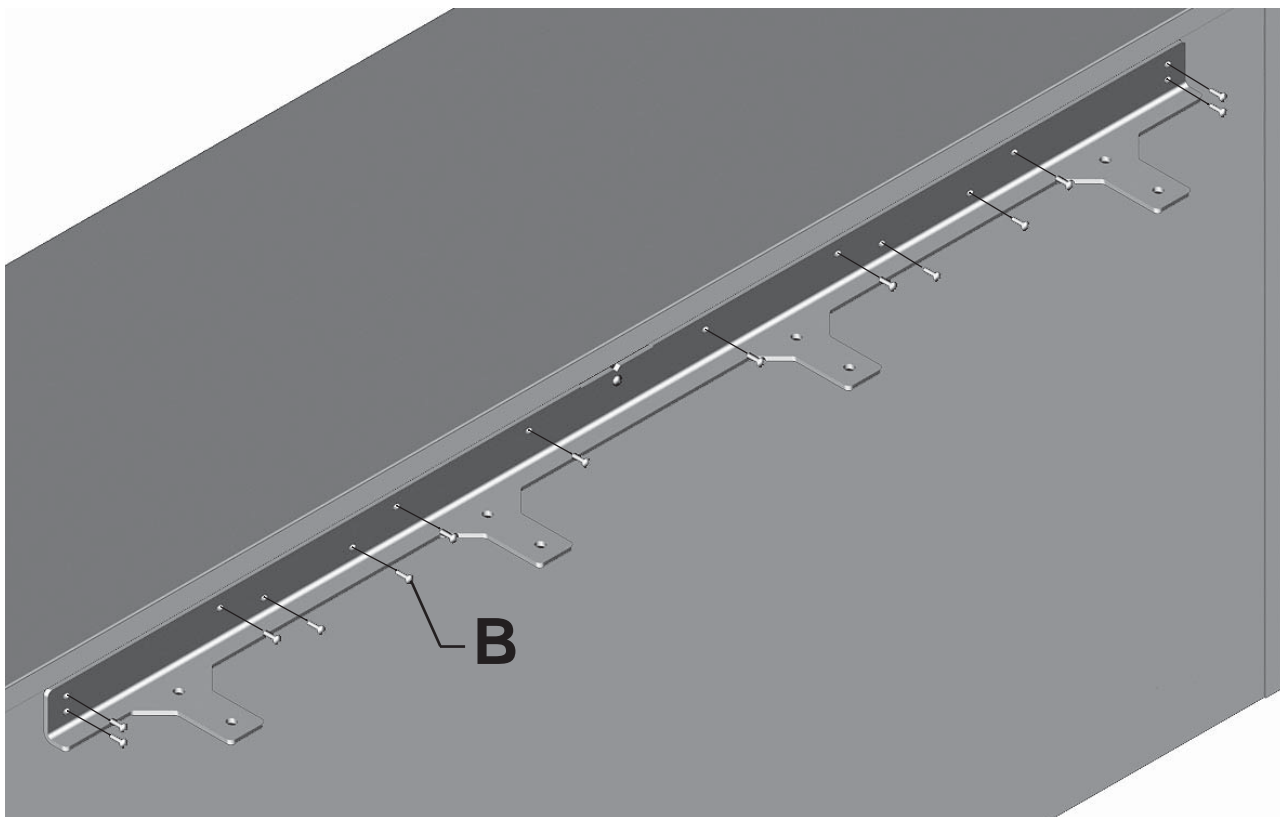

12. Install remaining 14 pan head screws (B).

HermanMiller

© 2012 Herman Miller, Inc. Zeeland, Michigan. Printed in the U.S.A.

Part no. 1BGJ9F rev C.

™, ®, Herman Miller, Canvas are among the trademarks of Herman Miller, Inc.

Illustrations and specifications are based on the latest product information available at the time of publication.
The right is reserved to make changes in design and specifications at any time, without notice, and also to discontinue products.

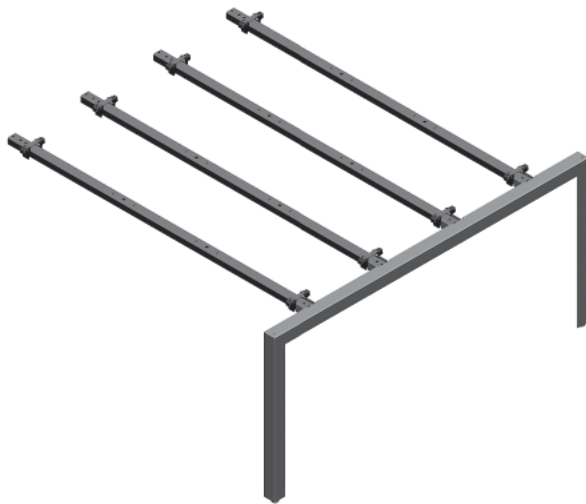

2 Work surface Frame



4 Work surface Frame

13. Assemble beams to legs. See instruction sheet 1BH56N for details.

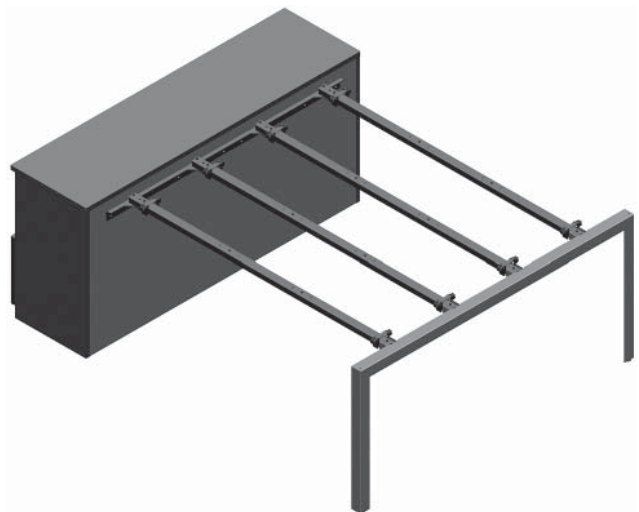
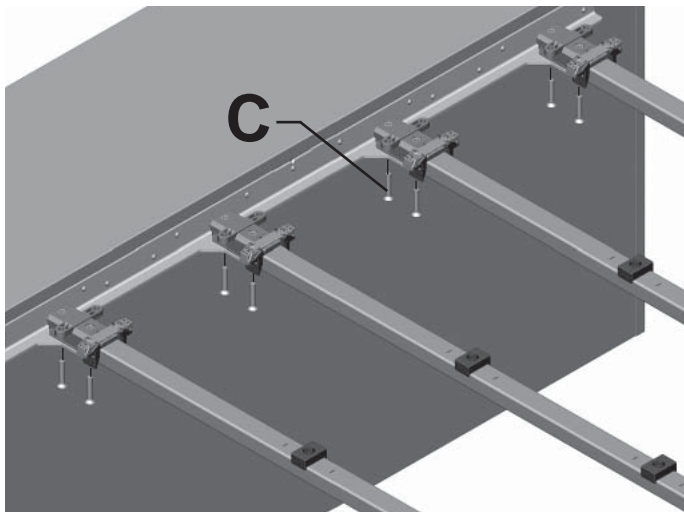

14. Place leg/beam assembly onto bracket. Align beams to holes in bracket.

15. Install hex socket screws (C).

16. Align legs to square frame. Ensure structure is straight and square as shown in instruction sheet 1BH56N. Adjust levelers/glides on legs and cabinet to level frame. Glide kits are provided in case standard glides do not offer enough length to level assembly properly.

HermanMiller

© 2012 Herman Miller, Inc. Zeeland, Michigan. Printed in the U.S.A.

Part no. 1BGJ9F rev C.

TM  Herman Miller, Canvas are among the trademarks of Herman Miller, Inc.

Illustrations and specifications are based on the latest product information available at the time of publication.
The right is reserved to make changes in design and specifications at any time, without notice, and also to discontinue products.

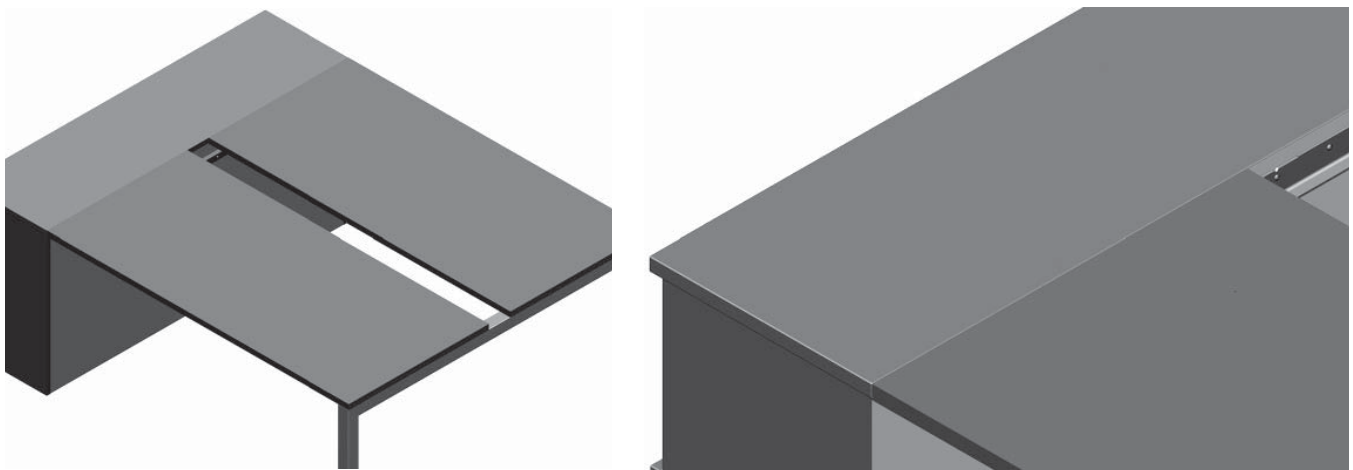

17. Attach work surfaces onto beam/leg assembly. See instruction sheet 1BH56N for details.

Disassembly for Recycling:

Materials Identification and Segregation:

Where possible, plastic components are marked with ASTM recycling codes. Use these codes to identify material type for recycling. Non marked components should be treated as mixed plastic. Ferrous metals can be identified using a small magnet for recycling. Non-ferrous metals should be separated and recycled separately.

To disassemble product, reverse the above installation steps.

HermanMiller

© 2012 Herman Miller, Inc. Zeeland, Michigan. Printed in the U.S.A.

Part no. 1BGJ9F rev C.

™ ® Herman Miller, Canvas are among the trademarks of Herman Miller, Inc.

Illustrations and specifications are based on the latest product information available at the time of publication.

The right is reserved to make changes in design and specifications at any time, without notice, and also to discontinue products.